

**DISPLAY THIS CARD ON PRINCIPAL FRONTAGE OF WORK**  
**CITY OF PORTLAND**

Please Read  
Application And  
Notes, If Any,  
Attached

**BUILDING INSPECTION**

**PERMIT**

**PERMIT ISSUED**

Permit Number: 080529

JUN - 9 2008

CITY OF PORTLAND

This is to certify that LAPOMARDA PASQUALINI & SHARON ELISE LAPOMARDA

has permission to Install 24' round above ground pool

AT 1443 WESTBROOK ST

227 E002001

provided that the person or persons, firm or corporation accepting this permit shall comply with all of the provisions of the Statutes of this State and of the Ordinances of the City of Portland regulating the construction, maintenance and use of buildings and structures, and of the application on file in this department.

Apply to Public Works for street line and grade if nature of work requires such information.

Notification of inspection must be given and when permission procured before this building or part thereof is started or closed-in. 24 HOUR NOTICE IS REQUIRED.

A certificate of occupancy must be procured by owner before this building or part thereof is occupied.

**OTHER REQUIRED APPROVALS**

Fire Dept. \_\_\_\_\_

Health Dept. \_\_\_\_\_

Appeal Board \_\_\_\_\_

Other \_\_\_\_\_

Department Name

6/2/08 ELNA  
Director - Building & Inspection Services

**PENALTY FOR REMOVING THIS CARD**

**City of Portland, Maine - Building or Use Permit Application**

389 Congress Street, 04101 Tel: (207) 874-8703, Fax: (207) 874-8716

|                       |                       |                     |
|-----------------------|-----------------------|---------------------|
| Permit No:<br>08-0529 | Issue Date:<br>6/2/08 | CBL:<br>227 E002001 |
|-----------------------|-----------------------|---------------------|

|                                                |                                         |                                               |                        |
|------------------------------------------------|-----------------------------------------|-----------------------------------------------|------------------------|
| Location of Construction:<br>1443 WESTBROOK ST | Owner Name:<br>LAPOMARDA PASQUALE III & | Owner Address:<br>1443 WESTBROOK ST           | Phone:<br>207-874-2999 |
| Business Name:                                 | Contractor Name:<br>Daves Pool          | Contractor Address:<br>690 Main St. Westbrook | Phone:<br>2078545006   |
| Lessee/Buyer's Name                            | Phone:                                  | Permit Type:<br>Swimming Pools                | Zone:<br>R-2           |

|                                                                                                                          |                                                                           |                                                                                    |                                                                 |                    |
|--------------------------------------------------------------------------------------------------------------------------|---------------------------------------------------------------------------|------------------------------------------------------------------------------------|-----------------------------------------------------------------|--------------------|
| Past Use:<br>Single Family Home                                                                                          | Proposed Use:<br>Single Family Home - Install 24' round above ground pool | Permit Fee:<br>\$40.00                                                             | Cost of Work:<br>\$1,250.00                                     | CEO District:<br>3 |
| Proposed Project Description:<br>Install 24' round above ground pool                                                     |                                                                           | FIRE DEPT:<br><input type="checkbox"/> Approved<br><input type="checkbox"/> Denied | INSPECTION:<br>Use Group: R-3 Type 5B<br>IRC-2003<br>Appendix G |                    |
|                                                                                                                          |                                                                           | Signature:                                                                         | Signature: <i>Ch</i> 6/2/08                                     |                    |
| PEDESTRIAN ACTIVITIES DISTRICT (P.A.D.)                                                                                  |                                                                           |                                                                                    |                                                                 |                    |
| Action: <input type="checkbox"/> Approved <input type="checkbox"/> Approved w/Conditions <input type="checkbox"/> Denied |                                                                           |                                                                                    |                                                                 |                    |
| Signature: _____ Date: _____                                                                                             |                                                                           |                                                                                    |                                                                 |                    |

|                         |                                 |                        |
|-------------------------|---------------------------------|------------------------|
| Permit Taken By:<br>lmd | Date Applied For:<br>05/16/2008 | <b>Zoning Approval</b> |
|-------------------------|---------------------------------|------------------------|

|                                                                                                                                                                                                                                                                                                                                                                                       |                                                                                                                                                                                                                                                                                                                                                                                         |                                                                                                                                                                                                                                                                                              |                                                                                                                                                                                                                                                                                                                                                                    |
|---------------------------------------------------------------------------------------------------------------------------------------------------------------------------------------------------------------------------------------------------------------------------------------------------------------------------------------------------------------------------------------|-----------------------------------------------------------------------------------------------------------------------------------------------------------------------------------------------------------------------------------------------------------------------------------------------------------------------------------------------------------------------------------------|----------------------------------------------------------------------------------------------------------------------------------------------------------------------------------------------------------------------------------------------------------------------------------------------|--------------------------------------------------------------------------------------------------------------------------------------------------------------------------------------------------------------------------------------------------------------------------------------------------------------------------------------------------------------------|
| <p>1. This permit application does not preclude the Applicant(s) from meeting applicable State and Federal Rules.</p> <p>2. Building permits do not include plumbing, septic or electrical work.</p> <p>3. Building permits are void if work is not started within six (6) months of the date of issuance. False information may invalidate a building permit and stop all work..</p> | <p><b>Special Zone or Reviews</b></p> <input type="checkbox"/> Shoreland<br><input type="checkbox"/> Wetland<br><input type="checkbox"/> Flood Zone<br><input type="checkbox"/> Subdivision<br><input type="checkbox"/> Site Plan<br><p>Maj <input type="checkbox"/> Minor <input type="checkbox"/> MM <input type="checkbox"/></p> <p><i>OK w/ condition</i><br/>Date: 5/20/08 ABN</p> | <p><b>Zoning Appeal</b></p> <input type="checkbox"/> Variance<br><input type="checkbox"/> Miscellaneous<br><input type="checkbox"/> Conditional Use<br><input type="checkbox"/> Interpretation<br><input type="checkbox"/> Approved<br><input type="checkbox"/> Denied<br><p>Date: _____</p> | <p><b>Historic Preservation</b></p> <input checked="" type="checkbox"/> Not in District or Landmark<br><input type="checkbox"/> Does Not Require Review<br><input type="checkbox"/> Requires Review<br><input type="checkbox"/> Approved<br><input type="checkbox"/> Approved w/Conditions<br><input type="checkbox"/> Denied<br><p><i>ABN</i><br/>Date: _____</p> |
|---------------------------------------------------------------------------------------------------------------------------------------------------------------------------------------------------------------------------------------------------------------------------------------------------------------------------------------------------------------------------------------|-----------------------------------------------------------------------------------------------------------------------------------------------------------------------------------------------------------------------------------------------------------------------------------------------------------------------------------------------------------------------------------------|----------------------------------------------------------------------------------------------------------------------------------------------------------------------------------------------------------------------------------------------------------------------------------------------|--------------------------------------------------------------------------------------------------------------------------------------------------------------------------------------------------------------------------------------------------------------------------------------------------------------------------------------------------------------------|

**CERTIFICATION**

I hereby certify that I am the owner of record of the named property, or that the proposed work is authorized by the owner of record and that I have been authorized by the owner to make this application as his authorized agent and I agree to conform to all applicable laws of this jurisdiction. In addition, if a permit for work described in the application is issued, I certify that the code official's authorized representative shall have the authority to enter all areas covered by such permit at any reasonable hour to enforce the provision of the code(s) applicable to such permit.

\_\_\_\_\_  
SIGNATURE OF APPLICANT ADDRESS DATE PHONE

\_\_\_\_\_  
RESPONSIBLE PERSON IN CHARGE OF WORK, TITLE DATE PHONE

**City of Portland, Maine - Building or Use Permit**

389 Congress Street, 04101 Tel: (207) 874-8703, Fax: (207) 874-8716

|                              |                                        |                            |
|------------------------------|----------------------------------------|----------------------------|
| <b>Permit No:</b><br>08-0529 | <b>Date Applied For:</b><br>05/16/2008 | <b>CBL:</b><br>227 E002001 |
|------------------------------|----------------------------------------|----------------------------|

|                                                       |                                                  |                                                      |                                 |
|-------------------------------------------------------|--------------------------------------------------|------------------------------------------------------|---------------------------------|
| <b>Location of Construction:</b><br>1443 WESTBROOK ST | <b>Owner Name:</b><br>LAPOMARDA PASQUALE III & S | <b>Owner Address:</b><br>1443 WESTBROOK ST           | <b>Phone:</b><br>207-874-2999   |
| <b>Business Name:</b>                                 | <b>Contractor Name:</b><br>Daves Pool            | <b>Contractor Address:</b><br>690 Main St. Westbrook | <b>Phone:</b><br>(207) 854-5006 |
| <b>Lessee/Buyer's Name</b>                            | <b>Phone:</b>                                    | <b>Permit Type:</b><br>Swimming Pools                |                                 |

|                                                                                  |                                                                             |
|----------------------------------------------------------------------------------|-----------------------------------------------------------------------------|
| <b>Proposed Use:</b><br>Single Family Home - Install 24' round above ground pool | <b>Proposed Project Description:</b><br>Install 24' round above ground pool |
|----------------------------------------------------------------------------------|-----------------------------------------------------------------------------|

**Dept:** Zoning      **Status:** Approved with Conditions      **Reviewer:** Ann Machado      **Approval Date:** 05/20/2008

**Note:****Ok to Issue:** 

- 1) This permit is being approved on the basis of plans submitted. Any deviations shall require a separate approval before starting that work.

**Dept:** Building      **Status:** Approved with Conditions      **Reviewer:** Chris Hanson      **Approval Date:** 06/02/2008

**Note:****Ok to Issue:** 

- 1) Equipment must be installed in compliance with the manufacturer's specifications
- 2) Pool and barrier installation shall meet the code requirements in Appendix G of the IRC 2003
- 3) Separate permits are required for any electrical, plumbing, or HVAC systems. Separate plans may need to be submitted for approval as a part of this process.

## BUILDING PERMIT INSPECTION PROCEDURES

Please call 874-8703 or 874-8693 (ONLY )

to schedule your inspections as agreed upon

Permits expire in 6 months, if the project is not started or ceases for 6 months.

The Owner or their designee is required to notify the inspections office for the following inspections and provide adequate notice. Notice must be called in 48-72 hours in advance in order to schedule an inspection:

**By initializing at each inspection time, you are agreeing that you understand the inspection procedure and additional fees from a "Stop Work Order" and "Stop Work Order Release" will be incurred if the procedure is not followed as stated below.**

**A Pre-construction Meeting will take place upon receipt of your building permit.**

Final inspection of barriers or alarm systems

Final inspection required at completion of work.

Certificate of Occupancy is not required for certain projects. Your inspector can advise you if your project requires a Certificate of Occupancy. All projects DO require a final inspection.

**If any of the inspections do not occur, the project cannot go on to the next phase, REGARDLESS OF THE NOTICE OR CIRCUMSTANCES.**

**CERIFICATE OF OCCUPANICES MUST BE ISSUED AND PAID FOR, BEFORE THE SPACE MAY BE OCCUPIED.**

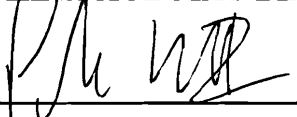
  
\_\_\_\_\_  
Signature of Applicant/Designee

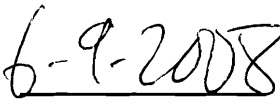
  
\_\_\_\_\_  
Date

\_\_\_\_\_  
Signature of Inspections Official

\_\_\_\_\_  
Date



# Pool Installation/Construction Permit Application

If you or the property owner owes real estate or personal property taxes or user charges on any property within the City, payment arrangements must be made before permits of any kind are accepted.

|                                                                                                                                                                    |                                                                                                                                 |                                                       |
|--------------------------------------------------------------------------------------------------------------------------------------------------------------------|---------------------------------------------------------------------------------------------------------------------------------|-------------------------------------------------------|
| Location/Address of Construction: <u>1443 Westbrook St. Portland, ME</u>                                                                                           |                                                                                                                                 |                                                       |
| Total Square Footage of Proposed Structure                                                                                                                         | Square Footage of Lot<br><u>29,119</u>                                                                                          |                                                       |
| Tax Assessor's Chart, Block & Lot<br>Chart# <u>227</u> Block# <u>E</u> Lot# <u>2</u>                                                                               | Owner:<br><u>Pasquale Lapomarda III</u>                                                                                         | Telephone:<br><u>207-874-2999</u>                     |
| Lessee/Buyer's Name (If Applicable)                                                                                                                                | Applicant name, address & telephone:<br><u>Pasquale Lapomarda III</u><br><u>1443 Westbrook St.</u><br><u>Portland, ME 04102</u> | Cost Of Work: \$ <u>1,250.00</u><br>Fee: \$ <u>30</u> |
| Dimensions of pool: <u>24' Round</u> above or below ground: <u>above</u>                                                                                           |                                                                                                                                 |                                                       |
| Dimensions of decking and/or any platforms, sheds, or other structures:                                                                                            |                                                                                                                                 |                                                       |
| Contractor's name, address & telephone:<br><u>Dave's Pool</u><br><u>690 Main St.</u><br><u>Westbrook, ME 04092</u>                                                 |                                                                                                                                 |                                                       |
| Who should we contact when the permit is ready: <u>Dave's Pool</u><br>Mailing address: <u>690 Main St.</u><br><u>Westbrook, ME 04092</u><br>Phone: <u>854-5006</u> |                                                                                                                                 |                                                       |

Please submit all of the information outlined in the pool application checklist. Failure to do so could result in the automatic denial of your permit.

In order to be sure the City fully understands the full scope of the project, the Planning and Development Department may request additional information prior to the issuance of a permit. For further information visit us on-line at [www.portlandmaine.gov](http://www.portlandmaine.gov), stop by the Building Inspections office, room 315 City Hall or call 874-8703.

I hereby certify that I am the Owner of record of the named property, or that the owner of record authorizes the proposed work and that I have been authorized by the owner to make this application as his/her authorized agent. I agree to conform to all applicable laws of this jurisdiction. In addition, if a permit for work described in this application is issued, I certify that the Code Official's authorized representative shall have the authority to enter all areas covered by this permit at any reasonable hour to enforce the provisions of the codes applicable to this permit.

|                                            |                       |
|--------------------------------------------|-----------------------|
| Signature of applicant: <u>[Signature]</u> | Date: <u>5-9-2008</u> |
|--------------------------------------------|-----------------------|

This is not a permit; you may not commence ANY work until the permit is issued.



## Pool Installation/Construction Checklist

All of the following information is required and must be submitted. Checking off each item as you prepare your application package will ensure your package is complete and will help to expedite the permitting process.

- A plot plan showing the shape and dimension of the lot, footprint of the pool and its distance from the actual property lines, and the principal structure. Include any decks or accessory structures
- A complete set of plans that include structural details, size and dimensions and a cross section showing the slope and depth ratios, or for above ground pool, design specifications. Often this information can be obtained from the manufacturer.
- A complete set of construction details for any accessory structures or decks including: pier or foundation layout, framing, fastenings, guards/handrails, baluster spacing and stair dimensions
- Details of required barrier protection including the design of fencing, gates, latches, ladders, or audible alarms (if applicable). Please show where they will be located and how they are constructed. This information can often be obtained from the manufacturer
- Proof of ownership is required if it is inconsistent with the assessors records

**All pool installations must be conducted in compliance with the  
IRC 2003 Building Code Appendix G**

**Separate permits are required for HVAC, and electrical installations.**

Permit Fee: \$30.00 for the first \$1000.00 construction cost, \$9.00 per additional \$1000.00 cost

**This is not a Permit; you may not commence any work until the Permit is issued.**

10/03

**AUBUCHON  
HARDWARE**[Print Window](#)[Close Window](#)

## Tee Fence Posts Green, 5'



**\$5.99** Online prices may vary from in-store prices.

✓ Usually ships in 2-5 business days

Designed to make them easier to use and more durable. These new posts feature an angled stud that helps hold the fence against the post. The large anchor plate provides greater holding power. This Tee Fence Posts Green, 5' is one of many top quality items in our Fence Tee Posts department.

Aubuchon Item #: **662835**

### Features and Details

**This item is available Online Only.**

You can also order this item through our retail locations in New England and Upstate New York.

- SMI Steel Model #TP125PGN050
- STEEL - STUDDER
- GREEN POST - SILVER TOPS - 1.25 WGT. - STANDARD
- Less Fasteners
- 5
- Unit: each
- Unit Weight: 12.0000 lbs
- UPC Code: 755588000859
- [Back to Top](#)

Product images may differ from actual product appearance.

Not all products are available at every Aubuchon Hardware store

Online prices and promotions may vary from what is available in our retail locations.

**Need help with your order? Contact us at 800-282-4393.**

© W.E. Aubuchon Co., Inc. 2007.

**AUBUCHON  
HARDWARE**[Print Window](#)[Close Window](#)

## Wood Snow fence, 4' x 50'



**\$79.99** Online prices may vary from in-store prices.

✓ Usually ships in 2-5 business days

Traditional wood lathe slatted fence for snow and sand control. 5 strands of 14-gauge twisted wire support 3/8" x 1-1/2" natural wood slats. This Wood Snow fence, 4' x 50' is one of many top quality items in our Snow Fence department.

Aubuchon Item #: **651840**

### Features and Details

**This item is available Store Only.**

You can also order this item through our retail locations in New England and Upstate New York.

- Mutual Industries Model #14910-9-48
- NATURAL WOOD
- Height x Lgth. Ft. 4 x 50
- Unit: roll
- Unit Weight: 40.0000 lbs
- UPC Code: 764083491017
- [Back to Top](#)

Product images may differ from actual product appearance.

Not all products are available at every Aubuchon Hardware store

Online prices and promotions may vary from what is available in our retail locations.

**Need help with your order? Contact us at 800-282-4393.**

© W.E. Aubuchon Co., Inc. 2007.



MAG. 2007

2.6'

S45°14'16"

149.40

N/F  
LABAY

BK. 21245, PG. 216

TAX SHEET 227, BLOCK E, LOT 1

SPLIT RAIL FENCE (TYP.)

CHAIN LINK FENCE (TYP.)

N44°45'44"E

225.00

PARCEL AREA  
29,119 SQ.F

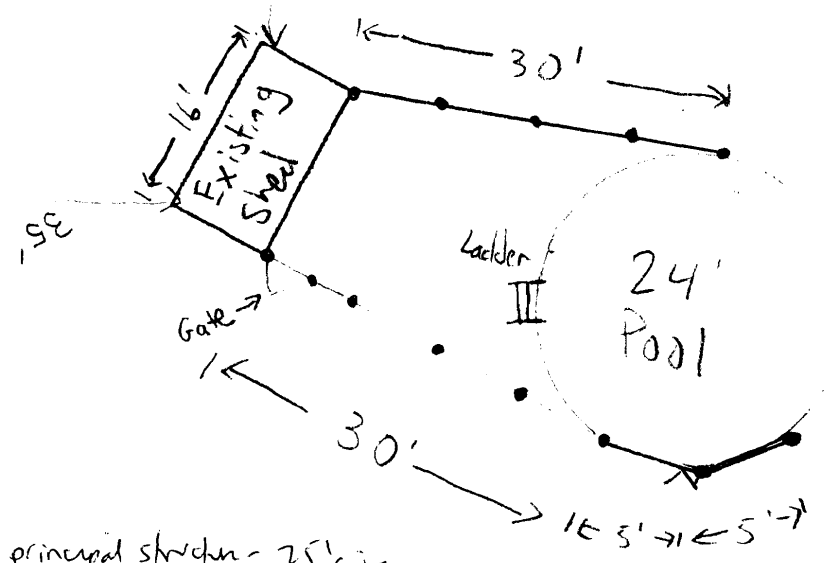
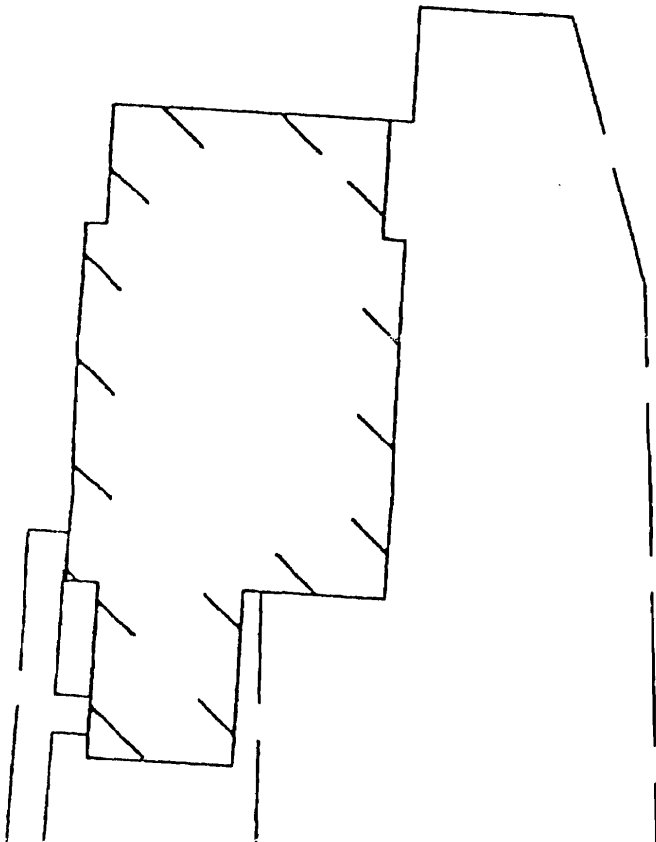
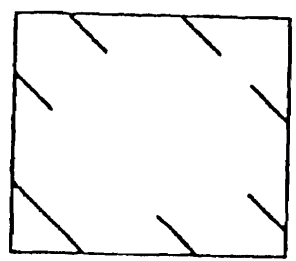

min - 10' from principal structure - 25' given  
min - 10' from rear - 50' given  
min - 10' from side - @ least 65' from right?

