

DISPLAY THIS CARD ON PRINCIPAL FRONTAGE OF WORK

CITY OF PORTLAND

BUILDING DEPARTMENT

PERMIT

Please Read Application And Notes, If Any, Attached

PERMIT ISSUED
Permit Number: 050886
JUL 14 2005
CITY OF PORTLAND

This is to certify that SHONLE KRISTEN & JASON P MOORE INC /Applicant
has permission to 10' x 9' Shed
AT 28 WINDING WAY
City 225 D001001

provided that the person or persons, firm or corporation accepting this permit shall comply with all of the provisions of the Statutes of Maine and of the ordinances of the City of Portland regulating the construction, maintenance and use of buildings and structures, and of the application on file in this department.

Apply to Public Works for street line and grade if nature of work requires such information.

Notification of inspection must be given and written permission procured before this building or part thereof is altered or closed-in. 48 HOUR NOTICE IS REQUIRED.

A certificate of occupancy must be procured by owner before this building or part thereof is occupied.

OTHER REQUIRED APPROVALS

Fire Dept.
Health Dept.
Appeal Board
Other
DepartmentName

Jeanie Bourke 7/13/05
Director - Building & Inspection Services

PENALTY FOR REMOVING THIS CARD

**City of Portland, Maine - Building or Use Permit Application**

389 Congress Street, 04101 Tel: (207) 874-8703, Fax: (207) 874-8716

Permit No: 05-0896	Issue Date: <b>PERMIT ISSUED</b> JUL 14 2005	CBL: 05 D00 001
-----------------------	--	--------------------

<b>Location of Construction:</b> 28 WINDING WAY	<b>Owner Name:</b> SHONLE KRISTEN & JASON P M	<b>Owner Address:</b> 28 WINDING WAY	<b>Phone:</b>
<b>Business Name:</b>	<b>Contractor Name:</b> Applicant	<b>Contractor Address:</b> Portland	<b>Phone:</b>
<b>Lessee/Buyer's Name</b>	<b>Phone:</b>	<b>Permit Type:</b> Sheds	<b>Zone:</b> R3

<b>Past Use:</b> Single Family Home	<b>Proposed Use:</b> Single Family Home/ 10' x 9' Shed	<b>Permit Fee:</b> \$30.00	<b>Cost of Work:</b> \$220.00	<b>CEO District:</b> 3	<i>Partial Shoreland</i>
--	---	-------------------------------	----------------------------------	---------------------------	--------------------------

<b>FIRE DEPT:</b> <input type="checkbox"/> Approved <input type="checkbox"/> Denied	<b>INSPECTION:</b> Use Group: R3 Type: u
Signature	Signature: <i>AMB 7/13/05</i> (A.D.)

**Proposed Project Description:**  
10' x 9' Shed

Action:  Approved  Approved w/Conditions  Denied

Signature: \_\_\_\_\_ Date: \_\_\_\_\_

<b>Permit Taken By:</b> Idobson	<b>Date Applied For:</b> 06/29/2005	<b>Zoning Approval</b>	
------------------------------------	--	------------------------	--

<ol style="list-style-type: none"> <li>This permit application does not preclude the Applicant(s) from meeting applicable State and Federal Rules.</li> <li>Building permits do not include plumbing, septic or electrical work.</li> <li>Building permits are void if work is not started within six (6) months of the date of issuance. False information may invalidate a building permit and stop all work..</li> </ol>	<b>Special Zone or Reviews</b> <input checked="" type="checkbox"/> Shoreland <input type="checkbox"/> Wetland <input type="checkbox"/> Flood Zone <input type="checkbox"/> Subdivision <input type="checkbox"/> Site Plan Maj <input type="checkbox"/> Minor <input type="checkbox"/> MM <input type="checkbox"/> Date: <i>AMB OK 7/13/05</i>	<b>Zoning Appeal</b> <input type="checkbox"/> Variance <input type="checkbox"/> Miscellaneous <input type="checkbox"/> Conditional Use <input type="checkbox"/> Interpretation <input type="checkbox"/> Approved <input type="checkbox"/> Denied Date: _____	<b>Historic Preservation</b> <input checked="" type="checkbox"/> Not in District or Landmark <input type="checkbox"/> Does Not Require Review <input type="checkbox"/> Requires Review <input type="checkbox"/> Approved <input type="checkbox"/> Approved w/Conditions <input type="checkbox"/> Denied Date: <i>AMB</i>
	<i>Front edge of property in shoreland well over 15' from HWM</i> <i>5' min from property lines</i>		

**CERTIFICATION**

I hereby certify that I am the owner of record of the named property, or that the proposed **work** is authorized by the owner of record and that I have been authorized by the owner to make this application as his authorized agent and I agree to conform to all applicable laws of this jurisdiction. In addition, if a permit for work described in the application is issued, I certify that the code official's authorized representative shall have the authority to enter all areas covered by such permit at any reasonable hour to enforce the provision of the code(s) applicable to such permit.

SIGNATURE OF APPLICANT	ADDRESS	DATE	PHONE
RESPONSIBLE PERSON IN CHARGE OF WORK, TITLE		DATE	PHONE

# All Purpose Building Permit Application

If you or the property owner owes real estate or personal property taxes or user charges on any property within the City, payment arrangements must be made before permits of any kind are accepted.

Total Square Footage of Proposed Structure <u>90 sq. Ft.</u>		Square Footage of Lot <u>7249 sq. Ft.</u>	
Lessee/Buyer's Name (If Applicable) _____		Applicant name, address & telephone: <u>Jason Moore</u> <u>28 Winding Way</u> <u>Portland, ME 04102</u>	
		Cost Of Work: \$ <u>0.0000</u> Fee: \$ <u>0.00/00</u>	
Current use: <u>Dwelling</u>			
If the location is currently vacant, what was prior use: _____			
Approximately how long has it been vacant: _____			
Proposed use: <u>Shed</u>			
Project description: <u>10x9 Shed Kit purchased from Sears</u>			
Contractor's name, address & telephone: _____			
Who should we contact when the permit is ready: <u>Jason Moore</u>			
Mailing address: <u>28 Winding Way</u> <u>Portland ME 04102</u>			
We will contact you by phone when the permit is ready. You must come in and pick up the permit and review the requirements before starting any work, with a Plan Reviewer. A stop work order will be issued and a \$100.00 fee if any work starts before the permit is picked up.			
PHONE: <u>207-776-9014</u>			

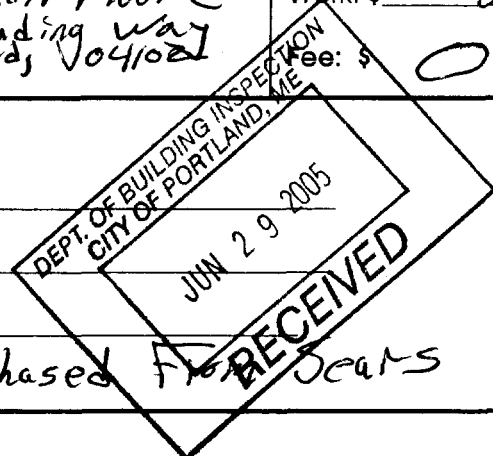

**IF THE REQUIRED INFORMATION IS NOT INCLUDED IN THE SUBMISSIONS THE PERMIT WILL BE AUTOMATICALLY DENIED AT THE DISCRETION OF THE BUILDING/PLANNING DEPARTMENT, WE MAY REQUIRE ADDITIONAL INFORMATION IN ORDER TO APPROVE THIS PERMIT.**

*I hereby certify that I am the Owner of record of the named property, or that the owner of record authorizes the proposed work and that I have been authorized by the owner to make this application as his/her authorized agent. I agree to conform to all applicable laws of this jurisdiction. In addition, if a permit for work described in this application is issued, I certify that the Code Official's authorized representative shall have the authority to enter all areas covered by this permit at any reasonable hour to enforce the provisions of the codes applicable to this permit.*

Signature of applicant: <u>Jason Moore</u>	Date: <u>6/28/05</u>
--	----------------------

**This is NOT a permit, you may not commence ANY work until the permit is issued. If you are in a Historic District you may be subject to additional permitting and fees with the Planning Department on the 4<sup>th</sup> floor of City Hall**

# Foundation

K9

## The Foundation For Your Building

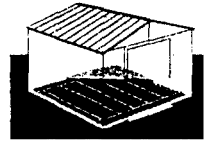

### OPTION 1: ARROW FLOOR FOUNDATION KIT: (Order No FB109-A or 68385-A)

Arrow has the best base for your building in this simple kit. It keeps stored items above the ground. This foundation should be used with one of the following.

A. To support a plywood deck B. To be filled with sand. We recommend the combined use of 1. an ARROW FLOOR FOUNDATION KIT and 2. an ARROW ANCHORING KIT as an effective method of securing the building to the ground. Allow 1-2 hours for construction.

### OPTION 2: Wood Platform

If you decide to build your own foundation, be sure to select the appropriate materials.

These are the recommended materials for your foundation:

- 2 x 4's (5cm x 10cm) Pressure Treated Lumber
- 5/8" (1,5cm) 4 x 8 (122cm x 244cm) Plywood-exterior grade
- 10 & 4 penny Galvanized Nails
- Concrete Blocks (optional)

The platform should be level and flat (free of bumps, ridges etc.) to provide good support for the building. The necessary materials may be obtained from your local lumber yard.

To construct the foundation follow instructions and diagram.

Construct frame (using 10 penny galvanized nails)

Measure 16"/24" (40,6cm/61cm) sections to construct inside frame (see diagram)

Secure plywood to frame (using 4 penny galvanized nails)

Allow 6 - 7 hours for construction.

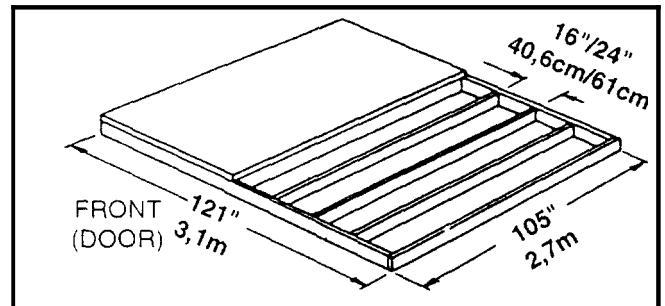

Note: Platform/Slab will extend 9/16" (1,4cm) beyond floor frame on all four sides. Seal this 9/16" of wood with a roofing cement (not included), or bevel this 9/16" of concrete when pouring, for good water drainage.

### OPTION 3: Concrete Slab

- We recommend for a proper strength concrete to use a mix of: 1 part cement ● 3 parts pea sized gravel ● 2 1/2 parts clean sand

Prepare the Site/Construct a Foundation

1. Dig a square, 6" (15cm) deep into the ground (remove grass).
2. Fill up to 4" (10cm) in the square with gravel and tamp firm.
3. Cover gravel with a sheet of 6 mil plastic.
4. Construct a wood frame using four planks of 1x4 (2,5cm x 10cm) lumber.
5. Pour in concrete to fill in the hole and the frame giving a total of 4" (8-10cm) thick concrete. Be sure surface is level.

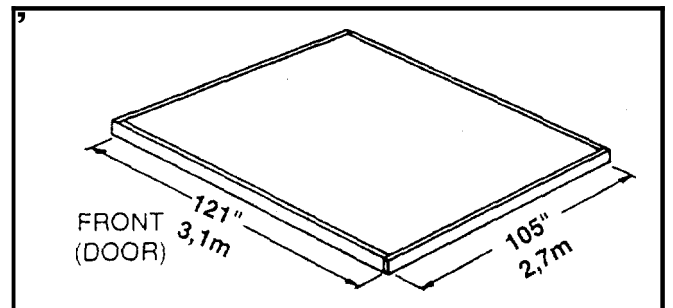

# Assembly by Key No.

AE13

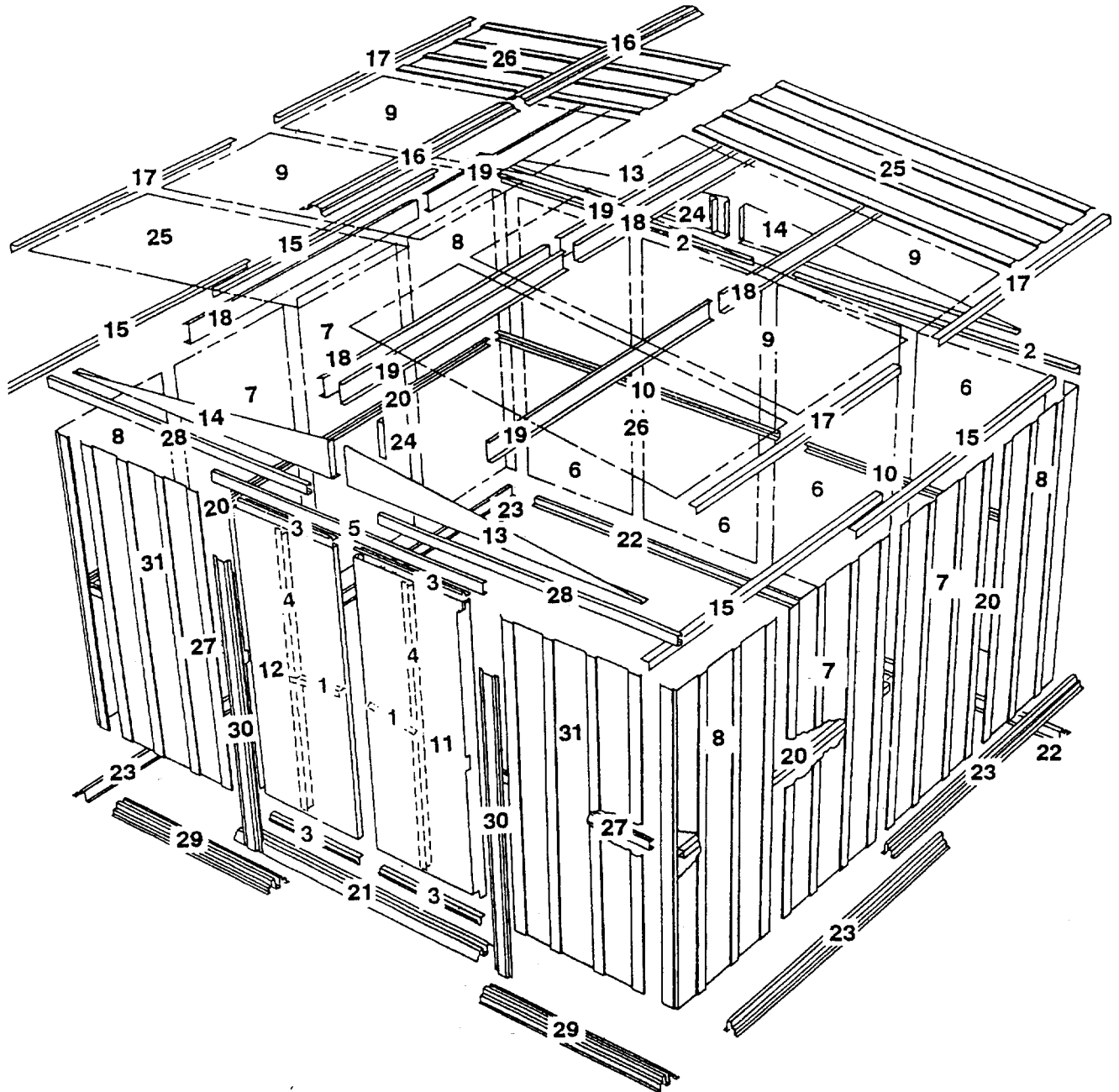

P/07  
PLAN

198

A-Proposed  
Shed

