

# DISPLAY THIS CARD ON PRINCIPAL FRONTAGE OF WORK CITY OF PORTLAND

## BUILDING INSPECTION PERMIT

Permit Number: 090706

Please Read Application And Notes, If Any, Attached

This is to certify that ROTHENBERG DEBRA A & RICHARD B PETERSON JTS/prop  
has permission to Installation of 400 sqft Attached Deck  
AT 93 WINDING WAY CBL 225 C024001

provided that the person or persons, firm or corporation accepting this permit shall comply with all of the provisions of the Statutes of Maine and of the Ordinances of the City of Portland regulating the construction, maintenance and use of buildings and structures, and of the application on file in this department.

Apply to Public Works for street line and grade if nature of work requires such information.

Notification of inspection must be given and written permission procured before this building or part thereof is lathed or otherwise closed-in. 24 HOUR NOTICE IS REQUIRED.

A certificate of occupancy must be procured by owner before this building or part thereof is occupied.

PERMIT ISSUED

OTHER REQUIRED APPROVALS	
Fire Dept.	<u>JUL 8 2009</u>
Health Dept.	
Appeal Board	
Other	

CITY OF PORTLAND

Department Name

*[Signature]*  
Director - Building & Inspection Services

PENALTY FOR REMOVING THIS CARD

*Closed-out scan notes.*

SCANNED

**City of Portland, Maine - Building or Use Permit Application**

389 Congress Street, 04101 Tel: (207) 874-8703, Fax: (207) 874-8716

Permit No: 09-0706	Issue Date: 7/8/09	CBL: 225 C024001
-----------------------	-----------------------	---------------------

Location of Construction: 93 WINDING WAY	Owner Name: ROTHENBERG DEBRA A & RIC	Owner Address: 93 WINDING WAY	Phone: 207-774-0733
Business Name:	Contractor Name: property owner	Contractor Address:	Phone:
Lessee/Buyer's Name	Phone:	Permit Type: Additions - Dwellings	Zone:

Past Use: Single Family Home	Proposed Use: Single Family Home - Installation of 400 sqft Attached Deck	Permit Fee: \$50.00	Cost of Work: \$3,000.00	CEO District: 3
---------------------------------	--	------------------------	-----------------------------	--------------------

Proposed Project Description: Installation of 400 sqft Attached Deck	FIRE DEPT: <input type="checkbox"/> Approved <input type="checkbox"/> Denied	INSPECTION: Use Group: R-3 Type 5B IRC-2003
	Signature:	Signature: <i>CE</i>
PEDESTRIAN ACTIVITIES DISTRICT (P.A.D.)		
Action: <input type="checkbox"/> Approved <input type="checkbox"/> Approved w/Conditions <input type="checkbox"/> Denied		
Signature:		Date:

Permit Taken By: lmd	Date Applied For: 07/08/2009	<b>Zoning Approval</b>
-------------------------	---------------------------------	------------------------

- This permit application does not preclude the Applicant(s) from meeting applicable State and Federal Rules.
- Building permits do not include plumbing, septic or electrical work.
- Building permits are void if work is not started within six (6) months of the date of issuance. False information may invalidate a building permit and stop all work..

Special Zone or Reviews	Zoning Appeal	Historic Preservation
<input type="checkbox"/> Shoreland	<input type="checkbox"/> Variance	<input type="checkbox"/> Not in District or Landmark
<input type="checkbox"/> Wetland	<input type="checkbox"/> Miscellaneous	<input checked="" type="checkbox"/> Does Not Require Review
<input type="checkbox"/> Flood Zone	<input type="checkbox"/> Conditional Use	<input type="checkbox"/> Requires Review
<input type="checkbox"/> Subdivision	<input type="checkbox"/> Interpretation	<input type="checkbox"/> Approved
<input type="checkbox"/> Site Plan <i>O.K.</i>	<input type="checkbox"/> Approved	<input type="checkbox"/> Approved w/Conditions
Maj <input type="checkbox"/> Minor <input type="checkbox"/> MM <input type="checkbox"/>	<input type="checkbox"/> Denied	<input type="checkbox"/> Denied
Date: <i>CE 7/8</i>	Date:	Date: <i>ce</i>

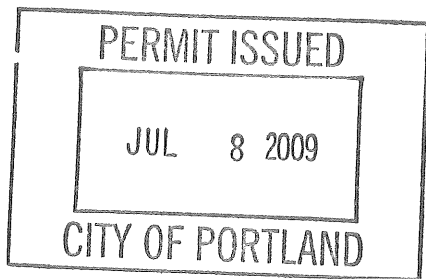

**CERTIFICATION**

I hereby certify that I am the owner of record of the named property, or that the proposed work is authorized by the owner of record and that I have been authorized by the owner to make this application as his authorized agent and I agree to conform to all applicable laws of this jurisdiction. In addition, if a permit for work described in the application is issued, I certify that the code official's authorized representative shall have the authority to enter all areas covered by such permit at any reasonable hour to enforce the provision of the code(s) applicable to such permit.

\_\_\_\_\_  
SIGNATURE OF APPLICANT ADDRESS DATE PHONE

\_\_\_\_\_  
RESPONSIBLE PERSON IN CHARGE OF WORK, TITLE DATE PHONE

**City of Portland, Maine - Building or Use Permit**

389 Congress Street, 04101 Tel: (207) 874-8703, Fax: (207) 874-8716

<b>Permit No:</b> 09-0706	<b>Date Applied For:</b> 07/08/2009	<b>CBL:</b> 225 C024001
------------------------------	--	----------------------------

<b>Location of Construction:</b> 93 WINDING WAY	<b>Owner Name:</b> ROTHENBERG DEBRA A & RIC	<b>Owner Address:</b> 93 WINDING WAY	<b>Phone:</b> 207-774-0733
<b>Business Name:</b>	<b>Contractor Name:</b> property owner	<b>Contractor Address:</b>	<b>Phone:</b>
<b>Lessee/Buyer's Name</b>	<b>Phone:</b>	<b>Permit Type:</b> Additions - Dwellings	

<b>Proposed Use:</b> Single Family Home - Installation of 400 sqft Attached Deck	<b>Proposed Project Description:</b> Installation of 400 sqft Attached Deck
---	--

**Dept:** Zoning      **Status:** Approved with Conditions      **Reviewer:** Chris Hanson      **Approval Date:** 07/08/2009

**Note:** **Ok to Issue:**

- 1) This property shall remain a single family dwelling. Any change of use shall require a separate permit application for review and approval.

**Dept:** Building      **Status:** Approved with Conditions      **Reviewer:** Chris Hanson      **Approval Date:** 07/08/2009

**Note:** **Ok to Issue:**

- 1) The doors entering the pool area must be alarmed or must meet section AG105 of the IRC2003
- 2) Permit approved based on the plans submitted and reviewed w/owner/contractor, with additional information as agreed on and as noted on plans.
- 3) Frost protection must be installed per the enclosed detail as discussed w/owner/contractor.
- 4) Application approval based upon information provided by applicant. Any deviation from approved plans requires separate review and approval prior to work.

7/15/09 -

Footings Inspection and Setbacks - O.K. to pour  
New Layout approved by C.S.H. 7/15/09

 1 Post uses a granite  
Footings (Lg. Rock 4' below New  
Grade - O.K.) well  
drained

8/24/09 - Final Inspection of  
Deck and Pool Areas.

O.K.



Close-out

# BUILDING PERMIT INSPECTION PROCEDURES

Please call 874-8703 or 874-8693 (ONLY)

to schedule your inspections as agreed upon

Permits expire in 6 months, if the project is not started or ceases for 6 months.

The Owner or their designee is required to notify the inspections office for the following inspections and provide adequate notice. Notice must be called in 48-72 hours in advance in order to schedule an inspection:

By initializing at each inspection time, you are agreeing that you understand the inspection procedure and additional fees from a "Stop Work Order" and "Stop Work Order Release" will be incurred if the procedure is not followed as stated below.

A Pre-construction Meeting will take place upon receipt of your building permit.

  X   Footing/Building Location Inspection: Prior to pouring concrete or setting precast piers

  X   ~~Framing/Rough Plumbing/Electrical: Prior to Any Insulating or drywalling~~

  X   Final inspection required at completion of work.

Certificate of Occupancy is not required for certain projects. Your inspector can advise you if your project requires a Certificate of Occupancy. All projects DO require a final inspection.

**If any of the inspections do not occur, the project cannot go on to the next phase, REGARDLESS OF THE NOTICE OR CIRCUMSTANCES.**

**CERIFICATE OF OCCUPANICES MUST BE ISSUED AND PAID FOR, BEFORE THE SPACE MAY BE OCCUPIED.**

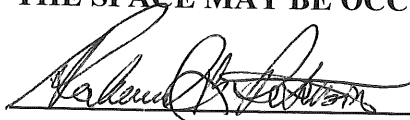
  
\_\_\_\_\_  
Signature of Applicant/Designee

  
\_\_\_\_\_  
Date

\_\_\_\_\_  
Signature of Inspections Official

\_\_\_\_\_  
Date



# General Building Permit Application

I/you, as the property owner, owner, lessee, or person in charge of any property, within the City of Portland, Oregon, hereby apply for a building permit for the above described work.

Location/Address of Construction: 93 Winding Way Portland, ME 04102

Total Square Footage of Proposed Structure/Area: ± 400 Sq. Ft. Deck Square Footage of Lot: 26,000 Number of Stories: 1

Tax Assessor's Chart, Block & Lot  
Chart# 225 Block# C Lot# 024  
Applicant \*must be owner, Lessee or Buyer\*  
Name Rick Peterson  
Address 93 Winding Way  
City, State & Zip Portland, ME 04102  
Telephone: (207) 774-0733

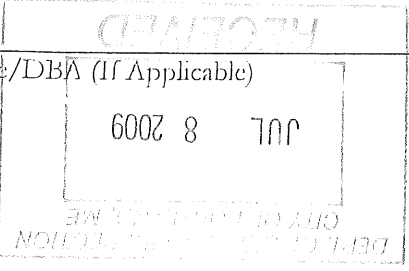

Lessee/DBA (if Applicable)  
6002 8 700  
Owner (if different from Applicant)  
Name \_\_\_\_\_  
Address \_\_\_\_\_  
City, State & Zip \_\_\_\_\_  
Cost Of Work: \$ 3000.00  
C of O Fee: \$ \_\_\_\_\_  
Total Fee: \$ \_\_\_\_\_

Current legal use (i.e. single family) Single family residence Number of Residential Units 1  
If vacant, what was the previous use? \_\_\_\_\_  
Proposed Specific use: \_\_\_\_\_  
Is property part of a subdivision? \_\_\_\_\_ If yes, please name \_\_\_\_\_  
Project description: ± 400 sq. ft. deck

Contractor's name: owner built w/ Consulting help from Great Northern Carpentry, Len Bugh  
Address: \_\_\_\_\_  
City, State & Zip \_\_\_\_\_ Telephone: (207) 774-0733 (home)  
Who should we contact when the permit is ready: Rick Peterson Telephone: (207) 712-0134 (cell)  
Mailing address: \_\_\_\_\_

Please submit all of the information outlined on the applicable Checklist. Failure to do so will result in the automatic denial of your permit.

In order to be sure the City fully understands the full scope of the project, the Planning and Development Department may request additional information prior to the issuance of a permit. For further information or to download copies of this form and other applications visit the Inspections Division on-line at [www.portlandmaine.gov](http://www.portlandmaine.gov), or stop by the Inspections Division office, room 315 City Hall or call 874-8703.

I hereby certify that I am the Owner of record of the named property, or that the owner of record authorizes the proposed work and that I have been authorized by the owner to make this application as his/her authorized agent. I agree to conform to all applicable laws of this jurisdiction. In addition, if a permit for work described in this application is issued, I certify that the Code Official's authorized representative shall have the authority to enter all areas covered by this permit at any reasonable hour to enforce the provisions of the codes applicable to this permit.

Signature: Rick Peterson Date: July 8, 2009

This is not a permit; you may not commence ANY work until the permit is issued.

# PETERSON DECK

RAILS: (STAIR RAILS ARE BUILT IN SAME STYLE)

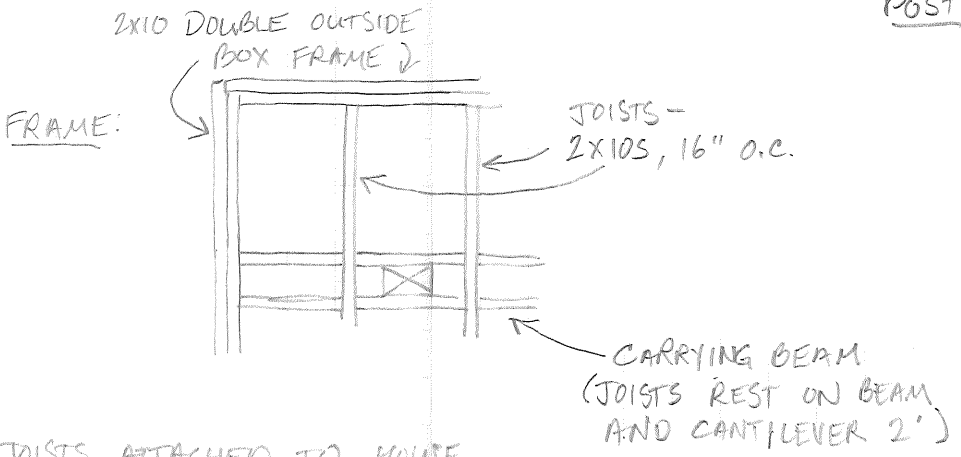
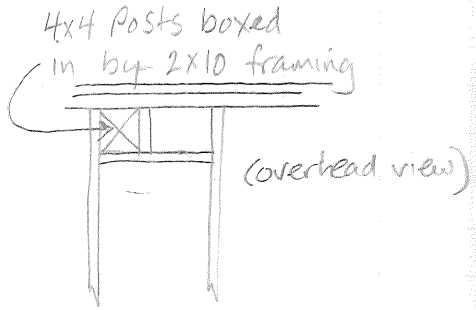
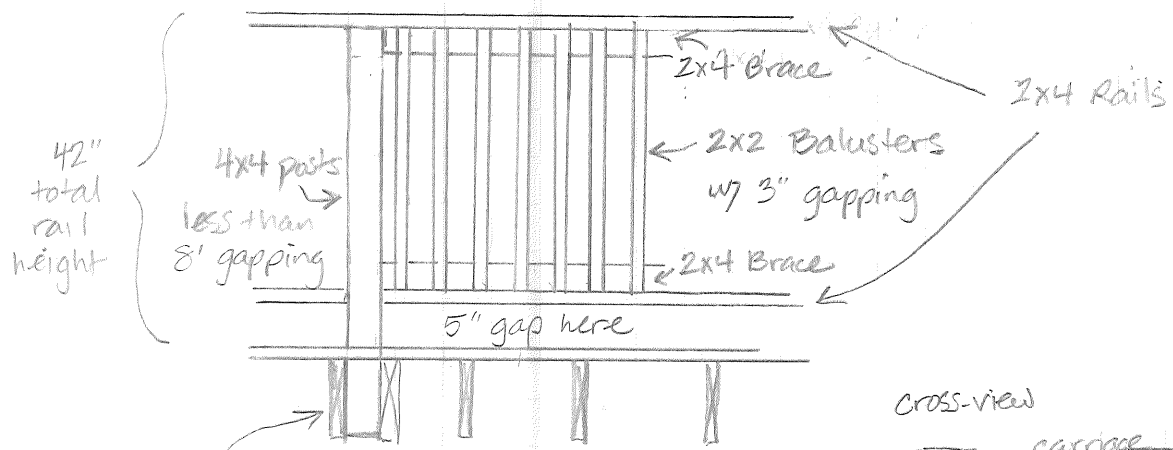

JOISTS ATTACHED TO HOUSE WITH JOIST HANGERS, (LEDGER IS BOLTED & FLASHED TO HOUSE ALREADY)

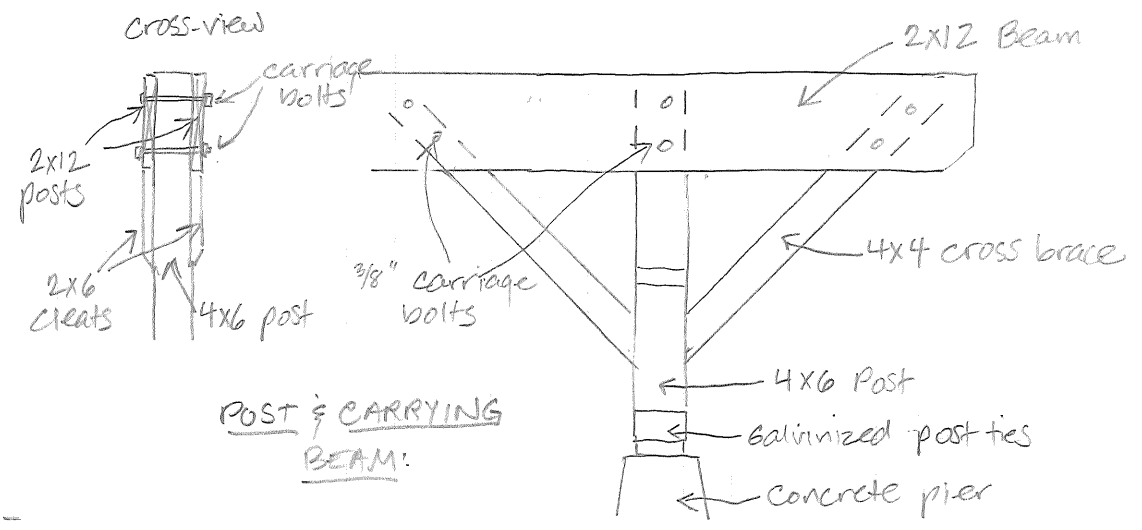
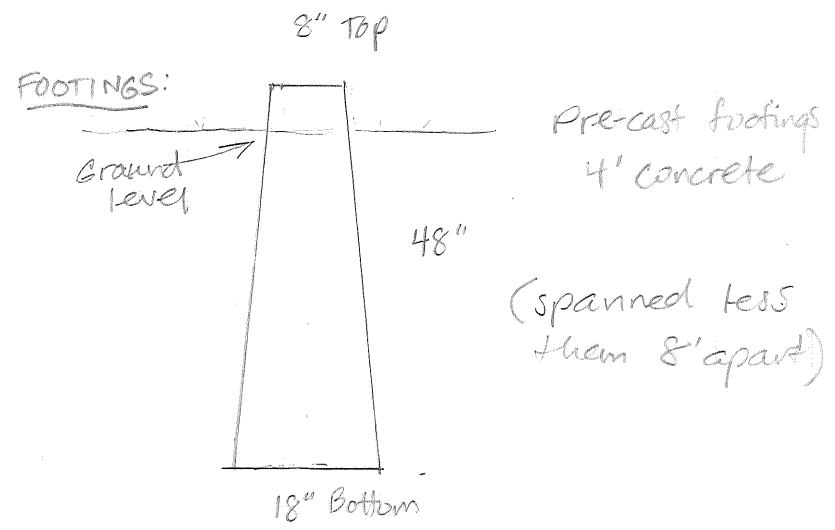

- NOTES:
- \* ALL FRAMING, DECKING, & RAILS ARE PT.
  - \* ALL FASTENERS ARE COMPLIANT WITH NEW PRESSURE TREATED WOOD
  - \* STAIR RISE/RUN IS 7"/11"; BASE OF STAIRS SET ON PAVER PATIO

STAIRS TO PATIO

See sht. SK9

- \* STAIR RAILING CONSTRUCTION IDENTICAL TO THAT ON DECK
- \* TREADS MADE FROM DECKING MATERIAL

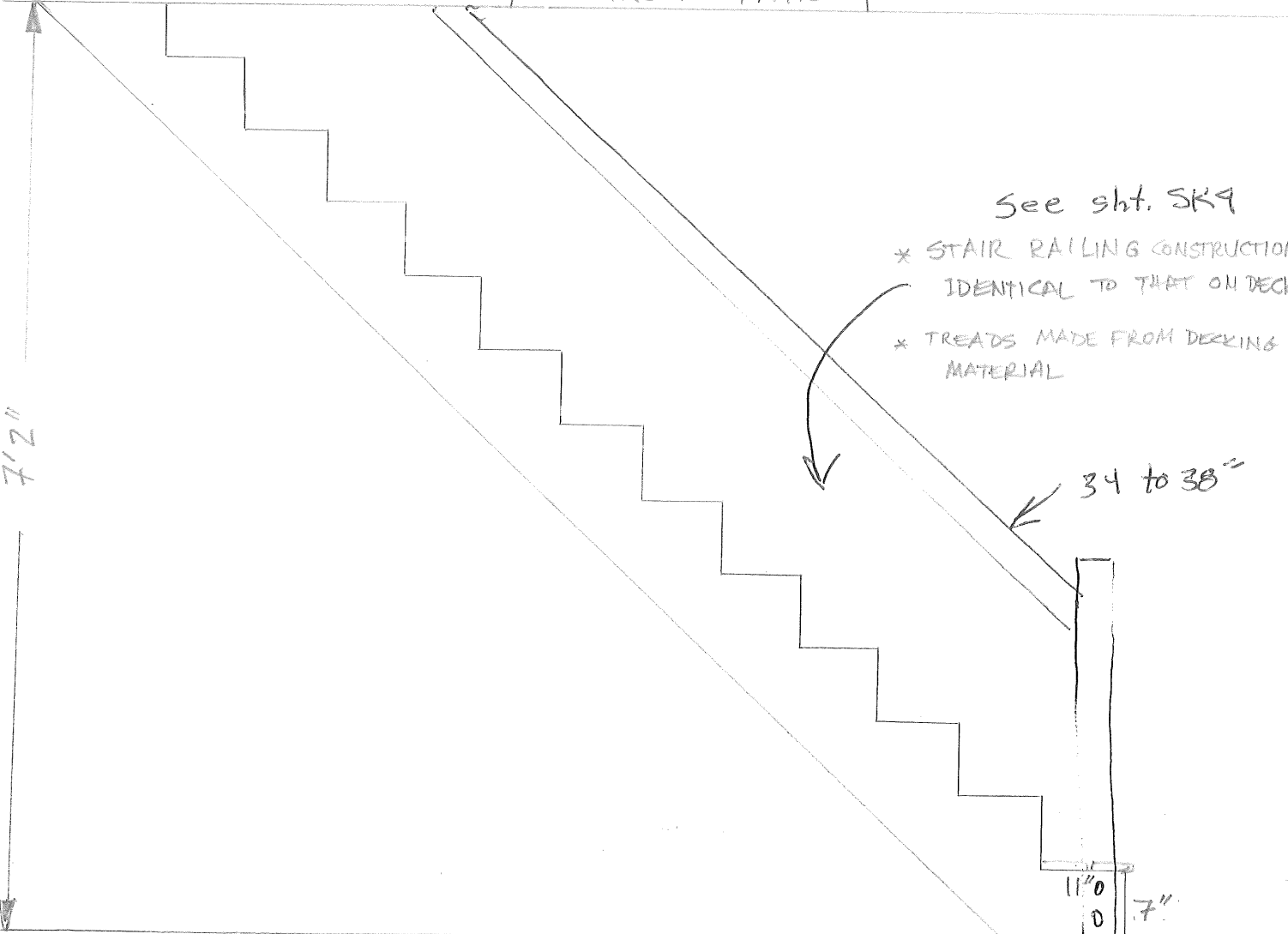

DECK ADDITION - STAIR DETAILS

CLAY BRICK PATIO PAVER

BRICK SETTING SAND

6+'' BASE MATERIAL

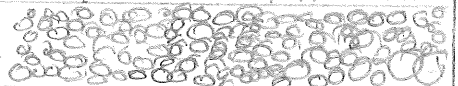

SK wing No.

DECK ADDITION STAIR DETAILS

ROTHENBERG/PETERSON RESIDENCE

JULY 8, 2009

93 WINDING WAY PORTLAND, MAINE 04102



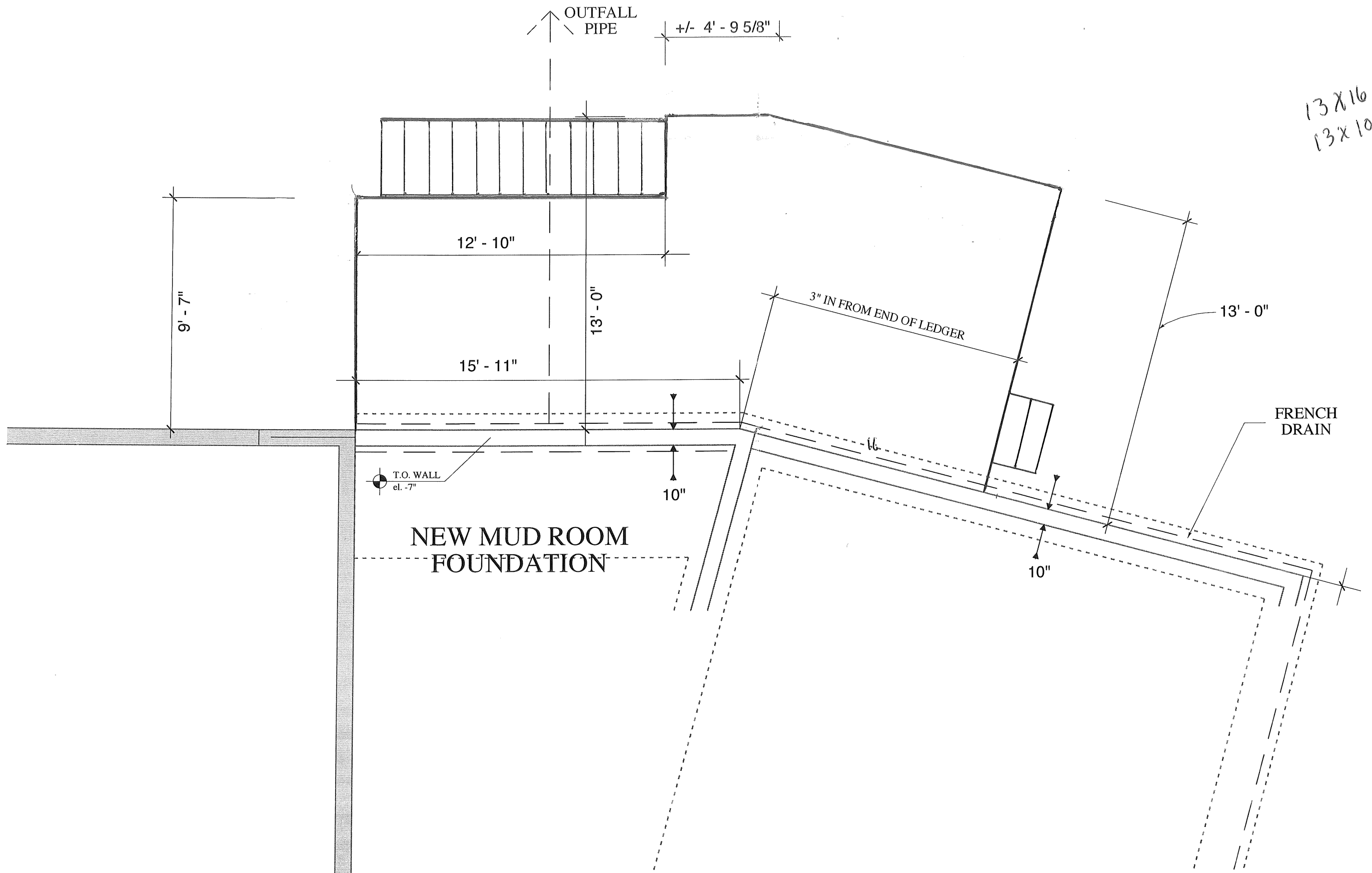

DAVID HEMBRE - ARCHITECT  
45 CASCO STREET  
PORTLAND, MAINE 04105  
(207) 699-2688

ISSUED FOR:	DATE:

ROTHENBERG/PETERSON  
**RESIDENCE**  
93 WINDING WAY  
PORTLAND, ME  
DMA PROJ. # 2801

SONO TUBE LOCATIONS  
SCALE: 1/4" = 1'

**SK 1**

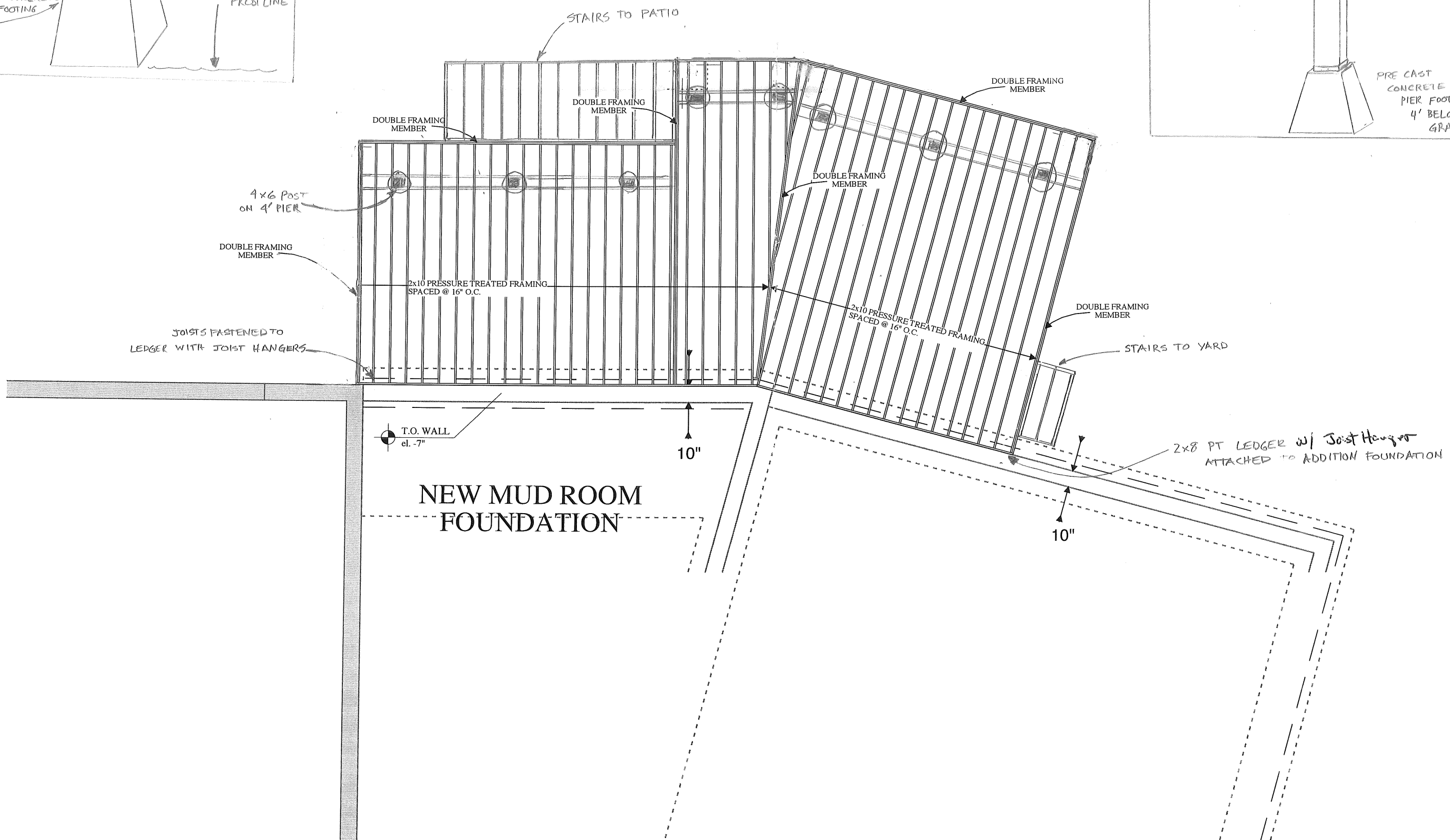
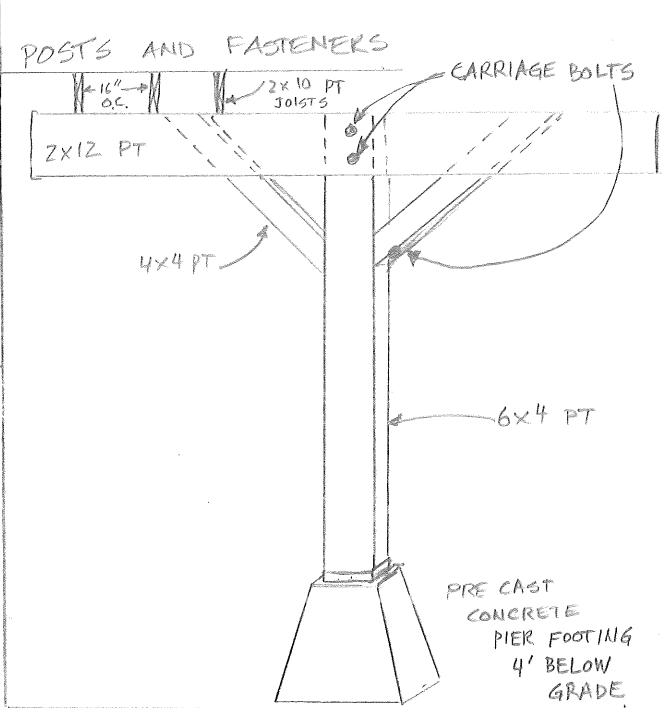
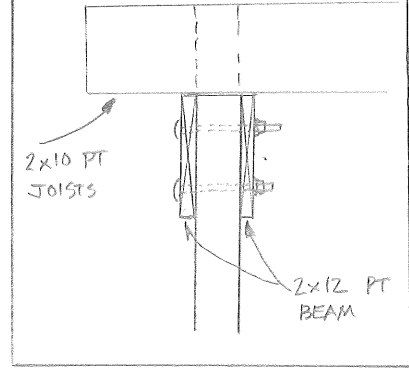
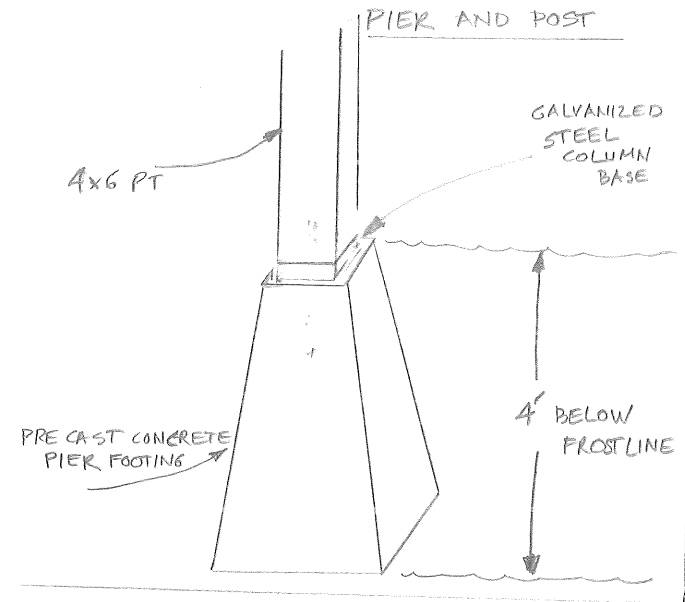

DAVID HEMBRE - ARCHITECT 45 CASCO STREET PORTLAND MAINE 04105 (207) 699-2688	
ISSUED FOR:	PRICING
DATE:	
ROTHENBERG/PETERSON RESIDENCE 93 WINDING WAY PORTLAND, ME DEA PROJ. # 20801	
FRAMING LAYOUT SCALE: 1/4" = 1'	
SK 2 DRAWING NO.	