

MAINE ORTHOPAEDICS CENTER
1601 CONGRESS STREET

WHIPPLE
CALLENDER
ARCHITECTS

551 CONGRESS
STREET
PORTLAND
ME 04101
775-2656

DATE 10/6/04
PROJECT
NUMBER
SCALE 1/8" or 1/4"
DRAWN JWW
CHECKED
REVISED
CONTENTS
FIRST
FLOOR
PLAN

SHEET of
A4

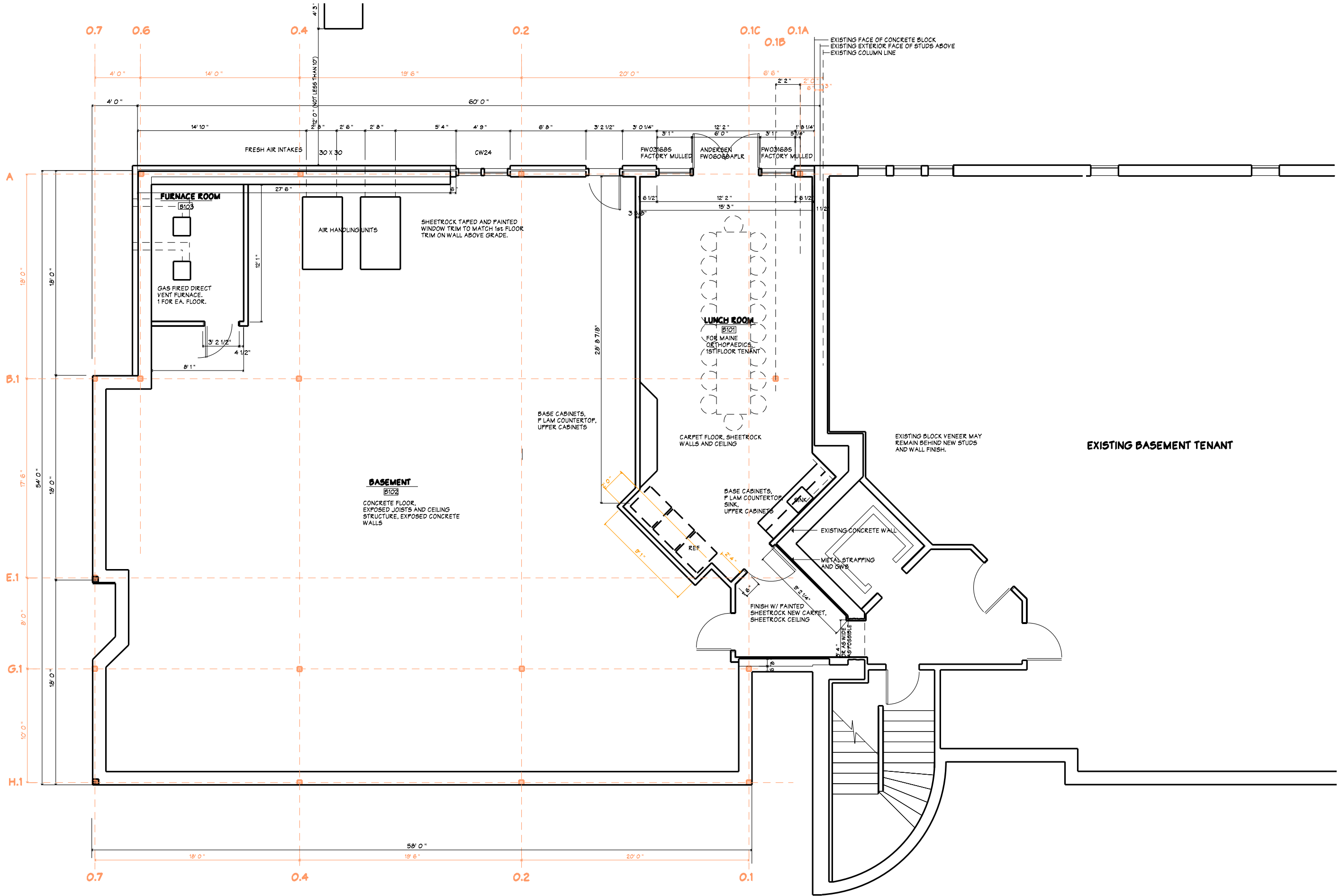

1 BASEMENT PLAN
A4 SCALE 1/4" = 1'