

**BUILDING SYSTEMS:**

**ROOF SYSTEM**

240# ARCHITECTURAL SHINGLE  
 ICE AND WATER SHIELD ENTIRE ROOF  
 X CDX T&G PLYWD SHEATHING  
 ALUMINUM DRIP EDGE  
 2 X 10S @ 16" O.C.  
 3:12 ROOF PITCH

**CEILING SYSTEM**

MINIMUM R-30 BATT INSULATION  
 6 MIL POLY VAPOR RETARDER  
 1 X 3 STRAPPING 16" O.C.  
 X GWB, PTD

**EXTERIOR WALL SYSTEM**

WOOD CEDAR SHAKE SHINGLES ON WALL NOTED  
 FINISH TO MATCH EXISTING  
 TYPAR HOUSE WRAP  
 X CDX  
 2 X 8 @ 16" O.C. (DBL @ PARALLEL CABINETS & BLK @ PERPENDICULAR CABINETS)  
 MIN R-19 BATT INSULATION  
 6 MIL POLY VAPOR RETARDER  
 X GWB, PTD

**FLOOR SYSTEM**

FINISH FLOOR MATERIAL - OWNER/ARCHITECT  
 TO DETERMINE  
 X T&G PLYWOOD  
 2 X 8 @ 16" O.C.  
 6 MIL POLY VAPOR RETARDER  
 MIN R-19 BATT INSULATION PLUS  
 2" RIGID INSULATION FASTENED TO UNDERSIDE  
 OF JOIST

**FOUNDATION**

8" REINFORCED CONCRETE WALL - HANDRUBBED  
 GROUT FINISH (SEE PLAN)  
 24"W X 12" DEEP FTG. TYP.  
 DAMPPROOFING  
 2" RIGID INSULATION ON INSIDE FACE

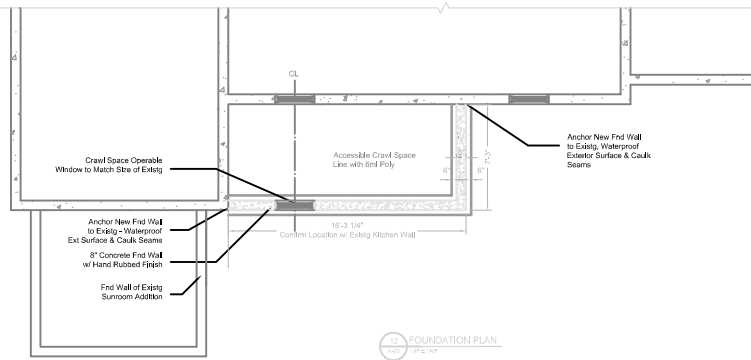
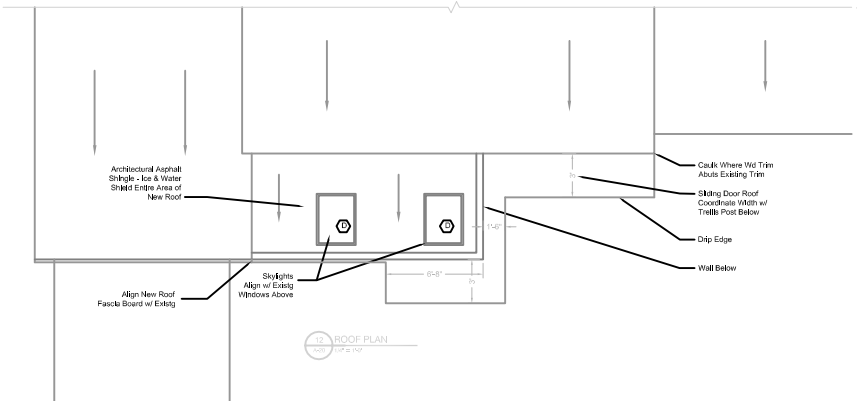

**ARCADIA**  
 designworks LLC  
 142 High Street, Suite 506  
 Portland, Maine 04101  
 tele.: 207.347.5252  
 c.p.: 207.749.9306  
 fax: 207.791.2848  
 ARCADIA@awcvt.net

**ResurgencE**  
 Engineering & Preservation, Inc.  
 132 Brentwood Street  
 Portland, ME 04103  
 V/F (207) 773-6800  
 resurgencE@verizon.net

- General Notes:**
- Dimensions shown are approximations that the Contractor should field verify.
  - As-built conditions may vary upon further inspection of walls, floors and ceiling cavities.
  - Kitchen and deck design shown only for planning purposes and are not to be constructed from these documents.
  - Contractor to coordinate re-routing of plumbing pipe, heating system, electrical circuits, outlets and wiring of all appliances. Architect to provide lighting schedule based on Owner selections.
  - Paint selection and color to be provided by Architect based on Owner selections.
  - Provide appropriate wood blocking for all wall-mounted items including but not limited to grab bars, shelves, cabinets and fixtures.

**REVISIONS:**  
 Preliminary Review Set - July 20, 2005  
 Construction Set - September 9, 2005

**PROJECT:**  
 Kramer Residence  
 57 Machigonne Street  
 Portland, Maine  
 July 2005

**CONSTRUCTION SET**

SCALE	1/4" = 1'-0"
DATE	

**Plans**

**A-20**