

### FIRE ALARM LEGEND

- P FIRE ALARM MANUAL PULL STATION - MOUNT 52" AFF TO TOP OF BOX
- F FIRE ALARM HORN AND STROBE UNIT - MOUNT 84" AFF TO TOP OF BOX OR 6" BELOW CEILING, WHICH EVER IS LOWER
- ◇ FIRE ALARM STROBE UNIT - MOUNT ABOVE DOOR - MOUNT 84" AFF TO BOTTOM OF BOX OR 6" BELOW CEILING, WHICH EVER IS LOWER
- S SMOKE DETECTOR - CEILING MOUNTED
- H HEAT DETECTOR - CEILING MOUNTED
- KB KNOX BOX - MOUNT CENTER OF BOX 5' AFG
- ▨ FIRE ALARM ANNUCIATOR PANEL - MOUNT CENTER OF BOX 5'-6" AFF

### EXIT & EMERGENCY LEGEND

- ⊗ EXIT SIGN - WALL MOUNTED
- ⊙ EXIT SIGN - CEILING MOUNTED
- ⬆ EMERGENCY LIGHT FIXTURES W/ BATTERY PACK - MOUNTED 84" AFF TO TOP OF BOX OR 6" BELOW CEILING, WHICH EVER IS LOWER
- ◇ EMERGENCY LIGHT REMOTE FIXTURES 84" AFF TO TOP OF BOX OR 6" BELOW CEILING, WHICH EVER IS LOWER

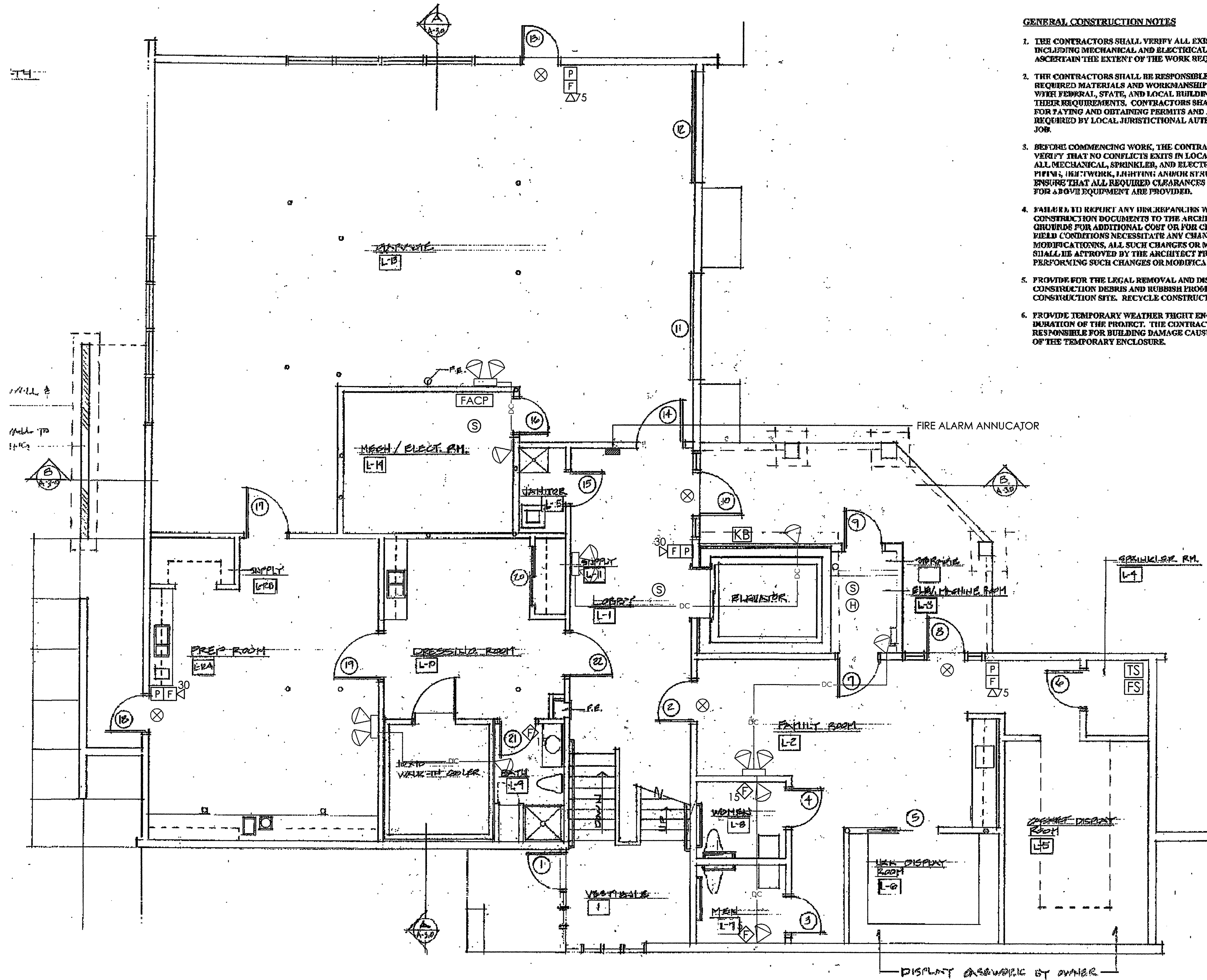

### GENERAL CONSTRUCTION NOTES

1. THE CONTRACTORS SHALL VERIFY ALL EXISTING CONDITIONS INCLUDING MECHANICAL AND ELECTRICAL CONDITIONS ASCERTAIN THE EXTENT OF THE WORK REQUIRED.
2. THE CONTRACTORS SHALL BE RESPONSIBLE FOR PROVIDING REQUIRED MATERIALS AND WORKMANSHIP IN ACCORDANCE WITH FEDERAL, STATE, AND LOCAL BUILDING CODES AND THEIR REQUIREMENTS. CONTRACTORS SHALL BE RESPONSIBLE FOR PAYING AND OBTAINING PERMITS AND APPROVALS AS REQUIRED BY LOCAL JURISDICTIONAL AUTHORITIES FOR THIS JOB.
3. BEFORE COMMENCING WORK, THE CONTRACTORS SHALL VERIFY THAT NO CONFLICTS EXIST IN LOCATIONS OF ANY ALL MECHANICAL, SPRINKLER, AND ELECTRICAL, INCLUDING PIPING, HEATWORK, FIGHTING APPLIANCE, ETC. TO ENSURE THAT ALL REQUIRED CLEARANCES OR INSTALLATIONS FOR ABOVE EQUIPMENT ARE PROVIDED.
4. FAILURE TO REPORT ANY DISCREPANCIES WITH THESE CONSTRUCTION DOCUMENTS TO THE ARCHITECT WILL INCREASE FOR ADDITIONAL COST OR FOR CHANGE ORDER. MODIFICATIONS, ALL SUCH CHANGES OR MODIFICATIONS SHALL BE APPROVED BY THE ARCHITECT PRIOR TO PERFORMING SUCH CHANGES OR MODIFICATIONS.
5. PROVIDE FOR THE LEGAL REMOVAL AND DISPOSAL OF ALL CONSTRUCTION DEBRIS AND RUBBISH FROM THE BUILDING CONSTRUCTION SITE. RECYCLE CONSTRUCTION DEBRIS.
6. PROVIDE TEMPORARY WEATHER TIGHT ENCLOSURES BY DIRECTION OF THE PROJECT. THE CONTRACTOR SHALL BE RESPONSIBLE FOR BUILDING DAMAGE CAUSED BY THE FAILURE OF THE TEMPORARY ENCLOSURE.

**Anthony Mancini, Inc.**  
 179 SHERIDAN ST.  
 PORTLAND, ME 04101  
 P: (207) 774-5829 F: (207) 772-1886  
 E: info@anthonycmancini.com  
 "We appreciate Your Business."

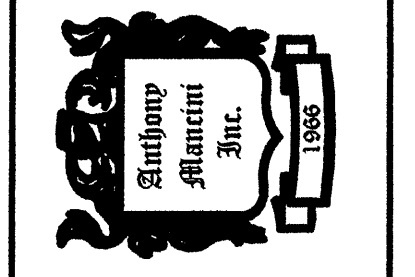

NO.	DATE	DESCRIPTION

PROJECT NAME & ADDRESS:  
 Hutchins Funeral Home  
 660 Brighton Ave  
 Portland, Maine

SHEET NAME:  
 Lower Level  
 Life-Safety Layout

Checked By: G. MANCINI Date: 08.18.2009  
 Drawn By: A. AMES Scale: 1/4" = 1'-0"

SHEET:  
**ELS1**