

- SECOND FLOOR PLAN**
- BEDROOM WINDOW MEETS EGRESS CODES - 6.0 SQ. FT. CLEAR OPENING
 - DUE TO DEEPER FLOOR JOISTS AND POSSIBLE HIGHER FIRST FLOOR CEILING - THERE WILL PROBABLY BE A STEP DOWN TO ATTIC FLOOR.

- PROPOSED FLOOR PLAN**
- ALL ANGLES AT 45°
 - BEDROOM WINDOWS MEET EGRESS CODES - (MINIMUM 5.7 SQ. FT. OF CLEAR OPENING)
 - EXISTING CEILING HEIGHT IS 7'-8 1/2" ±
POSSIBLY HAVE NEW CEILING HEIGHTS 8' - ALL CEILING HEIGHTS MEET CODES.
 - INSTALL EXHAUST FANS IN BATHS.
 - SMOKE AND CARBON MONOXIDE ALARMS TO BE HARD WIRED.
 - DRIVER TO BE VENTED.

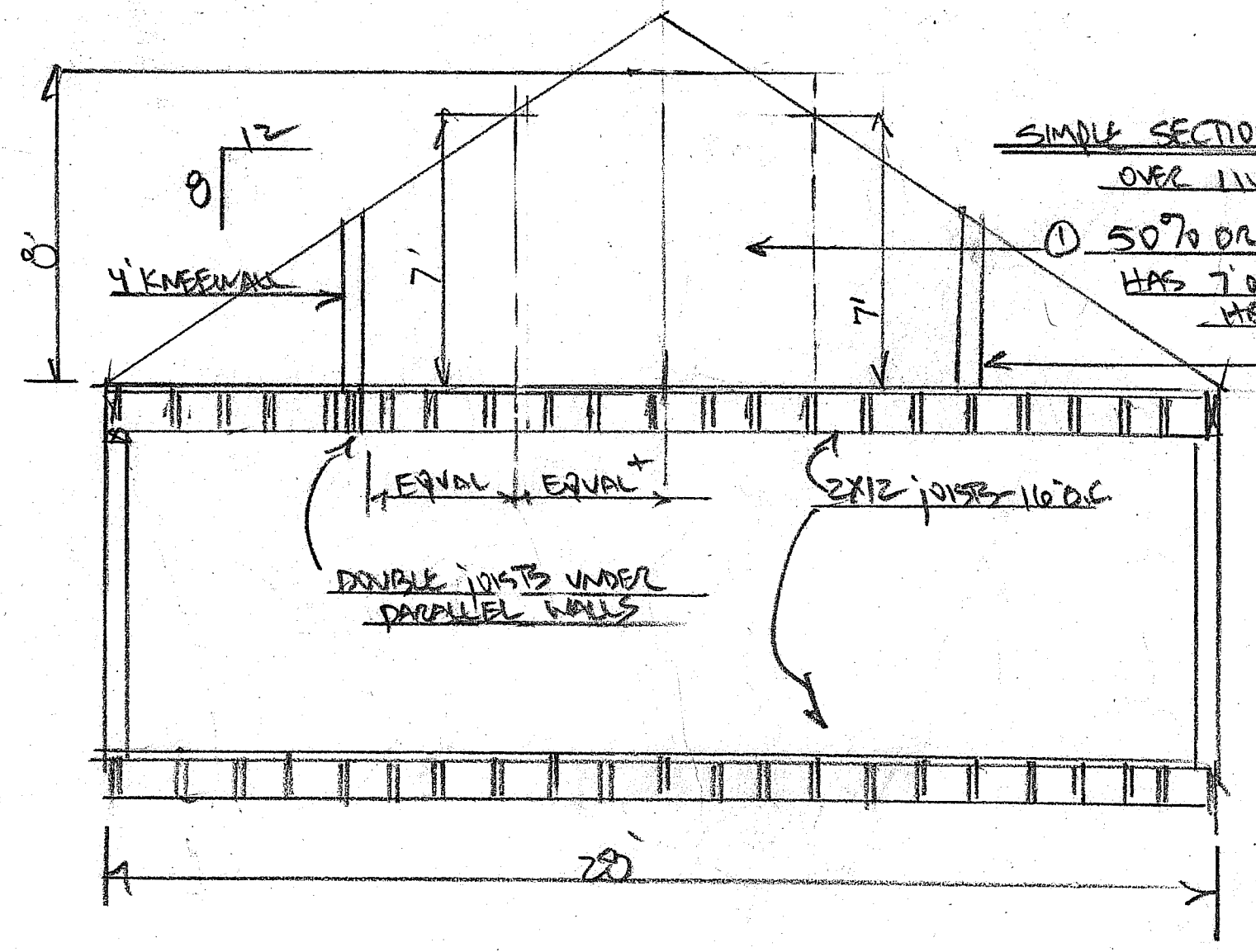

- SIMPLE SECTION OF BEDROOM #3 OVER LIVING AREA**
- 50% OR MORE OF BEDROOM HAS 7' OR MORE OF HEADROOM 4' KNEEWALL

CONTRACTOR:
WM WIGHT CONSTRUCTION
WIGHT_BILL@YAHOO.COM
207-318-3689

OWNERS: cell 332-2111
cell 415-9348

PLANS - TED AND LESLIE KAYNOR		
SCALE: 1/4" = 1'	APPROVED BY: 315 CASPIC ST.	DRAWN BY: SJK
DATE: 11/6/14		REVISED: 1/10/15
Phase II - Proposed Floor Plan		4/21/15 4/11/15
		4/18/15
DRAWING NUMBER		1 of 6
		8/16/15

16/10
670