

- SECOND FLOOR PLAN**
- BEDROOM WINDOW NEEDS EGRESS CODES - 6.0 SQ. FT. CLEAR OPENING
 - DUE TO DEEPER FLOOR JOISTS AND POSSIBLE HIGHER FIRST FLOOR CEILING - THERE WILL PROBABLY BE A STEP DOWN TO ATTIC FLOOR?

- PROPOSED FLOOR PLAN**
- ALL ANGLES AT 45°
 - BEDROOM WINDOWS MEET EGRESS CODES (MINIMUM 5.7 SQ. FT. OF CLEAR OPENING)
 - EXISTING CEILING HEIGHT IS 7'-8 1/2" ±
POSSIBLY HAVE NEW CEILING HEIGHTS 8' - ALL CEILING HEIGHTS MEET CODES
 - INSTALL EXHAUST FANS IN BATHS.
 - SMOKE AND CARBON MONOXIDE ALARMS TO BE HARD WIRED.
 - DRYER TO BE VENTED.

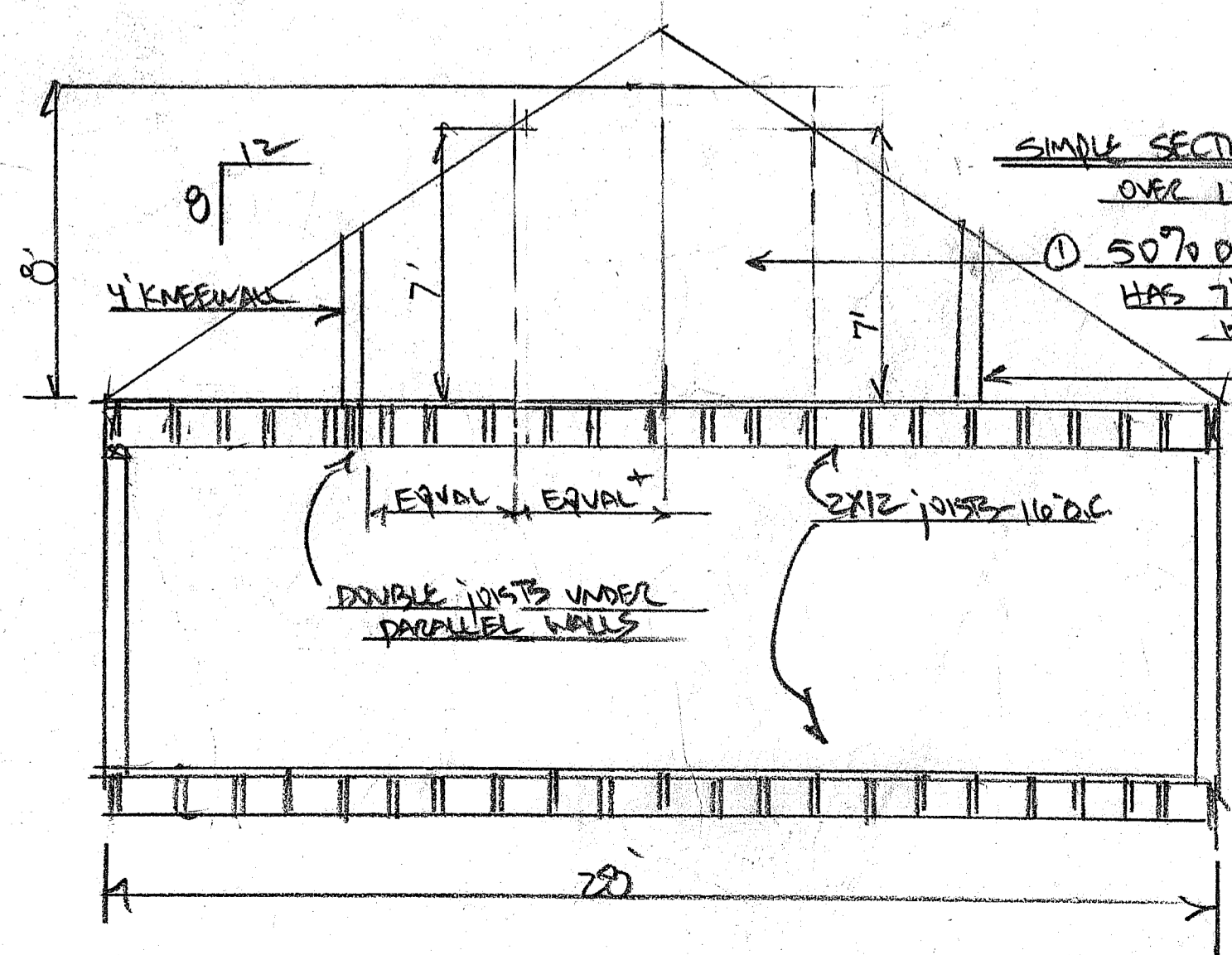

EXCAVATION - PAUL NAPOLITANO
 CAPPED ROOM @ MAINE.M.COM
 329-4412

SERGEY MIGNOV
 GEAR BUS CONTRACTOR
 329-9404
 S.M.C.MIGNOV@gmail.com

OWNERS: cell 332-2111
 cell 415-9348

PLANS - TED AND LESLIE KAUND		
SCALE: 1/4" = 1'	APPROVED BY: [Signature]	DRAWN BY: W. S. [Signature]
DATE: 11/11/15	315 CADISIC ST.	REVISED 11/10/15
Phase II - Proposed Floor Plan		4/21/15 411115
DRAWING NUMBER		4118115
		1 of 6