

- FOUNDATION PLAN**
- 1) FIN NEW WALL TO EXISTING FOUNDATION
 - 2) ALL 8" WALLS ON 8" X 16" CONTINUOUS FOOTING
 - 3) INSULATE INTERIOR OF HANG WALLS
 - 4) INSTALL DRAIN TILE INTERIOR AND EXTERIOR

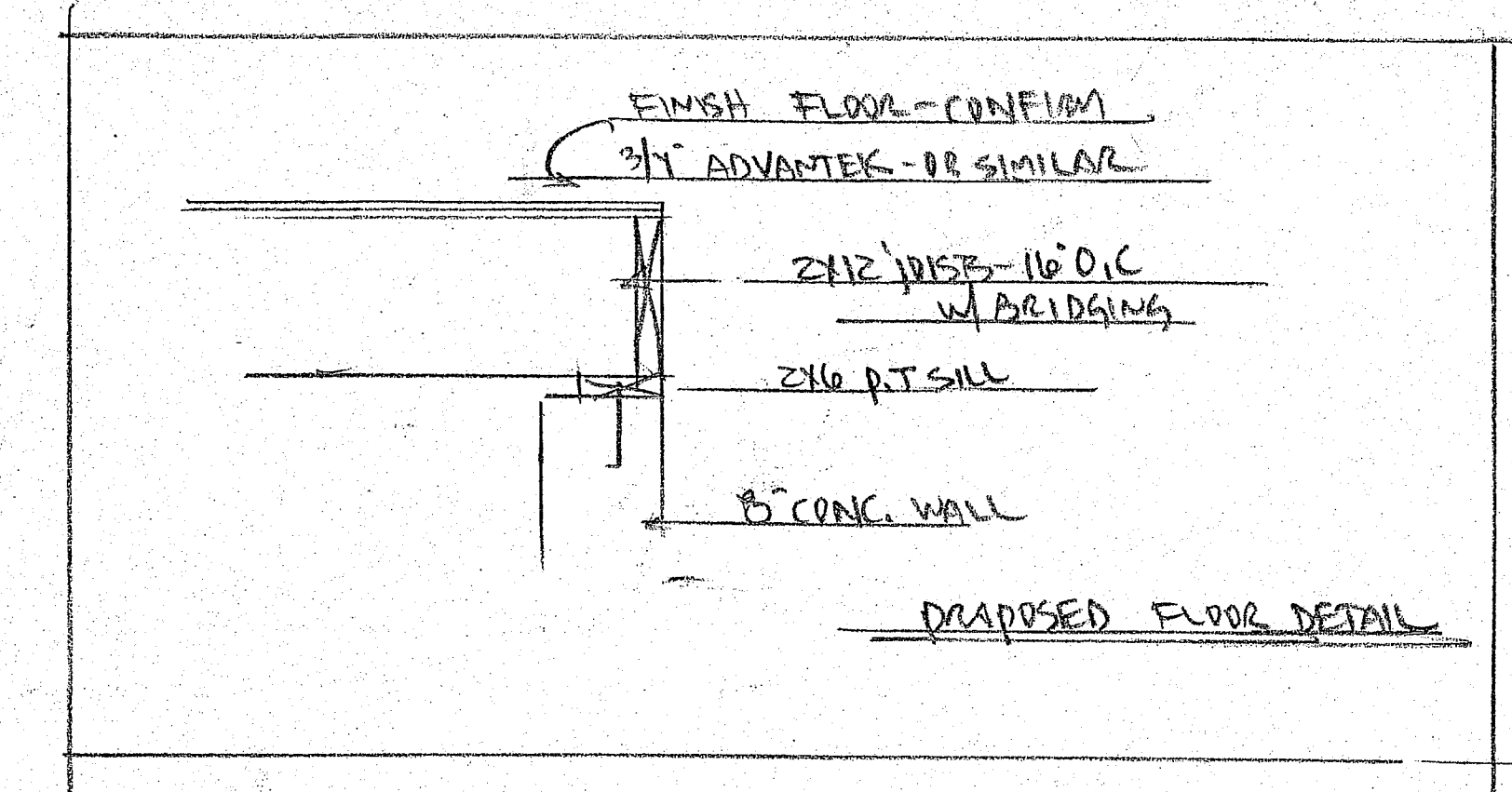
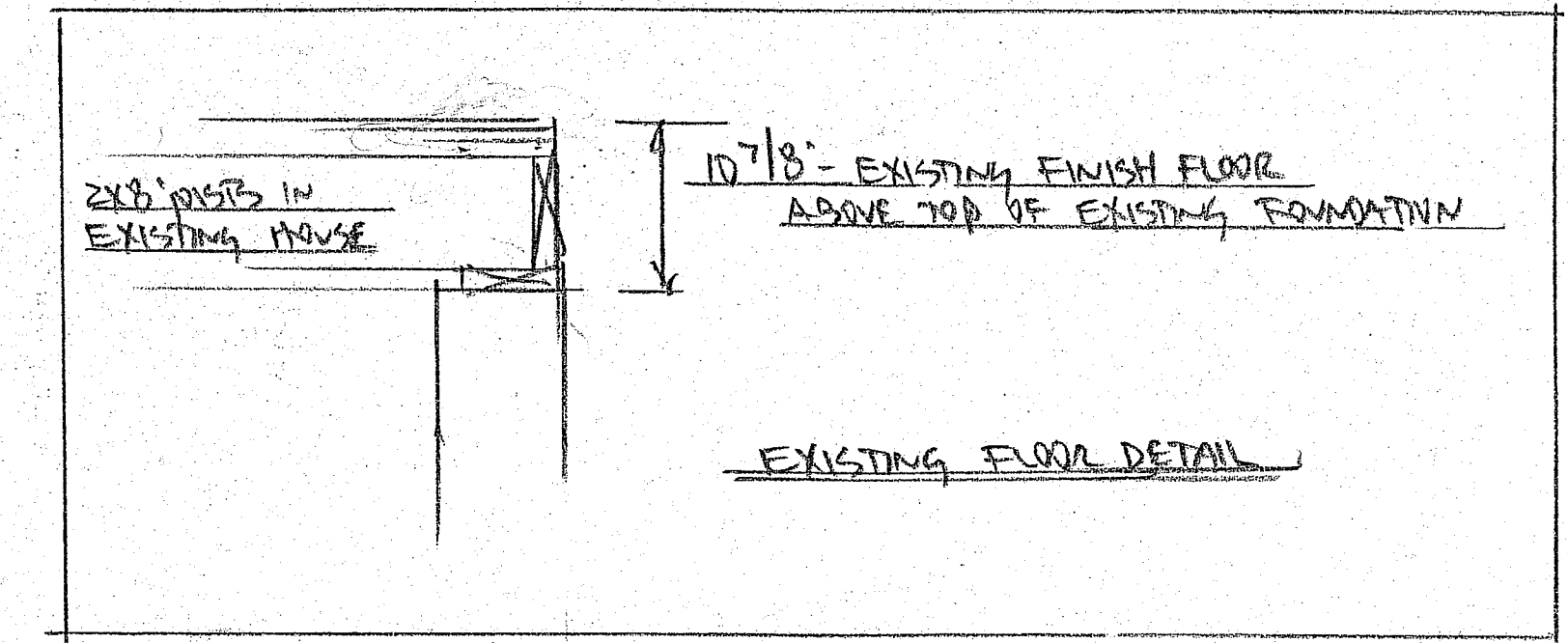

DUNS - TED + LESLIE KAYNOR		
SCALE: 1/4" = 1'	APPROVED BY: 315 CAPSIC ST.	DRAWN BY: W. Stora
DATE: 11/10/14		REVISED:
DRAWING NUMBER		3 of 3