



Reviewed for Code Compliance
 Permitting and Inspections Department
 Approved with Conditions
 12/31/2019

ELECTRICAL SPECIFICATIONS		UTILITIES			
QUANTITY	SPEC. NUMBER	DESCRIPTION	POWER	DETAIL	
				DEDICATED CIRCUIT	LOW VOLTAGE CONTROL DATA DROP
4	3A	UTILITY CENTER - SELF-CONTAINED WATER	115V		3A
4	4C	2" CONDUIT - PIPE CHASE WITH PULL-STRING SUPPLIED AND INSTALLED BY CONTRACTOR. RUN FROM ABOVE CEILING DOWN WALL AND BELOW SLAB TO JUNCTION BOX OR CABINET BASE AT LOCATIONS SHOWN. SWEEPING TO DEGREE BENDS ONLY. STUB-UP FLUSH WITH SUB-FLOOR. MARK LOCATION AT FINISH.			4C
4	5	DENTAL CHAIR RECEPTACLE - SUPPLIED & INSTALLED BY CONTRACTOR.	115V		5
1	6	DENTAL TRACK LIGHT - SUPPLIED AND INSTALLED BY HENRY SCHEIN DENTAL	115V		6
1	9B	X-RAY REMOTE EXPOSURE BUTTON - CONTRACTOR TO SUPPLY AND INSTALL PIPE CHASE WITH PULL-STRING TO (RA) OR (PC) LOCATION. VERIFY SUPPLIER OF EXPOSURE BUTTON AND WIRING WITH HENRY SCHEIN EQUIPMENT SPECIALIST. FINAL CONNECTION BY HENRY SCHEIN DENTAL.			9B
1	9C	PANORAMIC AND CEPHALOMETRIC XRAY UNIT - SUPPLIED AND INSTALLED BY HENRY SCHEIN DENTAL. REQUIRES A 3 WIRE GROUNDED CIRCUIT.	115V & 230V	20A (XZ)	9C
1	14	STERILIZER (SINGLE CASSETTE) - SUPPLIED AND INSTALLED BY HENRY SCHEIN DENTAL. VERIFY IF SWITCHED OUTLET IS REQ'D.	115V	20A	14A
1	14A	STERILIZER (AUTO-CLAVE) - SUPPLIED AND INSTALLED BY HENRY SCHEIN DENTAL. VERIFY IF SWITCHED OUTLET IS REQ'D.	115V	20A	14A
1	23A	EXHAUST FAN FOR DENTAL MECHANICAL CLOSET - SUPPLIED AND INSTALLED BY CONTRACTOR. A THERMOSTAT CONTROLLED FAN IS REQUIRED TO KEEP ROOM TEMPERATURE WITHIN THE EQUIPMENT MANUFACTURER'S RECOMMENDED OPERATING TEMPERATURE RANGE. FAN OUTPUT (CFM) TO BE DETERMINED BY ARCHITECT/ENGINEER. VENT TO OUTSIDE.	115V		
1	25	DENTAL AIR COMPRESSOR - SUPPLIED BY HENRY SCHEIN DENTAL. INSTALLED BY CONTRACTOR. FOR DENTAL AIR DRIVEN DEVICES. 1/2" LB. COPPER TYPE K OR L SUPPLY LINES TO LOCATIONS THAT REQUIRE AIR. BUCK BOOST TRANSFORMER SUPPLIED AND INSTALLED BY CONTRACTOR (IF REQ'D). FINAL CONNECTIONS BY CONTRACTOR. REFER TO NFPA 99 CODES RELATING TO CATEGORY 3 DENTAL FACILITIES.	230V	20A	25
1	26B	VACUUM PUMP (PHE) - SUPPLIED BY HENRY SCHEIN DENTAL. INSTALLED BY CONTRACTOR. 1.5"-2" MAIN TRUNK LINES. VERIFY TRUNK, REDUCTION AND BRANCH LINE SIZES WITH A/E RECOMMENDATIONS. USE SCH 40 PVC WHERE PERMITTED BY CODE. EXHAUST PUMP TO OUTSIDE. BACK FLOW PREVENTION REQ'D PER LOCAL CODE. HENRY SCHEIN TO SUPPLY AIR/WATER SEPARATOR IF REQ'D. BUCK BOOST TRANSFORMER SUPPLIED AND INSTALLED BY CONTRACTOR (IF REQ'D). FINAL CONNECTIONS BY CONTRACTOR.	(2) 230V	(2) 20A	26B
1	32	REMOTE PANEL (AIR & (2) VAC) - SUPPLIED BY HENRY SCHEIN DENTAL. INSTALLED BY CONTRACTOR 60" A.F.F. CONTRACTOR TO SUPPLY AND INSTALL 24V CONTROL WIRING PER MFR SPECS.			32

ELECTRICAL NOTES

- THIS SPECIFICATION SHEET IS INTENDED AS A GUIDE FOR TRADESMEN. THE FLOOR PLANS ENCLOSED HEREIN ARE SUGGESTIONS FOR THE PLACEMENT OF DENTAL EQUIPMENT. THEY ARE NOT INTENDED FOR CONSTRUCTION.
- EXACT EQUIPMENT LOCATIONS MUST BE JOB SITE VERIFIED BY THE HENRY SCHEIN DENTAL EQUIPMENT SPECIALIST.
- FOLLOW MANUFACTURER'S TEMPLATES FOR EXACT REQUIREMENTS FOR ANY EQUIPMENT SUPPLIED BY HENRY SCHEIN DENTAL. CONSULT WITH HENRY SCHEIN DENTAL REP FOR ADDITIONAL INFORMATION.
- GFCI PROTECTION OR REDUNDANT GROUND IN DENTAL CHAIR RECEPTACLES, DENTAL UTILITY CABINETS AND ANY OTHER AREAS REQUIRED BY LOCAL CODE IS THE RESPONSIBILITY OF THE ELECTRICAL CONTRACTOR.
- ADDITIONAL CONVENIENCE OUTLETS REQUIRED ON JOBSITE ARE THE RESPONSIBILITY OF ELECTRICAL CONTRACTORS. FOLLOW LOCAL CODE RESTRICTIONS.
- CONDUIT LOCATIONS (4, 4A, 4B, 4C) SHOULD BE VERIFIED WITH OWNER AND HENRY SCHEIN REP PRIOR TO ROUGH-IN.
- ALL COMPUTER NETWORKING AND WORKSTATIONS MUST BE SPECIFIED BY CUSTOMER'S COMPUTER SUPPLIER. IF HENRY SCHEIN WILL BE SUPPLYING THE COMPUTERS & NETWORKING COMPONENTS, SEE SHEET SE2 FOR THE OFFICE TECHNOLOGY PLAN.
- CONTRACTOR TO PROVIDE AND INSTALL ALL EXIT SIGNS, EMERGENCY LIGHTING AND FIRE SUPPRESSION & DETECTION SYSTEMS AS PER ARCHITECT'S DRAWINGS AND LOCAL CODE.
- REFER TO ARCHITECT'S DRAWINGS FOR ELECTRICAL REQUIREMENTS IN ALL AREAS NOT INDICATED ON THIS PLAN.

ALL DIMENSIONS NOTED ON PLAN ARE TO THE CENTERLINE OF RECEPTACLE OR UTILITY CENTER (UNLESS SHOWN OTHERWISE)

ELECTRICAL LEGEND

ALL HEIGHTS TO BE SPECIFIED ON-SITE UNLESS NOTED OTHERWISE

▽ DATA DROP

*SPECIFICATIONS MAY INCLUDE DATA. SEE ELECTRICAL SCHEDULE THIS SHEET

SEE SHEETS SED.1 & SED.2 FOR DENTAL EQUIPMENT DETAILS

INTEGRATED DESIGN STUDIO
HENRY SCHEIN DENTAL
 10920 W LINCOLN AVE. WEST ALLIS, WI 53227
 henry.schein@integrateddesign.com

DR. JOANNA YU
 PROJECT: HENRY SCHEIN REP: TAYLOR PETRSON
 CENTER: BOSTON, MA
 PHONE #: (603) 320-6333

LOCATION: 1601 Congress Street - 2nd Floor Portland, ME

IMPORTANT NOTE:
 THIS DOCUMENT HAS BEEN PREPARED AS AN INSTRUMENT OF PROFESSIONAL SERVICE AND IS NOT AN ARCHITECTURAL PLAN. THE IDEAS DESIGN INCLUDED HEREIN ARE THE SOLE PROPERTY OF HENRY SCHEIN DENTAL AND ARE PROTECTED UNDER COPYRIGHT. THESE PLANS MAY NOT BE USED OR REPRODUCED WITHOUT EXPRESSED WRITTEN CONSENT OF HENRY SCHEIN AND FULL PAYMENT OF ANY ASSOCIATED DESIGN FEES. ALL DIMENSIONS ARE SUBJECT TO JOB-SITE VERIFICATION.

PROJECT NUMBER: 19-2695
 PROJECT START DATE: 04/23/2019
 FINALS START DATE: 10/23/2019
 DRAWN BY: OTHER
 FINALS BY: AKL
 CHECKED BY: MPJ

REVISIONS:
 11/04/19 AKL

INT. SQ. FT. = PER ARCH
 SCALE: 1/4"=1'-0" | SH. SIZE: 24 x 36
 DENTAL
 ELECTRICAL PLAN
SE.1

© 2019 by HENRY SCHEIN, INC.

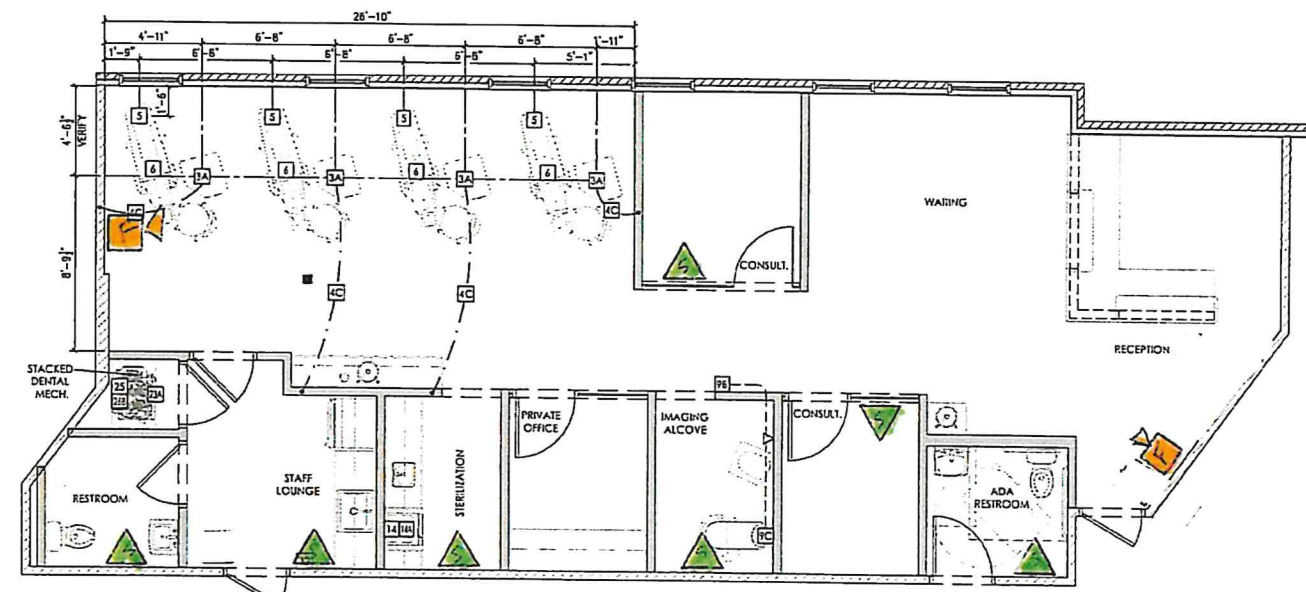

ALL DIMENSIONS ARE BASED ON A HAND-DRAWN SKETCH OR ORIGINAL BLUEPRINT PROVIDED TO THE HENRY SCHEIN INTEGRATED DESIGN STUDIO. AS-BUILT DIMENSIONS MUST BE JOB-SITE VERIFIED BY A HENRY SCHEIN DENTAL EQUIPMENT REPRESENTATIVE. IT IS THE ARCHITECT/CONTRACTOR'S RESPONSIBILITY TO VERIFY THAT ALL CODE RESTRICTIONS & CLEARANCES ARE MET.

THIS PLAN IS FOR THE SOLE PURPOSE OF SPECIFICATION AND INSTALLATION OF THE DENTAL EQUIPMENT SUPPLIED BY HENRY SCHEIN DENTAL. THE SPACE PLANNING AND CONCEPTUAL DESIGN HAS BEEN SUGGESTED BY OTHERS AND THE IDEAS HEREIN ARE NOT NECESSARILY RECOMMENDED BY THE HENRY SCHEIN INTEGRATED DESIGN STUDIO.

PROPOSED ELECTRICAL PLAN
 1/4"=1'-0"

LEGEND

☐ - Horn Stroke
 ▲ - Stroke