

**CITY OF PORTLAND, MAINE
DEVELOPMENT REVIEW APPLICATION
PLANNING DEPARTMENT PROCESSING FORM
Planning Copy**

2005-0120
Application I. D. Number
6/7/2005
Application Date
Relocation of House
Project Name/Description

Peter and Terry Weyl
Applicant
17 Brewer Street, Portland, ME 04102
Applicant's Mailing Address

17 - 17 Brewer Street, Portland, Maine
Address of Proposed Site
220 B006
Assessor's Reference: Chart-Block-Lot

Consultant/Agent
Applicant Ph: (207) 774-9172 Agent Fax:
Applicant or Agent Daytime Telephone, Fax

Proposed Development (check all that apply): New Building Building Addition Change Of Use Residential Office Retail
 Manufacturing Warehouse/Distribution Parking Lot Other (specify) _____

1,326 s.f.
Proposed Building square Feet or # of Units
Acreage of Site _____
R5
Zoning

Check Review Required:

<input checked="" type="checkbox"/> Site Plan (major/minor)	<input type="checkbox"/> Subdivision # of lots _____	<input type="checkbox"/> PAD Review	<input type="checkbox"/> 14-403 Streets Review
<input type="checkbox"/> Flood Hazard	<input type="checkbox"/> Shoreland	<input type="checkbox"/> Historic Preservation	<input type="checkbox"/> DEP Local Certification
<input type="checkbox"/> Zoning Conditional Use (ZBA/PB)	<input type="checkbox"/> Zoning Variance	<input type="checkbox"/> Other _____	

Fees Paid: Site Pla **\$400.00** Subdivision _____ Engineer Review _____ Date **6/9/2005**

Planning Approval Status:
 Approved Approved w/Conditions See Attached Denied
Reviewer *[Signature]*

Approval Date **6-29-05** Approval Expiration _____ Extension to _____
 Additional Sheets Attached
 OK to Issue Building Permit
signature *[Signature]* date **6-29-05**

Performance Guarantee Required* Not Required

No building permit may be issued until a performance guarantee has been submitted as indicated below

<input checked="" type="checkbox"/> Performance Guarantee Accepted	_____	_____	_____
	date	amount	expiration date
<input checked="" type="checkbox"/> Inspection Fee Paid	_____	_____	
	date	amount	
Building Permit Issue	_____		
	date		
<input checked="" type="checkbox"/> Performance Guarantee Reduced	_____	_____	_____
	date	remaining balance	signature
Temporary Certificate of Occupancy	_____	<input type="checkbox"/> Conditions (See Attached)	_____
	date		expiration date
Final Inspection	_____	_____	
	date	signature	
Certificate Of Occupancy	_____		
	date		
<input checked="" type="checkbox"/> Performance Guarantee Released	_____	_____	
	date	signature	
<input checked="" type="checkbox"/> Defect Guarantee Submitted	_____	_____	_____
	submitted date	amount	expiration date
<input checked="" type="checkbox"/> Defect Guarantee Released	_____	_____	
	date	signature	



PORTLAND MAINE

Strengthening a Remarkable City, Building a Community for Life • www.portlandmaine.gov

Planning and Development Department
Lee D. Urban, Director

Planning Division
Alexander Jaegerman, Director

Peter and Terry Weyl
17 Brewer Street
Portland, ME 04102

June 24, 2005

Dear Mr. and Mrs. Weyl:

RE: Application for Single Family House Relocation, Brewer Street, ID # 2005-0120

Thank you for your application to relocate a single family home from #1563 Congress Street to your lot on Brewer Street. Upon review of the site plan, the City's Planning Division has the following comments:

1. 4 parking spaces, 9'x19' each, are required (2 per unit). Please add 4th space to the site plan. Note: parking in the R-5 zone must be outside of the front setback.
2. Relating to item #1, it may be possible to add the 4th space in front of the garage and eliminate the proposed curb cut and paved driveway in front of the new building. Please consider.
3. Please show proposed topography/grading on your site plan.
4. Add erosion control (silt fence) as applicable.

Please submit 4 copies of revised plans to my attention.
Feel free to call me if you have any questions or comments.

Sincerely,

Jay Reynolds
Development Review Coordinator

cc: Sarah Hopkins, Development Review Services Manager

CITY OF PORTLAND, MAINE
DEVELOPMENT REVIEW APPLICATION
PLANNING DEPARTMENT PROCESSING FORM

Fire Copy

2005-0120

Application I. D. Number

6/7/2005

Application Date

Relocation of House

Project Name/Description

Peter and Terry Weyl

Applicant

17 Brewer Street, Portland, ME 04102

Applicant's Mailing Address

Consultant/Agent

Applicant Ph: (207) 774-9172 Agent Fax:

Applicant or Agent Daytime Telephone, Fax

17 - 17 Brewer Street, Portland, Maine

Address of Proposed Site

220 B006

Assessor's Reference: Chart-Block-Lot

Proposed Development (check all that apply): New Building Building Addition Change Of Use Residential Office Retail
 Manufacturing Warehouse/Distribution Parking Lot Other (specify) _____

1,326 s.f.

Proposed Building square Feet or # of Units

Acreage of Site

R5

Zoning

Check Review Required:

- Site Plan (major/minor) Subdivision # of lots _____ PAD Review 14-403 Streets Review
 Flood Hazard Shoreland Historic Preservation DEP Local Certification
 Zoning Conditional Use (ZBA/PB) Zoning Variance Other _____

Fees Paid: Site Pla \$400.00 Subdivision _____ Engineer Review _____ Date 6/9/2005

Fire Approval Status:

Reviewer

Fire Prevention

- Approved Approved w/Conditions See Attached Denied

Approval Date *June 10 05* Approval Expiration _____ Extension to _____ Additional Sheets Attached

Condition Compliance *Jay Kelley* signature *6-10* date

Performance Guarantee Required* Not Required

* No building permit may be issued until a performance guarantee has been submitted as indicated below

- | | | | |
|---|----------------|--|-----------------|
| <input type="checkbox"/> Performance Guarantee Accepted | _____ | _____ | _____ |
| | date | amount | expiration date |
| <input type="checkbox"/> Inspection Fee Paid | _____ | _____ | |
| | date | amount | |
| <input type="checkbox"/> Building Permit Issue | _____ | | |
| | date | | |
| <input type="checkbox"/> Performance Guarantee Reduced | _____ | _____ | _____ |
| | date | remaining balance | signature |
| <input type="checkbox"/> Temporary Certificate of Occupancy | _____ | <input type="checkbox"/> Conditions (See Attached) | _____ |
| | date | | expiration date |
| <input type="checkbox"/> Final Inspection | _____ | _____ | |
| | date | signature | |
| <input type="checkbox"/> Certificate Of Occupancy | _____ | | |
| | date | | |
| <input type="checkbox"/> Performance Guarantee Released | _____ | _____ | |
| | date | signature | |
| <input type="checkbox"/> Defect Guarantee Submitted | _____ | _____ | _____ |
| | submitted date | amount | expiration date |
| <input type="checkbox"/> Defect Guarantee Released | _____ | _____ | |
| | date | signature | |

17 Brewer Street
Portland, ME 04102
Tel: 774-9172
June 7, 2005

The City of Portland
Planning and Development Department
389 Congress Street
Portland, ME 04101

Dear Sir or Madam:

We have acquired the 2-story house and the adjoining garage at 1563 Congress Street from Mr. Michael Rogers, and are planning to move both structures to our side yard at 17 Brewer Street, as a rental unit addition to our house. The distance of the move would be approximately one block, as Brewer Street is directly across Congress Street from the structures.

The anticipated date of the move would be during the final week of June or the first week of July, 2005. Our house mover is James Merry of Scarborough. Our contractor is E.G. Johnson of Portland, who will subcontract an electrician and plumber. We have already contacted CMP, Verizon and Time Warner Cable about the feasibility of the move.

The estimated cost for this project is \$65,000.00.

In addition to moving the house to a foundation in our side yard, we would have a city licensed contractor make a curb cut 5 feet from the neighboring driveway to provide off-street parking for the tenants of the unit. The Department of Public Works has given initial approval for this curb cut.

Our landscape plan includes planting two small river birch trees in the side yard.

Thank you for your consideration of this project.



Peter and Terry Weyl



City of Portland Site Plan Application

If you or the property owner owes real estate or personal property taxes or user charges on any property within the City, payment arrangements must be made before permits of any kind are accepted.

Address of Proposed Development: 17 BREWER ST.		Zone: R5
Total Square Footage of Proposed Structure: 1,326 (HOUSE: 750 GARAGE: 576)	Square Footage of Lot: 9,888	
Tax Assessor's Chart, Block & Lot: Chart# 220 Block# B Lot# 6	Property owner's mailing address: 17 BREWER ST. PORTLAND, ME 04102	Telephone #: (207) 774-9172
Consultant/Agent, mailing address, phone # & contact person:	Applicant's name, mailing address, telephone #/Fax#/Pager#: PETER & TERRAY WEYL 17 BREWER ST. PORTLAND, ME 04102 (207) 774-9172	Project name: PETER & TERRAY WEYL
Proposed Development (check all that apply) <input type="checkbox"/> New Building <input type="checkbox"/> Building Addition <input type="checkbox"/> Change of Use <input checked="" type="checkbox"/> Residential <input type="checkbox"/> Office <input type="checkbox"/> Retail <input type="checkbox"/> Manufacturing <input type="checkbox"/> Warehouse/Distribution <input type="checkbox"/> Parking lot Subdivision (\$500.00) + amount of lots _____ (\$25.00 per lot) \$ _____ Site Location of Development (\$3,000.00) (except for residential projects which shall be \$200.00 per lot _____) <input type="checkbox"/> Traffic Movement (\$1,000.00) <input type="checkbox"/> Stormwater Quality (\$250.00) <input type="checkbox"/> Section 14-403 Review (\$400.00 + \$25.00 per lot) <input type="checkbox"/> Other _____		
Major Development (more than 10,000 sq. ft.) <input type="checkbox"/> Under 50,000 sq. ft. (\$500.00) <input type="checkbox"/> 50,000 - 100,000 sq. ft. (\$1,000.00) <input type="checkbox"/> Parking Lots over 100 spaces (\$1,000.00) <input type="checkbox"/> 100,000 - 200,000 sq. ft. (\$2,000.00) <input type="checkbox"/> 200,000 - 300,000 sq. ft. (\$3,000.00) <input type="checkbox"/> Over 300,000 sq. ft. (\$5,000.00) <input type="checkbox"/> After-the-fact Review (\$1,000.00 + applicable application fee)		
Minor Site Plan Review <input checked="" type="checkbox"/> Less than 10,000 sq. ft. (\$400.00) <input type="checkbox"/> After-the-fact Review (\$1,000.00 + applicable application fee)		
Plan Amendments <input type="checkbox"/> Planning Staff Review (\$250.00) <input type="checkbox"/> Planning Board Review (\$500.00)		

- Please see next page -



TD Banknorth, N.A.
Operations Center
P.O.Box 1377
Lewiston, ME 04243-1377
Toll Free: 800 462-3666
TDBanknorth.com

June 2nd, 2005

PETER WEYL
TERRY V WEYL
17 BREWER ST
PORTLAND, ME 04102

RE: Loan # [REDACTED]

Dear Customer:

Thank you for your recent request on the above referenced loan number. Listed below is the information you requested.

Principal Balance:	\$ 19,549.19
Next Payment Due:	06/03/05
Payment Amount:	50.56
Available Amount as of 6-2-05:	\$93,250.81
Collateral:	17 BREWER ST

If you have any questions please feel free to call our Customer Service Department at 1-800-281-0025 x4335.

Sincerely,

Customer Service Department
Loan Operations

Who billing will be sent to: (Company, Contact Person, Address, Phone #)

PETER WEYL
17 BREWER ST. PORTLAND ME 04102

TEL:
(207) 774-9172

Submittals shall include (9) separate folded packets of the following:

- copy of application
- cover letter stating the nature of the project
- site plan containing the information found in the attached sample plans check list

Amendment to Plans: Amendment applications should include 6 separate packets of the above (a, b, & c)

ALL PLANS MUST BE FOLDED NEATLY AND IN PACKET FORM

Section 14-522 of the Zoning Ordinance outlines the process; copies are available at the counter at .50 per page (8.5 x11) you may also visit the web site: ci.portland.me.us chapter 14

I hereby certify that I am the Owner of record of the named property, or that the owner of record authorizes the proposed work and that I have been authorized by the owner to make this application as his/her authorized agent. I agree to conform to all applicable laws of this jurisdiction. In addition, if a permit for work described in this application is issued, I certify that the Code Official's authorized representative shall have the authority to enter all areas covered by this permit at any reasonable hour to enforce the provisions of the codes applicable to this permit.

Signature of applicant:

Peter + Tony Weyl

Date:

6/7/05

This application is for site review ONLY, a building Permit application and associated fees will be required prior to construction.

Development in Portland

The City of Portland has instituted the following fees to recover the costs of reviewing development proposals under the Site Plan and Subdivision ordinances: application fee; engineering fee; and inspection fee. Performance and defect guarantees are also required by ordinance to cover all site work proposed.

The **Application Fee** covers general planning and administrative processing costs, and is paid at the time of application.

The Planning Division is required to send notices to neighbors upon receipt of an application and prior to public meetings. The applicant will be billed for mailing and advertisement costs. Applicants for development will be charged an **Engineering Review Fee**. This fee is charged by the Planning Division for review of on-site improvements of a civil engineering nature, such as storm water management as well as the engineering analysis of related improvements within the public right-of-way, such as public streets and utility connections, as assessed by the Department of Public Works. The Engineering Review fee must be paid before a building permit can be issued. Monthly invoices are sent out by the Planning Division on a monthly basis to cover engineering costs.

A **Performance Guarantee** will be required following approval of development plans. This guarantee covers all required improvements within the public right-of-way, plus certain site improvements such as landscaping, paving, and drainage improvements. The Planning Division will provide a cost estimate form for figuring the amount of the performance guarantee, as well as sample form letters to be filled out by a financial institution.

An **Inspection Fee** must also be submitted to cover inspections to ensure that sites are developed in accordance with the approved plan. The inspection fee is 2.0% of the performance guarantee amount, or as assessed by the planning or public works engineer. The minimum inspection fee is \$300 for development, unless no site improvements are proposed. Public Works inspects work within the City right-of-way and Planning inspects work within the site including pipe-laying and connections. (The contractor must work with inspectors to coordinate timely inspections, and should provide adequate notice before inspections, especially in the case of final inspection.)

Upon completion of a development project, the performance guarantee is released, and a **Defect Guarantee** in the amount of 10% of the performance guarantee must be provided. The Defect Guarantee will be released after a year.

Other reimbursements to the City include actual or apportioned costs for advertising and mailed notices. All fees shall be paid prior to the issuance of any building permit.

For more information on the fees or review process, please call the Planning Division at 874-8719 or 874-8721.



12 Beaver St.



1563 CONCRETS ST.

17 Brewer Street
Portland, ME 04102
Tel: 774-9172
June 7, 2005

The City of Portland
Planning and Development Department
389 Congress Street
Portland, ME 04101

Dear Sir or Madam:

We have acquired the 2-story house and the adjoining garage at 1563 Congress Street from Mr. Michael Rogers, and are planning to move both structures to our side yard at 17 Brewer Street, as a rental unit addition to our house. The distance of the move would be approximately one block, as Brewer Street is directly across Congress Street from the structures.

The anticipated date of the move would be during the final week of June or the first week of July, 2005. Our house mover is James Merry of Scarborough. Our contractor is E.G. Johnson of Portland, who will subcontract an electrician and plumber. We have already contacted CMP, Verizon and Time Warner Cable about the feasibility of the move.

The estimated cost for this project is \$65,000.00.

In addition to moving the house to a foundation in our side yard, we would have a city licensed contractor make a curb cut 5 feet from the neighboring driveway to provide off-street parking for the tenants of the unit. The Department of Public Works has given initial approval for this curb cut.

Our landscape plan includes planting two small river birch trees in the side yard.

Thank you for your consideration of this project.



Peter and Terry Weyl



City of Portland Site Plan Application

If you or the property owner owes real estate or personal property taxes or user charges on any property within the City, payment arrangements must be made before permits of any kind are accepted.

Address of Proposed Development: 17 BREWER ST.		Zone: R5
Total Square Footage of Proposed Structure: 1,326 (HOUSE: 750 GARAGE: 576)		Square Footage of Lot: 9,888
Tax Assessor's Chart, Block & Lot: Chart# 220 Block# B Lot# 6		Property owner's mailing address: 17 BREWER ST. PORTLAND, ME 04102
		Telephone #: (207) 774-9172
Consultant/Agent, mailing address, phone # & contact person:		Applicant's name, mailing address, telephone #/Fax#/Pager#: PETER & TERRY WEYL 17 BREWER ST. PORTLAND, ME 04102 (207) 774-9172
		Project name: PETER & TERRY WEYL
<p>Proposed Development (check all that apply)</p> <p><input type="checkbox"/> New Building <input type="checkbox"/> Building Addition <input type="checkbox"/> Change of Use <input checked="" type="checkbox"/> Residential <input type="checkbox"/> Office <input type="checkbox"/> Retail <input type="checkbox"/> Manufacturing</p> <p><input type="checkbox"/> Warehouse/Distribution <input type="checkbox"/> Parking lot</p> <p><input type="checkbox"/> Subdivision (\$500.00) + amount of lots _____ (\$25.00 per lot) \$ _____</p> <p><input type="checkbox"/> Site Location of Development (\$3,000.00)</p> <p><input type="checkbox"/> (except for residential projects which shall be \$200.00 per lot _____)</p> <p><input type="checkbox"/> Traffic Movement (\$1,000.00) <input type="checkbox"/> Stormwater Quality (\$250.00)</p> <p><input type="checkbox"/> Section 14-403 Review (\$400.00 + \$25.00 per lot)</p> <p><input type="checkbox"/> Other _____</p>		
<p>Major Development (more than 10,000 sq. ft.)</p> <p><input type="checkbox"/> Under 50,000 sq. ft. (\$500.00)</p> <p><input type="checkbox"/> 50,000 - 100,000 sq. ft. (\$1,000.00)</p> <p><input type="checkbox"/> Parking Lots over 100 spaces (\$1,000.00)</p> <p><input type="checkbox"/> 100,000 - 200,000 sq. ft. (\$2,000.00)</p> <p><input type="checkbox"/> 200,000 - 300,000 sq. ft. (\$3,000.00)</p> <p><input type="checkbox"/> Over 300,000 sq. ft. (\$5,000.00)</p> <p><input type="checkbox"/> After-the-fact Review (\$1,000.00 + applicable application fee)</p>		
<p>Minor Site Plan Review</p> <p><input checked="" type="checkbox"/> Less than 10,000 sq. ft. (\$400.00)</p> <p><input type="checkbox"/> After-the-fact Review (\$1,000.00 + applicable application fee)</p>		
<p>Plan Amendments</p> <p><input type="checkbox"/> Planning Staff Review (\$250.00)</p> <p><input type="checkbox"/> Planning Board Review (\$500.00)</p>		
- Please see next page -		

Who billing will be sent to: (Company, Contact Person, Address, Phone #)	TEL:
PETER WEYL 17 BREWER ST. PORTLAND ME 04102	(207) 774-9172

Submittals shall include (9) separate folded packets of the following:

- a. copy of application
- b. cover letter stating the nature of the project
- c. site plan containing the information found in the attached sample plans check list

Amendment to Plans: Amendment applications should include 6 separate packets of the above (a, b, & c)
ALL PLANS MUST BE FOLDED NEATLY AND IN PACKET FORM

Section 14-522 of the Zoning Ordinance outlines the process; copies are available at the counter at .50 per page (8.5 x11) you may also visit the web site: ci.portland.me.us chapter 14

I hereby certify that I am the Owner of record of the named property, or that the owner of record authorizes the proposed work and that I have been authorized by the owner to make this application as his/her authorized agent. I agree to conform to all applicable laws of this jurisdiction. In addition, if a permit for work described in this application is issued, I certify that the Code Official's authorized representative shall have the authority to enter all areas covered by this permit at any reasonable hour to enforce the provisions of the codes applicable to this permit.

Signature of applicant: Peter + Tony Weyl	Date: 6/7/05
---	--------------

This application is for site review ONLY, a building Permit application and associated fees will be required prior to construction.

Development in Portland

The City of Portland has instituted the following fees to recover the costs of reviewing development proposals under the Site Plan and Subdivision ordinances: application fee; engineering fee; and inspection fee. Performance and defect guarantees are also required by ordinance to cover all site work proposed.

The **Application Fee** covers general planning and administrative processing costs, and is paid at the time of application.

The Planning Division is required to send notices to neighbors upon receipt of an application and prior to public meetings. The applicant will be billed for mailing and advertisement costs. Applicants for development will be charged an **Engineering Review Fee**. This fee is charged by the Planning Division for review of on-site improvements of a civil engineering nature, such as storm water management as well as the engineering analysis of related improvements within the public right-of-way, such as public streets and utility connections, as assessed by the Department of Public Works. The Engineering Review fee must be paid before a building permit can be issued. Monthly invoices are sent out by the Planning Division on a monthly basis to cover engineering costs.

A **Performance Guarantee** will be required following approval of development plans. This guarantee covers all required improvements within the public right-of-way, plus certain site improvements such as landscaping, paving, and drainage improvements. The Planning Division will provide a cost estimate form for figuring the amount of the performance guarantee, as well as sample form letters to be filled out by a financial institution.

An **Inspection Fee** must also be submitted to cover inspections to ensure that sites are developed in accordance with the approved plan. The inspection fee is 2.0% of the performance guarantee amount, or as assessed by the planning or public works engineer. The minimum inspection fee is \$300 for development, unless no site improvements are proposed. Public Works inspects work within the City right-of-way and Planning inspects work within the site including pipe-laying and connections. (The contractor must work with inspectors to coordinate timely inspections, and should provide adequate notice before inspections, especially in the case of final inspection.)

Upon completion of a development project, the performance guarantee is released, and a **Defect Guarantee** in the amount of 10% of the performance guarantee must be provided. The Defect Guarantee will be released after a year.

Other reimbursements to the City include actual or apportioned costs for advertising and mailed notices. All fees shall be paid prior to the issuance of any building permit.

For more information on the fees or review process, please call the Planning Division at 874-8719 or 874-8721.



TD Banknorth, N.A.
Operations Center
P.O.Box 1377
Lewiston, ME 04243-1377
Toll Free: 800 462-3666
TDBanknorth.com

June 2nd, 2005

PETER WEYL
TERRY V WEYL
17 BREWER ST
PORTLAND, ME 04102

RE: Loan # [REDACTED]

Dear Customer:

Thank you for your recent request on the above referenced loan number. Listed below is the information you requested.

Principal Balance:	\$ 19,549.19
Next Payment Due:	06/03/05
Payment Amount:	50.56
Available Amount as of 6-2-05:	\$93,250.81
Collateral:	17 BREWER ST

If you have any questions please feel free to call our Customer Service Department at 1-800-281-0025 x4335.

Sincerely,

Customer Service Department
Loan Operations



17 Brewer St.

17 Bremer St.
#2005-0120
minor Site Plan
receipt of
appl. notice sent
to immediate
neighbors.

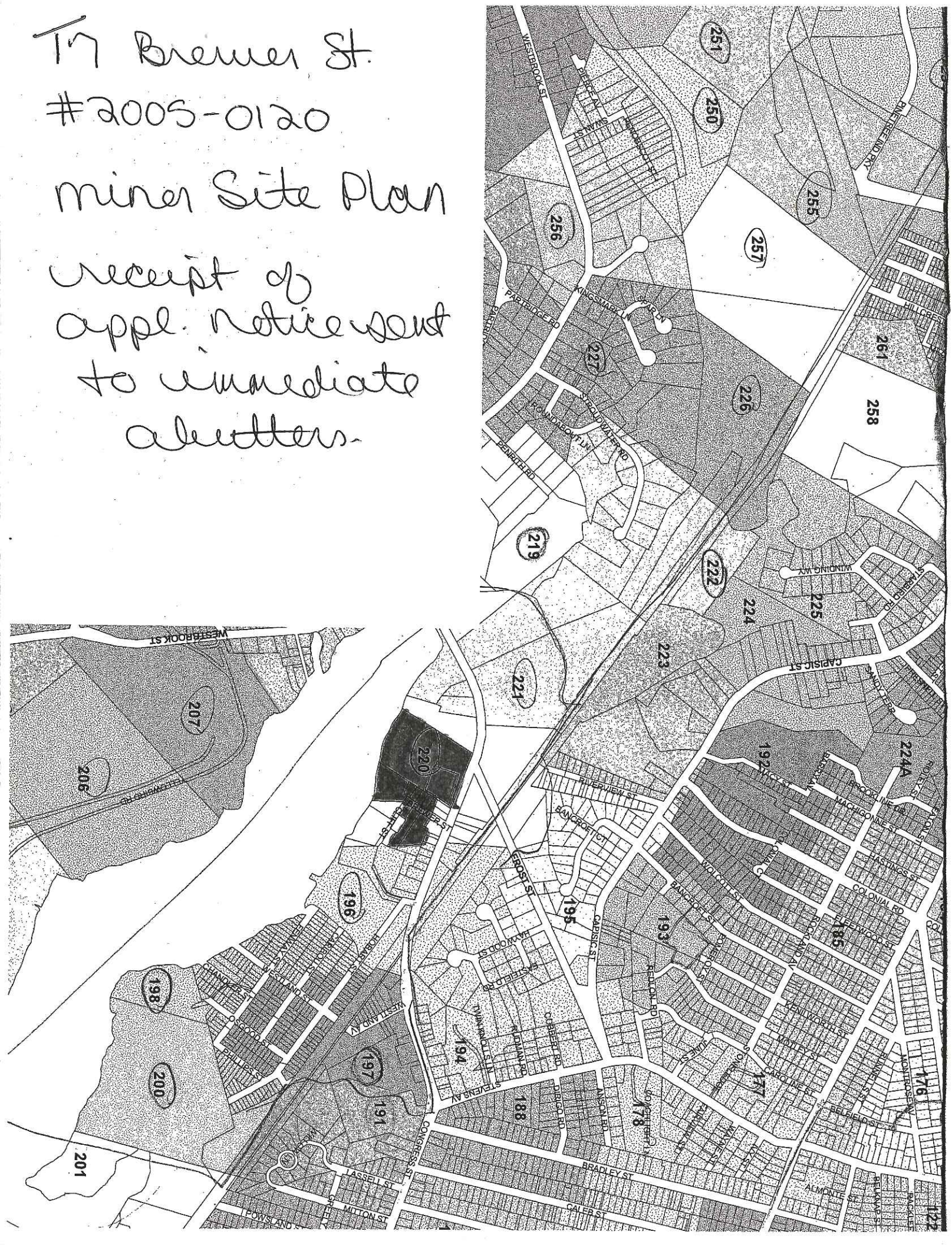



1563 CONCRETS ST.

11
62047

15
312620

10
44330

8
42887

7
6297

6
4912

5
4912

4
4912

3
3954

2
4912

1
5000

6
5000

12
20,830

9
7200

14
30420

9
53960

10
6283

1
46280

5
12680

7
6308

8
14040

2
4374

FLATS

WATER

HIGH

LINE

APP. CENTER LINE
P.W.D. R/W

TOW PATH

CLIFF STREET

BREWER STREET

PASSAGE STREET

CONGRESS STREET

(B)

(A)

(E)

1626
1624
1622
1620
1618
1616
1614
1612
1610
1608
1606
1604
1602
1600
1598
1596
1594
1592
1590
1588
1586
1584
1582
1580
1578
1576
1574
1572
1570
1568
1566
1564
1562
1560
1558
1556
1554
1552
1550
1548
1546
1544
1542
1540
1538
1536
1534
1532
1530
1528
1526
1524
1522
1520
1518
1516
1514
1512
1510
1508
1506
1504
1502
1500
1498
1496
1494
1492
1490
1488
1486
1484
1482
1480
1478
1476
1474
1472
1470
1468
1466
1464
1462
1460
1458
1456
1454
1452
1450
1448
1446
1444
1442
1440
1438
1436
1434
1432
1430
1428
1426
1424
1422
1420
1418
1416
1414
1412
1410
1408
1406
1404
1402
1400
1398
1396
1394
1392
1390
1388
1386
1384
1382
1380
1378
1376
1374
1372
1370
1368
1366
1364
1362
1360
1358
1356
1354
1352
1350
1348
1346
1344
1342
1340
1338
1336
1334
1332
1330
1328
1326
1324
1322
1320
1318
1316
1314
1312
1310
1308
1306
1304
1302
1300
1298
1296
1294
1292
1290
1288
1286
1284
1282
1280
1278
1276
1274
1272
1270
1268
1266
1264
1262
1260
1258
1256
1254
1252
1250
1248
1246
1244
1242
1240
1238
1236
1234
1232
1230
1228
1226
1224
1222
1220
1218
1216
1214
1212
1210
1208
1206
1204
1202
1200
1198
1196
1194
1192
1190
1188
1186
1184
1182
1180
1178
1176
1174
1172
1170
1168
1166
1164
1162
1160
1158
1156
1154
1152
1150
1148
1146
1144
1142
1140
1138
1136
1134
1132
1130
1128
1126
1124
1122
1120
1118
1116
1114
1112
1110
1108
1106
1104
1102
1100
1098
1096
1094
1092
1090
1088
1086
1084
1082
1080
1078
1076
1074
1072
1070
1068
1066
1064
1062
1060
1058
1056
1054
1052
1050
1048
1046
1044
1042
1040
1038
1036
1034
1032
1030
1028
1026
1024
1022
1020
1018
1016
1014
1012
1010
1008
1006
1004
1002
1000
998
996
994
992
990
988
986
984
982
980
978
976
974
972
970
968
966
964
962
960
958
956
954
952
950
948
946
944
942
940
938
936
934
932
930
928
926
924
922
920
918
916
914
912
910
908
906
904
902
900
898
896
894
892
890
888
886
884
882
880
878
876
874
872
870
868
866
864
862
860
858
856
854
852
850
848
846
844
842
840
838
836
834
832
830
828
826
824
822
820
818
816
814
812
810
808
806
804
802
800
798
796
794
792
790
788
786
784
782
780
778
776
774
772
770
768
766
764
762
760
758
756
754
752
750
748
746
744
742
740
738
736
734
732
730
728
726
724
722
720
718
716
714
712
710
708
706
704
702
700
698
696
694
692
690
688
686
684
682
680
678
676
674
672
670
668
666
664
662
660
658
656
654
652
650
648
646
644
642
640
638
636
634
632
630
628
626
624
622
620
618
616
614
612
610
608
606
604
602
600
598
596
594
592
590
588
586
584
582
580
578
576
574
572
570
568
566
564
562
560
558
556
554
552
550
548
546
544
542
540
538
536
534
532
530
528
526
524
522
520
518
516
514
512
510
508
506
504
502
500
498
496
494
492
490
488
486
484
482
480
478
476
474
472
470
468
466
464
462
460
458
456
454
452
450
448
446
444
442
440
438
436
434
432
430
428
426
424
422
420
418
416
414
412
410
408
406
404
402
400
398
396
394
392
390
388
386
384
382
380
378
376
374
372
370
368
366
364
362
360
358
356
354
352
350
348
346
344
342
340
338
336
334
332
330
328
326
324
322
320
318
316
314
312
310
308
306
304
302
300
298
296
294
292
290
288
286
284
282
280
278
276
274
272
270
268
266
264
262
260
258
256
254
252
250
248
246
244
242
240
238
236
234
232
230
228
226
224
222
220
218
216
214
212
210
208
206
204
202
200
198
196
194
192
190
188
186
184
182
180
178
176
174
172
170
168
166
164
162
160
158
156
154
152
150
148
146
144
142
140
138
136
134
132
130
128
126
124
122
120
118
116
114
112
110
108
106
104
102
100
98
96
94
92
90
88
86
84
82
80
78
76
74
72
70
68
66
64
62
60
58
56
54
52
50
48
46
44
42
40
38
36
34
32
30
28
26
24
22
20
18
16
14
12
10
8
6
4
2
0

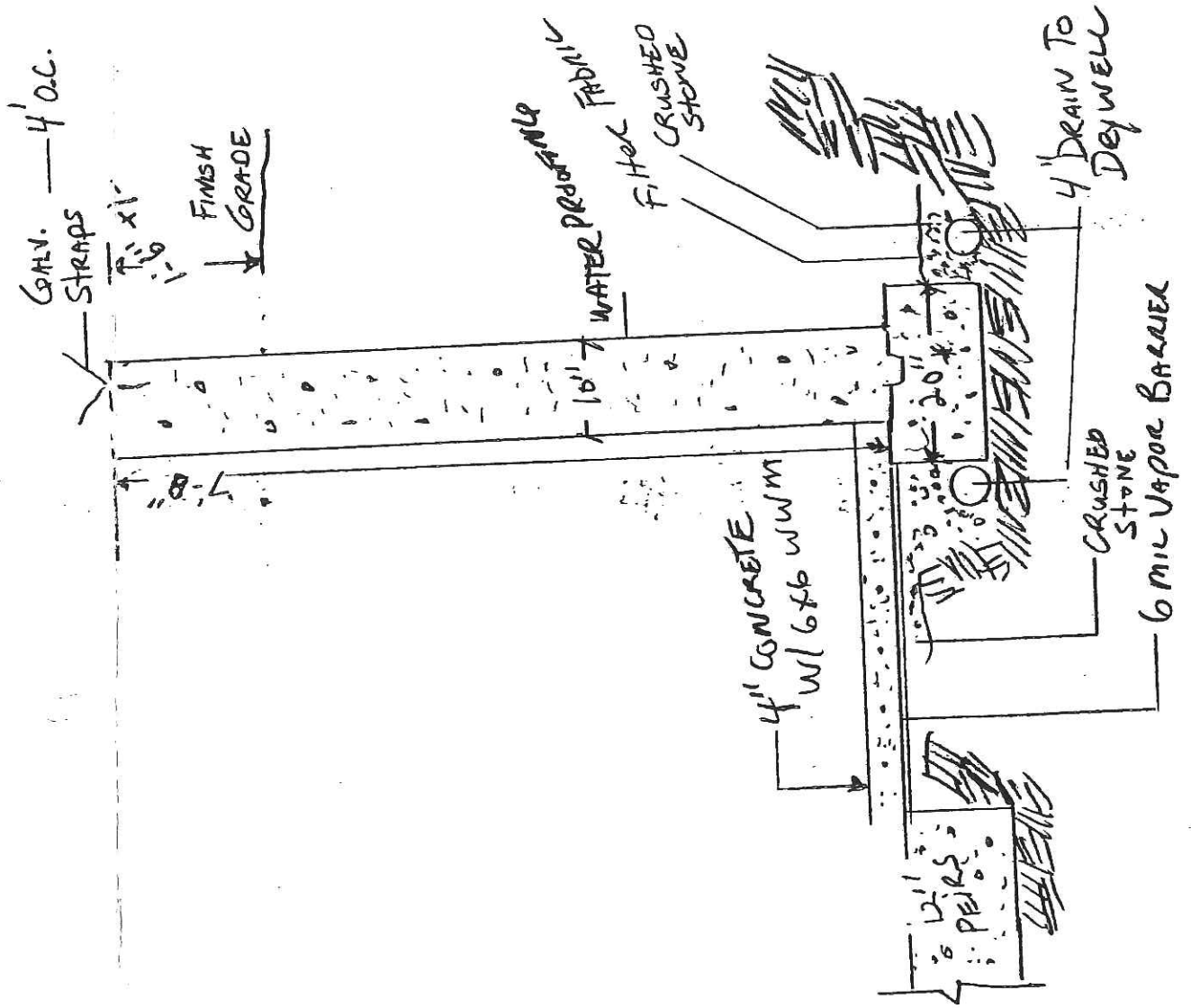

FOUNDATION
 WALL DETAIL
 SCALE: 1/2" = 1'-0"

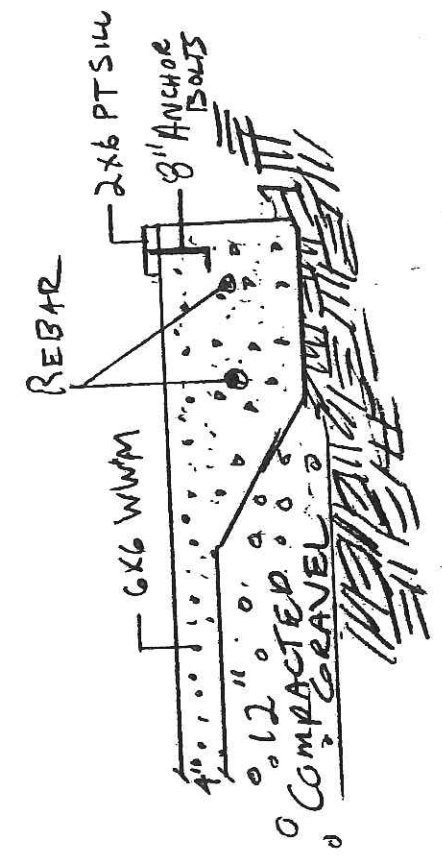

GARAGE FLOOR
 DETAIL
 SCALE: 1/2" = 1'-0"

TIONSTO
 EYL
 DENCE
 VER STREET
 AND, MAINE