

2 7 2004 6014

Dig info 2004 230 2765

# SUBSURFACE WASTEWATER DISPOSAL SYSTEM APPLICATION

Maine Department of Human Services  
Division of Health Engineering, Station 10 SHS  
(207) 287-5672 FAX (207) 287-4172

<b>PROPERTY LOCATION</b>		>> Caution: Permit Required - Attach In Space Below <<	
City, Town, or Plantation	PORTLAND 787 3779	PORTLAND Date Permit Issued: 6/17/04 PERMIT # 8962 STATE COPY \$ 1/10/04 L.P.I. # 01749 Local Plumbing Inspector Signature: <i>[Signature]</i>	<input type="checkbox"/> Double Fee <input type="checkbox"/> FEE Charged
Street or Road	25 PENRITH STREET Seanreen		
Subdivision, Lot *			
<b>OWNER/APPLICANT INFORMATION</b>			
Name (last, first, MI)	STAHL FRANCES Owner Applicant		
Mailing Address of	C/O RICHARD WALTZ 172 PRESUMPCOT STREET PORTLAND, ME		
<input type="checkbox"/> Owner <input type="checkbox"/> Applicant			
Daytime Tel. *	772-2801	Municipal Tax Map * 219 A Lot * 15	
<b>Owner or Applicant Statement</b>		<b>Caution: Inspections Required</b>	
I state and acknowledge that the information submitted is correct to the best of my knowledge and understand that any falsification is reason for the Department and/or Local Plumbing Inspector to deny a permit.		I have inspected the installation authorized above and found it to be in compliance with the Subsurface Wastewater Disposal Rules Application.	
Signature of Owner/Applicant _____ Date _____		Local Plumbing Inspector Signature _____ (1st) Date Approved _____ _____ (2nd) Date Approved _____	

PERMIT INFORMATION		
<b>TYPE OF APPLICATION</b>	<b>THIS APPLICATION REQUIRES</b>	<b>DISPOSAL SYSTEM COMPONENTS</b>
1. <input type="checkbox"/> First Time System 2. <input checked="" type="checkbox"/> Replacement System Type Replaced: _____ Year Installed: _____ 3. <input type="checkbox"/> Expanded System a. <input type="checkbox"/> Minor Expansion b. <input type="checkbox"/> Major Expansion 4. <input type="checkbox"/> Experimental System 5. <input type="checkbox"/> Seasonal Conversion	1. <input checked="" type="checkbox"/> No Rule Variance 2. <input type="checkbox"/> First Time System Variance a. <input type="checkbox"/> Local Plumbing Inspector Approval b. <input type="checkbox"/> State & Local Plumbing Inspector Approval 3. Replacement System Variance a. <input type="checkbox"/> Local Plumbing Inspector Approval b. <input type="checkbox"/> State & Local Plumbing Inspector Approval 4. <input type="checkbox"/> Minimum Lot Size Variance 5. <input type="checkbox"/> Seasonal Conversion Approval	1. <input checked="" type="checkbox"/> Complete Non-Engineered System 2. <input type="checkbox"/> Primitive System (graywater & alt toilet) 3. <input type="checkbox"/> Alternative Toilet, specify: _____ 4. <input type="checkbox"/> Non-Engineered Treatment Tank (only) 5. <input type="checkbox"/> Holding Tank, _____ Gallons 6. <input type="checkbox"/> Non-Engineered Disposal Field (only) 7. <input type="checkbox"/> Separated Laundry System 8. <input type="checkbox"/> Complete Engineered System (2000gpd+) 9. <input type="checkbox"/> Engineered Treatment Tank (only) 10. <input type="checkbox"/> Engineered Disposal Field (only) 11. <input type="checkbox"/> Pre-treatment, specify: _____ 12. <input type="checkbox"/> Miscellaneous components
<b>SIZE OF PROPERTY</b>	<b>DISPOSAL SYSTEM TO SERVE</b>	<b>TYPE OF WATER SUPPLY</b>
47,000 SQ. FT. <input type="checkbox"/> sq. ft. <input type="checkbox"/> acres	1. <input checked="" type="checkbox"/> Single Family Dwelling Unit, No. of Bedrooms: <u>4</u> 2. <input type="checkbox"/> Multiple Family Dwelling, No of Units: _____ 3. <input type="checkbox"/> Other: _____ SPECIFY Current Use <input type="checkbox"/> Seasonal <input checked="" type="checkbox"/> Year Round <input type="checkbox"/> Undeveloped	1. <input type="checkbox"/> Drilled Well 2. <input type="checkbox"/> Dug Well 3. <input type="checkbox"/> Private 4. <input checked="" type="checkbox"/> Public 5. <input type="checkbox"/> Other: _____
<b>SHORELAND ZONING</b>		
<input type="checkbox"/> Yes <input checked="" type="checkbox"/> No		

DESIGN DETAILS (SYSTEM LAYOUT SHOWN ON PAGE 3)			
<b>TREATMENT TANK</b>	<b>DISPOSAL FIELD TYPE &amp; SIZE</b>	<b>GARBAGE DISPOSAL UNIT</b>	<b>DESIGN FLOW</b>
1. <input checked="" type="checkbox"/> Concrete a. <input checked="" type="checkbox"/> Regular b. <input type="checkbox"/> Low Profile 2. <input type="checkbox"/> Plastic 3. <input type="checkbox"/> Other: _____ CAPACITY (2) 1000 gallons	1. <input type="checkbox"/> Stone Bed 2. Stone Trench 3. <input checked="" type="checkbox"/> Proprietary Device a. <input type="checkbox"/> Cluster array c. <input checked="" type="checkbox"/> Linear b. <input checked="" type="checkbox"/> Regular d. <input type="checkbox"/> H-20 loaded 4. <input type="checkbox"/> Other: _____ SIZE <u>1400</u> sq. ft. <input type="checkbox"/> lin. ft. <u>28 PLASTIC CHAMBERS</u>	1. <input type="checkbox"/> No 3. <input type="checkbox"/> Maybe 2. <input checked="" type="checkbox"/> Yes >> Specify one below: a. <input type="checkbox"/> Multi-compartment tank b. <input checked="" type="checkbox"/> <u>2</u> tanks in series c. <input type="checkbox"/> Increase in tank capacity d. <input type="checkbox"/> Filter on tank outlet	<b>480</b> gallons per day BASED ON: 1. <input checked="" type="checkbox"/> Table 501.1 (dwelling unit(s)) 2. <input type="checkbox"/> Table 501.2 (other facilities) SHOW CALCULATIONS - for other facilities - EXISTING 3 BEDROOM EXPANDING TO <b>4 BEDROOMS AT          120 GALLONS PER          DAY EACH</b> 3. <input type="checkbox"/> Section 503.0 (meter readings) ATTACH WATER-METER DATA
<b>SOIL DATA &amp; DESIGN CLASS</b>	<b>DISPOSAL FIELD SIZING</b>	<b>PUMPING</b>	
PROFILE CONDITION DESIGN <u>5 / C / 2</u> AT Observation Hole * <u>TP 1</u> Depth <u>29</u> " OF MOST LIMITING SOIL FACTOR	1. <input type="checkbox"/> Small - 2.0 sq.ft./gpd 2. <input checked="" type="checkbox"/> Medium - 2.6 sq.ft./gpd 3. <input type="checkbox"/> Medium-Large - 3.3 sq.ft./gpd 4. <input type="checkbox"/> Large - 4.1 sq.ft./gpd 5. <input type="checkbox"/> Extra-Large - 5.0 sq.ft./gpd	RAISE PLUMBING AS NEEDED 1. <input type="checkbox"/> Not required 2. <input checked="" type="checkbox"/> May be required 3. <input type="checkbox"/> Required >> Specify only for engineered or experimental systems: DOSE: _____ Gallons	

SITE EVALUATOR STATEMENT		
I certify that on <u>4/26/04</u> (date) I completed a site evaluation on this property and state that the data reported is accurate and that the proposed system is in compliance with the Subsurface Wastewater Disposal Rules (10-144A CMR 211).		
Site Evaluator Signature <i>[Signature]</i> ALBERT FRICK	SE * 163	Date <u>5/7/2004</u> ALBERTFRICK@WORLDNET.ATT.NET
Site Evaluator Name Printed ALBERT FRICK ASSOCIATES - 95A COUNTY ROAD ROAD GORHAM, MAINE 04038 - (207) 839-5563	Telephone Number (207) 839-5563	E-mail Address ALBERTFRICK@WORLDNET.ATT.NET

# SUBSURFACE WASTEWATER DISPOSAL SYSTEM APPLICATION

Maine Department of Human Services  
 Division of Health Engineering, Station 10 SHS  
 (207) 287-5672 FAX (207) 287-4172

Town, City, Plantation  
**PORTLAND**

Street, Road Subdivision  
**25 PENRITH STREET**

Owner's Name  
**FRANCES STAHL**

SITE PLAN

Scale 1" = 50 FT.  
 or as shown

SITE LOCATION PLAN  
 (Attach Map from Maine Atlas for New System Variance)

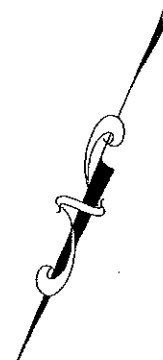
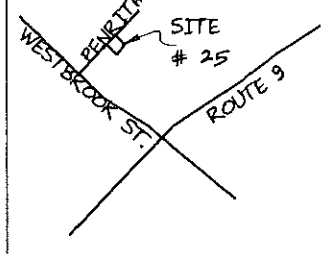
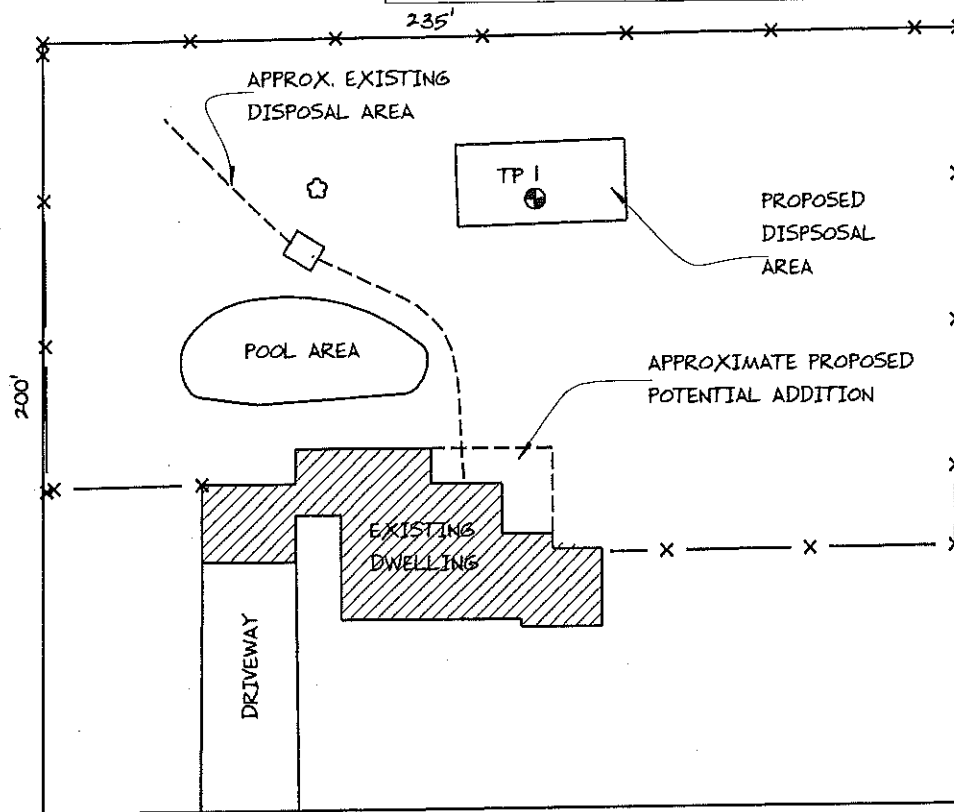

PENRITH STREET

## SOIL DESCRIPTION AND CLASSIFICATION (Location of Observation Holes Shown Above)

Observation Hole TP 1  Test Pit  Boring  
 " Depth of Organic Horizon Above Mineral Soil

DEPTH BELOW MINERAL SOIL SURFACE (inches)	Texture	Consistency	Color	Mottling
0				
10	FINE SANDY LOAM		DARK BROWN	
20		FRIABLE	LIGHT YELLOW BROWN	
30	FINE SAND		PALER YELLOW BROWN	FEW, FAINT
40		CEMENTED	YELLOW BROWN	FREE WATER
50				

Observation Hole           Test Pit  Boring  
 " Depth of Organic Horizon Above Mineral Soil

DEPTH BELOW MINERAL SOIL SURFACE (inches)	Texture	Consistency	Color	Mottling
0				
10				
20				
30				
40				
50				

Soil Classification S C Slope          %  
 Profile Condition Limiting Factor 29"  
 Ground Water  
 Restrictive Layer  
 Bedrock  
 Pit Depth

Soil Classification          Slope          %  
 Profile Condition Limiting Factor           
 Ground Water  
 Restrictive Layer  
 Bedrock  
 Pit Depth

*Albert Frick*  
 Site Evaluator Signature

163  
 SE

5/3/2004  
 Date

# SUBSURFACE WASTEWATER DISPOSAL SYSTEM APPLICATION

Moine Department of Human Services  
 Division of Health Engineering, Station 10 SHS  
 (207) 287-5672 FAX (207) 287-4172

Town, City, Plantation  
**PORTLAND**

Street, Road, Subdivision  
**25 PENRITH STREET**

Owner's Name  
**FRANCES STAHL**

## SUBSURFACE WASTEWATER DISPOSAL PLAN

SCALE 1" = 30' FT.

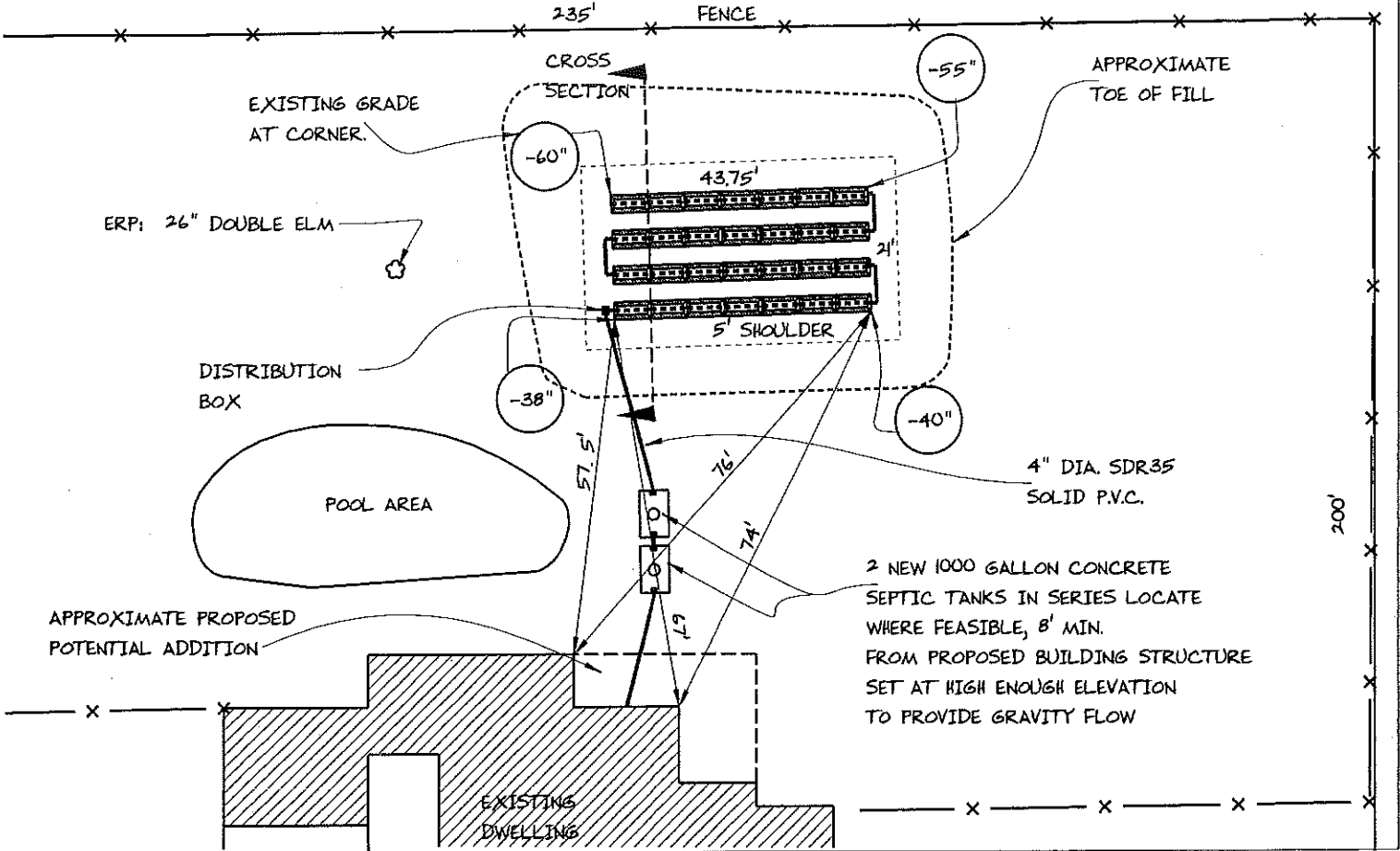

### FILL REQUIREMENTS

Depth of Fill (Upslope)	: 23" - 25"
Depth of Fill (Downslope)	: 25" - 30"
DEPTHS AT CROSS-SECTION (shown below)	

### CONSTRUCTION ELEVATIONS

Finished Grade Elevation
Top of Distribution Pipe or Proprietary Device
Bottom of Disposal Area

SEE  
 DETAIL  
 BELOW

### ELEVATION REFERENCE POINT

Location & Description  
 NAIL IN 26" DOUBLE ELM TREE, NAIL 20" ABOVE BASE  
 Reference Elevation is: 0.0' or -----

### DISPOSAL AREA CROSS SECTION

SCALE:  
 VERTICAL: 1" = 5 FT  
 HORIZONTAL: 1" = 10 FT

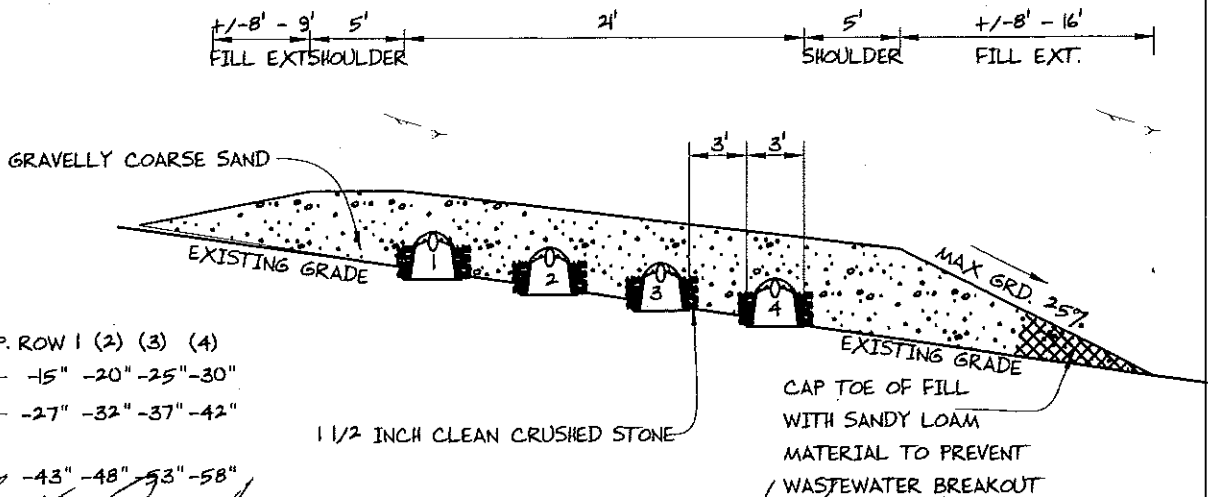

Site Evaluator Signature

163  
 SE \*

Date

Page 3 of 3  
 HHE-200 Rev. 10/02



**Albert Frick Associates, Inc.**

**Soil Scientists & Site Evaluators**

95A County Road Gorham, Maine 04038

(207) 839-5563

PORTLAND	25 PENRITH STREET	FRANCES STALL
TOWN	LOCATION	APPLICANT'S NAME

1) The Plumbing and Subsurface Wastewater Disposal Rules adopted by the State of Maine, Department of Human Services pursuant to 22 M.R.S.A. § 42 (the "Rules") are incorporated herein by reference and made a part of this application and shall be consulted by the owner/applicant, the system installer and/or building contractor for further construction details and material specifications. The system Installer should contact Albert Frick Associates, Inc. 839-5563, if there are any questions concerning materials, procedures or designs. The system installer and/or building contractor installing the system shall be solely responsible for compliance with the Rules and with all state and municipal laws and ordinances pertaining to the permitting, inspection and construction of subsurface wastewater disposal systems.

2) This application is intended to represent facts pertinent to the Rules only. It shall be the responsibility of the owner/applicant, system Installer and/or building contractor to determine compliance with and to obtain permits under all applicable local, state and/or federal laws and regulations (including, without limitation, Natural Resources Protection Act, wetland regulations, zoning ordinances, subdivision regulations, Site Location of Development Act and minimum lot size laws) before installing this system or considering the property on which the system is to be installed a "buildable" lot. It is recommended that a wetland scientist be consulted regarding wetland regulations.

Prior to the commencement of construction/installation, the local plumbing inspector shall inform the owner/applicant and Albert Frick Associates, Inc of any local ordinances which are more restrictive than the Rules in order that the design may be amended. All designs are subject to review by local, state and/or federal authorities. Albert Frick Associates, Inc.'s liability shall be limited to revisions required by regulatory agencies pursuant to laws or regulations in effect at the time of preparation of this application.

3) All information shown on this application relating to property lines, well locations, subsurface structures and underground facilities (such as utility lines, drains, septic systems, water lines, etc.) are based solely upon information provided by the owner/applicant and has been relied upon by Albert Frick Associates, Inc. in preparing this application. The owner/applicant shall review this application prior to the start of construction and confirm this information.

4) Installation of a garbage (grinder) disposal is not recommended. If one is installed, an additional 1000 gallon septic tank or a septic tank filter should be connected in series to the proposed septic tank.

5) The system user shall avoid introducing kitchen grease or fats into this system. Chemicals such as septic tank cleaners and/ or chlorine (such as from water treatment) and controlled or hazardous substances shall not be disposed of in this system.

PORTLAND

25 PENRITH STREET

FRANCES STALL

TOWN

LOCATION

APPLICANT'S NAME

6) The septic tank should be pumped within two years of installation and subsequently as recommended by the pump service, but in no event should the septic tank be pumped less often than every three years.

7) The actual water flow or number of bedrooms shall not exceed the design criteria indicated on this application without a re-evaluation of the system as proposed. If the system is supplied by public water or a private service with a water meter, the water consumption per period should be divided by the number of days to calculate the average daily water consumption (water usage (cu. ft.) x 7.48 cu. ft. (gallons per cu. ft.) divided by the # of days in period).

8) The general minimum setbacks between a well and septic system serving a single family residence is 100-300 feet, unless the local municipality has a more stringent requirement. A well installed by an abutter within the minimum setback distances prior to the issuance of a permit for the proposed disposal system may void this design.

9) When a gravity system is proposed: BEFORE CONSTRUCTION/INSTALLATION BEGINS, the system installer or building contractor shall review the elevations of all points given in this application and the elevation of the existing and/or proposed building drain and septic tank inverts for compatibility to minimum slope requirement. In gravity systems, the invert of the septic tank(s) outlet(s) shall be at least 4 inches above the invert of the distribution box outlet at the disposal area. When an effluent pump is required, provisions shall be made to make certain that surface ground water does not enter the septic tank or pump station. An alarm device warning of a pump failure shall be installed. Also, when pumping is required of a chamber system, install a "T" connection in the distribution box and place 3 inches of stone or a splash plate in the first chamber. Insulate gravity pipes, pump lines and the distribution box as necessary to prevent freezing.

10) On all systems, remove the vegetation, organic duff and old fill material from under the disposal area and any fill extension. On sites where the proposed system is to be installed in natural soil, scarify the bottom and sides of the excavated disposal area with a rake. Do not use wheeled equipment on the scarified soil surface. For systems installed in fill, scarify the native soil by roto-tilling to a depth of at least 8 inches over the entire disposal and fill extension area to prevent glazing and to promote fill bonding. Place fill in loose layers no deeper than 8 inches and compact thoroughly before placing more fill (this ensures that voids and loose pockets are eliminated to minimize the chance of leakage). Do not use wheeled equipment on the scarified soil area until after 12 inches of fill is in place. Keep equipment off the chambers. Divert the surface water away from the disposal area by ditching or shallow swales.

11) Unless noted otherwise, fill shall be gravelly coarse sand which contains no more than 5% fines (silt and clay).

12) Do not install systems on loamy, silty, or clayey soils during wet periods since soil smearing/glazing may seal off the soil interface.

13) Seed all filled and disturbed surfaces with perennial grass seed, then mulch with hay or equivalent



**Albert Frick Associates, Inc.**  
Soil Scientists & Site Evaluators

95A County Road Gorham, Maine 04038  
(207) 839-5563