



ARCHITECTS
 49 DARTMOUTH STREET
 PORTLAND, MAINE 04101
 207-775-1059
 www.pdtarchs.com

COPYRIGHT 2009
 PDT Architects
 Reuse or reproduction of the
 contents of this document is not
 permitted without written
 permission of PDT Architects.

Maine Eye Center - Stroudwater Crossing
 PORTLAND, MAINE

JOB NO.
09-006

DRWN. CHK
AJR

SCALE:
AS NOTED

ISSUE
PERMIT SET
19 MARCH 2009

TITLE
LIFE SAFETY PLAN

SHEET

LS

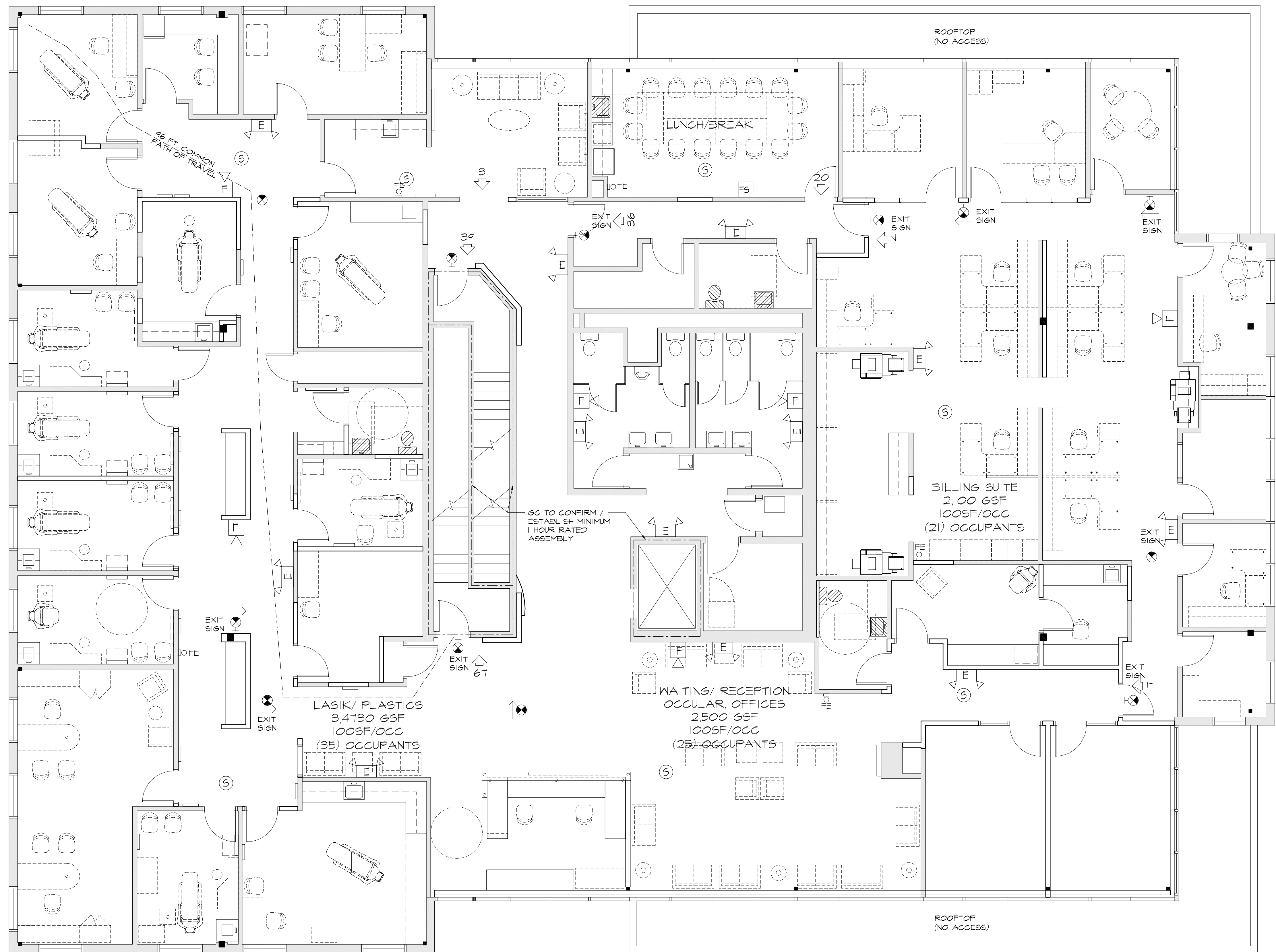

LIFE SAFETY & BUILDING CODE COMPLIANCE SUMMARY	
Building Code:	IBC 2003
Life Safety Code:	NFPA 2003
Occupancy	Existing Business
General Building Heights and Areas	
Allowable Height and Building Areas	Table 503 Business
Tabular Area (At) 23,000 sf/floor	Height - 4 stories
Area Modifications - 506	
Overall space	
Aa = At + [(At x If y/100) + [(At x Is y/100)	
At = 23000, If = 0%, Is = 300%	
Aa = 23000 + [(23000 x 0)/100] + [(23000 x 300)/100]	
Aa = 92,000 sf	
Actual sf = 32,134 sf	
Types of Construction	
IBC: Type IIB, unprotected - noncombustible	
Fire Protection Systems	
Existing sprinkler system to be recertified NFPA compliant supervised automatic sprinkler system.	
Most Restrictive Means of Egress Component Parameters	
Max Exit Travel Distance	IBC 1015.1 & NFPA 39.2.6.1 = 300ft
Min Corridor Width 7.3.4.1 - 36" (occupant load < 50)	39.2.3.2 - 44" (occupant load > 50)
Min Egress Width Table 7.3.3.1 (0.2"/person) > 32" @ doors	
Max Dead End Corridor: 39.2.5.2 (50 ft)	
Exits: 7.1.3.2.1 (1)(b) existing stair enclosure not less than 1 hour	
Common Path of Travel: 39.2.5.3.1 = 100 ft	

LIFE SAFETY PLAN
 3/16*11-C

GRAPHIC KEY 9,355 SQUARE FEET

COMMON PATH OF TRAVEL	SHADED AREA DESIGNATES DISPLAY SIDE
FIRE ALARM HORN / STROBE LIGHT	CEILING MOUNTED EXIT SIGN
EMERGENCY LIGHTING	ARROW SHOWS DIRECTIONAL SIGNAL
SMOKE DETECTOR	SHADED AREA DESIGNATES DISPLAY SIDE
FE LOCATION, REUSE EXIST. WHERE ACCEPTABLE	WALL MOUNTED EXIT SIGN
	OCCUPANT LOAD

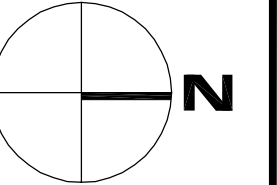

Mar 19, 2009 - 2:05pm

\\Pdt\fs1\Dat2\Master Proj Files2\Maine Eye Center\Maine Eye Stroudwater\CAD\MEEYE-plan.dwg