

Mar 19, 2009 - 2:06pm

\\Pdrfd\1\Dat2\Master Proj Files2\Maine Eye Center\Maine Eye Stroudwater\CAD\MEEYE-plan.dwg

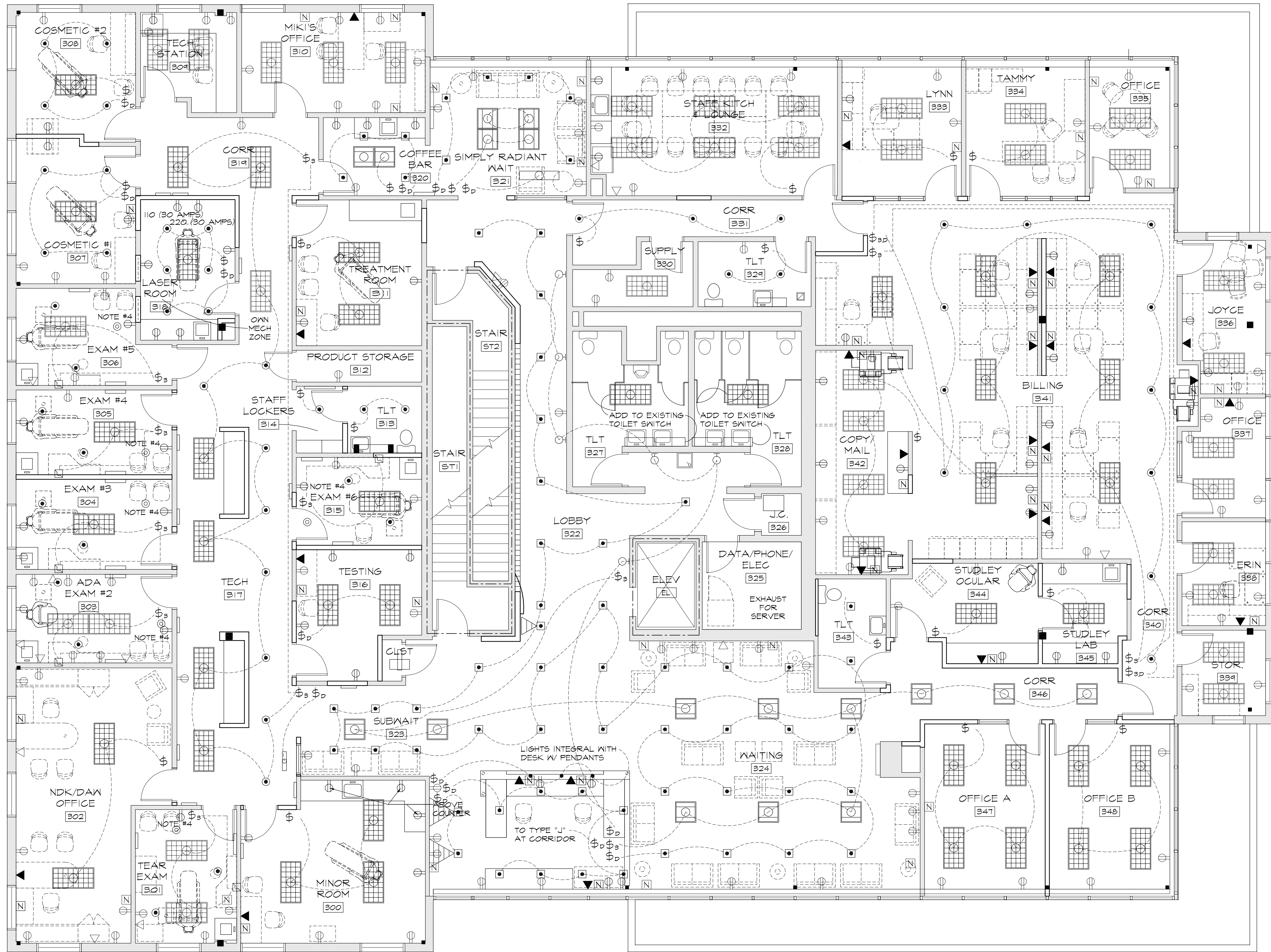

1 POWER / SWITCHING PLAN
3/16"=1'-0"

KEY

	LIGHTING FIXTURES, SEE DWG #A2 AND SPECS		BOX IN WALL FOR INTERFACE AT ALL REFRACTION DESKS DATA OUTLET
	ONE-WAY SWITCH		EXISTING TELEPHONE POWER AND DATA OUTLETS, CONFIRM ACTIVELY WIRED
	THREE-WAY SWITCH		NEW DUPLEX OUTLET
	DIMMABLE SWITCH		NEW DATA
			NEW TELEPHONE

NOTES:

- CONFIRM EXISTING POWER / DATA / TELEPHONE SHOWN TO REMAIN IS WIRED.
- NEW POWER / DATA SHOWN IS TO ACCOMMODATE PROPOSED TENANT FIT-UP. PROVIDE ADDITIONAL OUTLETS TO ACCOMMODATE CODE GUIDELINES
- PROVIDE LIFESAFETY EQUIPMENT AND LIGHTING AS REQUIRED PER CODE
- COORDINATE OUTLET HEIGHT WITH WALL MTD MONITOR

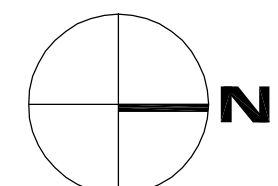

PDT
ARCHITECTS
49 DARTMOUTH STREET
PORTLAND, MAINE 04101
207-775-1059
www.pdtarch.com

COPYRIGHT 2009
PDT Architects
Reuse or reproduction of the contents of this document is not permitted without written permission of PDT Architects.

Maine Eye Center - Stroudwater Crossing
PORTLAND, MAINE

JOB NO.
09-006

DRWN. CHK
AJR

SCALE:
3/16"=1'-0"

ISSUE
PERMIT SET
19 MARCH 2009

TITLE
POWER / DATA AND
SWITCHING PLAN

SHEET
A5