

LIFE SAFETY & BUILDING CODE COMPLIANCE SUMMARY				
Building Code:		IBC 2003	Life Safety Code:	NFPA 2006
Occupancy		Existing Business		
General Building Heights and Areas				
Allowable Height and Building Areas				
Table 503 Business				
Tabular Area (At) 23,000 sqft/floor		Height - 4 stories		
Area Modifications - 506				
Overall space				
Aa = At + [(At x If y/100) + [(At x Is y/100]				
At = 23000, If = 0%, Is = 300%				
Aa = 23000 + [(23000 x0)/100] + [(23000 x 300)/100]				
Aa = 92,000 sqft				
Actual sf = 32,288 sf				
Frontage Increase - 506.2				
If = 100 (F/P - .25) W/30				
If = 100 (614/850 - .25) 30/30 = 47%				
Types of Construction				
IBC: Type VB, main structure IIB, VB due to wood framed unoccupied level in previously occupied space				
Fire Protection Systems				
Existing sprinkler system to be (re)certified NFPA compliant automatic sprinkler system.				
Most Restrictive Means of Egress Component Parameters				
Max Exit Travel Distance				
IBC 1015.1 & NFPA 39.2.6.1 = 300ft				
Min Corridor Width " 7.3.4.1 - 36" (occupant loads < 50)				
Min Egress Width Table 7.3.3.1 (2 in/person)				
Max Dead End Corridor 39.2.5.2 (50 ft)				

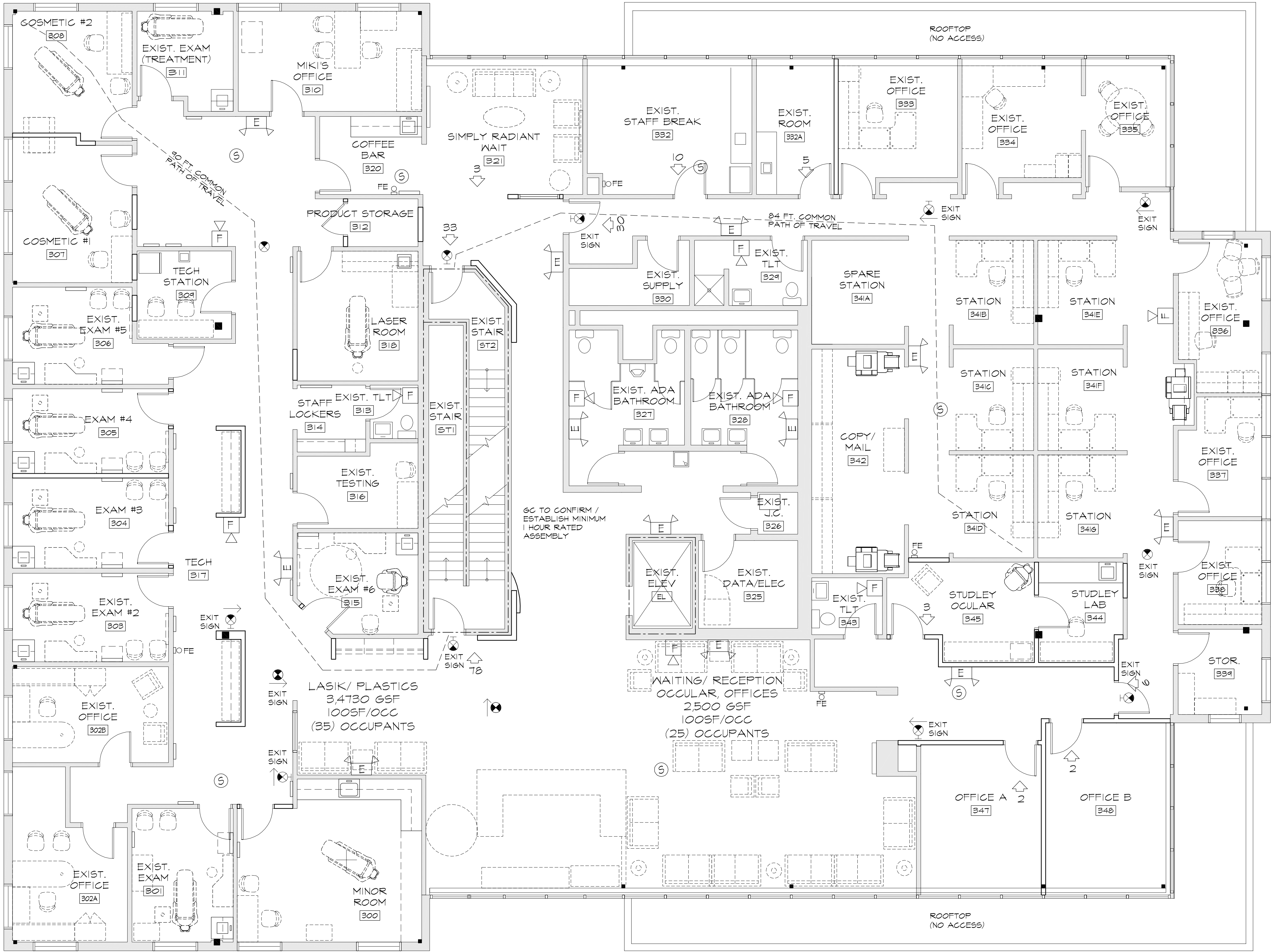

1 LIFE SAFETY PLAN
3/16"=1'-0"

GRAPHIC KEY

9,355 SQUARE FEET

COMMON PATH OF TRAVEL

FIRE ALARM HORN / STROBE LIGHT

EMERGENCY LIGHTING

SMOKE DETECTOR

FE LOCATION, REUSE EXIST. WHERE ACCEPTABLE

SHADED AREA DESIGNATES DISPLAY SIDE

ARROW SHOWS DIRECTIONAL SIGNAL

SHADED AREA DESIGNATES DISPLAY SIDE

OCCUPANT LOAD