

**Detailed IBC Code Review:**

303.1	No Change of use: from A-3 church space to A-3 Dance hall/gymnasium (Second floor: Business)		
503	A-3VB Construction	1 story	6,000sf
	B VB Construction	2 stories	9,000sf
508.4	Non-Sprinkled 2 hour separation (between A & B) (Fire Barriers)		
508.4.3	Assembly must be on first floor.		
707	Fire Barriers (existing)		
903.2.1.3	A-3 No sprinkler system required		
903.2.2	B No sprinkler system required		
907.2.1	A No Fire Alarm required		
907.2.2	B No Fire Alarm required		
1004.1.1	Occupant Load:		
	2 <sup>nd</sup> Floor Business Areas	2244sf 100 gross	23 people
	1 <sup>st</sup> Floor Exercise rooms	2244sf 50 gross	45 people
1014.3	Common path of travel limit: 75'		

**Detailed NFPA 101 Code Review:**

3.3.25.5	Existing Building		
6.1.2.1	Assembly Occupancy		
6.1.11.1	Business Occupancy		
6.1.14.4.1	1-hour separation (between Assembly<300 & Business)		
6.2.2.3	Ordinary Hazard contents		
7.3.1.2	Occupancy Load:		
	Exercise w/o equipment:	2244sf 15 gross	150 people
13	Existing Assembly		
13.1.6	V(000) permitted for occupancy under 300 on 1st floor		
13.3.4.1.1	No alarm system required		
13.3.5.1	No sprinkler system required		

**Detailed ADA Code Review:**

36.402	Alterations	
36.403	Path of Travel (disproportionality: 20%)	
	Priority List:	
	Entrance	
	Route to altered Area	
	Restroom	
	Phones	
	Drinking Fountains	
	Parking, storage, alarms etc	

**Plumbing Code:**

Table 4-1 only applies to changes of use resulting in an increased occupancy load

**Code Summary:**

Existing Use:	Group A-3
Proposed Use:	Group A-3
Existing fire protection:	Not sprinklered
Proposed fire protection:	Not sprinklered
Existing fire alarm:	No fire alarm in tenant space
Proposed fire alarm:	No fire alarm in tenant space
Gross Area:	2244sf (per floor)
Occupancy Load IBC:	45 Occupants
Occupant Load NFPA 101:	150 Occupants

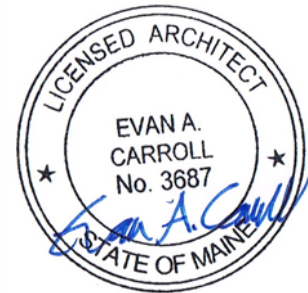

**APPLICANT:**  
 CREATING SPACE YOGA  
 CAROL COLSON  
 PO BOX 10801  
 PORTLAND, ME 04104  
 yogaforme2@yahoo.com  
 207-671-5972



Bild Architecture  
 PO Box 8235  
 Portland, ME 04104  
 207-408-0168  
 evan@bildarchitecture.com

PROJECT NO.  
14029  
PROJECT  
Yoga Studio

DRAWN BY  
EAC  
DESCRIPTION  
Permit Plan

ISSUE  
10.15.14  
SCALE  
1/8" = 1'-0"

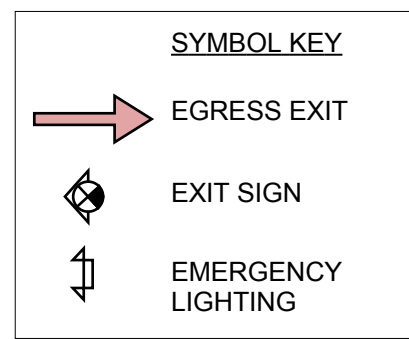
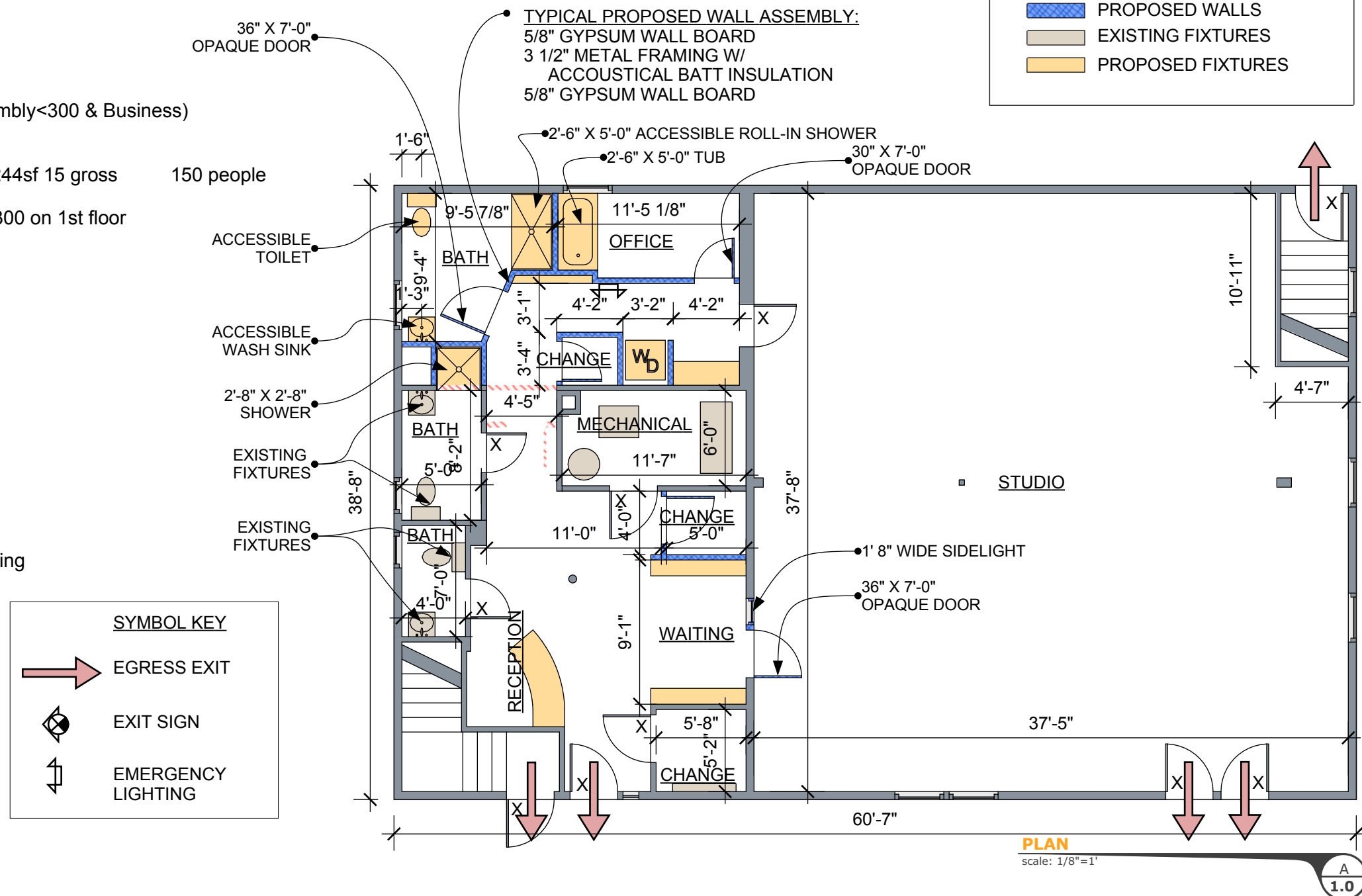
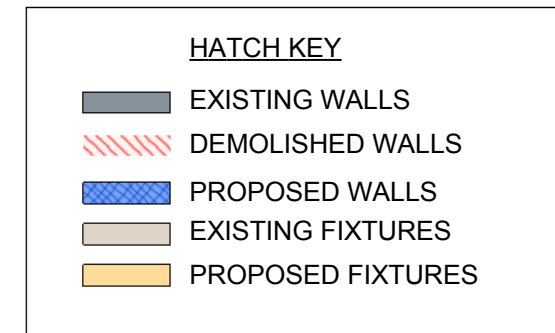
**A**  
1.0

**PLAN**  
scale: 1/8"=1'