

2x8 Stud

2x6 ceiling Joist + Strapping Drywall

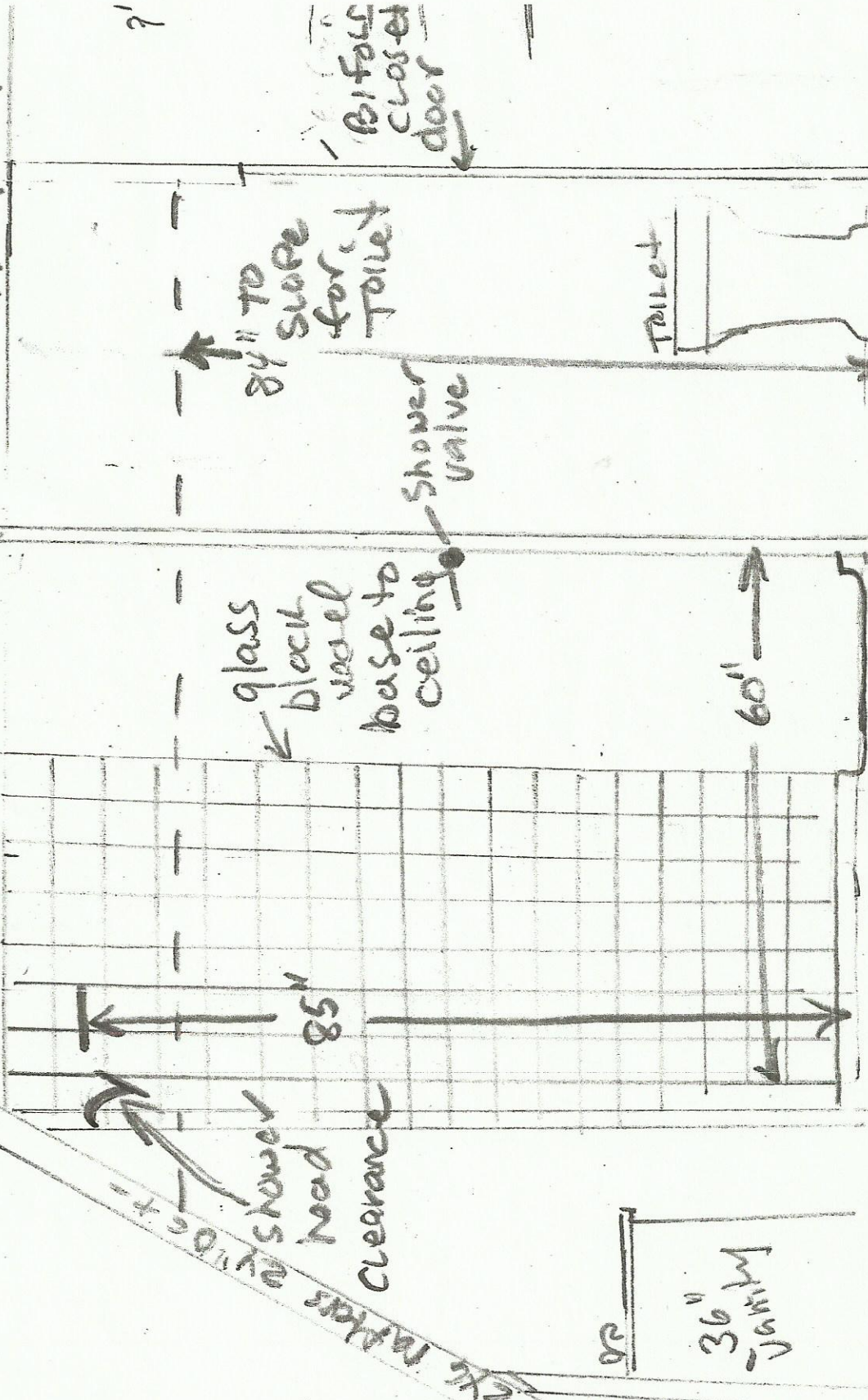

84" TO Slope for Toilet

Bifold closet door

Toilet

Shower valve

glass block wall base to ceiling

60"

85"

shower head clearance

36" Minimum
2x4 16" OC

EXISTING 2x4 16" OC

Proposed bath layout TRUGS 1600.