

1ST FLOOR - LIGHTING

SCALE: 1/8" = 1'-0"

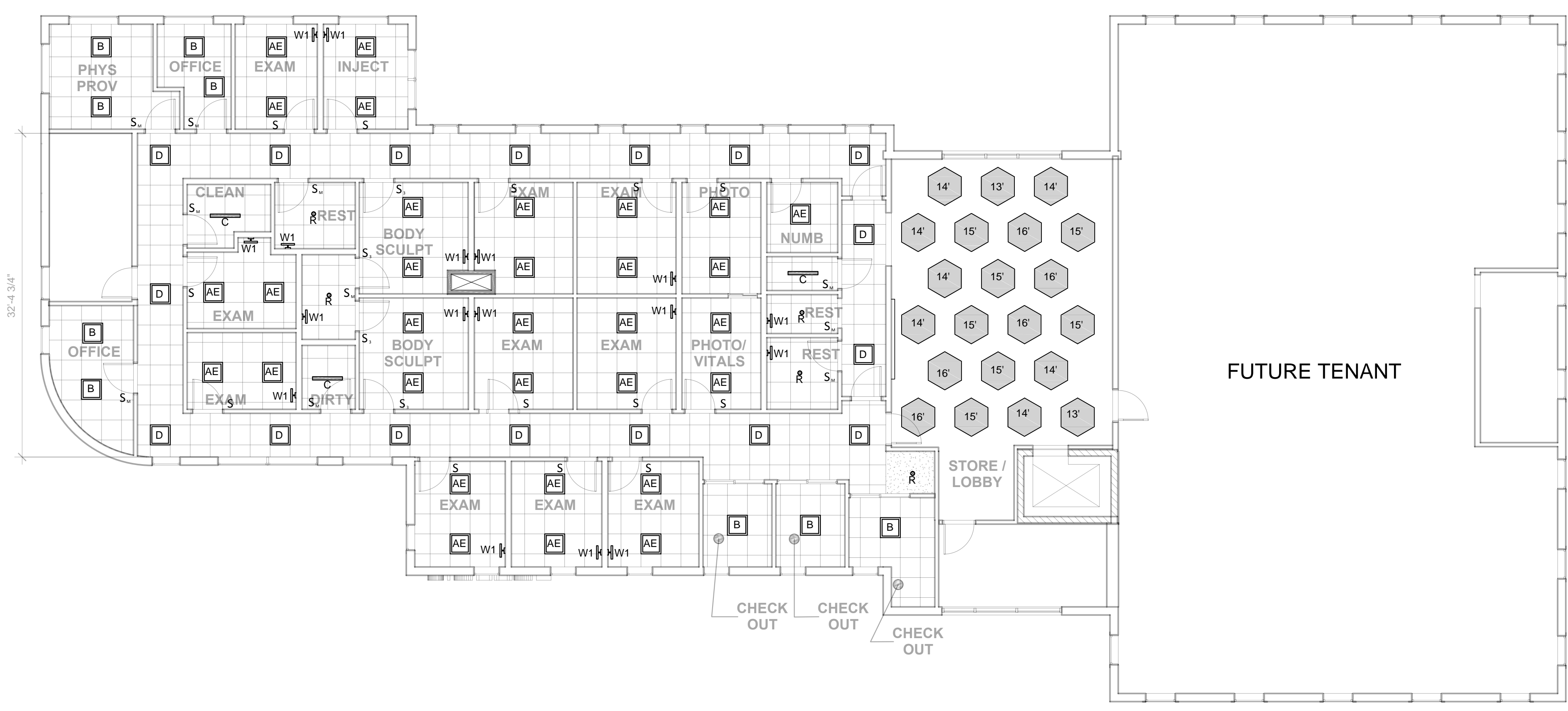

2ND FLOOR - LIGHTING

SCALE: 1/8" = 1'-0"

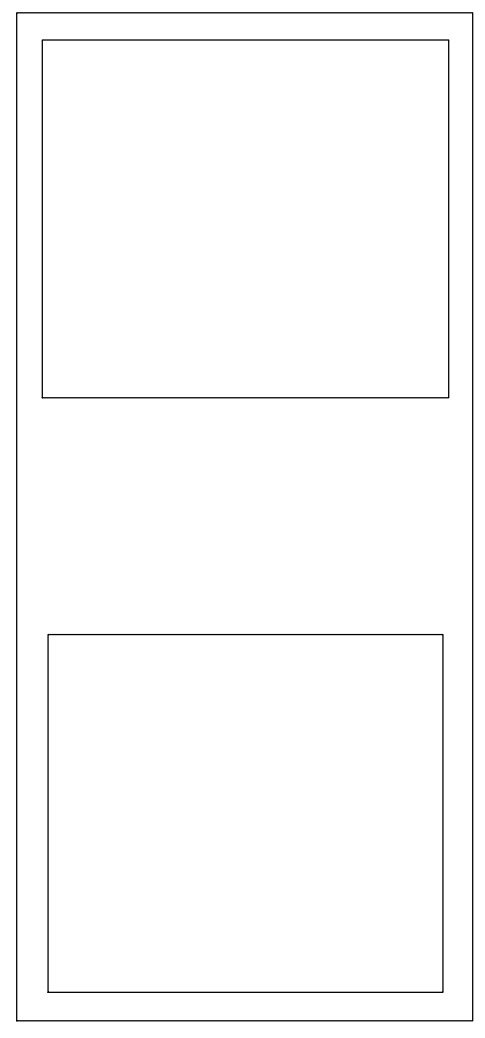

B.H. Milliken
ELECTRICAL CONTRACTORS
235 PRESUMPCOT STREET
PORTLAND, MAINE
04103
207.879.1877

MEDICAL OFFICES
DR. BEDECS
1945 CONGRESS STREET
PORTLAND, MAINE

TITLE:
LIGHTING

SCALE: 1/8" = 1'-0"

DATE: 5/22/17

SHEET:

E500