

SECTION 4  
3/4" = 1'-0"  
S1.0  
S1.1

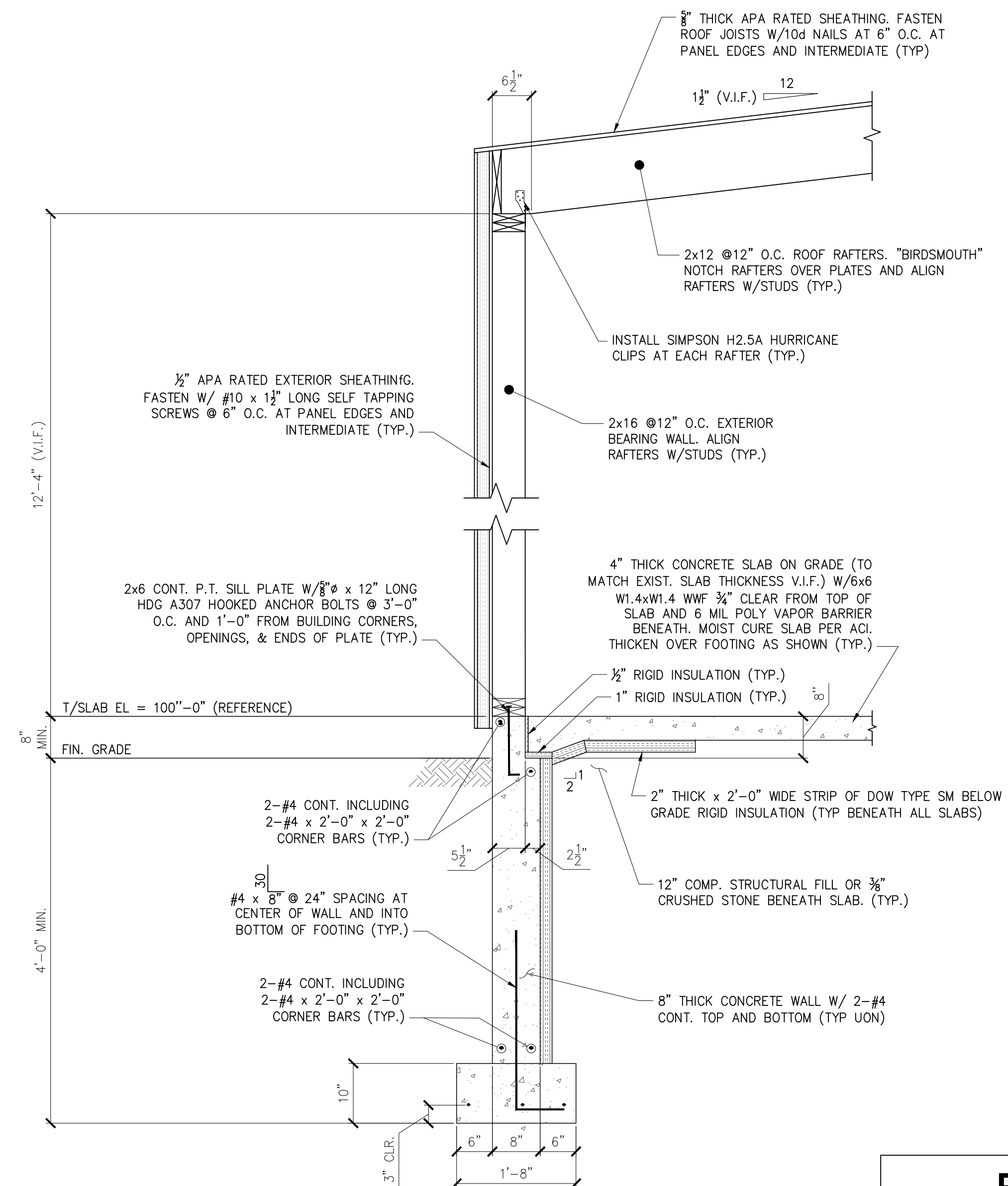

SECTION 5  
3/4" = 1'-0"  
S1.0  
S1.1

**PRELIMINARY  
NOT FOR CONSTRUCTION**

L & L STRUCTURAL  
ENGINEERING SERVICES, INC.  
SIX O STREET  
SOUTH PORTLAND, MAINE 04106  
PHONE: (207) 767-4830  
FAX: (207) 799-5432

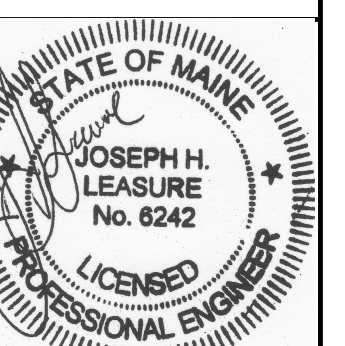

| rev. | date     | description                    | app'd |
|------|----------|--------------------------------|-------|
| A    | 01/26/17 | FOR PRICING & PERMIT           | JHL   |
| B    | 02/25/17 | REDESIGN, FOR COORD.           | JHL   |
| C    | 03/01/17 | REDESIGN, FOR PRICING & PERMIT | JHL   |

designed by: JHL  
drawn by: P.A.M.  
checked by: JHL  
scale: AS NOTED  
date: 12/19/2016  
plot date: 03/01/2017  
project #: 2014-1678

PORTLAND ELKS LODGE  
1945 CONGRESS STREET  
PORTLAND, MAINE  
BUILDING RENOVATIONS  
SECTION 4

**S3.2**

THESE DRAWINGS HAVE BEEN DEVELOPED BY L&L STRUCTURAL ENGINEERING SERVICES, INC. FOR THE TITLE SET ONLY. THE DRAWINGS ARE THE SOLE PROPERTY OF L&L ENGINEERING SERVICES, INC. AND THEY SHALL NOT BE USED, LENT, COPIED OR ALTERED WITHOUT THE WRITTEN CONSENT OF L&L STRUCTURAL ENGINEERING SERVICES, INC.