

1 | ORDER OF INSTALLATION OF WATERPROOFING AT WINDOWS
3/8" = 1'-0"

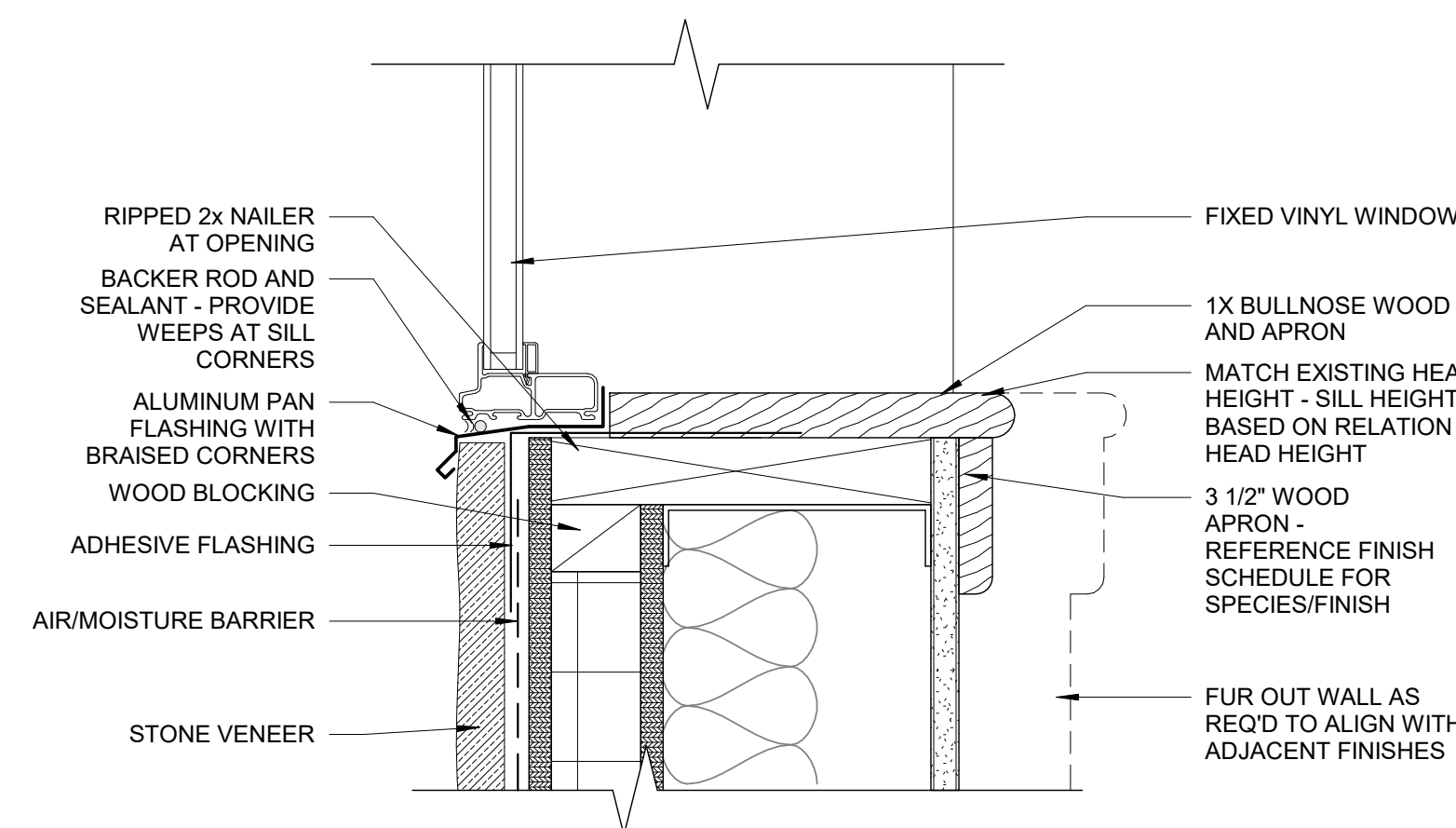

3 | TYP. WINDOW SILL SECTION AT SOUTH ELEVATION
3" = 1'-0"

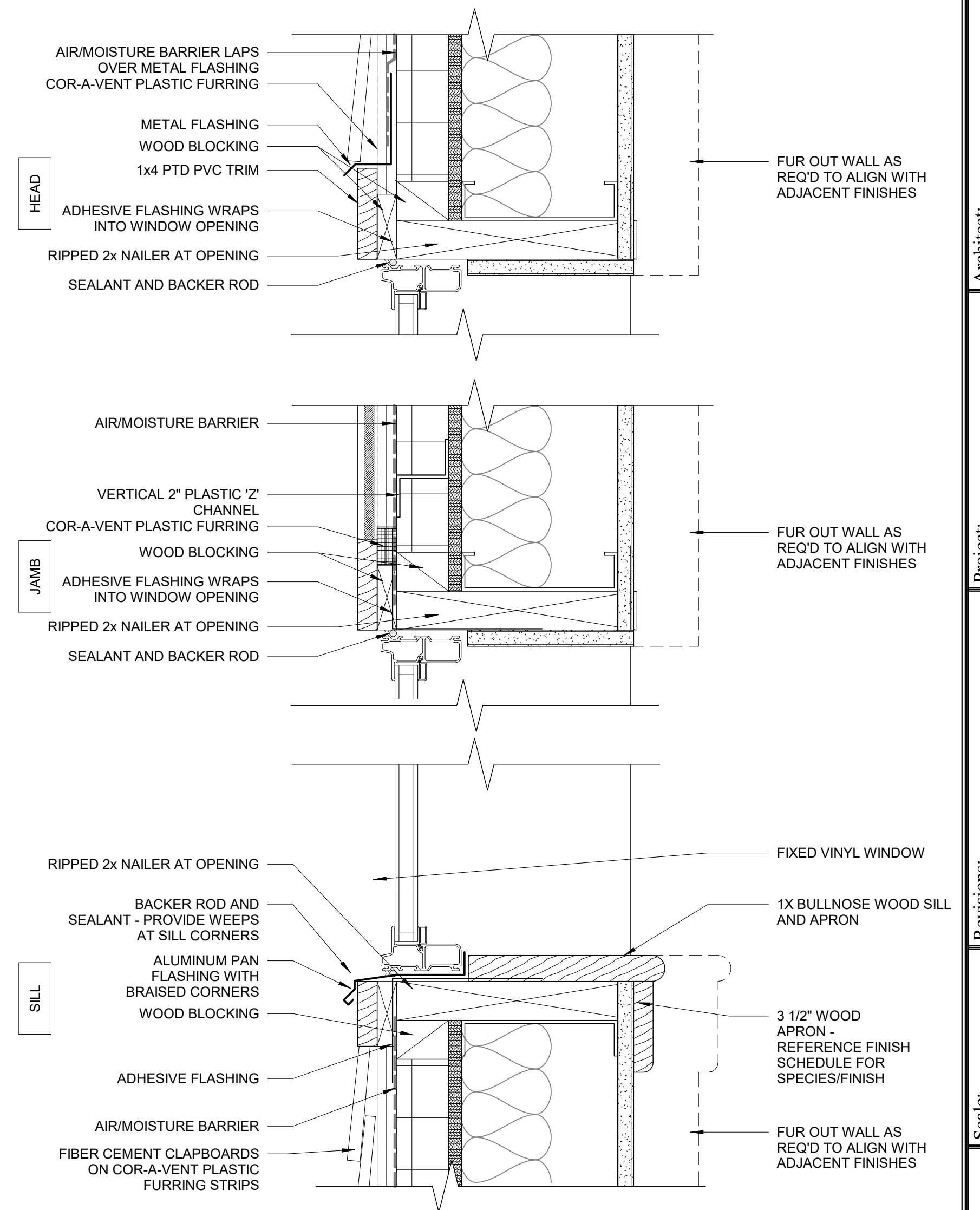

4 | TYPICAL WINDOW SECTION
3" = 1'-0"

PUBLIC AREA DOOR SCHEDULE											
DOOR No.	SIZE			DOOR				FRAME		CLOSER	REMARKS
	WIDTH	HEIGHT	THICKNESS	TYPE	MATERIAL	FINISH	THRESH	MATERIAL	LABEL		
GRADE											
001	6'-0"	7'-0"		1	AL		AL	STOREFRONT		Yes	
002	3'-0"	7'-0"	1 3/4"	3	INSUL-GALV	PTD	AL	EXISTING		Yes	VERIFY SIZE IN FIELD
003	3'-6"	7'-0"	1 3/4"	3	INSUL-GALV	PTD	AL	EXISTING		Yes	VERIFY SIZE IN FIELD
004	3'-0"	7'-0"		2	AL		AL	STOREFRONT		Yes	
005	3'-0"	7'-0"		2	AL		AL	STOREFRONT		Yes	
006	3'-0"	6'-6"		2	AL		AL	EXISTING		Yes	VERIFY SIZE IN FIELD
007	6'-0"	7'-0"		1	AL		AL	STOREFRONT		Yes	

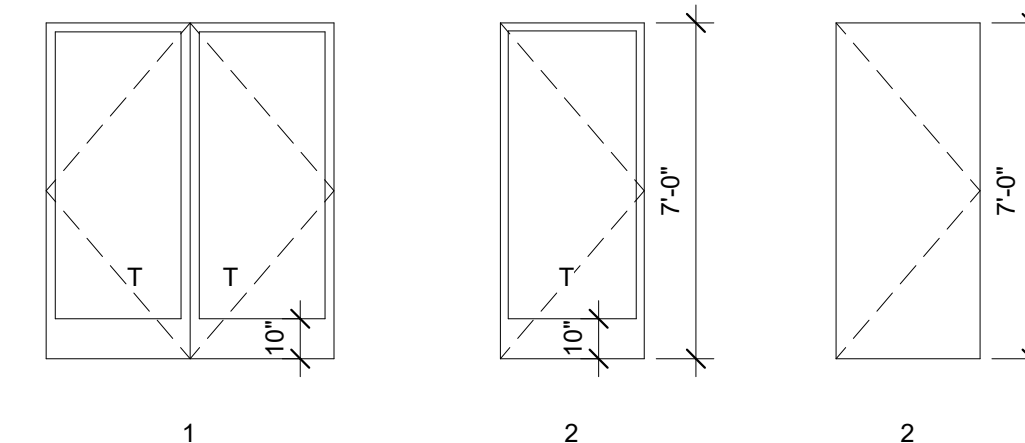

2 | DOOR LEAF ELEVATIONS
1/4" = 1'-0"

NOTE: COORDINATE ALL HARDWARE WITH OWNER

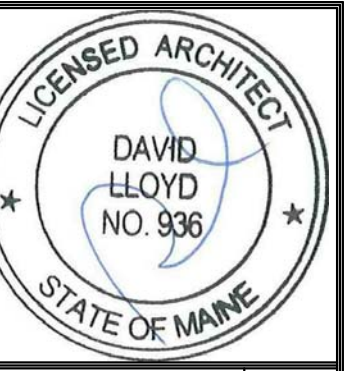

Prepared For:
Northland Management
Address
City, State

Consultant:

ARCHETYPE architects
48 Union Wharf Portland, Maine 04101
(207) 772-6022 ARCHETYPE@ARCHETYPEPA.COM

Architect:

Elks Lodge

Project:

Portland, Maine

Revisions:
1 03/01/17 REDESIGN

Date: 01/26/2017
Scale: As indicated
DOOR AND WINDOW SCHEDULE

Date: 01/26/2017

A8.02