

Prepared For: **Northland Management**  
17 South St., 3rd floor  
Portland, ME

Consultant: **ARCHETYPE architects**  
48 Union Wharf Portland, Maine 04101  
(207) 772-6022 ARCHETYPE@ARCHETYPEPA.COM

Project: **Elks Lodge**  
Portland, Maine

Revisions:  
Date: 01/26/2017  
Scale: 1/8" = 1'-0"  
**LIFE SAFETY**

**LS1.1**

FIRE EXTINGUISHER	●
MAX TRAVEL DISTANCE	-----
DEAD END CORR. TRAVEL LENGTH	- - - -
COMMON PATH OF TRAVEL LENGTH	→
EXIT ENTRANCE	⊕
EXIT ENTRANCE	→

**LIFE SAFETY LEGEND**  
1/8" = 1'-0"

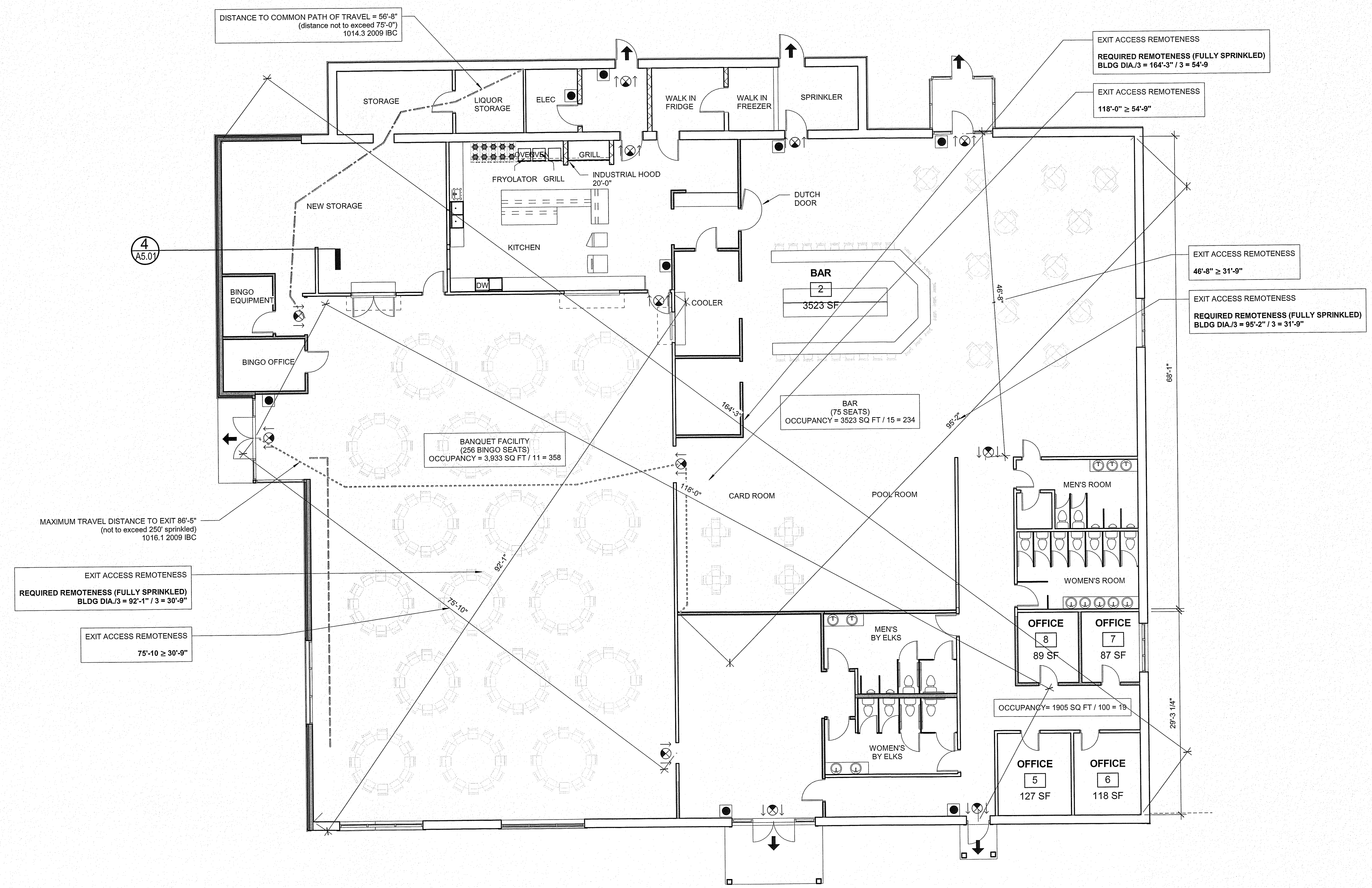

**1 | 1ST FLOOR LIFE SAFETY PLAN** 13,447 SQ FT  
1/8" = 1'-0"