



DISPLAY THIS CARD ON PRINCIPAL FRONTAGE OF WORK



CITY OF PORTLAND

BUILDING

PERMIT

This is to certify that PROPERTIES LLC MN

Located At 2063 CONGRESS

Job ID: 2011-01-337-SIGN

CBL: 215 - - B - 004 - 001 - - - -

has permission to Face Replacement Mortgage Network Sign

provided that the person or persons, firm or corporation accepting this permit shall comply with all of the provisions of the Statutes of Maine and of the Ordinances of the City of Portland regulating the construction, maintenance and use of the buildings and structures, and of the application on file in the department.

Notification of inspection and written permission procured before this building or part thereof is lathed or otherwise closed-in. 48 HOUR NOTICE IS REQUIRED.

A final inspection must be completed by owner before this building or part thereof is occupied. If a certificate of occupancy is required, it must be procured prior to occupancy.

Fire Prevention Officer

Code Enforcement Officer / Plan Reviewer

THIS CARD MUST BE POSTED ON THE STREET SIDE OF THE PROPERTY.
PENALTY FOR REMOVING THIS CAR

PERMIT ISSUED

FEB - 1 2011

City of Portland

City of Portland, Maine - Building or Use Permit Application
 389 Congress Street, 04101 Tel: (207) 874-8703, FAX: (207) 8716

Job No: 2011-01-337-SIGN	Date Applied: 1/25/2011	CBL: 215 - - B - 004 - 001 - - - -	
Location of Construction: 2063 CONGRESS (2059)	Owner Name: PROPERTIES LLC MN	Owner Address: 300 ROSEWOOD DR DANVERS, MA - MASSACHUSETTS 01923	Phone:
Business Name:	Contractor Name: Sign Design, Inc, Roger	Contractor Address: 207 P.O. Box WESTBROOK MAINE04098	Phone: 856-2600
Lessee/Buyer's Name:	Phone:	Permit Type: SIGN - PERM - Signage - Permanent	Zone: R-P
Past Use: Professional Office - "Mortgage Network"	Proposed Use: Professional Office - "Mortgage Network"	Cost of Work:	CEO District:
		Fire Dept: <input type="checkbox"/> Approved <input type="checkbox"/> Denied <input type="checkbox"/> N/A	Inspection: Use Group: Type: Sign Signature: <i>[Signature]</i>
Proposed Project Description: 2059 Congress Mortgage Network - replace panel in existing building sign		Pedestrian Activities District (P.A.D.)	

Permit Taken By:	Zoning Approval		
1. This permit application does not preclude the Applicant(s) from meeting applicable State and Federal Rules. 2. Building Permits do not include plumbing, septic or electrical work. 3. Building permits are void if work is not started within six (6) months of the date of issuance. False information may invalidate a building permit and stop all work. <div style="text-align: center; font-size: 24px; font-weight: bold;">PERMIT ISSUED</div> <div style="text-align: center;">FEB - 1 2011</div>	Special Zone or Reviews <input type="checkbox"/> Shoreland <input type="checkbox"/> Wetlands <i>- existing sign</i> <input type="checkbox"/> Flood Zone <i>legally nonconforming</i> <input type="checkbox"/> Subdivision <input type="checkbox"/> Site Plan _ Maj _ Min _ MM Date: <i>OK with condition</i> <i>1/27/11 ABW</i>	Zoning Appeal <input type="checkbox"/> Variance <input type="checkbox"/> Miscellaneous <input type="checkbox"/> Conditional Use <input type="checkbox"/> Interpretation <input type="checkbox"/> Approved <input type="checkbox"/> Denied Date:	Historic Preservation <input checked="" type="checkbox"/> Not in Dist or Landmark <input type="checkbox"/> Does not Require Review <input type="checkbox"/> Requires Review <input type="checkbox"/> Approved <input type="checkbox"/> Approved w/Conditions <input type="checkbox"/> Denied Date: <i>ASM</i>
	CERTIFICATION		

I hereby certify that I am the owner of record of the named property, or that the proposed work is authorized by the owner of record and that I have been authorized by the owner to make this application as his authorized agent and I agree to conform to all applicable laws of this jurisdiction. In addition, if a permit for work described in the application is issued, I certify that the code official's authorized representative shall have the authority to enter all areas covered by such permit at any reasonable hour to enforce the provision of the code(s) applicable to such permit.

SIGNATURE OF APPLICANT	ADDRESS	DATE	PHONE
RESPONSIBLE PERSON IN CHARGE OF WORK, TITLE	DATE	PHON	

Job Summary Report
Job ID: 2011-01-337-SIGN

Report generated on Jan 25, 2011 2:51:36 PM

Location Id	Structure Description	Permit Status	Permit Description	Issue Date	Reissue Date	Expiration Date		
29072	Commercial / Mortgage Network	Initialized	Face Replacement Mortgage Network					
Inspection Details								
Inspection Id	Inspection Type	Inspection Result Status	Inspection Status Date	Scheduled Start Timestamp	Result Status Date	Final Inspection Flag		
Fees Details								
Fee Code Description	Charge Amount	Permit Charge Adjustment	Permit Charge Adj Remark	Payment Date	Receipt Number	Payment Amount	Payment Adjustment Amount	Payment Adj Comment
Signs	\$102.00							



Signage/Awning Permit Application

If you or the property owner owes real estate or personal property taxes or user charges on any property within the City, payment arrangements must be made before permits of any kind are accepted.

Location/Address of Construction: <u>2059 Congress St. (2663)</u>		
Tax Assessor's Chart, Block & Lot Chart# <u>215</u> Block# <u>B</u> Lot# <u>4</u>	Owner: <u>MN Properties</u>	Telephone: <u>JEFF EAE</u> <u>761-1653</u>
Lessee/Buyer's Name (If Applicable)	Contractor name, address & telephone: <u>Sign Design, Inc.</u> <u>P.O. Box 207</u> <u>Westbrook, ME 04098</u> <u>856-2600</u>	Total s.f. of signage \times \$2.00 Per s.f. plus \$30.00/\$65.00 For H.D. signage= Total Fee: \$ _____ Awning Fee= cost of work _____ Total Fee: \$ _____
Who should we contact when the permit is ready: <u>Roger/Diana</u> phone: <u>856-2600</u>		
Tenant/allocated building space frontage (feet): Length: <u>84'</u> Height: <u>20'</u> Lot Frontage (feet) <u>300'</u> <u>Single Tenant</u> or Multi Tenant Lot <u>single</u>		
Current Specific use: <u>offices</u> If vacant, what was prior use: <u>N/A</u> Proposed Use: _____		
Information on proposed sign(s): <u>face replacement</u> Freestanding (e.g., pole) sign? Yes ___ No ___ Dimensions proposed: _____ Height from grade: _____ Bldg. wall sign? (attached to bldg) Yes <u>X</u> No ___ Dimensions proposed: <u>29 3/4" X 174"</u> (<u>36 SF</u>)		
Proposed awning? Yes ___ No <u>X</u> Is awning backlit? Yes ___ No ___ Height of awning: _____ Length of awning: _____ Depth: _____ Is there any communication, message, trademark or symbol on it? Yes ___ No ___ If yes, total s.f. of panels w/communications, message, trademark or symbol: _____ s.f.		
Information on existing and previously permitted sign(s): Freestanding (e.g., pole) sign? Yes ___ No ___ Dimensions: _____ Bldg. wall sign? (attached to bldg) Yes ___ No ___ Dimensions: <u>30" X 174"</u> <u>36 SF</u> Awning? Yes ___ No ___ Sq. ft. area of awning w/communication: _____		
A site sketch and building sketch showing exactly where existing and new signage is located <u>City of Portland Maine</u> Sketches and/or pictures of proposed signage and existing building are also required.		

RECEIVED

Dept. of Building Inspections

Please submit all of the information outlined in the Sign/Awning Application Checklist. Failure to do so may result in the automatic denial of your permit.

In order to be sure the City fully understands the full scope of the project, the Planning and Development Department may request additional information prior to the issuance of a permit. For further information visit us on-line at www.portlandmaine.gov, stop by the Building Inspections office, room 315 City Hall or call 874-8703.

I hereby certify that I am the Owner of record of the named property, or that the owner of record authorizes the proposed work and that I have been authorized by the owner to make this application as his/her authorized agent. I agree to conform to all applicable laws of this jurisdiction. In addition, if a permit for work described in this application is issued, I certify that the Code Official's authorized representative shall have the authority to enter all areas covered by this permit at any reasonable hour to enforce the provisions of the codes applicable to this permit.

Signature of applicant: Diana Olmstead Date: 1/18/11

This is not a permit; you may not commence ANY work until the permit is issued.

* building sign previously permitted - # 93-0411
legally non conforming OK - same size.



Sign Contractors

P.O. Box 207
Westbrook, ME 04098
(207) 858-2600 * FAX: (207) 858-7600
1-800-948-9037
signdest@maine.rr.com
A Full Service Sign Company

RE:

To Whom It May Concern:

As the owner (or owner representative) of the property located at:

2059 Congress St, Portland, ME 04102

I authorize Sign Design Inc. to install signs/sign face replacements as detailed on attached paperwork.

[Signature]
Signature *Treasurer*
MN Properties, LLC

1/7/2011
Date

Albert Paré III
Print Name

RECEIVED
JAN 20 2011
Dept. of Building Inspections
City of Portland Maine

Michaud, Rowe And Ruscak Ins.
P.O. Box 188
North Andover MA 01845
Phone: 978 688 8829 Fax: 978 557 2130

THIS CERTIFICATE IS ISSUED AS A MATTER OF INFORMATION ONLY AND CONFERS NO RIGHTS UPON THE CERTIFICATE HOLDER. THIS CERTIFICATE DOES NOT AMEND, EXTEND OR ALTER THE COVERAGE AFFORDED BY THE POLICIES BELOW.

INSURED Mortgage Network, Inc. MN Properties, LLC 300 Rosewood Drive Danvers MA 01923	INSURERS AFFORDING COVERAGE		NAIC #
	INSURER A:	Hanover Insurance Company	22292
	INSURER B:		
	INSURER C:		
	INSURER D:		
	INSURER E:		

COVERAGES

THE POLICIES OF INSURANCE LISTED BELOW HAVE BEEN ISSUED TO THE INSURED NAMED ABOVE FOR THE POLICY PERIOD INDICATED. NOTWITHSTANDING ANY REQUIREMENT, TERM OR CONDITION OF ANY CONTRACT OR OTHER DOCUMENT WITH RESPECT TO WHICH THIS CERTIFICATE MAY BE ISSUED OR MAY PERTAIN, THE INSURANCE AFFORDED BY THE POLICIES DESCRIBED HEREIN IS SUBJECT TO ALL THE TERMS, EXCLUSIONS AND CONDITIONS OF SUCH POLICIES. AGGREGATE LIMITS SHOWN MAY HAVE BEEN REDUCED BY PAID CLAIMS.

NSR ADD'L LTR	INSRD	TYPE OF INSURANCE	POLICY NUMBER	POLICY EFFECTIVE DATE (MM/DD/YYYY)	POLICY EXPIRATION DATE (MM/DD/YYYY)	LIMITS
A		GENERAL LIABILITY <input checked="" type="checkbox"/> COMMERCIAL GENERAL LIABILITY <input type="checkbox"/> CLAIMS MADE <input checked="" type="checkbox"/> OCCUR GEN'L AGGREGATE LIMIT APPLIES PER: <input type="checkbox"/> POLICY <input type="checkbox"/> PRO-JECT <input type="checkbox"/> LOC	OBN5689028	01/01/11	01/01/12	EACH OCCURRENCE DAMAGE TO RENTED PREMISES (Ea occurrence) \$ 200000 DAMAGE TO RENTED PREMISES (Ea occurrence) \$ 300000 MED EXP (Any one person) \$ 5000 PERSONAL & ADV INJURY \$ 2000000 GENERAL AGGREGATE \$ 4000000 PRODUCTS - COMP/OP AGG \$ 4000000
		AUTOMOBILE LIABILITY <input type="checkbox"/> ANY AUTO <input type="checkbox"/> ALL OWNED AUTOS <input type="checkbox"/> SCHEDULED AUTOS <input type="checkbox"/> HIRED AUTOS <input type="checkbox"/> NON-OWNED AUTOS				COMBINED SINGLE LIMIT (Ea accident) \$ BODILY INJURY (Per person) \$ BODILY INJURY (Per accident) \$ PROPERTY DAMAGE (Per accident) \$
		GARAGE LIABILITY <input type="checkbox"/> ANY AUTO				AUTO ONLY - EA ACCIDENT \$ OTHER THAN EA ACC \$ AUTO ONLY: AGG \$
		EXCESS / UMBRELLA LIABILITY <input type="checkbox"/> OCCUR <input type="checkbox"/> CLAIMS MADE DEDUCTIBLE RETENTION \$				EACH OCCURRENCE \$ AGGREGATE \$ \$ \$
A		WORKERS COMPENSATION AND EMPLOYERS' LIABILITY ANY PROPRIETOR/PARTNER/EXECUTIVE OFFICER/MEMBER EXCLUDED? (Mandatory in NH) If yes, describe under SPECIAL PROVISIONS below OTHER <input type="checkbox"/> Y/N	WHN6288598	01/31/11	01/31/12	<input checked="" type="checkbox"/> WC STATU-TORY LIMITS <input type="checkbox"/> OTH-ER E.L. EACH ACCIDENT \$ 1000000 E.L. DISEASE - EA EMPLOYEE \$ 1000000 E.L. DISEASE - POLICY LIMIT \$ 1000000
A		Hanover Insurance	OBN5689028	01/01/11	01/01/12	

DESCRIPTION OF OPERATIONS / LOCATIONS / VEHICLES / EXCLUSIONS ADDED BY ENDORSEMENT / SPECIAL PROVISIONS

Office location: 2059 Congress St., Portland, ME 04102
City of Portland is named as an additional insured with respect to liability arising out of the use of the described premises, including the exterior sign.

CERTIFICATE HOLDER

PORTLA2
City of Portland
Code Enforcement
239 Park Ave.
Portland ME 04102

CANCELLATION

SHOULD ANY OF THE ABOVE DESCRIBED POLICIES BE CANCELLED BEFORE THE EXPIRATION DATE THEREOF, THE ISSUING INSURER WILL ENDEAVOR TO MAIL _____ DAYS WRITTEN NOTICE TO THE CERTIFICATE HOLDER NAMED TO THE LEFT, BUT FAILURE TO DO SO SHALL IMPOSE NO OBLIGATION OR LIABILITY OF ANY KIND UPON THE INSURER, ITS AGENTS OR REPRESENTATIVES.
AUTHORIZED REPRESENTATIVE

ACORD 25 (2009/01)

© 1988-2009 ACORD CORPORATION. All rights reserved.

The ACORD name and logo are registered marks of ACORD

RECEIVED
JAN 20 2011
City of Portland Insurance Services

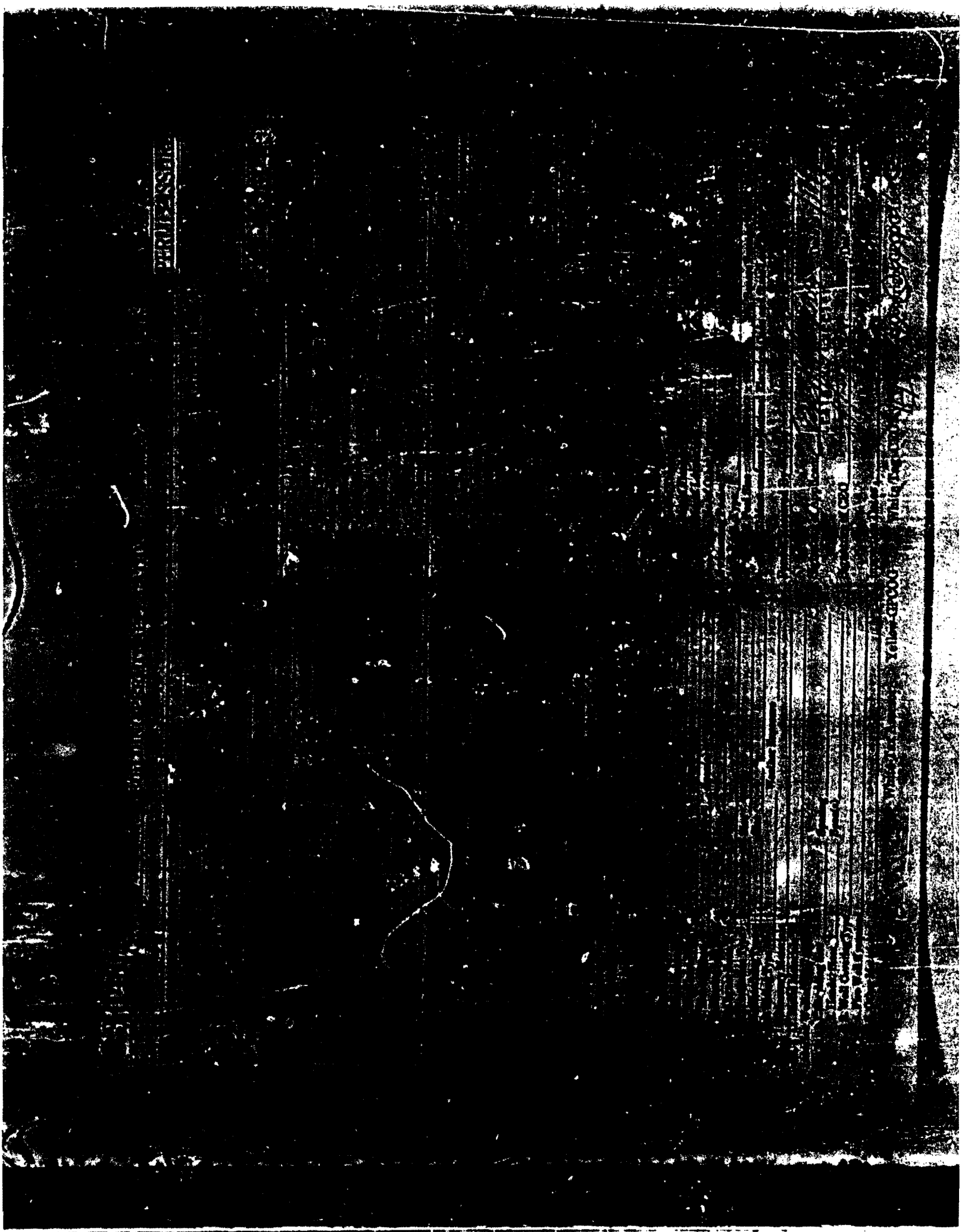

ALL INFORMATION CONTAINED HEREIN IS UNCLASSIFIED DATE 08-08-00 BY 60320 JAL/STP

10/10/10

10/10/10

10/10/10

Comptrol 54

10/10/10

10/10/10

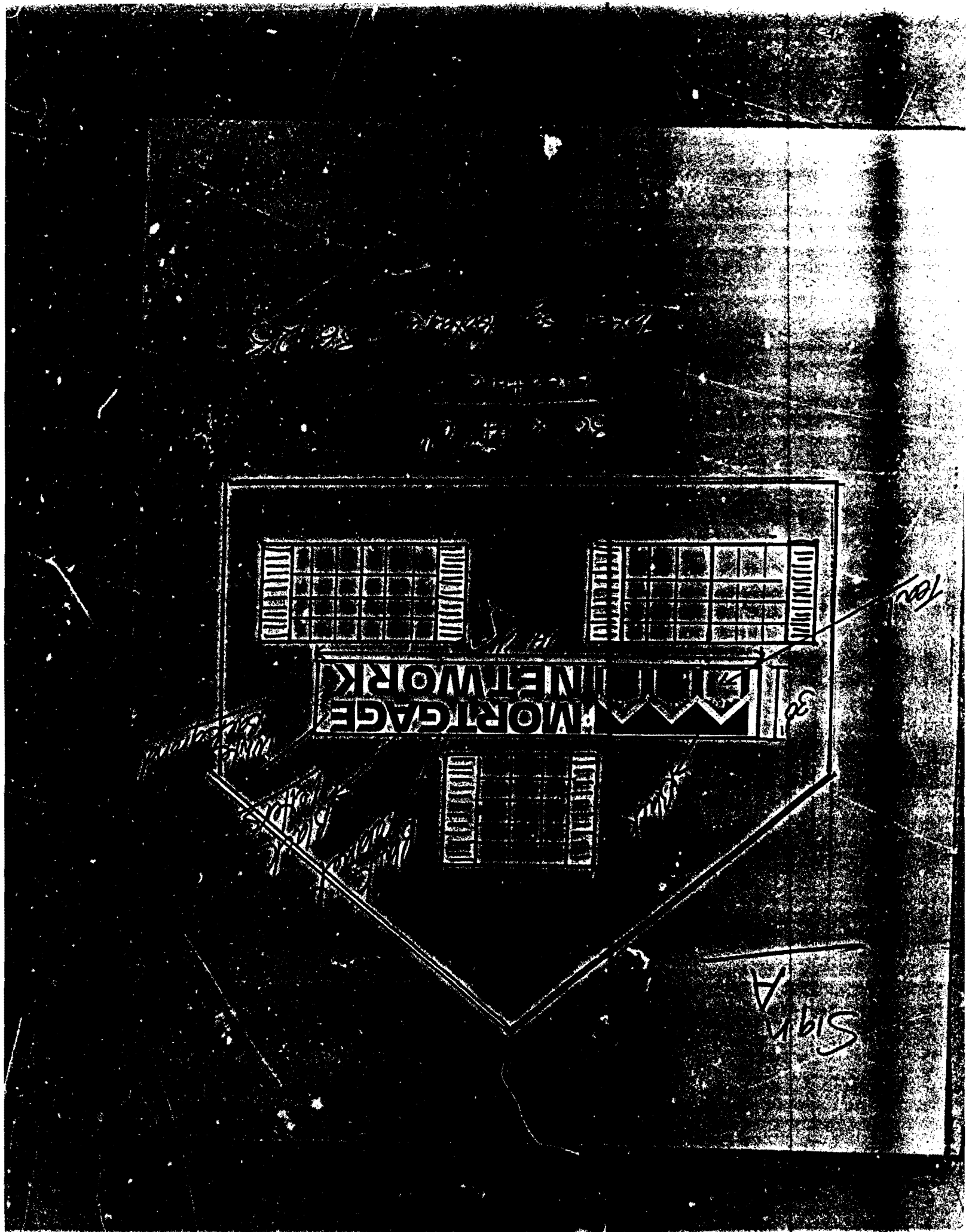



2059 - Existing face
replacing yellowed substrate
w/new

NOT TO SCALE

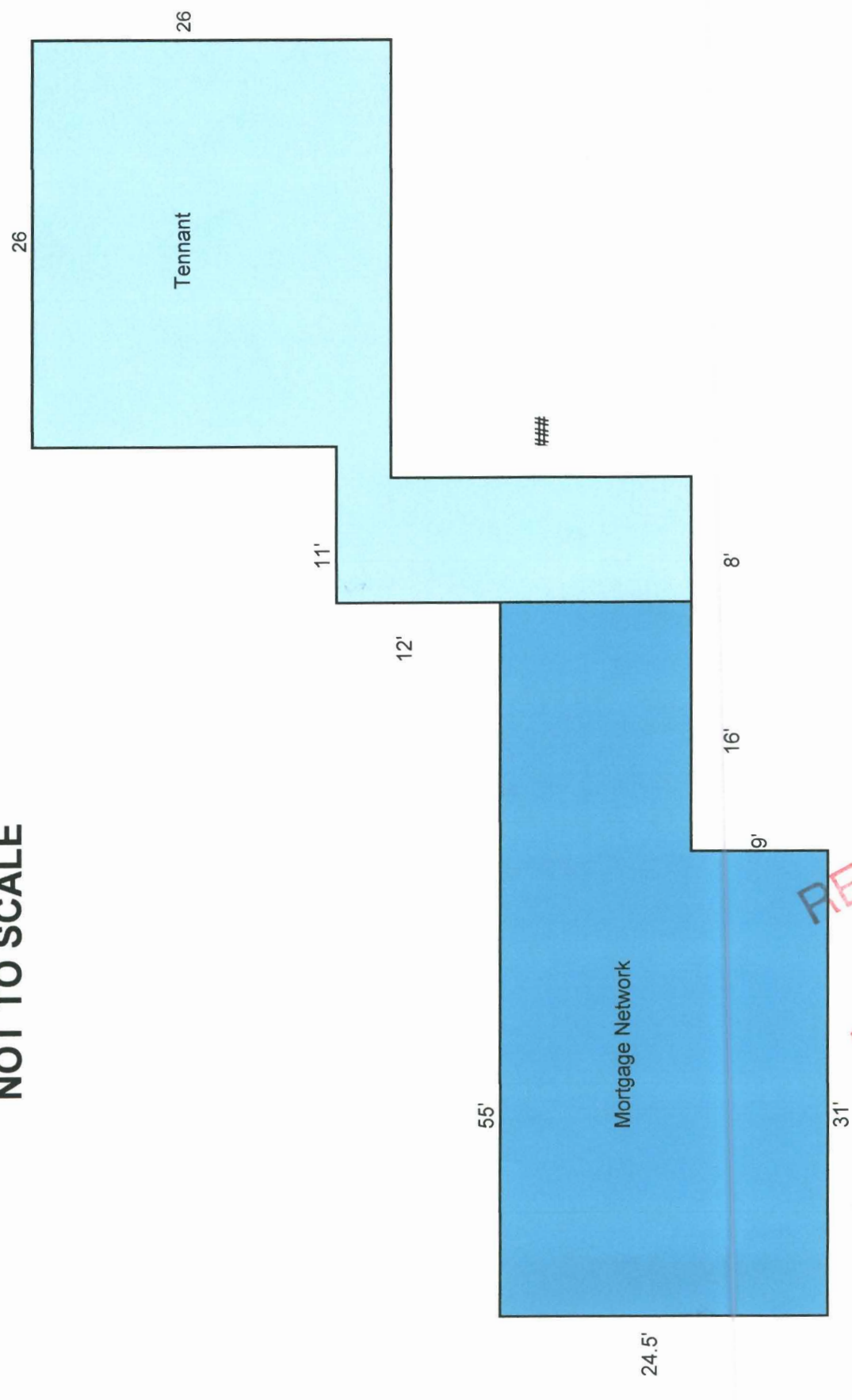

RECEIVED
JAN 20 2011
Dept. of Building Inspections
City of Portland Maine

This Design Is The Property Of Sign Design Inc.
306 Warren Ave. Portland, ME
Phone: 207.856.2600 Fax: 207.856.7600
signdesi@maine.rr.com

35.954
E-MAIL 12/7/10

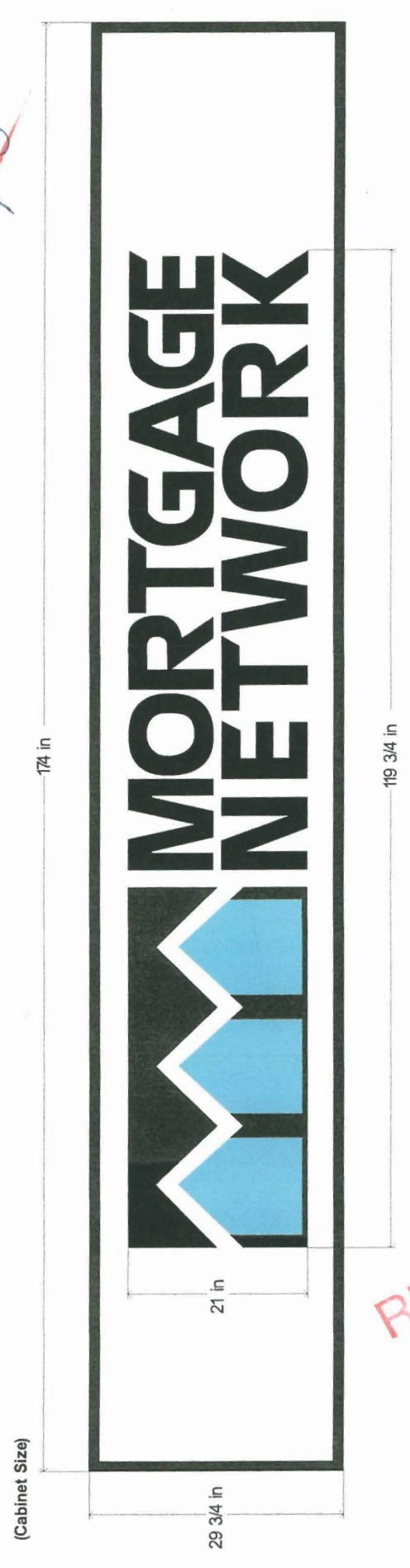

RECEIVED
JAN 20 2011
Dept. of Building Inspection
City of Portland

held in place by retainer system & screws - sign is lay-bolled to wall

This proof may reflect color shifts due to the color conversion from ink to paint and or vinyl. Also, PMS colors will be approximated to the best of our ability.
Customer supplied artwork files (300 dpi required) will be used as is, and Sign Design Inc. is not responsible for any faults in the design.

Any black outlines appearing on this proof are for representation only. They are to distinguish sign components such as borders, retainers, faces and reveals. Unless otherwise specified, they are not considered as part of the sign graphics.
Sign Design Inc. is not responsible for errors occurring due to improper review of this submitted proof.

Client: Mortgage Network
File: mortgage network comp. 2
Date: 12.3.10

Approval: 12/7/10
Customer approval is a signed confirmation that dimensions, colors, spelling, graphics and all other job specifics are correct.



CITY OF PORTLAND, MAINE
Department of Building Inspections

Original Receipt

1.20 20 11

Received from T.R. Singh

Location of Work 2059 Maple

Cost of Construction \$ _____ Building Fee: _____

Permit Fee \$ _____ Site Fee: _____

Certificate of Occupancy Fee: _____

Total: 102

Building (IL) _____ Plumbing (IS) _____ Electrical (I2) _____ Site Plan (U2) _____

Other _____

CBL: 215-B-4

Check #: 5134 Total Collected \$ 102

**No work is to be started until permit issued.
Please keep original receipt for your records.**

Taken by: [Signature]

WHITE - Applicant's Copy
YELLOW - Office Copy
PINK - Permit Copy

2011-1-20-11