

UNUMPROVIDENT CORPORATION

HO I SECURITY DOORS

2211 Congress Street
Portland, Maine

ISSUED FOR CONSTRUCTION 5-21-04

EGRESS ANALYSIS

BOCA 1999, BUSINESS OCCUPANCY, NOT SPRINKLERED

GROUND LEVEL EXITS:

WEST EXIT STAIR: (1) 3' DOOR = 160 PEOPLE
EAST EXIT STAIR: (1) 3' DOOR = 160 PEOPLE
DOOR @ LOADING DOCK: (1) 3' DOOR = 160 PEOPLE

FIRST FLOOR EXITS:

FRONT LOBBY: (2) PAIR OF 3' DOORS, (2) 3' DOORS = 960 PEOPLE
REAR LOBBY: (2) 6'-6" REVOLVING DOORS, (2) 3' DOORS, (1) PAIR OF 3' DOORS = 640 PEOPLE

TOTAL CAPACITY WITH REVOLVING DOORS = 2,080 PEOPLE
(BOCA OCCUPANCY @ 100 SF/PERSON = 1,448 PEOPLE)

ORIGINAL CAPACITY = 2,400 PEOPLE

ACTUAL OCCUPANCY = 1200 +/- PEOPLE

SYMBOL LEGEND

- DETAIL
- CIRCLE NOTE
- PARTITION TAG
- DOOR TAG
- ROOM NAME
ROOM NUMBER
- SEALANT AND
BACKER ROD

KEY PLAN

SCALE: 1/32" = 1'-0"

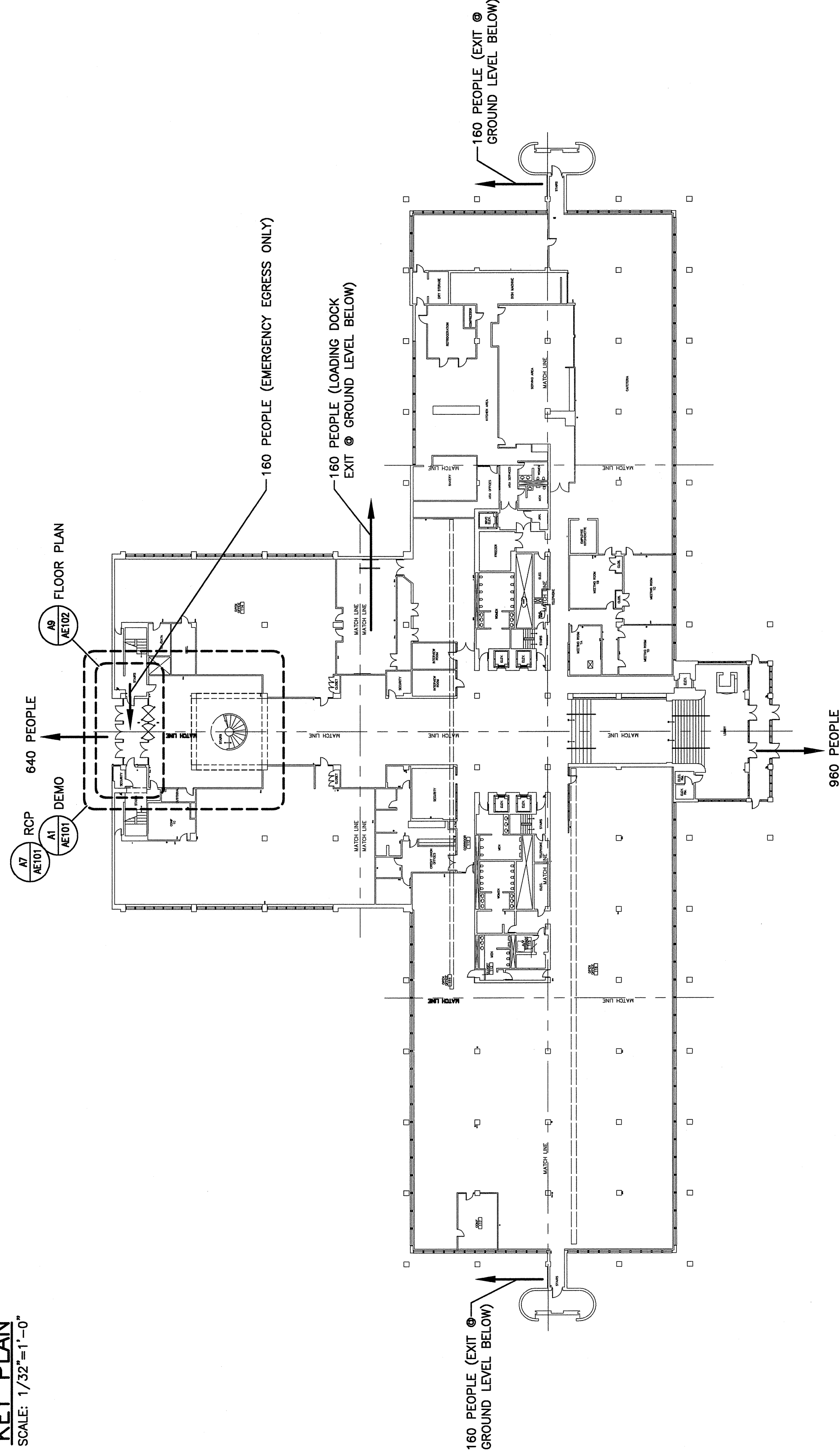

DRAWING LIST

GENERAL	TITLE SHEET
G1001	TITLE SHEET
ARCHITECTURAL	
AE101	DEMOLITION & REFLECTED CEILING PLANS
AE102	PLANS, ELEVATIONS, SECTIONS, DETAILS & DOOR SCHEDULE
AE103	SECTIONS & DETAILS
MECHANICAL	
M-001	LEGEND AND ABBREVIATIONS
M-101	HVAC PLANS, SCHEDULES AND SPECIFICATIONS
ELECTRICAL	
E-001	LEGEND, GENERAL NOTES & FIXTURE SCHEDULE
ED101	DEMOLITION & LIGHTING PLANS
EP101	POWER & SYSTEMS PLANS

SM
RT
ARCHITECTURE ENGINEERING PLANNING
SMRT
144 Fore Street/P.O. Box 618
Portland, Maine 04104
tel. (207) 772-3846
fax. (207) 772-1070

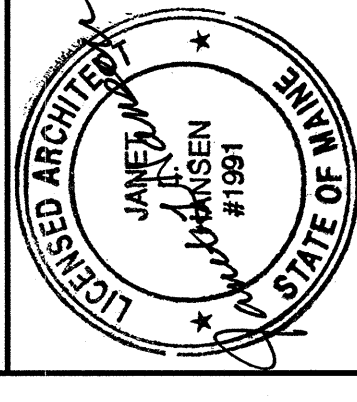

UNUMPROVIDENT CORPORATION
HO I SECURITY DOORS
PORTLAND, MAINE
ISSUED FOR CONSTRUCTION
5-21-04

REV	DESCRIPTION	DATE
1	ISSUED FOR CONSTRUCTION	5-21-04
0	ISSUED FOR PERMITTING	2-13-04

GRAPHIC SCALE:
0" 1"
SCALE: AS NOTED
PROJECT MANAGER: J.L.H.
A/C/DRAWN BY: R.L.J./D.M.
A/E OF RECORD: J.L.H.
CADD FILE: G1001-03146
PROJECT NO: 03146
DATE:
SHEET TITLE:

TITLE SHEET
SHEET No. G1001