

SHEET NOTES



2211 Congress Street
Portland, ME 04122

Gensler

214 North Tryon Street
Suite 2320
Charlotte, NC 28202
United States

Tel: 704.377.2725
Fax: 704.377.2807

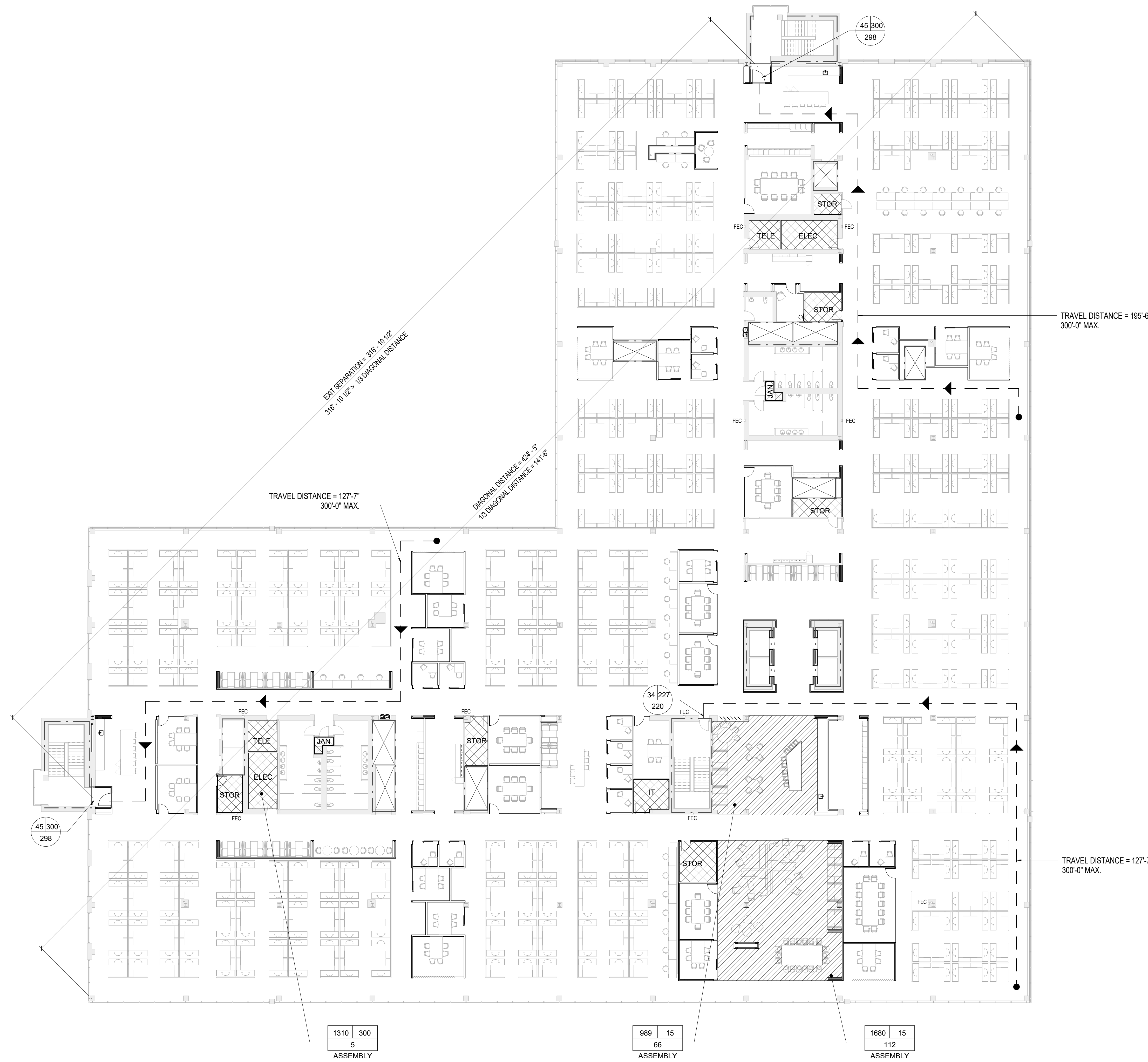

TRAVEL DISTANCE = 195'-0"
300'-0" MAX.

TRAVEL DISTANCE = 127'-7"
300'-0" MAX.

TRAVEL DISTANCE = 127'-7"
300'-0" MAX.

LEVEL 04
OCCUPANT LOAD AND EXIT WIDTH (Table 1004.1.1)

USE GROUP OR SPACE DESCRIPTION	AREA ^(a) sq. ft.	AREA ^(b) PER OCCUPANT	ACTUAL OCCUPANT LOAD	CALCULATED OCCUPANT LOAD (ab)	EGRESS REQUIRED WIDTH (SECTION 1005.1)				Exit Width (in) ^{(c)(d)(e)}						
					OCCUPANT (TABLE 1008.1)		STAR		LEVEL		STAR		LEVEL		
BUSINESS	63,291	100 GROSS		633											
ASSEMBLY (UNCONCENTRATED)	2,669	15 SF		178											
STORAGE	1,310	300 SF		5											
LEVEL 04 - TOTAL	67,260	VARIABLE	539*	816											

*NOTE: 633 PERSON LEVEL CAPACITY PER NFPA 101
 (a) See Table 1004.1.1 for information on how to calculate gross area.
 (b) See Section 1004.1.1 for information on how to calculate net area.
 (c) See Section 1005.1 for information on how to calculate required width.
 (d) See Section 1005.1 for information on how to calculate actual width.
 (e) See Section 1005.1 for information on how to calculate actual width.

GENERAL NOTES

- TRAVEL DISTANCE
- COMMON PATH OF TRAVEL
- POINT OF DECISION
- AREA NOT IN CONTRACT
- AREA CALCULATION
- AREA PER OCCUPANT [1004.1.1]
- OCCUPANCY (PEOPLE)
- CLEAR EXIT WIDTH AT DOOR
- MAXIMUM EGRESS CAPACITY AT DOOR [1005.1]
- ACTUAL EGRESS COUNT AT THIS DOOR
- CARD READER
- ELECTROMAGNETIC EGRESS LOCK PROVIDED WITH PUSH TO EGRESS BUTTON AND MOTION SENSOR
- 15 SECOND DELAYED EGRESS

Date	Description
12/15/17	ISSUE FOR PERMIT & CONSTRUCTION
1/03/18	BULLETIN #02

OCCUPANCY CLASSIFICATION LEGEND

- ASSEMBLY (UNCONCENTRATED)
1 PERSON / 15 SF
- BUSINESS (GENERAL)
1 PERSON / 100 SF
- ACCESSORY STORAGE
1 PERSON / 300 SF

1 EGRESS & OCCUPANCY PLAN - LEVEL 04
SCALE: 1/16" = 1'-0"

Seal / Signature



Project Name
Unum Workplace Transformation - Phase 2 & 3 (HO2 & HO3)

Project Number
59.6481.003

Description
LIFE SAFETY PLAN - LEVEL 04 - HO3

Scale
As indicated

LS02.104