

3/8/2018 3:32:09 PM I:\gensler_ad\projects\Revit\Level\Access\2462559 6481 003 - UNUM - PORTLAND - H03 - UNUM - PORTLAND - H03_2016_22462.rvt

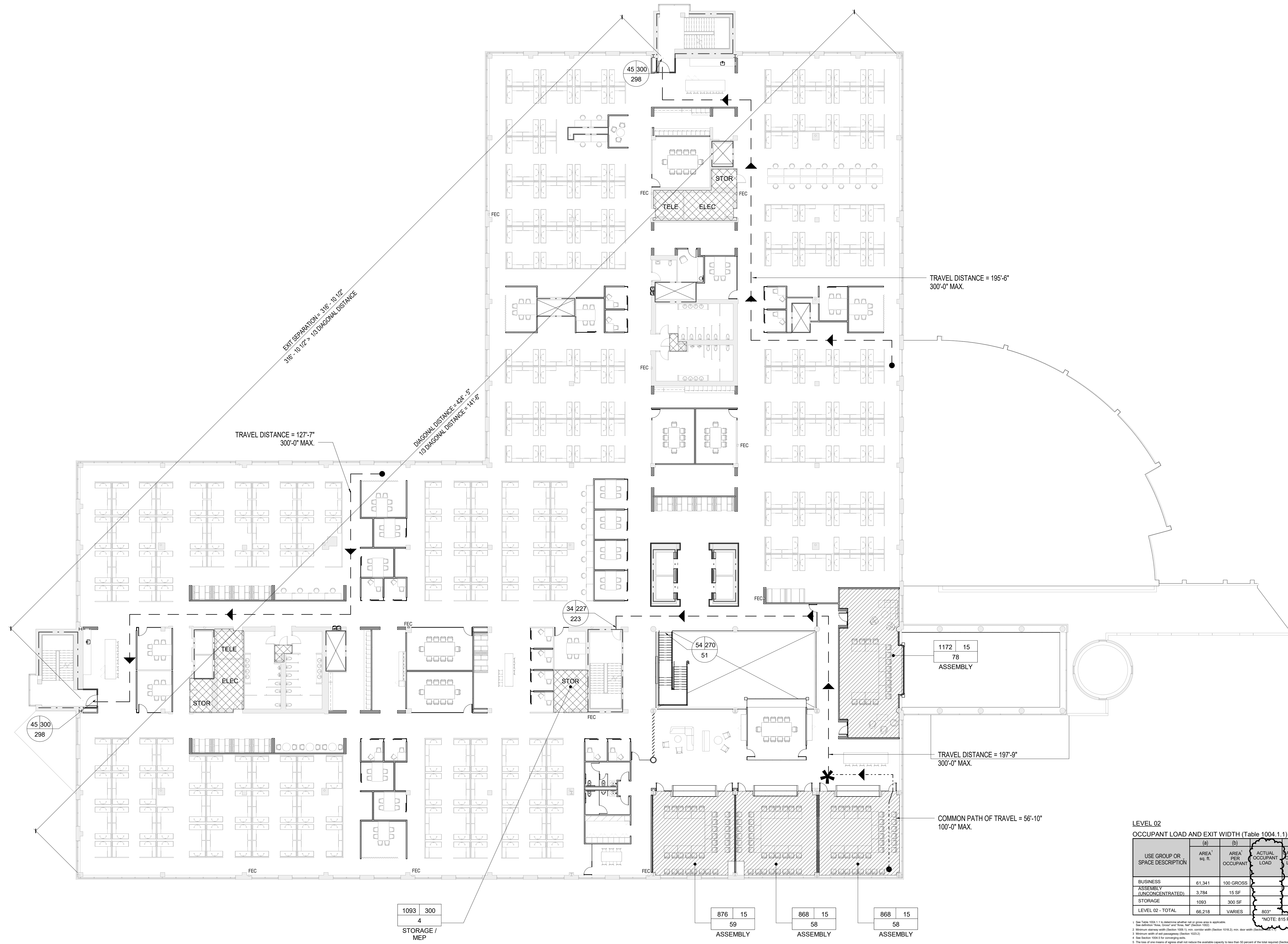

LEVEL 02 OCCUPANT LOAD AND EXIT WIDTH (Table 1004.1.1)

USE GROUP OR SPACE DESCRIPTION	AREA ¹ sq. ft.	AREA PER OCCUPANT	ACTUAL OCCUPANT LOAD	CALCULATED OCCUPANT LOAD (TABLE 1004.1.1)	Exit Width (in) ^{2,3,4,5}					
					EGRESS WIDTH PER OCCUPANT (TABLE 1005.1)		REQUIRED WIDTH (SECTION 1005.1)		ACTUAL WIDTH SHOWN ON PLANS	
					STAIR	LEVEL	STAIR	LEVEL	STAIR	LEVEL
BUSINESS	61,341	100 GROSS	614	614						
ASSEMBLY (UNCONCENTRATED)	3,784	15 SF	252	252						
STORAGE	1,093	300 SF	4	4						
LEVEL 02 - TOTAL	66,218	VARIES	870	870						

1. See Table 1004.1.1 for alternative egress widths for group areas in buildings.
 2. Egress width shall be 20 in. for all exits.
 3. Minimum egress width shall be 20 in. for all exits.
 4. See Section 1005.1 for egress width.
 5. The total of the number of egress doors shall not be less than 10 percent of the total egress doors (Section 1005.1).
 6. Occupancy classification legend.

1 EGRESS & OCCUPANCY PLAN - LEVEL 02
SCALE: 1/16" = 1'-0"

SHEET NOTES

GENERAL NOTES

- TRAVEL DISTANCE
- - - COMMON PATH OF TRAVEL
- * POINT OF DECISION
- ▨ AREA NOT IN CONTRACT
- AREA CALCULATION
- AREA PER OCCUPANT [1004.1.1]
- OCCUPANCY (PEOPLE)
- CLEAR EXIT WIDTH AT DOOR
- MAXIMUM EGRESS CAPACITY AT DOOR [1005.1]
- ACTUAL EGRESS COUNT AT THIS DOOR
- [CR] CARD READER
- [EM] ELECTROMAGNETIC EGRESS LOCK PROVIDED WITH PUSH TO EGRESS BUTTON AND MOTION SENSOR
- [DE] 15 SECOND DELAYED EGRESS

OCCUPANCY CLASSIFICATION LEGEND

- ▨ ASSEMBLY (UNCONCENTRATED) 1 PERSON / 15 SF
- ▨ BUSINESS (GENERAL) 1 PERSON / 100 SF
- ▨ ACCESSORY STORAGE 1 PERSON / 300 SF

Date	Description
12/15/17	ISSUE FOR PERMIT & CONSTRUCTION
1/31/18	BULLETIN #02

Seal / Signature

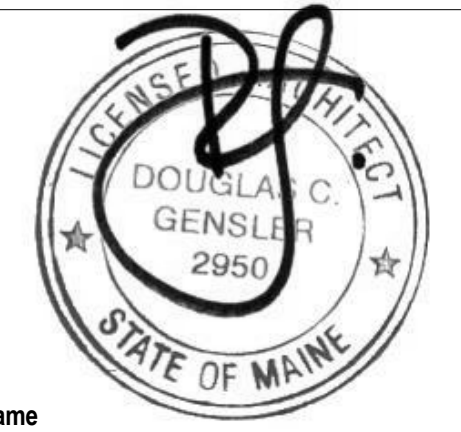

Project Name
Unum Workplace Transformation - Phase 2 & 3 (HO2 & HO3)

Project Number
59.6481.003

Description
LIFE SAFETY PLAN - LEVEL 02 - HO3

Scale
As indicated

LS02.102



2211 Congress Street
Portland, ME 04122

Gensler

214 North Tryon Street
Suite 2320
Charlotte, NC 28202
United States
Tel: 704.377.2725
Fax: 704.377.2807