

SHEET NOTES

GENERAL NOTES

- ➔ TRAVEL DISTANCE
- ➔ COMMON PATH OF TRAVEL
- ✳ POINT OF DECISION
- AREA NOT IN CONTRACT
- AREA CALCULATION
- AREA PER OCCUPANT [1004.1.1]
- OCCUPANCY (PEOPLE)
- CLEAR EXIT WIDTH AT DOOR
- MAXIMUM EGRESS CAPACITY AT DOOR [1005.1]
- ACTUAL EGRESS COUNT AT THIS DOOR
- CR CARD READER
- EM ELECTROMAGNETIC EGRESS LOCK PROVIDED WITH PUSH TO EGRESS BUTTON AND MOTION SENSOR
- DE 15 SECOND DELAYED EGRESS

OCCUPANCY CLASSIFICATION LEGEND

- ▨ ASSEMBLY (UNCONCENTRATED)  
1 PERSON / 15 SF
- BUSINESS (GENERAL)  
1 PERSON / 100 SF
- ▩ ACCESSORY STORAGE  
1 PERSON / 300 SF

Date	Description
12/15/17	ISSUE FOR PERMIT & CONSTRUCTION
1/03/18	BULLETIN #02

Seal / Signature

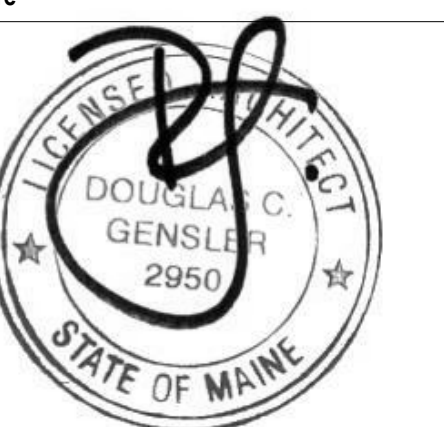

Project Name  
Unum Workplace Transformation - Phase 2 & 3 (HO2 & HO3)

Project Number  
59.6481.003

Description  
LIFE SAFETY PLAN - LEVEL 01 - HO3

Scale  
As indicated

LS02.101

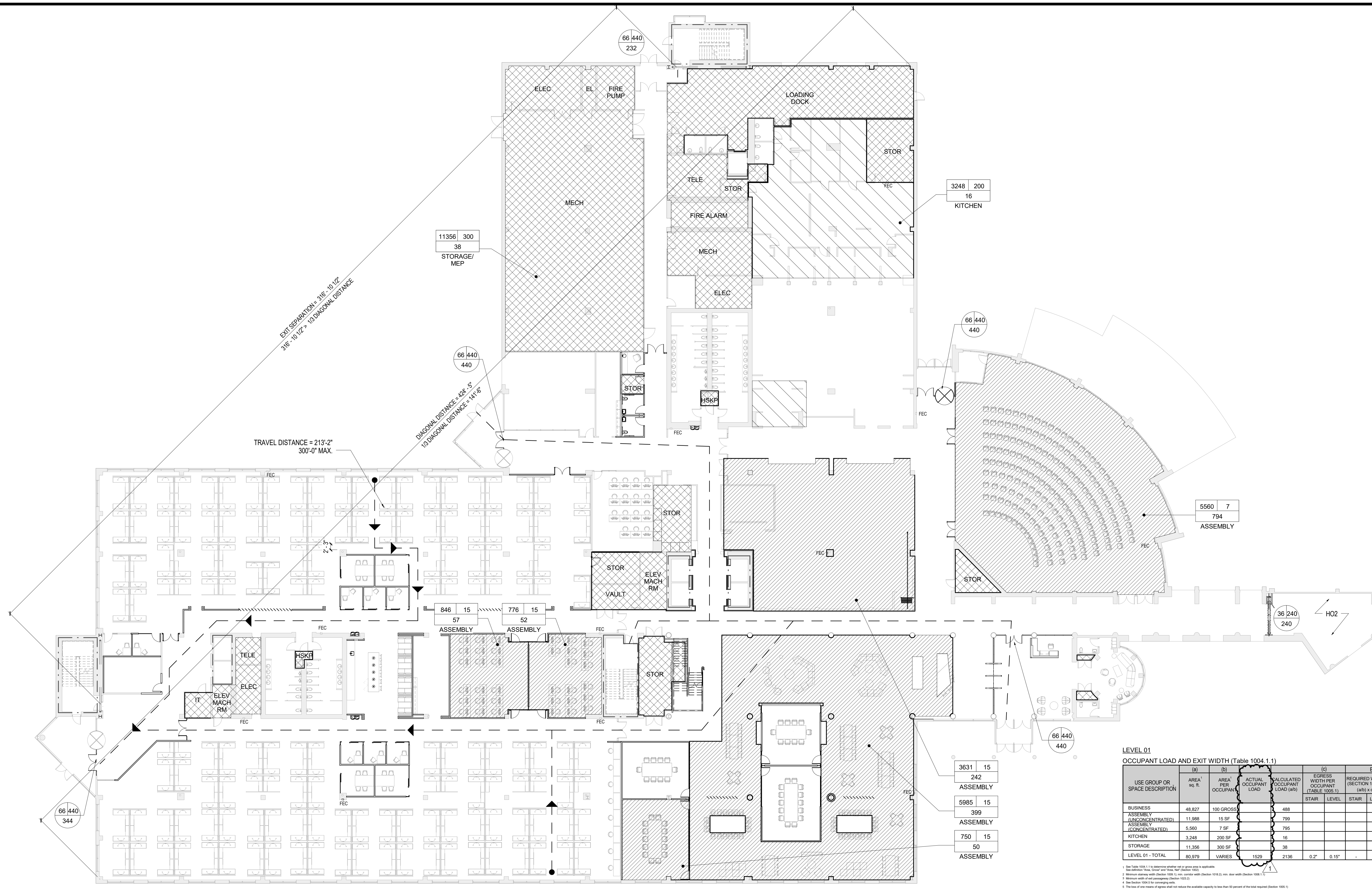

**LEVEL 01  
OCCUPANT LOAD AND EXIT WIDTH (Table 1004.1.1)**

USE GROUP OR SPACE DESCRIPTION	AREA <sup>(1)</sup> per ft.	AREA PER OCCUPANT <sup>(2)</sup>	ACTUAL OCCUPANT LOAD <sup>(3)</sup>	CALCULATED OCCUPANT LOAD <sup>(4)</sup>	EGRESS WIDTH PER OCCUPANT (TABLE 1005.1)		Exit Width (m) <sup>(5,6,7,8)</sup>	
					STAR	LEVEL	STAR	LEVEL
BUSINESS	48,827	100 GROSS	488					
ASSEMBLY (UNCONCENTRATED)	11,288	15 SF	750					
ASSEMBLY (CONCENTRATED)	5,560	7 SF	795					
KITCHEN	3,248	200 SF	16					
STORAGE	11,356	300 SF	38					
<b>LEVEL 01 - TOTAL</b>	<b>80,079</b>	<b>VARIES</b>	<b>1,629</b>	<b>2,136</b>	<b>0.2'</b>	<b>0.10'</b>	<b>-</b>	<b>320"</b>

1. See Table 1004.1.1 for minimum egress width per gross area to applicable.  
2. Minimum egress width shall be 18 inches for all exits.  
3. Maximum egress width shall be 18 inches for all exits.  
4. Minimum egress width shall be 18 inches for all exits.  
5. The total egress width shall be the sum of the egress widths for all exits.  
6. The total egress width shall be the sum of the egress widths for all exits.  
7. The total egress width shall be the sum of the egress widths for all exits.  
8. The total egress width shall be the sum of the egress widths for all exits.

**1** EGRESS & OCCUPANCY PLAN - LEVEL 01  
SCALE: 1/16" = 1'-0"

**BUILDING CODE SUMMARY**

**a. PROJECT INFORMATION**

Name of Project: UNUM TRANSFORMATION - PORTLAND PHASE 2 AND 3 (HO2 & HO3)  
Address: 2211 CONGRESS STREET, PORTLAND, MAINE Zip Code: 04102  
Proposed Use: BUSINESS - B (NO CHANGE TO EXISTING OCCUPANCY OR USE)  
Owner / Authorized Agent: Phone #  
City: PORTLAND State: ME  
County: Phone #

**b. PROJECT SUMMARY / ALTERNATIVE MEANS OF COMPLIANCE**

Building Description: EXISTING 4 STORY OFFICE BUILDING  
Scope of Work Details: INTERIOR RENOVATION OF EXISTING LEVEL 01, LEVEL 02, LEVEL 03 AND LEVEL 04  
PROJECT WILL CONSIST OF THE CONSTRUCTION OF SELECT PARTITIONS, CEILING, FINISHES AND ASSOCIATED ELECTRICAL, PLUMBING, MECHANICAL, AND FIRE PROTECTION AS WELL AS MILLWORK AND SYSTEMS FURNITURE.

**c. DESIGN PROFESSIONAL INFORMATION**

DESIGNER FROM	NAME	LICENSE #	PHONE #	E-MAIL
Architectural	DOUGLAS GENSLER	ANC2950	617.619.5700	doug.gensler@gensler.com
Electrical	JEFFREY SCOTT LOWERY, P.E.	J.S. LOWERY	704.357.9333	jeffrey.lowery@unum.com
Fire Alarm	JEFFREY SCOTT LOWERY, P.E.	J.S. LOWERY	704.357.9333	jeffrey.lowery@unum.com
Plumbing	BRAD J. RABINOWITZ, P.E.	B. RABINOWITZ	704.357.9333	brad.rabinowitz@unum.com
Mechanical	BRAD J. RABINOWITZ, P.E.	B. RABINOWITZ	704.357.9333	brad.rabinowitz@unum.com
Sprinkler-Standpipe	BRAD J. RABINOWITZ, P.E.	B. RABINOWITZ	704.357.9333	brad.rabinowitz@unum.com
Structural	BRAD J. RABINOWITZ, P.E.	B. RABINOWITZ	704.357.9333	brad.rabinowitz@unum.com
Retaining Walls/Hgt.				
Other:				

**APPLICABLE CODES**

Building Code: 2009 International Existing Building Code (IEBC)

Existing Building:  Change of use/occupancy  Building tenant space interior completion (Alteration / Renovation)  
Year of construction: 1998 - Business use (B) OFFICE

**BASIC BUILDING DATA**

Construction Type (Table 601):  IA  I-A  I-B  I-C  I-D  I-E  I-F  I-G  I-H  I-I  I-J  I-K  I-L  I-M  I-N  I-O  I-P  I-Q  I-R  I-S  I-T  I-U  I-V  I-W  I-X  I-Y  I-Z

Sprinklers (Section 903):  No  Partial  Yes  NFPA 13-07  NFPA 13R-07  NFPA 13D-07

Standpipes (Section 905):  No  Yes Class:  I  II  III  WET  DRY NFPA 14-07

Fire District:  No  Yes Flood Hazard Area (Appendix G)  No  Yes

Building Height (Feet): 61' (Table 503) Stories: 4  
Occupancy: B - BUSINESS Accessory Occupancies (<10%): A3 - ASSEMBLY

Gross Building Area:	EXISTING (SQ FT)	NEW (SQ FT)	ALT. RE (SF)
LEVEL 01	80,079	0	61,894
LEVEL 02	66,218	0	62,489
LEVEL 03	67,497	0	63,887
LEVEL 04	67,270	0	63,679
<b>TOTAL</b>	<b>281,064</b>	<b>0</b>	<b>251,959</b>

Story No.	Description and Use	(A) Big Area per Story (Actual)	(B) Table 503.5 Area	(C) Area for Forfeiture Increase <sup>1</sup>	(D) Area for Sprinkler Increase <sup>2</sup>	(E) Allowable Area or Unlimited <sup>3</sup>	(F) Maximum Building Area <sup>4</sup>
LEVEL 01	B	80,079	UL	NA	NA	NA	NA
LEVEL 02	B	66,218	UL	NA	NA	NA	NA
LEVEL 03	B	67,497	UL	NA	NA	NA	NA
LEVEL 04	B	67,270	UL	NA	NA	NA	NA

1. Forfeiture area is based on the area of the building as constructed.  
2. Sprinklered areas shall be based on the area of the building as constructed.  
3. Unlimited area is based on the area of the building as constructed.  
4. Maximum building area is based on the area of the building as constructed.

**ALLOWABLE HEIGHT (Chapter 5)**

Type of Construction	Type	IB	IB	IB
Building Height in Feet	Feet - 160'	Feet-H-20'	180'	61'
Building Height in Stories	Stories - 11	Stories-H-1'	20	4

**EXIT REQUIREMENTS**

**NUMBER AND ARRANGEMENT OF EXITS (Table 1021.1)**

FLOOR, ROOM OR SPACE DESIGNATION	MINIMUM NUMBER <sup>1</sup> OF EXITS		TRAVEL DISTANCE		ARRANGEMENT MEANS OF EGRESS <sup>1,2</sup> (SECTION 1015.2)	
	REQUIRED (Single Exit 1021.2)	SHOWN ON PLANS	ALLOWABLE TRAVEL DISTANCE (TABLE 1016.1)	ACTUAL TRAVEL DISTANCE (SHOWN ON PLANS)	REQUIRED DISTANCE BETWEEN EXIT DOORS	ACTUAL DISTANCE SHOWN ON PLANS
LEVEL 01	2	6	300'-0" MAX.	213'-2"	141'-6"	316'-10"
LEVEL 02	2	3	300'-0" MAX.	197'-6"	141'-6"	316'-10"
LEVEL 03	2	3	300'-0" MAX.	197'-6"	141'-6"	316'-10"
LEVEL 04	2	3	300'-0" MAX.	197'-6"	141'-6"	316'-10"

1. See Table 1021.1 for minimum number of exits.  
2. Exits shall be arranged in accordance with Section 1021.1.2.

**PLUMBING FIXTURES REQUIREMENTS**

OCCUPANCY USE GROUP AND/OR DESIGNATION SPACE	WATERCLOSETS		URINALS		LAVATORIES		SHOWERS/TUBS	DRINKING FOUNTAINS
	MALE	FEMALE	MALE	FEMALE	MALE	FEMALE		
LEVEL 01 (REQUIRED)	13	19	0	9	9	0	4	
LEVEL 01 (PROVIDED)	13	19	0	9	9	0	4	
LEVEL 02 (REQUIRED)	9	10	0	6	6	0	3	
LEVEL 02 (PROVIDED)	9	10	0	6	6	0	3	
LEVEL 03 (REQUIRED)	7	16	5	9	9	0	4	
LEVEL 03 (PROVIDED)	7	16	5	9	9	0	4	
LEVEL 04 (REQUIRED)	9	13	0	6	6	0	3	
LEVEL 04 (PROVIDED)	9	13	0	6	6	0	3	
<b>TOTAL REQUIRED</b>	<b>40</b>	<b>51</b>	<b>0</b>	<b>27</b>	<b>27</b>	<b>0</b>	<b>13</b>	
<b>TOTAL PROVIDED</b>	<b>32</b>	<b>60</b>	<b>18</b>	<b>40</b>	<b>43</b>	<b>0</b>	<b>18</b>	

**FIRE RESISTANCE RATINGS IIB**

EXIT PASSAGEWAY	2 HOUR	LOAD BEARING WALLS	0 HOUR
EXIT PASSAGEWAY	1 HOUR	FLOOR CONSTRUCTION	0 HOUR
STAIR ENCLOSURES	1 HOUR	ROOF CONSTRUCTION	0 HOUR
CORRIDORS	0 HOUR	SHAFTS	1 HOUR
COLUMNS	0 HOUR	ELEVATOR ENCLOSURES	1 HOUR
LOAD BEARING WALLS	0 HOUR		

**L WALL LEGENDS**

CHECK IF THE FOLLOWING ARE PRESENT AND INDICATED BY A WALL LEGEND ON ALL PLANS

Fire Walls 706  Fire Barriers 707  Shaft Enclosures 708  Fire Partitions 709  
 Smoke Barriers 710  Smoke Partitions 711  No rated walls are present

**LIFE SAFETY SYSTEMS (Existing or new systems)**

Emergency Lighting (1006)  No  Yes

Exit Signs (1011)  No  Yes

Fire Alarm (907, NFPA 72-07)  No  Yes

Smoke Detection Systems (907)  No  Yes  Partial

Panic Hardware (1008.1.10)  No  Yes

Life safety systems generator (207.2)  No  Yes