

12/15/2017 2:05:27 PM I:\gensler\ad\projects\Revit\Level\Access\25168559_6481_003 - UNUM - PORTLAND - H03_2016_25168559.rvt

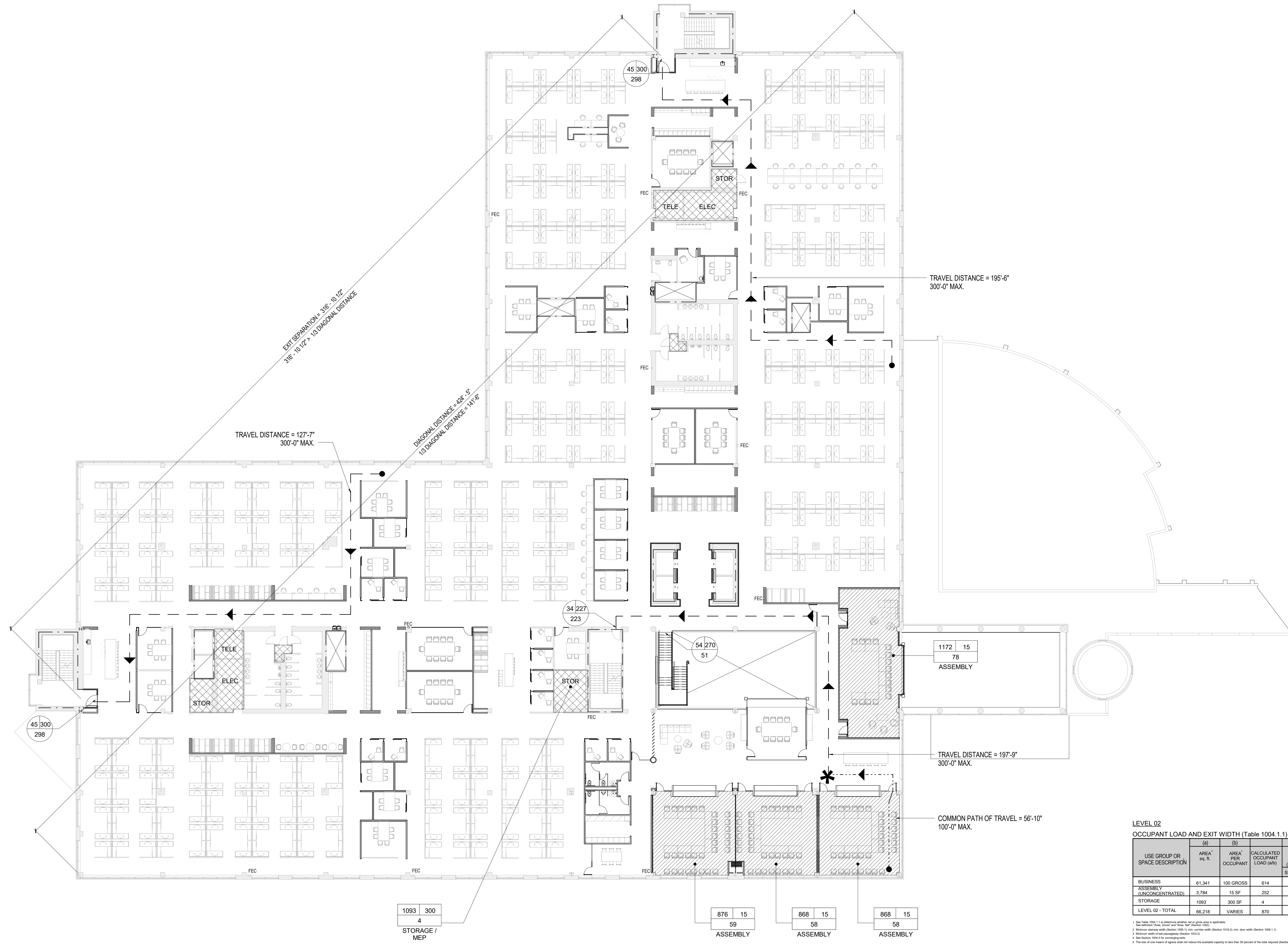

**LEVEL 02
OCCUPANT LOAD AND EXIT WIDTH (Table 1004.1.1)**

USE GROUP OR SPACE DESCRIPTION	AREA ¹ sq. ft.	AREA PER OCCUPANT	CALCULATED OCCUPANT LOAD (L)	Exit Width (ft) ^{2,3,4,5}					
				EGRESS WIDTH PER OCCUPANT (TABLE 1005.1)		REQUIRED WIDTH (SECTION 1005.1)			
				STAIR	LEVEL	STAIR	LEVEL	STAIR	LEVEL
BUSINESS	61,341	100 GROSS	614						
ASSEMBLY (UNCONCENTRATED)	3,784	15 SF	252						
STORAGE	1,063	300 SF	4						
LEVEL 02 - TOTAL	66,218	VARIES	870	0.2'	0.15'	173"	130"	54"	124"

1. See Table 1004.1.1 for alternative egress widths for gross areas in assemblies.
2. Egress width shall be 20" for stairs and 18" for level egress.
3. Egress width shall be 20" for stairs and 18" for level egress.
4. See Section 1005.1 for egress width.
5. The sum of the areas of signs shall not reduce the available capacity to less than 50 percent of the total required (Section 1005.1).
6. Occupancy classification (Section 1004.1.1).

1 EGRESS & OCCUPANCY PLAN - LEVEL 02
SCALE: 1/16" = 1'-0"

SHEET NOTES

GENERAL NOTES

- ➔ TRAVEL DISTANCE
- ➔➔➔ COMMON PATH OF TRAVEL
- ✱ POINT OF DECISION
- ▨ AREA NOT IN CONTRACT
- ◻ AREA CALCULATION
- ○ ○ ○ AREA PER OCCUPANT [1004.1.1]
- ○ ○ ○ OCCUPANCY (PEOPLE)
- ○ ○ ○ CLEAR EXIT WIDTH AT DOOR
MAXIMUM EGRESS CAPACITY
AT DOOR [1005.1]
- ○ ○ ○ ACTUAL EGRESS COUNT AT
THIS DOOR
- CR CARD READER
- EM ELECTROMAGNETIC EGRESS
LOCK PROVIDED WITH PUSH TO
EGRESS BUTTON AND MOTION
SENSOR
- DE 15 SECOND DELAYED EGRESS

- OCCUPANCY CLASSIFICATION LEGEND**
- ▨ ASSEMBLY (UNCONCENTRATED)
1 PERSON / 15 SF
 - ◻ BUSINESS (GENERAL)
1 PERSON / 100 SF
 - ▨ ACCESSORY STORAGE
1 PERSON / 300 SF

Date	Description
12/15/17	ISSUE FOR PERMIT & CONSTRUCTION



2211 Congress Street
Portland, ME 04122



214 North Tryon Street
Suite 2320
Charlotte, NC 28202
United States
Tel: 704.377.2725
Fax: 704.377.2807

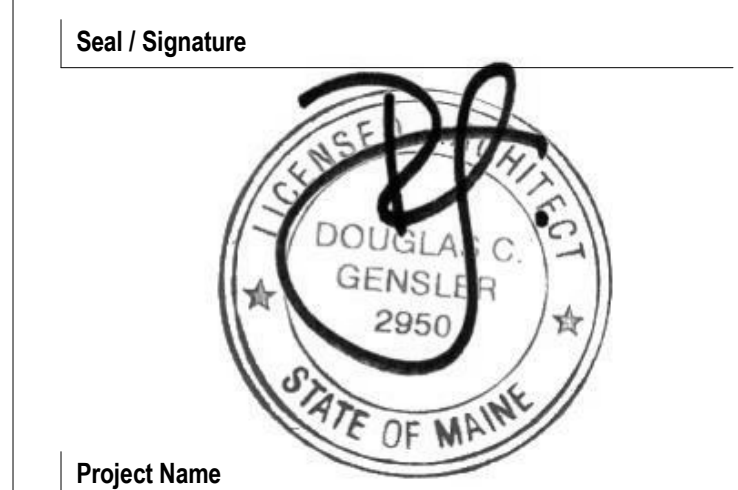

Project Name
**Unum Workplace Transformation
- Phase 2 & 3 (HO2 & HO3)**

Project Number
59.6481.003

Description
LIFE SAFETY PLAN - LEVEL 02 - HO3

Scale
As indicated

LS02.102