

03 TYP. VIDEO CONF. IN EXECUTIVE SUITE - ENLARGED RCP
SCALE: 3/8" = 1'-0"

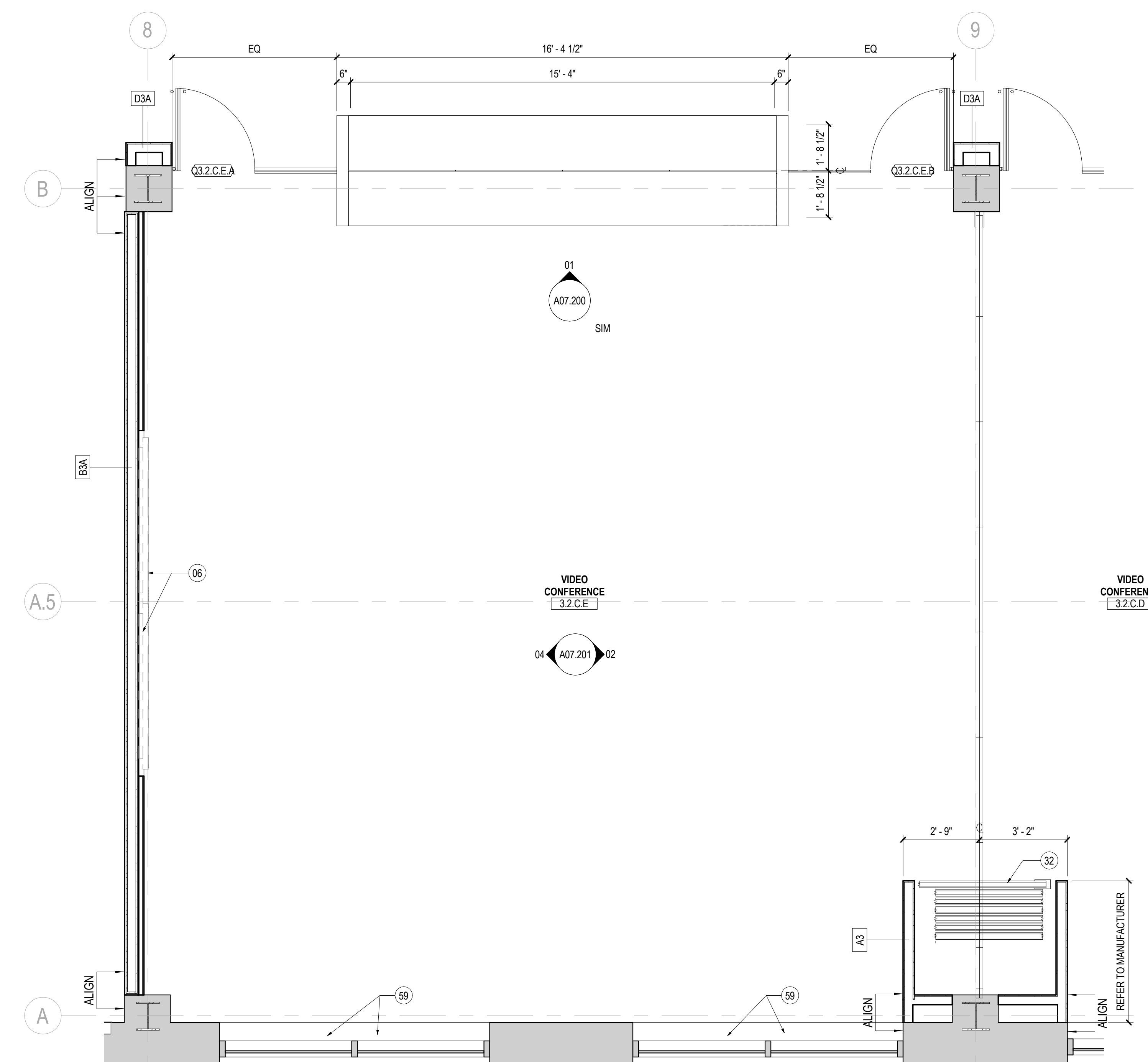

01 TYP. VIDEO CONF. IN EXECUTIVE SUITE - ENLARGED FLOOR PLAN
SCALE: 3/8" = 1'-0"

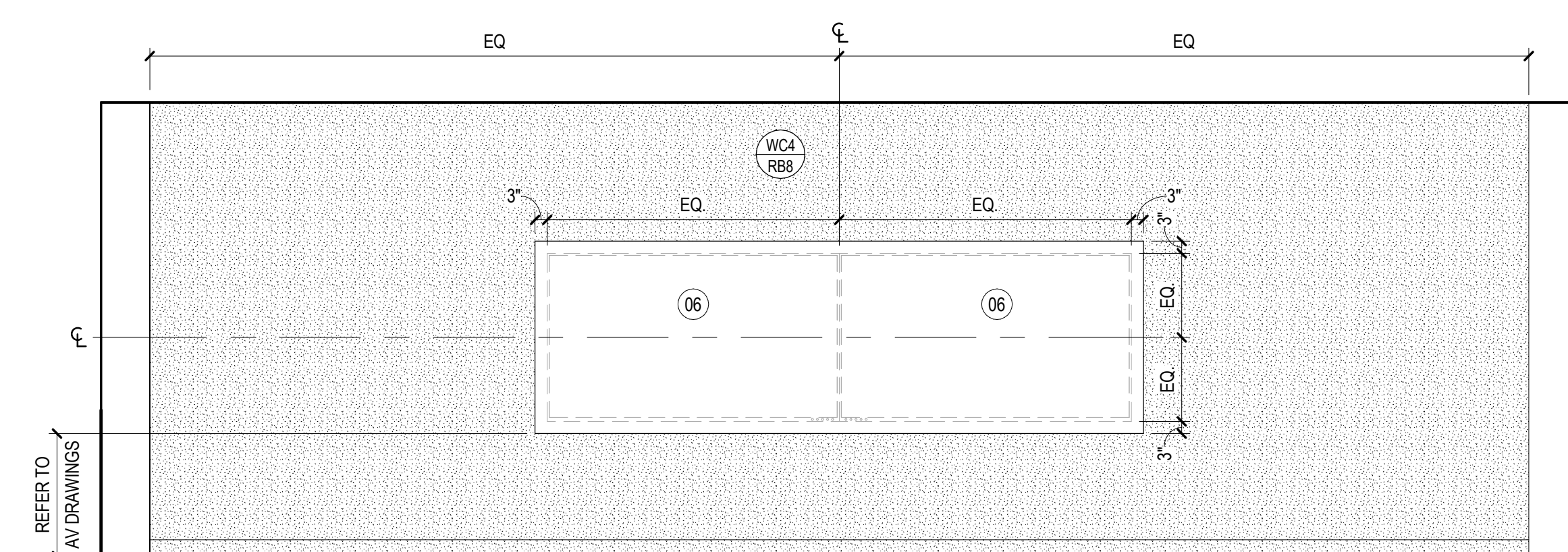

04 TYP. VIDEO CONF. IN EXECUTIVE SUITE - INTERIOR ELEV - TV WALL
SCALE: 3/8" = 1'-0"

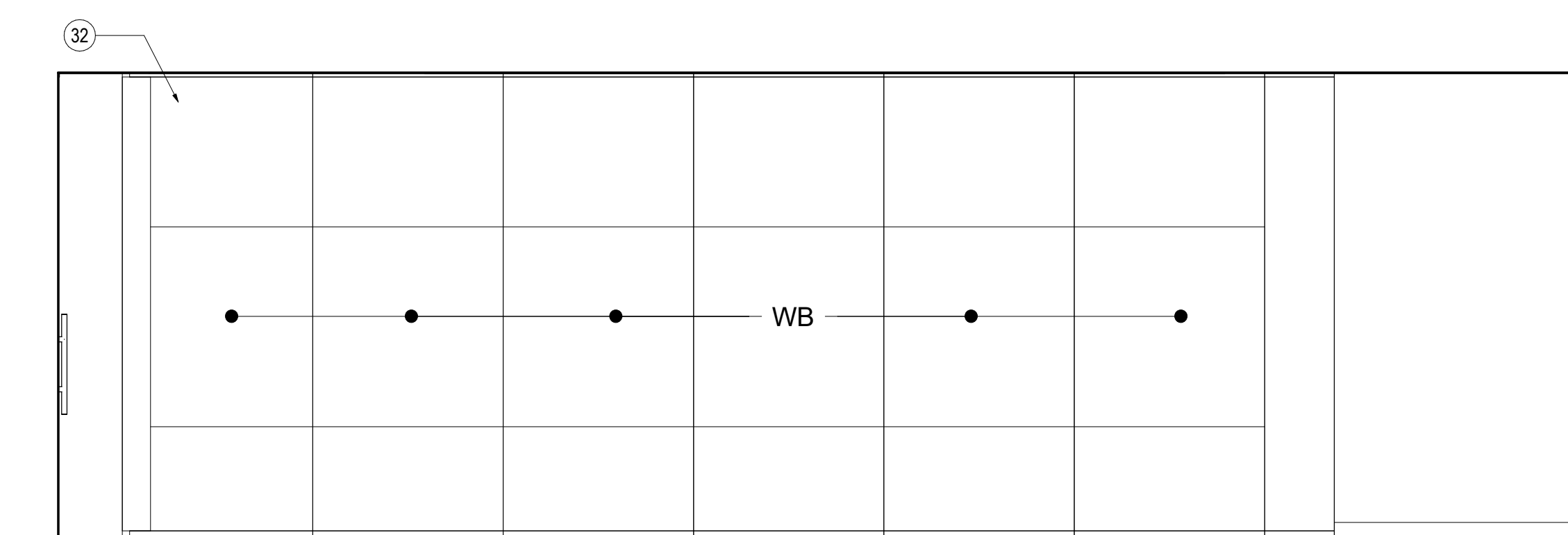

02 TYP. VIDEO CONF. IN EXEC SUITE - INT. ELEV OPERABLE PARTITION
SCALE: 3/8" = 1'-0"

SHEET NOTES

- 06 TV NIC. GC TO PROVIDE BLOCKING AS REQUIRED. REFER TO AV REFERENCE DRAWINGS.
- 32 OPERABLE PARTITION, MODERN FOLD
- 59 BLACKOUT SHADES, REFER TO FINISH DRAWINGS

GENERAL NOTES

- A. REFER TO SHEETS SERIES A02.100, A02.200 AND I02.100 FOR CONSTRUCTION, REFLECTED CEILING AND FINISH PLAN GENERAL NOTES.
- B. REFER TO FINISH PLAN FOR WALL BASE AS SCHEDULED, TYPICAL.

KEY PLAN

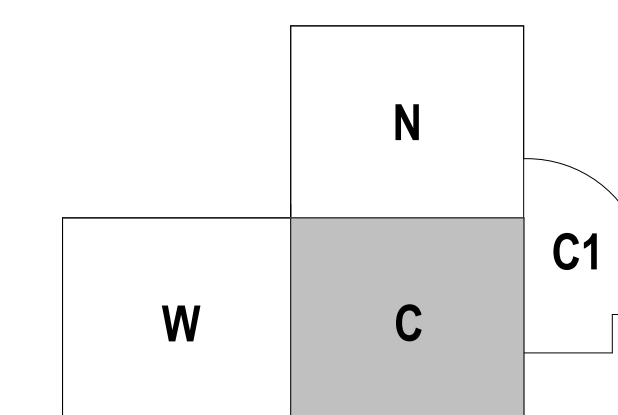

Date	Description
12/15/17	ISSUE FOR PERMIT & CONSTRUCTION

Seal / Signature

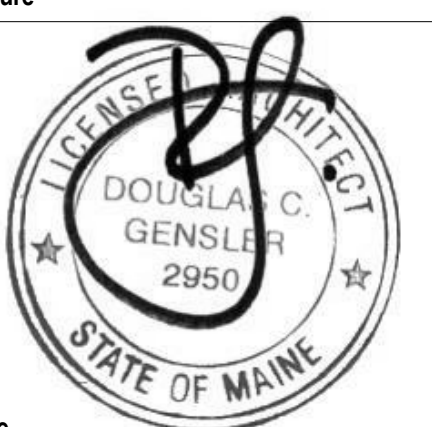

Project Name

Unum Workplace Transformation
- Phase 2 & 3 (HO2 & HO3)

Project Number

59.6481.003

Description

ENLARGED PLANS AND ELEVATIONS -
EXECUTIVE SUITE

Scale

3/8" = 1'-0"

A07.201