

12/15/2017 2:11:28 PM | gensler\_ad/projects/Revit/Level/Access/2516859\_6481\_003 - UNUM - PORTLAND - HO3\_2016\_2516859.rvt

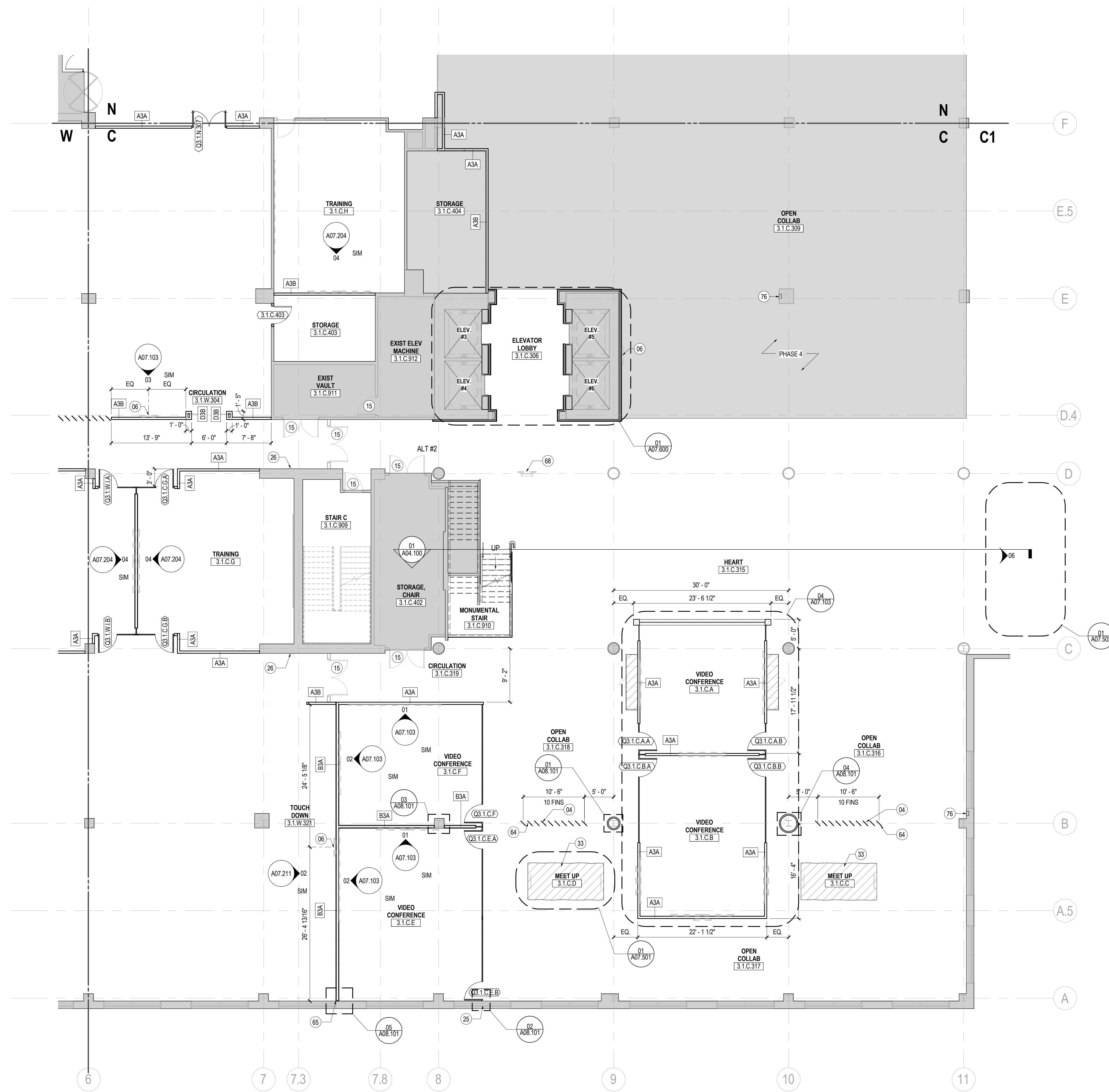

**01 CONSTRUCTION PLAN - LEVEL 01 - AREA C**  
SCALE: 1/8" = 1'-0"

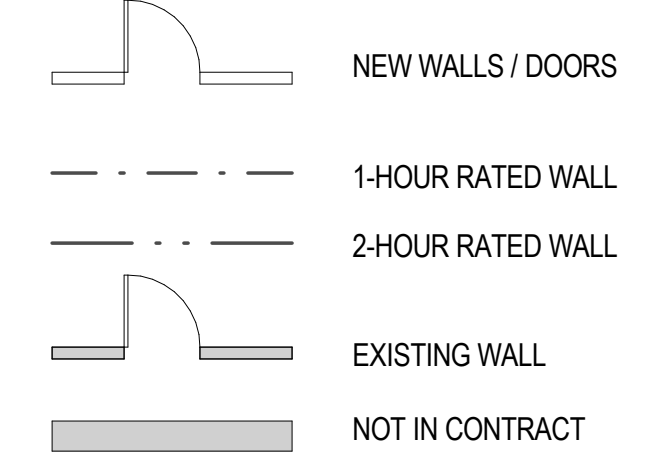

**KEY PLAN**

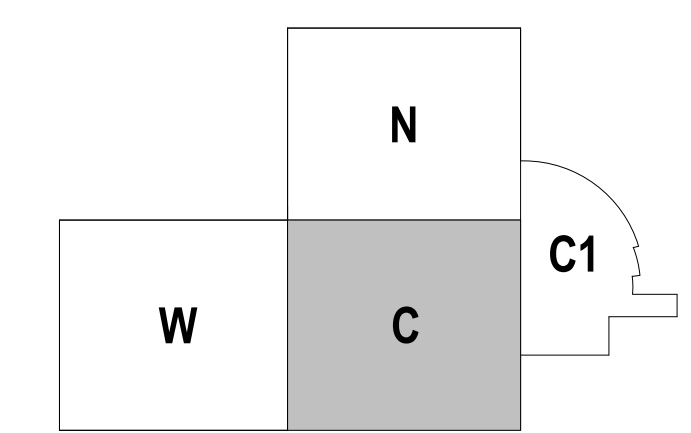

**SHEET NOTES**

- 04 DECORATIVE FINIS. REFER TO FINISH PLAN AND FINISH LEGEND.
- 06 TV NIC. GC TO PROVIDE BLOCKING AS REQUIRED. REFER TO AV REFERENCE DRAWINGS.
- 15 EXISTING DOOR TO REMAIN.
- 25 CENTER OF WALL TO ALIGN WITH CENTER OF EXISTING MULLION.
- 26 EXISTING FIRE EXTINGUISHER CABINET TO REMAIN. REFER TO DEMOLITION PLANS.
- 33 LIVE EDGE TABLE. SEE SHEET A07.501 FOR ADDITIONAL INFORMATION.
- 64 CENTER ON COLUMN LINE.
- 65 ALIGN TO EDGE OF WINDOW JAMB.
- 68 CEILING MOUNT AND TV NIC.
- 76 NEW FIRE EXTINGUISHER CABINET TO BE INSTALLED.

**GENERAL NOTES**

- A. REFER TO SERIES A00 FOR GRAPHIC SYMBOLS, ABBREVIATIONS, AND GENERAL NOTES.
- B. REFER TO SHEET A00.11 FOR DOOR, FRAME, AND HARDWARE SCHEDULE.
- C. REFER TO SHEET A00.10 FOR PARTITION TYPE DETAILS.
- D. DO NOT SCALE DRAWINGS. WRITTEN DIMENSIONS GOVERN. THE TYPE, LOCATION, AND DIMENSIONS OF ALL PARTITIONS AND DOORS SHALL BE AS SHOWN ON ARCHITECT'S DRAWINGS. IN CASE OF CONFLICT, NOTIFY ARCHITECT PRIOR TO PARTITION INSTALLATION. ARCHITECT'S PLAN SUPERSEDES ALL OTHERS.
- E. ALL PARTITIONS ARE DIMENSIONED FROM FINISHED FACE TO FINISHED FACE U.N.O. AND SHALL ALLOW FOR THICKNESS OF WALL FINISHES, INCLUDING WOOD AND FABRIC PANELS.
- F. ALL DIMENSIONS MARKED 'HOLD' OR 'CLEAR' SHALL BE MAINTAINED.
- G. ALL NEW PARTITIONS TO BE PARTITION TYPE A3A, U.N.O.
- H. PROVIDE 20 GA. IN-WALL METAL BLOCKING FOR WALL-MOUNTED MILLWORK AND AV EQUIPMENT.
- I. PERIMETER OFFICES ARE DIMENSIONED FROM INSIDE FACE OF SILL, U.N.O.
- K. ALL NEW WALLS TO BE LOCATED IN RELATION TO EXISTING WALLS TO REMAIN AND COLUMN LINES AS REQUIRED.

Date	Description
12/15/17	ISSUE FOR PERMIT & CONSTRUCTION

**unum**  
2211 Congress Street  
Portland, ME 04122

**Gensler**  
214 North Tryon Street  
Suite 2320  
Charlotte, NC 28202  
United States

Tel 704.377.2725  
Fax 704.377.2807

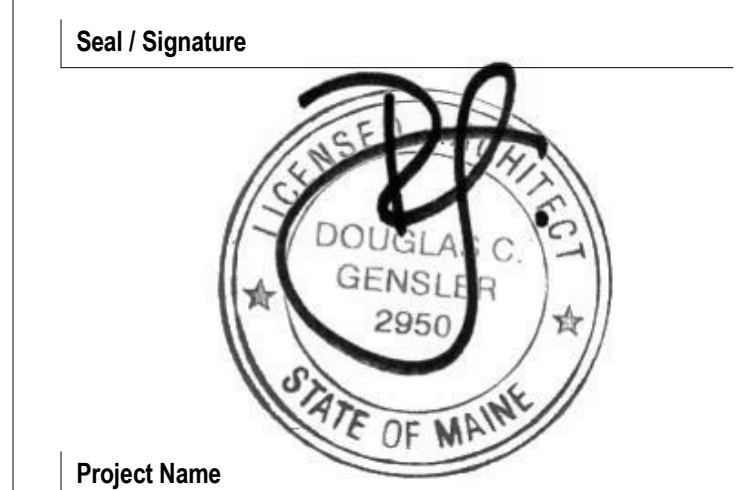

Project Name  
**Unum Workplace Transformation - Phase 2 & 3 (HO2 & HO3)**

Project Number  
**59.6481.003**

Description  
**CONSTRUCTION PLAN - LEVEL 01 - AREA C - HO3**

Scale  
As indicated

**A02.111C**