

12/15/2017 2:07:48 PM I:\gensler_ad\projects\Revit\Level\Access\25168559_6481_003_UNUM - PORTLAND - HO3 - UNUM - PORTLAND - HO3_2016_25168559.rvt

01 DEMOLITION PLAN - LEVEL 02 - AREA N
SCALE: 1/8" = 1'-0"

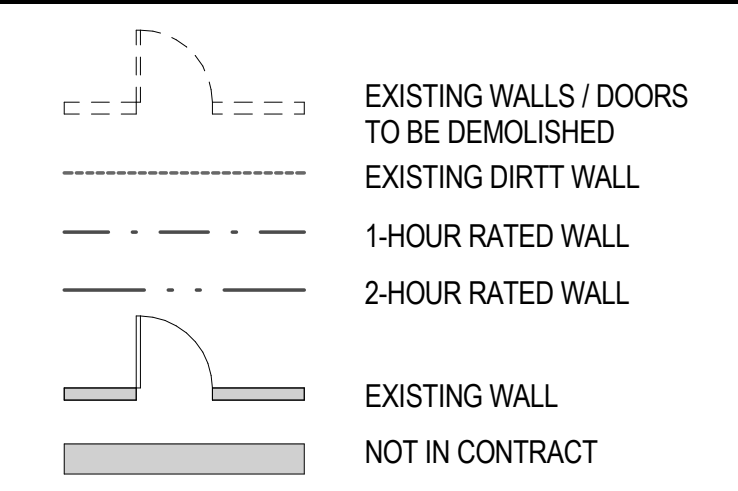

SHEET NOTES

- 01 EXISTING DIRT DOOR AND WALL ASSEMBLY REMOVED BY OWNER. DEMOLISH ANY REMAINING PARTITIONS/FRAMING AS REQUIRED FOR NEW WORK.
- 02 DEMOLISH EXISTING WALL.
- 03 DEMOLISH EXISTING DOOR AND FRAME. COORDINATE STORAGE OF HARDWARE SET FOR REUSE WITH OWNER.
- 07 REMOVE EXISTING WALL, FLOOR AND CEILING FINISHES.
- 15 EXISTING DOOR TO REMAIN.
- 26 EXISTING FIRE EXTINGUISHER CABINET TO REMAIN. GC TO CONFIRM FIRE EXTINGUISHER CAN BE REUSED. PREP FOR PAINT FINISH TO MATCH ADJACENT FINISH.
- 31 EXISTING WALL TO DECK TO REMAIN. COORDINATE WITH PLAN. PATCH AND REPAIR AS REQUIRED.
- 35 RECESSED DRINKING FOUNTAIN TO BE DEMOLISHED AND REPLACED.
- 61 PATCH AND REPAIR EXTERIOR WALL, TYP.

GENERAL NOTES

- A. DEMOLISH ALL PARTITIONS AND ASSOCIATED FIXTURES AS SHOWN DASHED. U.N.O.
- B. DEMOLITION DRAWINGS ARE DIAGRAMMATIC AND DO NOT INTEND TO SHOW THE FULL EXTENT OF ALL AREAS AFFECTED BY UTILITY DEMOLITION AND RECONSTRUCTION. DEMOLITION SHALL INCLUDE ALL ITEMS INDICATED ON THE DEMOLITION PLANS AND ALL OTHER ITEMS REQUIRED TO BE DEMOLISHED TO ACCOMPLISH CONSTRUCTION INDICATED ELSEWHERE IN THE CONTRACT DOCUMENTS. IF QUESTIONS ARISE AS TO THE REMOVAL OF MATERIAL IN ACCORDANCE WITH THE CONTRACT DOCUMENTS, CLARIFY THE POINT IN QUESTION WITH THE ARCHITECT BEFORE PROCEEDING.
- C. PROVIDE TEMPORARY WEATHER PROTECTION DURING INTERVAL BETWEEN DEMOLITION AND REMOVAL OF EXISTING CONSTRUCTION ON EXTERIOR SURFACES, AND INSTALLATION OF NEW CONSTRUCTION TO ENSURE THAT NO WATER LEAKAGE OR DAMAGE OCCURS TO STRUCTURE OR INTERIOR AREAS OF EXISTING BUILDING. REMOVE PROTECTIONS AT COMPLETION OF WORK.
- D. AS NOTED, ALL FLOOR FINISHES TO BE REMOVED. THE SLAB LEVELED AS REQUIRED, AND PREPARED FOR NEW FINISHES.
- E. REFER TO SERIES G00 FOR GRAPHIC SYMBOLS, ABBREVIATIONS AND GENERAL NOTES.
- F. REMOVE ALL EXISTING WALL FINISHES AND WALL BASE AT COLUMNS, PERIMETER WALLS, AND CORE WALLS WHERE NEW FINISHES ARE NOTED. PATCH AND PREPARE PARTITIONS AS REQUIRED TO ACCEPT NEW WALL BASE.
- G. PROVIDE PROTECTIVE BARRICADES, PROTECTIVE CANOPIES, AND OTHER FORMS OF PROTECTION AS REQUIRED TO PROTECT OWNER'S PERSONNEL AND GENERAL PUBLIC FROM INJURY AND TO PROVIDE FREE AND SAFE PASSAGE DUE TO SELECTIVE DEMOLITION WORK. CONSTRUCT TEMPORARY INSULATED SOLID DUST PROOF PARTITIONS WHERE REQUIRED TO SEPARATE AREAS WHERE NOISY OR EXTENSIVE DIRT OR DUST OPERATIONS ARE PERFORMED. EQUIP PARTITIONS WITH DUST PROOF DOORS AND SECURITY LOCKS IF REQUIRED.
- H. REMOVE ALL VERTICAL BLINDS AND PROVIDE TO OWNER FOR REUSE/STORAGE.
- I. REMOVAL OF ANY EQUIPMENT, CABLING SWITCHES, AND CONDUIT PERTAINING TO DATA/ COMMUNICATIONS AND TELEPHONE SHALL BE VERIFIED WITH TELEPHONE COMPANIES SERVICE OWNER OR TENANT DATA/ COMMUNICATIONS REPRESENTATIVE AS REQUIRED TO PREVENT NEW CONSTRUCTION DELAYS.
- J. MAINTAIN EXISTING UTILITIES TO REMAIN. KEEP IN SERVICE. IDENTIFY AND PROTECT AGAINST DAMAGE DURING DEMOLITION OPERATIONS.
- K. REMOVE TO SOURCE ALL PIPES, VENTS APPLIANCES OR DRAINS NOT BEING RE-USED.
- L. REFER TO PLUMBING, MECHANICAL, AND ELECTRICAL DRAWINGS FOR ADDITIONAL DEMOLITION, RECONSTRUCTION, AND PROTECTION INFORMATION.

KEY PLAN

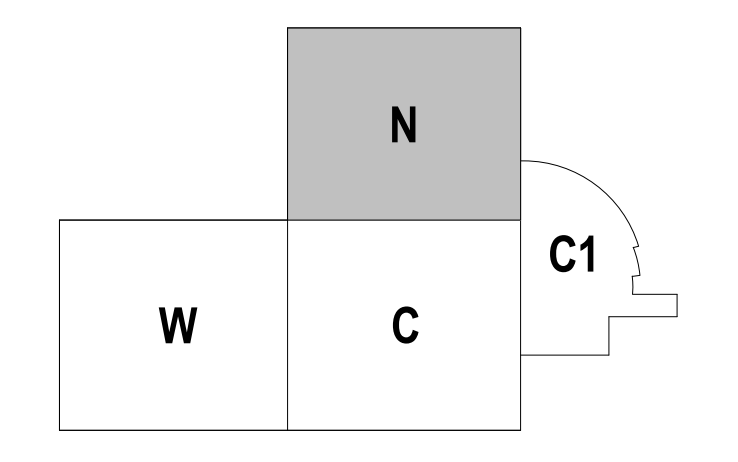

unum
2211 Congress Street
Portland, ME 04122

Gensler
214 North Tryon Street
Suite 2320
Charlotte, NC 28202
United States

Tel 704.377.2725
Fax 704.377.2807

Date	Description
12/15/17	ISSUE FOR PERMIT & CONSTRUCTION

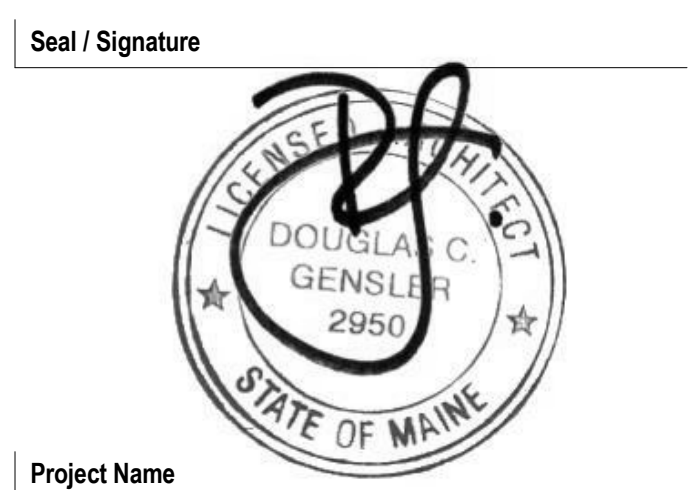

Project Name
Unum Workplace Transformation - Phase 2 & 3 (HO2 & HO3)

Project Number
59.6481.003

Description
DEMOLITION PLAN - LEVEL 02 - AREA N - HO3

Scale
As indicated

A01.112N