

12/15/2017 2:06:58 PM I:\gensler\ad\projects\Revit\Level\Access\25168559 6481.003 - UNUM - PORTLAND - HO3 - UNUM - PORTLAND - HO3\_2016\_25168559.rvt

**01 DEMOLITION PLAN - LEVEL 01 - AREA N**  
SCALE: 1/8" = 1'-0"

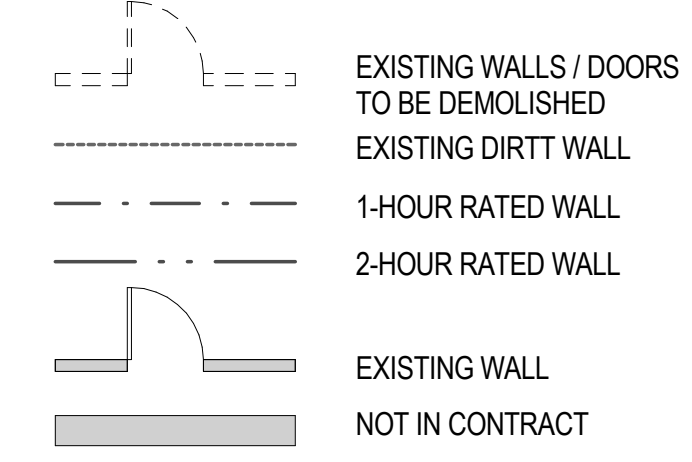
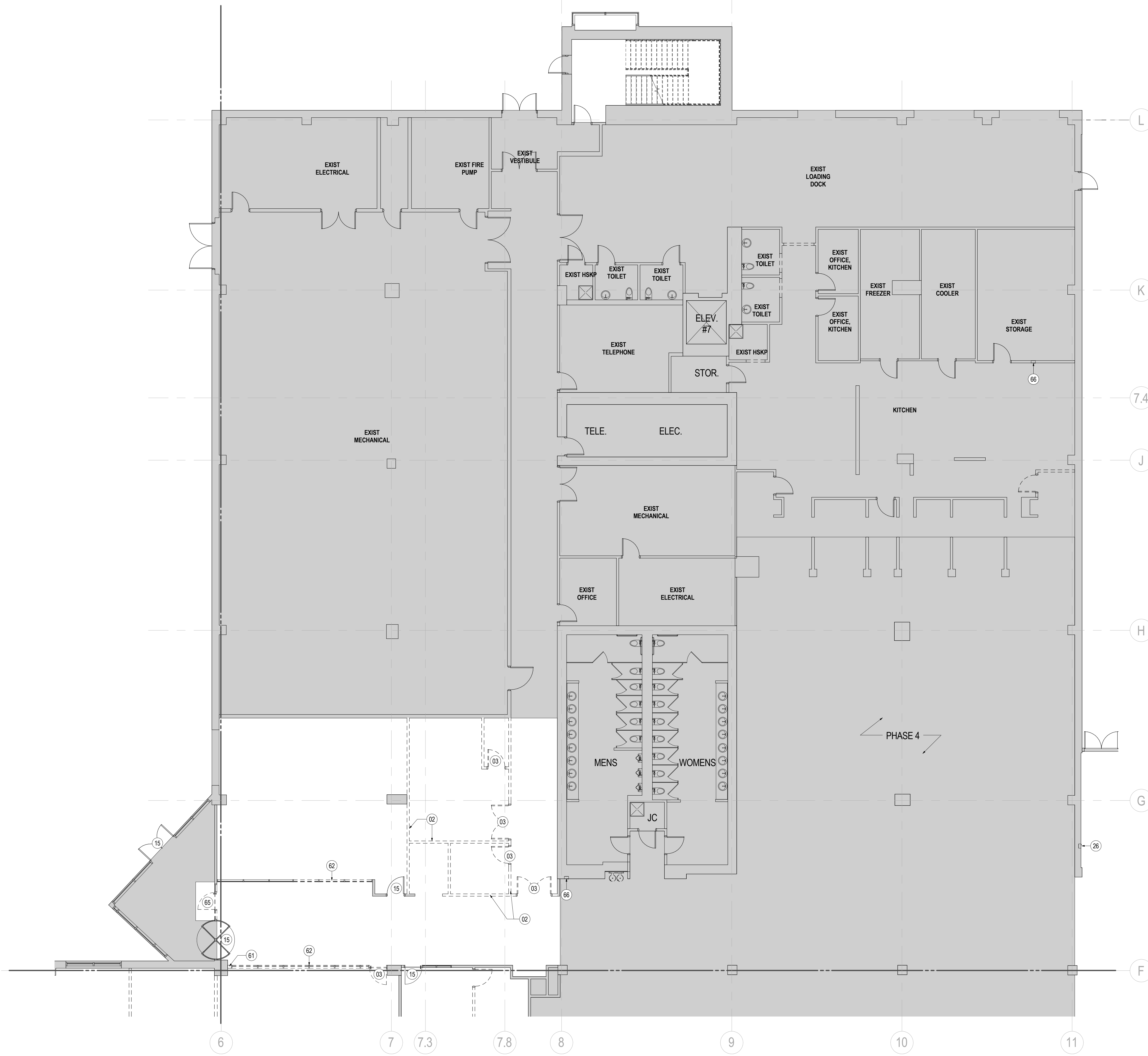

**SHEET NOTES**

- 02 DEMOLISH EXISTING WALL.
- 03 DEMOLISH EXISTING DOOR AND FRAME. COORDINATE STORAGE OF HARDWARE SET FOR REUSE WITH OWNER.
- 15 EXISTING DOOR TO REMAIN.
- 61 PATCH AND REPAIR EXTERIOR WALL, TYP.
- 62 DEMOLISH EXISTING STORE FRONT.
- 65 REMOVE EXISTING DOOR AND STORE FRONT ASSEMBLY.
- 66 EXISTING FIRE EXTINGUISHER CABINET TO REMAIN.

**GENERAL NOTES**

- A. DEMOLISH ALL PARTITIONS AND ASSOCIATED FIXTURES AS SHOWN DASHED. U.N.O.
- B. DEMOLITION DRAWINGS ARE DIAGRAMMATIC AND DO NOT INTEND TO SHOW THE FULL EXTENT OF ALL AREAS AFFECTED BY UTILITY DEMOLITION AND RECONSTRUCTION. DEMOLITION SHALL INCLUDE ALL ITEMS INDICATED ON THE DEMOLITION PLANS AND ALL OTHER ITEMS REQUIRED TO BE DEMOLISHED TO ACCOMPLISH CONSTRUCTION INDICATED ELSEWHERE IN THE CONTRACT DOCUMENTS. IF QUESTIONS ARISE AS TO THE REMOVAL OF MATERIAL IN ACCORDANCE WITH THE CONTRACT DOCUMENTS, CLARIFY THE POINT IN QUESTION WITH THE ARCHITECT BEFORE PROCEEDING.
- C. PROVIDE TEMPORARY WEATHER PROTECTION DURING INTERVAL BETWEEN DEMOLITION AND REMOVAL OF EXISTING CONSTRUCTION ON EXTERIOR SURFACES, AND INSTALLATION OF NEW CONSTRUCTION TO ENSURE THAT NO WATER LEAKAGE OR DAMAGE OCCURS TO STRUCTURE OR INTERIOR AREAS OF EXISTING BUILDING. REMOVE PROTECTIONS AT COMPLETION OF WORK.
- D. AS NOTED, ALL FLOOR FINISHES TO BE REMOVED. THE SLAB LEVELED AS REQUIRED, AND PREPARED FOR NEW FINISHES.
- E. REFER TO SERIES G00 FOR GRAPHIC SYMBOLS, ABBREVIATIONS AND GENERAL NOTES.
- F. REMOVE ALL EXISTING WALL FINISHES AND WALL BASE AT COLUMNS, PERIMETER WALLS, AND CORE WALLS WHERE NEW FINISHES ARE NOTED. PATCH AND PREPARE PARTITIONS AS REQUIRED TO ACCEPT NEW WALL BASE.
- G. PROVIDE PROTECTIVE BARRICADES, PROTECTIVE CANOPIES, AND OTHER FORMS OF PROTECTION AS REQUIRED TO PROTECT OWNER'S PERSONNEL AND GENERAL PUBLIC FROM INJURY AND TO PROVIDE FREE AND SAFE PASSAGE DUE TO SELECTIVE DEMOLITION WORK. CONSTRUCT TEMPORARY INSULATED SOLID DUST PROOF PARTITIONS WHERE REQUIRED TO SEPARATE AREAS WHERE NOISY OR EXTENSIVE DIRT OR DUST OPERATIONS ARE PERFORMED. EQUIP PARTITIONS WITH DUST PROOF DOORS AND SECURITY LOCKS IF REQUIRED.
- H. REMOVE ALL VERTICAL BLINDS AND PROVIDE TO OWNER FOR REUSE/STORAGE.
- I. REMOVAL OF ANY EQUIPMENT, CABLING SWITCHES, AND CONDUIT PERTAINING TO DATA/ COMMUNICATIONS AND TELEPHONE SHALL BE VERIFIED WITH TELEPHONE COMPANIES SERVICE OWNER OR TENANT DATA/ COMMUNICATIONS REPRESENTATIVE AS REQUIRED TO PREVENT NEW CONSTRUCTION DELAYS.
- J. MAINTAIN EXISTING UTILITIES TO REMAIN. KEEP IN SERVICE. IDENTIFY AND PROTECT AGAINST DAMAGE DURING DEMOLITION OPERATIONS.
- K. REMOVE TO SOURCE ALL PIPES, VENTS APPLIANCES OR DRAINS NOT BEING RE-USED.
- L. REFER TO PLUMBING, MECHANICAL, AND ELECTRICAL DRAWINGS FOR ADDITIONAL DEMOLITION, RECONSTRUCTION, AND PROTECTION INFORMATION.

**KEY PLAN**



211 Congress Street  
Portland, ME 04122



214 North Tryon Street  
Suite 2320  
Charlotte, NC 28202  
United States  
Tel: 704.377.2725  
Fax: 704.377.2807

Date	Description
12/15/17	ISSUE FOR PERMIT & CONSTRUCTION

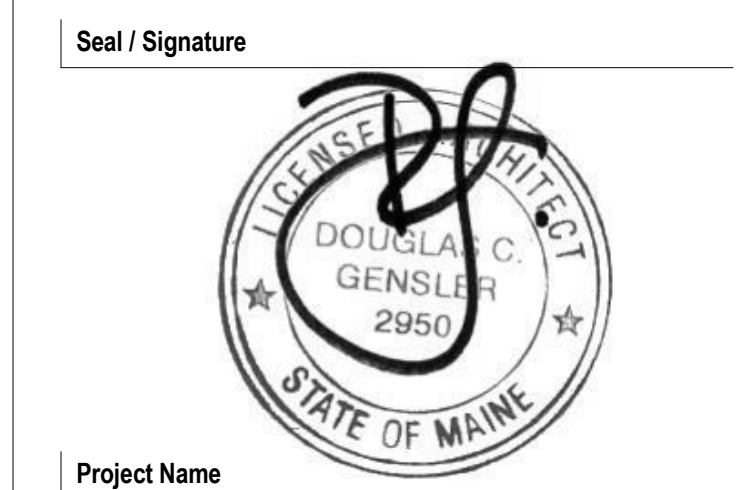

Project Name  
**Unum Workplace Transformation - Phase 2 & 3 (HO2 & HO3)**

Project Number  
**59.6481.003**

Description  
**DEMOLITION PLAN - LEVEL 01 - AREA N - HO3**

Scale  
As indicated

**A01.111N**