

05 EF TRAINING - WEST ELEVATION  
SCALE: 3/8" = 1'-0"

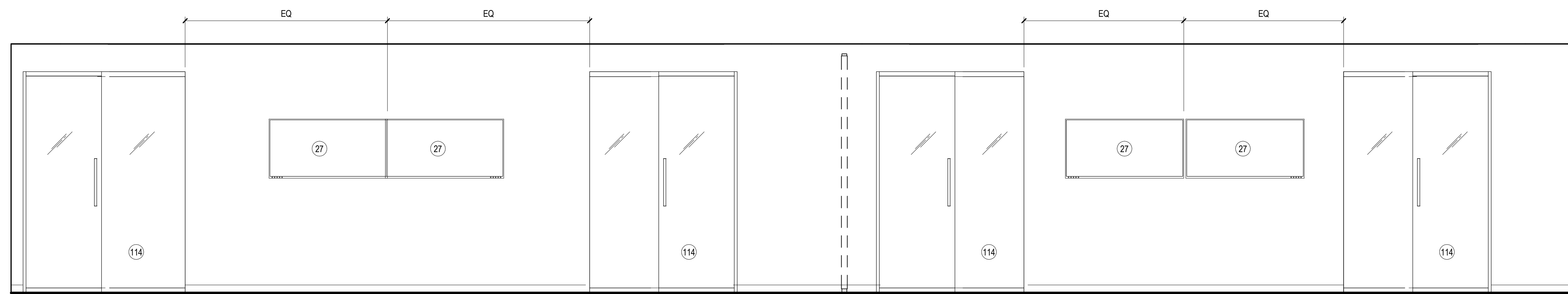

03 EC-ED TRAINING - SOUTH ELEVATION  
SCALE: 3/8" = 1'-0"

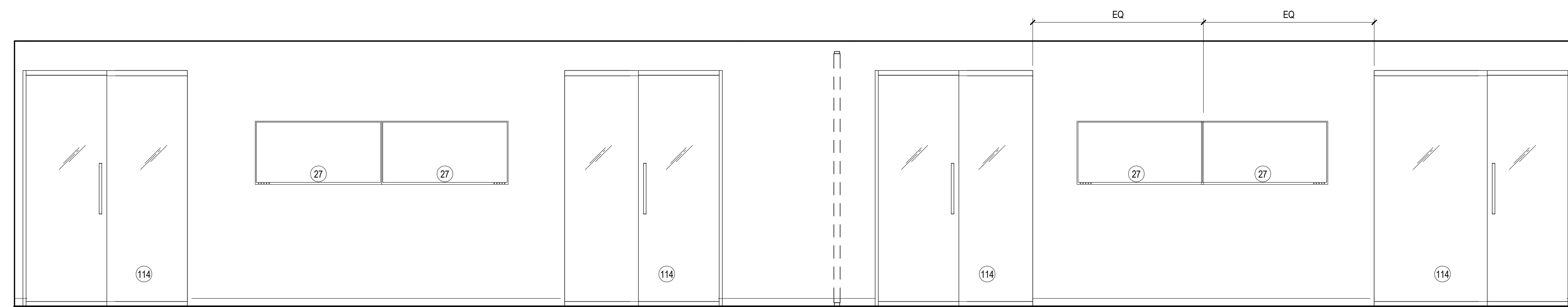

06 EG-EH TRAINING - NORTH ELEVATION  
SCALE: 3/8" = 1'-0"

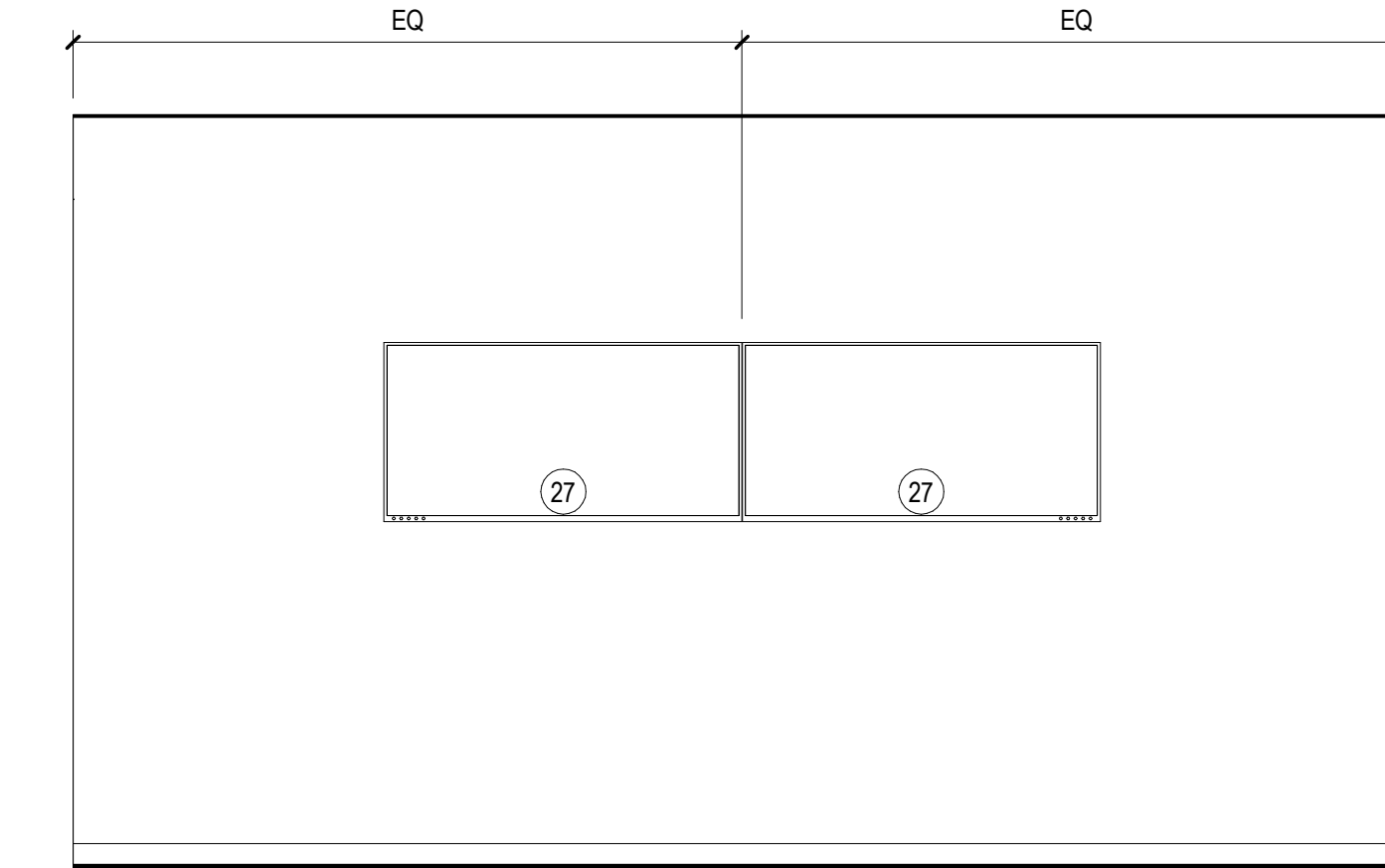

01 EE TRAINING - WEST ELEVATION  
SCALE: 3/8" = 1'-0"

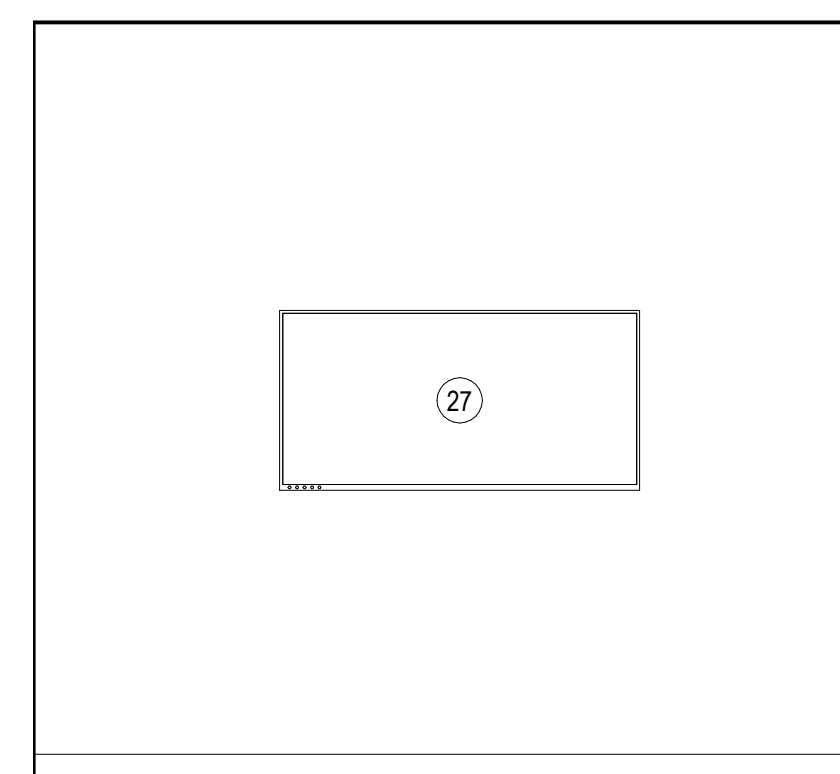

07 EK CONFERENCE - WEST ELEVATION  
SCALE: 3/8" = 1'-0"

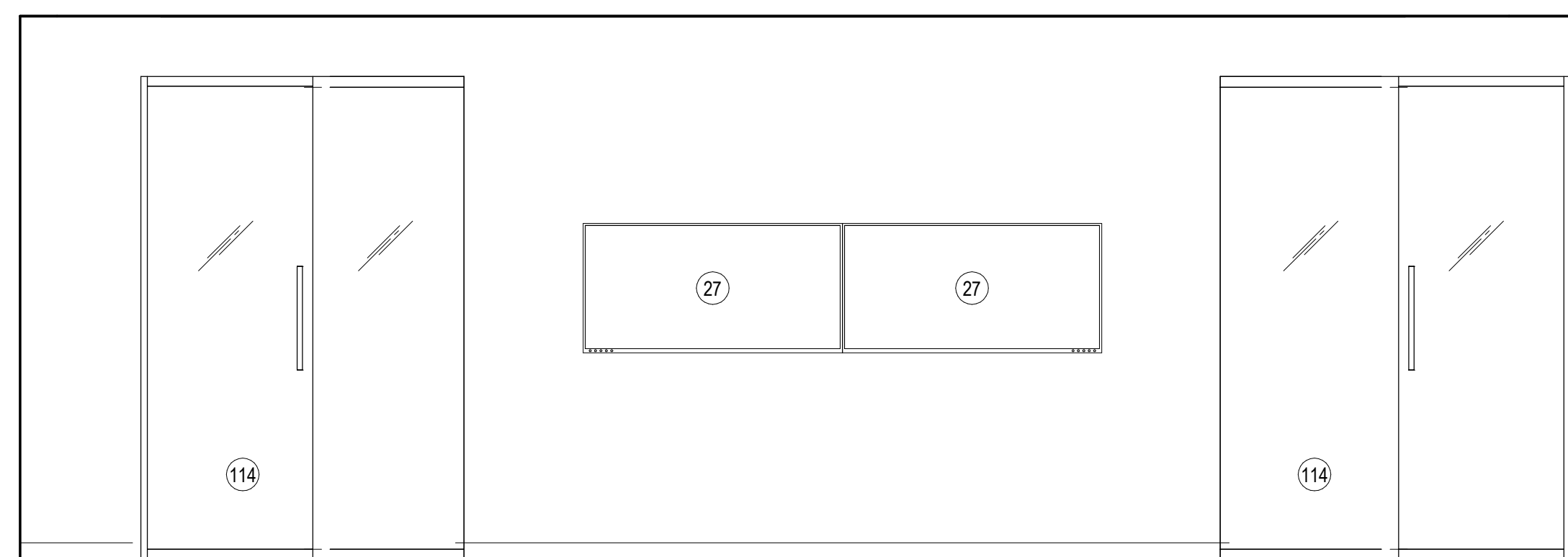

04 EB TRAINING - SOUTH ELEVATION  
SCALE: 3/8" = 1'-0"

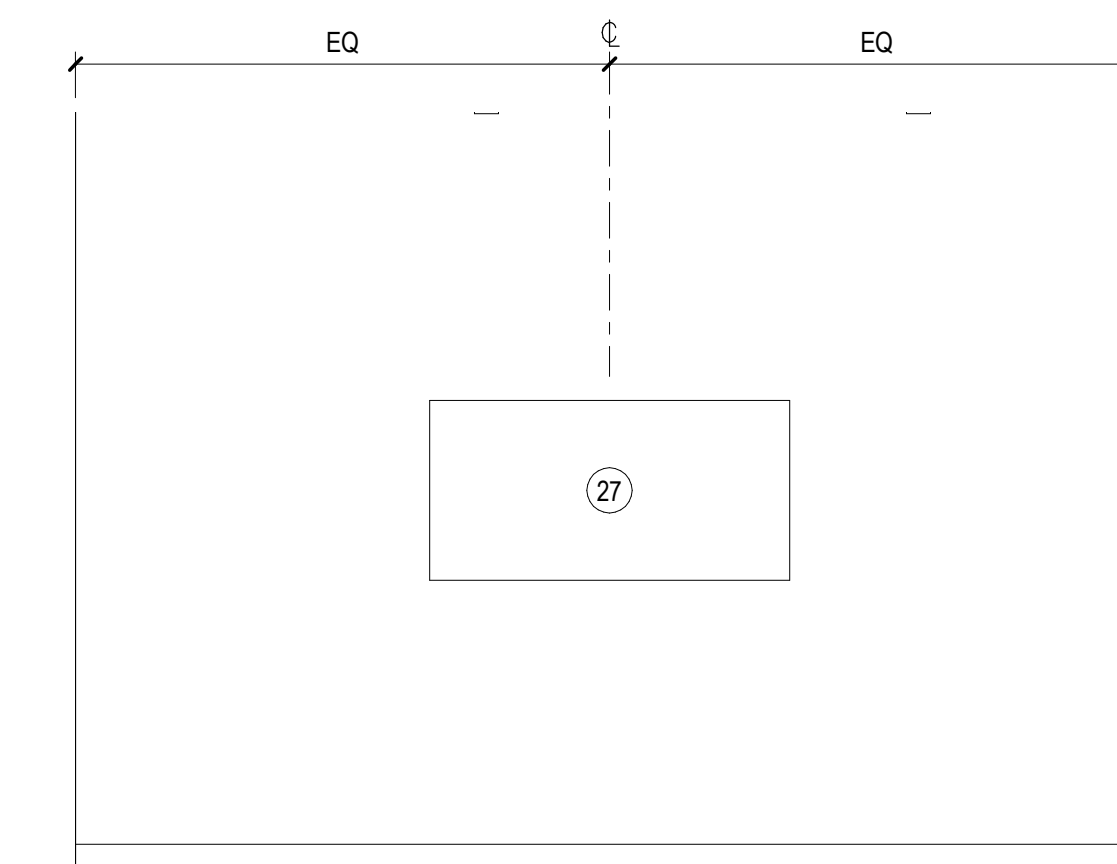

02 EJ CONFERENCE - WEST ELEVATION  
SCALE: 3/8" = 1'-0"

Date	Description
12/15/17	ISSUE FOR PERMIT & CONSTRUCTION

Seal / Signature

Project Name  
Unum Workplace  
Transformation - Phase 2 & 3  
(H02 & H03)  
59.6481.003  
Description  
INTERIOR ELEVATIONS - LEVEL 00 -  
H02

Scale  
3/8" = 1'-0"

A07.001

12/15/2017 9:40:42 AM I:\gensler\ad\projects\Revit\level\00\00\262659 6481 003 - UNUM - PORTLAND - H02\_2016\_22462.rvt

**SHEET NOTES**

- 27 WALL MOUNTED TV, NIC. REFER TO ELECTRICAL DRAWINGS AND AV REFERENCE DRAWINGS FOR MOUNTING HEIGHT, GC TO PROVIDE BLOCKING AS REQUIRED.
- 114 DEMOUNTABLE STOREFRONT AND DOOR. REFER TO PLAN AND PROJECT MANUAL FOR MORE INFORMATION.

**GENERAL NOTES**

- A. REFER TO SHEETS SERIES A02.100, A02.200 AND 02.100 FOR CONSTRUCTION, REFLECTED CEILING AND FINISH PLAN GENERAL NOTES.
- B. REFER TO FINISH PLAN FOR WALL BASE AS SCHEDULED, TYPICAL.

**KEY PLAN**