





GRAPHIC LEGEND:

-  Occupant Load
-  Cumulative Occupant Load
-  1-hour Fire/Smoke Separation
-  2-hour Fire/Smoke Separation
-  Open Office Area

International Building Code and Life Safety Code Summary

EDITIONS REFERENCED
International Building Code 2009
NFPA 101 - Life Safety Code 2009

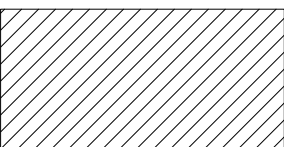
GENERAL DESCRIPTION OF WORK
Total 3rd floor area: 67,719 sf
Approximate area of renovation: 4,416 sf
Construction types: Type Ila non-combustible, protected

OCCUPANCY
The predominant occupancy of the building is Offices. The building also includes assembly and storage occupancies. Assembly spaces intended exclusively for use by employees as part of their training and meeting functions.

FIRE RESISTANCE
- 2-hr separations at Exit Stairs and Shafts
- 1-hr separations at Elevator Lobbies
- Doors shall be self closing at barriers.

EGRESS COMPONENTS
- Stairs in the existing building are enclosed with existing concrete construction.
- Maximum Dead-End Corridor = 50'
- Maximum Travel Distance = 200'
- Egress width per person = 0.3' @ stairs, 0.2' @ horizontal exits

SPRINKLER
This project is partially equipped with an automated sprinkler system. This floor is partially sprinkled (4,330 sf +/-).
- See Electrical drawings for extent of work at Fire Alarm System.

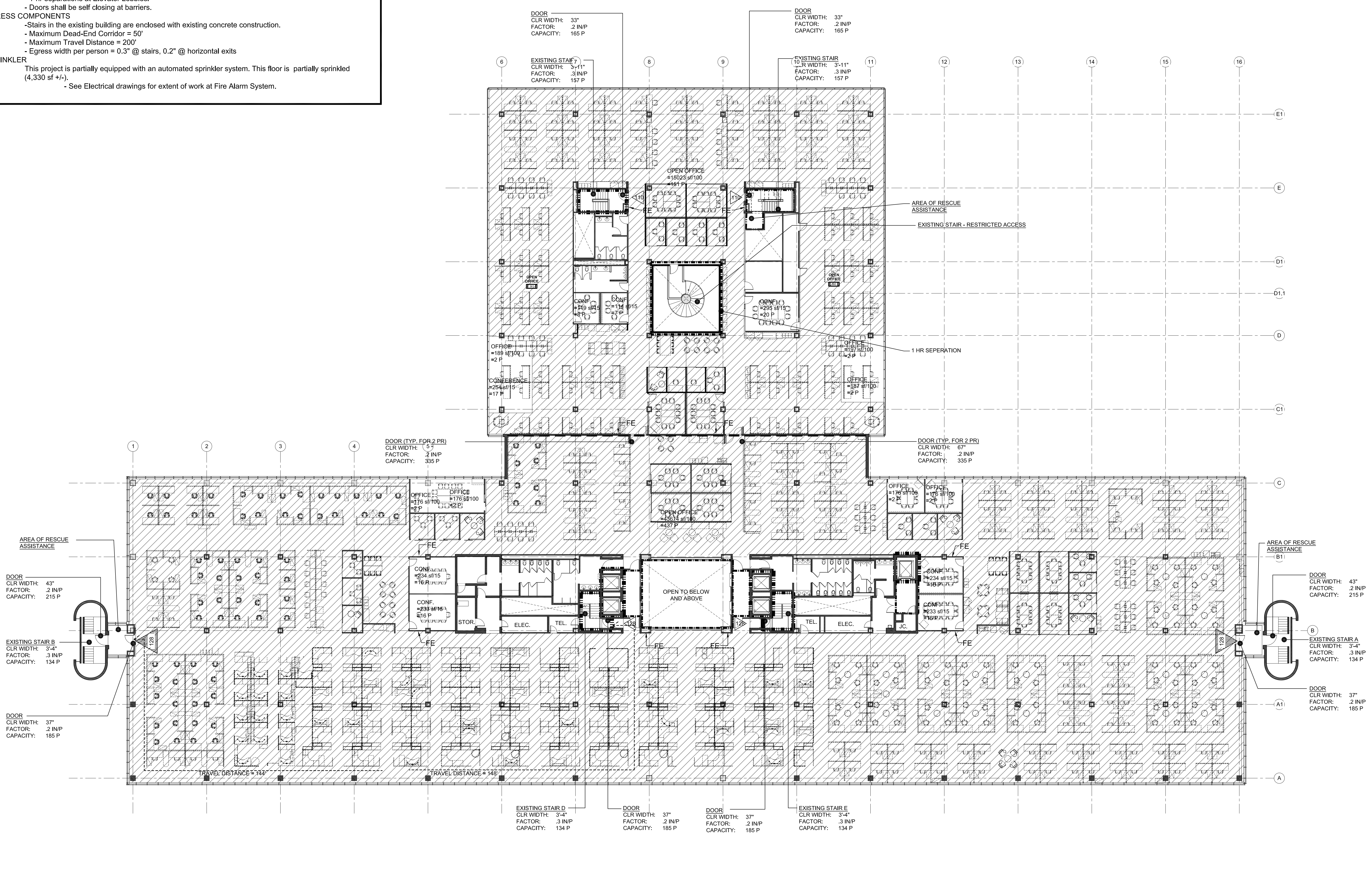

1 HO1-THIRD FLOOR CODE DIAGRAM
1/16" = 1'-0"