

Thursday, October 2, 2014 3:47:52 PM CHELSEA UPHAM
 H:\MASTER PROJ FILES\2014\10 WORKING FILES\02 ARCHITECTURAL\ALUM CAD\SHETS\A500 HOLD\DETAILS.DWG

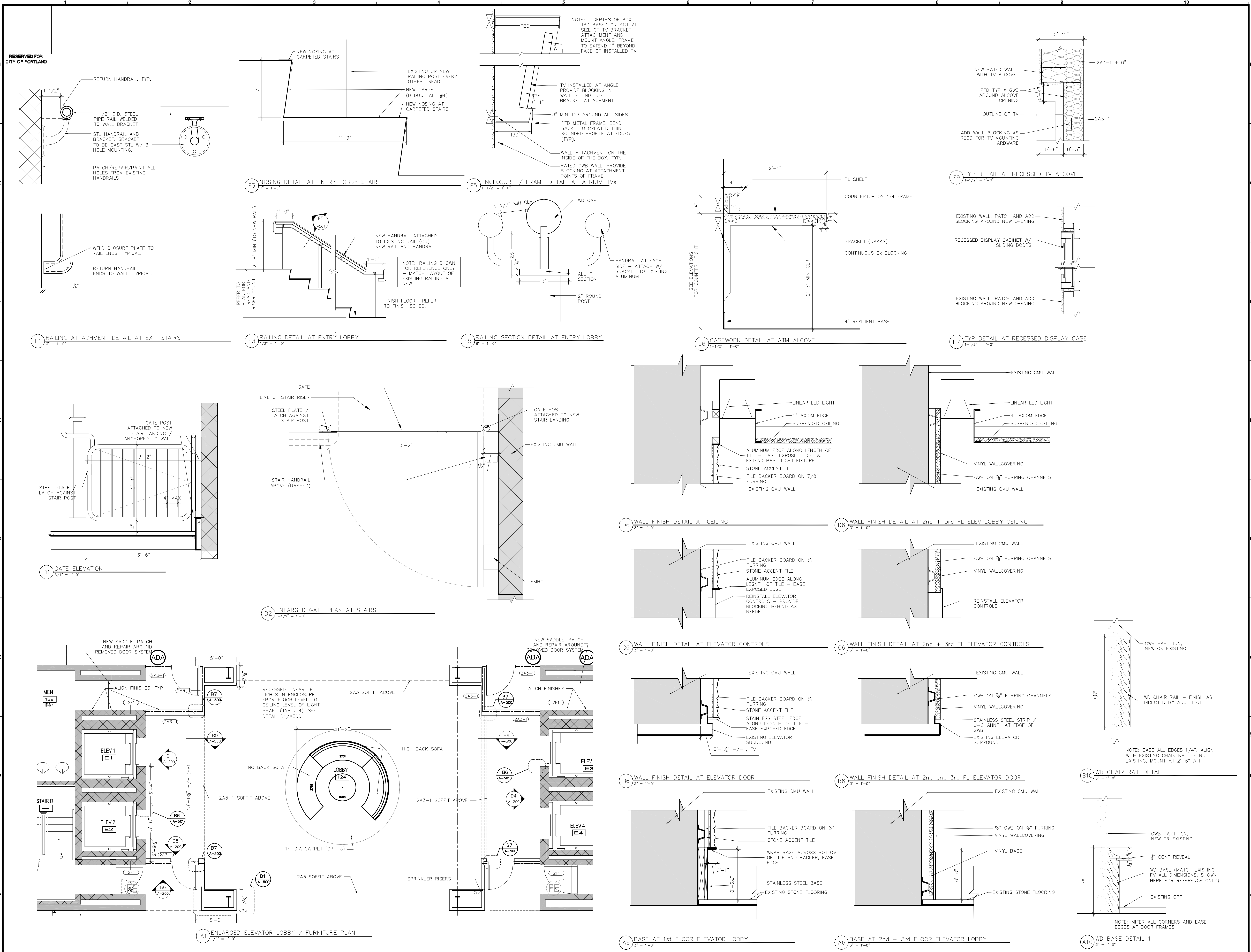

PDT ARCHITECTS
 49 DARTMOUTH STREET
 PORTLAND, MAINE 04103
 207-776-1089
 www.pdtarch.com

Allied Engineering
 Structural Mechanical
 Electrical Commissioning

160 Veranda Street
 Portland, Maine 04103
 T: 207-221-2260
 F: 207-221-2266
 Web: www.allied-eng.com

allied Project No:
 CAD File:
 COPYRIGHT 2014
 PDT Architects
 Reuse or reproduction of the contents of this document is not permitted without the permission of PDT Architects.

2014 UNUM - HOI Interior Renovations
 PORTLAND, MAINE

REGISTERED ARCHITECT
 BRIAN W. WELLS
 STATE OF MAINE

PDT JOB NO.
 13-096

DRAWN
 CLL

SCALE
 VARIES

ISSUE: 2 Oct 2014
 PERMIT SET

TITLE
 TYPICAL DETAILS

SHEET
A501