

H7	LIGHTING GENERAL NOTES
	<ol style="list-style-type: none"> EXISTING LUMINAIRES SCHEDULED FOR RELOCATION ARE TO BE REMOVED IN ORDER TO SECURE FLOOR HEIGHT. THE DURATION OF CONSTRUCTION DIVISION 26 SHALL CLEAN AND TEST ALL LUMINAIRES FOR PROPER OPERATION PRIOR TO REINSTALLATION. REPAIRS TO LUMINAIRE HOUSINGS SHALL BE TURNED OVER TO THE OWNER. ALL EXISTING LUMINAIRES SCHEDULED TO BE REINSTALLED SHALL BE CLEANED AND IMPROVED LAMP SHALL BE REPLACED.

G9	LIGHTING KEYED NOTES
	<ol style="list-style-type: none"> IN THIS AREA, CONNECT LUMINAIRES TO EXISTING LOCAL LIGHTING CIRCUITS. PROVIDE NEW LOCAL SWITCHING AS SHOWN AHEAD OF EXISTING BMS CONTROLS. CONTRACTOR SHALL VERIFY ALL CIRCUIT AMPACITIES PRIOR TO INSTALLATION. CONNECT LUMINAIRES TO EXISTING LOCAL LIGHTING CIRCUIT AND EXISTING LOCAL LIGHTING SWITCH GROUP. CONTRACTOR SHALL VERIFY ALL CIRCUIT AMPACITIES PRIOR TO INSTALLATION. CONNECT TO UNSWITCHED PORTION OF LOCAL EMERGENCY LIGHTING CIRCUIT. IN THIS ROOM, EXTEND EXISTING LIGHTING BRANCH CIRCUIT WIRING TO PROVIDE NEW SWITCHING CONFIGURATION. INST ALL LOCAL LIGHTING CONTROLS AHEAD OF EXISTING BMS CONTROLS. CONNECT LUMINAIRE TO OCCUPANCY SENSOR CONTROL AHEAD OF EXISTING BMS CONTROLS. UTILIZE EXISTING LIGHTING BRANCH CIRCUIT. CONNECT EXISTING LUMINAIRES TO EXISTING EXTERIOR LIGHTING CIRCUIT. MODIFY OR EXTEND EXISTING BRANCH CIRCUIT WIRING AS NECESSARY. VERIFY ALL CIRCUIT AMPACITIES IN THE FIELD. CONNECT LIGHTING TO NEW LOCAL OCCUPANCY SENSOR CONTROL. VERIFY NEW CIRCUITRY FOR COMPACTOR HOUSING POWER EQUIPMENT. REFER TO KEYED NOTE #1, DWG B-101B.

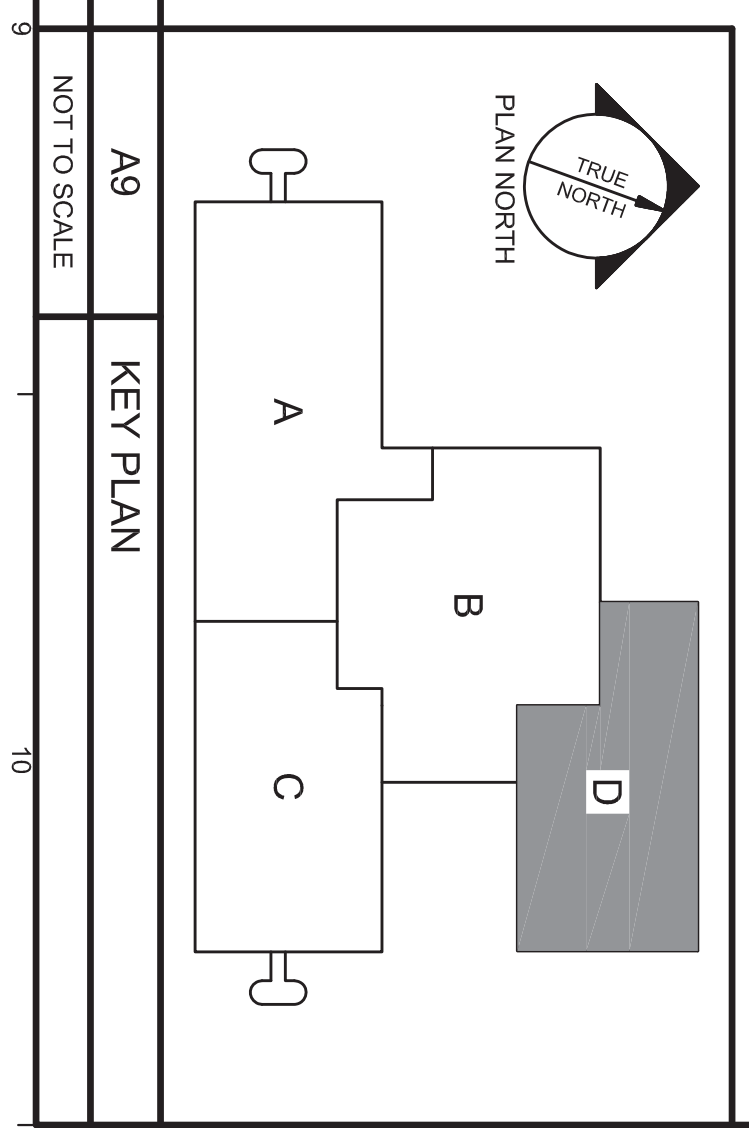

<p>ARCHITECTS 49 BATHMOUTH STREET PORTLAND, MAINE 04101 207.775-1899 www.pdtdesign.com</p>	<p>Allied Engineering Electrical Commissioning 161 Veranda Street Portland, Maine 04103 1-207-211-2169 www.allied-eng.com</p>	<p>allied Project No. 12027 CAD FILE: 12027A.DWG COPYRIGHT 2013 PDI Architects PDI Architects 1000 State Street Portland, ME 04101 207.775-1899 www.pdiarch.com</p>	<p>UNUM ~ HOI Basement & Dock Renovations PORTLAND, MAINE</p>	<p>STATE OF MAINE PLANNING BOARD CATHERINE A. FAUCHER No. 1701 12-124 PLOT JOB NO.</p>	<p>TITLE ELECTRICAL LIGHTING PART PLAN -AREA D</p> <p>SHEET EL-101D</p>
---	---	---	---	---	---