

| H7 | LIGHTING GENERAL NOTES |
|----|---|
| | <ol style="list-style-type: none"> EXISTING LUMINAIRES SCHEDULED FOR REMOVAL ARE TO BE REMOVED IN PREPARATION FOR REWORK. THE DURATION OF CONSTRUCTION, DIVISION 26 SHALL CLEAN AND TEST ALL LUMINAIRES FOR PROPER OPERATION PRIOR TO REINSTALLATION. REINSTALLATION SHALL BE SCHEDULED FOR PROPER OPERATION PRIOR TO REINSTALLATION. REINSTALLATION SHALL BE SCHEDULED FOR PROPER OPERATION PRIOR TO REINSTALLATION. ALL EXISTING LUMINAIRES SCHEDULED TO BE REINSTALLED SHALL BE REINSTALLED AND IMPROVED LAMPS SHALL BE REPLACED. |

| G9 | LIGHTING KEYED NOTES |
|----|--|
| | <ol style="list-style-type: none"> IN THIS AREA, CONNECT LUMINAIRES TO EXISTING LOCAL LIGHTING CIRCUITS. PROVIDE NEW LOCAL SWITCHING AS SHOWN AHEAD OF EXISTING BMS CONTROLS. CONTRACTOR SHALL VERIFY ALL CIRCUIT AMP RATINGS PRIOR TO INSTALLATION. CONNECT LUMINAIRES TO EXISTING LOCAL LIGHTING CIRCUIT AND EXISTING LOCAL LIGHTING SWITCH GROUP. CONTRACTOR SHALL VERIFY ALL CIRCUIT AMP RATINGS PRIOR TO INSTALLATION. CONNECT TO UNSWITCHED PORTION OF LOCAL EMERGENCY LIGHTING CIRCUIT. IN THIS ROOM, EXTEND EXISTING LIGHTING BRANCH CIRCUIT WIRING TO PROVIDE NEW SWITCHING CONFIGURATION. INST. ALL LOCAL LIGHTING CONTROLS AHEAD OF EXISTING BMS CONTROLS. CONNECT LUMINAIRES TO OCCUPANCY SENSOR CONTROL AHEAD OF EXISTING BMS CONTROLS. UTILIZE EXISTING LIGHTING BRANCH CIRCUIT. CONNECT EXISTING LUMINAIRES TO EXISTING EXTERIOR LIGHTING CIRCUIT. MODIFY OR EXTEND EXISTING BRANCH CIRCUIT WIRING AS NECESSARY. VERIFY ALL CIRCUIT AMP RATINGS IN THE FIELD. CONNECT LIGHTING TO NEW LOCAL OCCUPANCY SENSOR CONTROL. VERIFY ALL CIRCUIT AMP RATINGS PRIOR TO INSTALLATION. REFER TO KEYED NOTE #1, DWG B-9101B. |

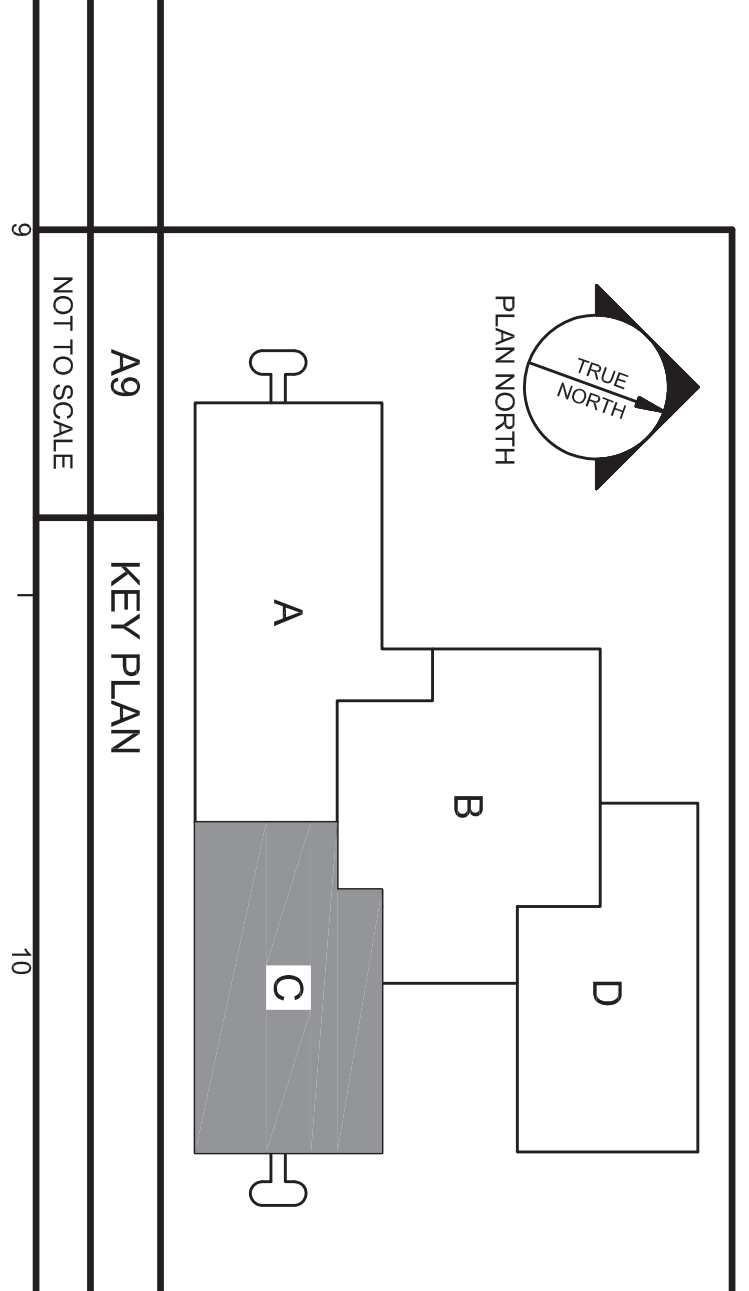

| | | | | | | | | |
|--|--|--|--|---------------------------------|---|--|--|---|
| <p>ARCHITECTS 49 DEARTH STREET PORTLAND, MAINE 04101 www.allied-eng.com</p> | <p>Allied Engineering Electrical Commissioning 161 Veranda Street Portland, Maine 04103 1-800-221-2269 www.allied-eng.com</p> | <p>Issue: 21 MAY 2013 AS PER EXIT SIGN REVISIONS</p> | <p>UNUM ~ HOI Basement & Dock Renovations PORTLAND, MAINE</p> | <p>EL-101C SHEET</p> | <p>PROJECT INFORMATION PROJECT NO. 12-124 DRAWN: NLR SCALE: AS NOTED ISSUE: 21 MAY 2013 AS PER EXIT SIGN REVISIONS</p> | <p>PROFESSIONAL SEAL KATHERINE A. FAUCHER REGISTERED PROFESSIONAL ENGINEER MAINE 0000000000</p> | <p>CLIENT INFORMATION UNUM HO-1 2012 RENOVATIONS 161 VERANDA STREET PORTLAND, MAINE 04103</p> | <p>PROJECT INFORMATION PROJECT NO. 12027A.DWG COPYRIGHT 2013 PDI Architects www.pdi-architects.com</p> |
|--|--|--|--|---------------------------------|---|--|--|---|