

International Building Code and Life Safety Code Summary

EDITIONS REFERENCED

International Building Code 2009
NFPA 101 - Life Safety Code 2009

GENERAL DESCRIPTION OF WORK

Total floor area: 64,135 sf First Floor
Approximate area of renovation: *No Floor Area Impact, see description of work
Construction types: IBC - Type IIA, non-combustible, protected
NFPA - Type II (II)

Scope of work for this level is to upgrade doors at stairs and egress routes to meet NFPA 80 requirements.

OCCUPANCY

The predominant occupancy of the building is Business. Existing Assembly spaces intended exclusively for use by employees as part of their training and meeting functions. Existing occupancies are not changed by the project.

EGRESS COMPONENTS

- Stairs in the existing building are enclosed with existing concrete construction.
- Maximum Dead-End Corridor = 50'
- Maximum Travel Distance = 200'
- Egress width per person = 0.3' @ stairs, 0.2' @ horizontal exits

SPRINKLER

The existing building is partially sprinklered. This project adds an automated sprinkler system to remainder of Basement Level and a fire pump to extend the system in future to remaining levels.
- See Electrical drawings for extent of work at Fire Alarm System.

GRAPHIC LEGEND:

- Occupant Load
- Cumulative Occupant Load
- 1-hour
- 2-hour
- Smoke Partition
- No Occupant Load
- Open Office Area

Total Exit Capacity this Floor = 1,724 P

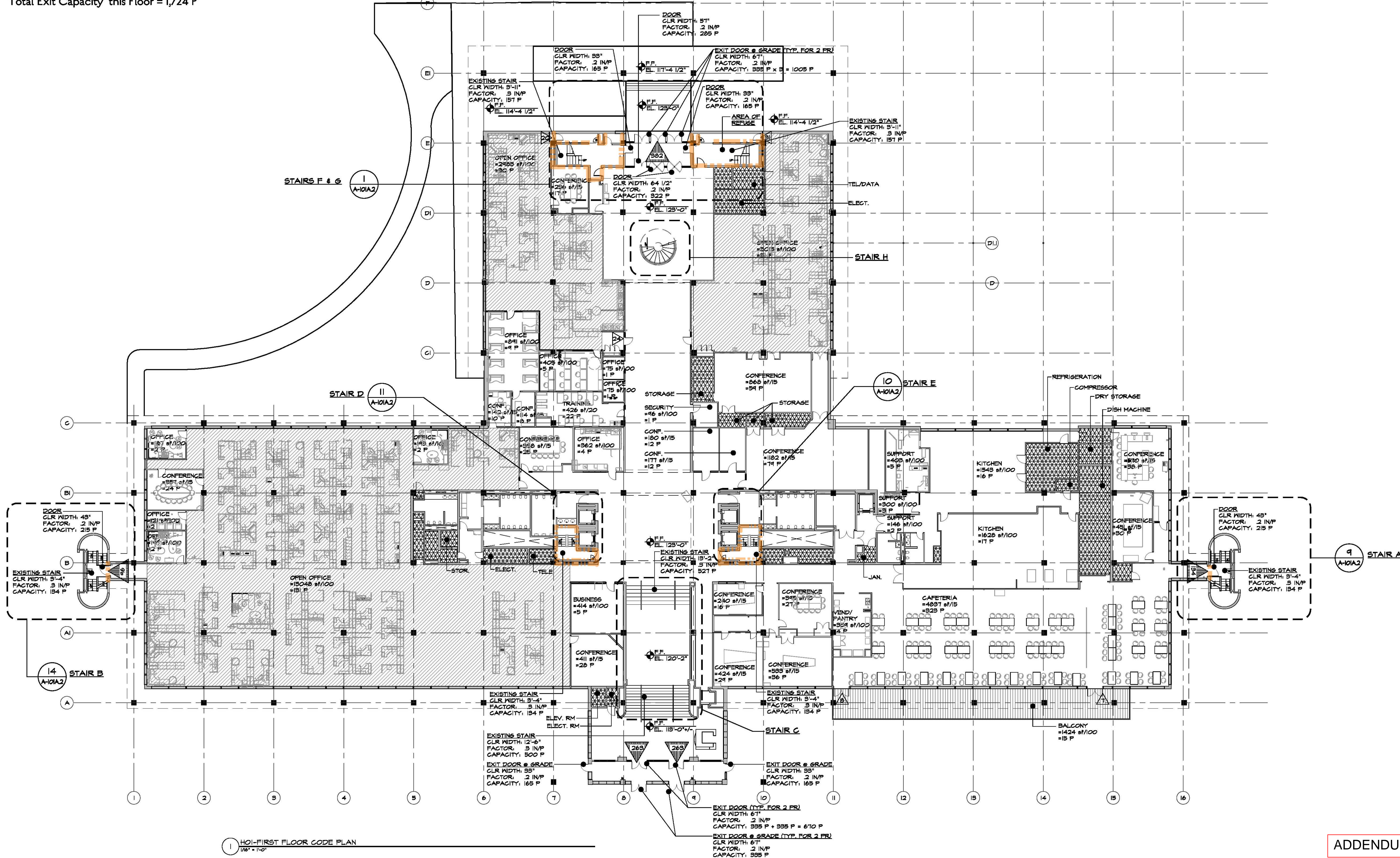

1 HOI-FIRST FLOOR CODE PLAN
1/8" = 1'-0"

ADDENDUM #1