

DISPLAY THIS CARD ON PRINCIPAL FRONTAGE OF WORK CITY OF PORTLAND

BUILDING INSPECTION PERMIT

Permit Number: 030244

Please Read Application And Notes, If Any, Attached

Unum Corp/Door Control

This is to certify that

Replace vestibule doors with revolving double swing doors

has permission to

2211 Congress St

215 B002001

AT

provided that the person or persons who apply for or receive this permit shall comply with all of the provisions of the Statutes of the State and of the Ordinances of the City of Portland regulating the construction, maintenance and use of buildings and structures, and of the application on file in this department.

Apply to Public Works for street line and grade if nature of work requires such information.

Notification of inspection must be given and when permission is procured before this building or part thereof is occupied or otherwise exposed-in-4
YOUR NOTICE IS REQUIRED.

A certificate of occupancy must be procured by owner before this building or part thereof is occupied.

OTHER REQUIRED APPROVALS

Fire Dept. *[Signature]*

Health Dept. _____

Appeal Board _____

Other _____
Department Name

[Signature] 4/14/00
Director, Building & Inspection Services

PENALTY FOR REMOVING THIS CARD

City of Portland, Maine - Building or Use Permit Application

389 Congress Street, 04101 Tel: (207) 874-8703, Fax: (207) 874-8716

Permit No: 03-0244	Issue Date:	CBL: 215 B002001
-----------------------	-------------	---------------------

Location of Construction: 2211 Congress St	Owner Name: Unum Corp	Owner Address: 2211 Congress St	Phone: 207-575-5886
Business Name:	Contractor Name: Door Control	Contractor Address: Portland	Phone:
Lessee/Buyer's Name	Phone:	Permit Type: Alterations - Commercial	Zone: OP

Past Use: Office Space/Vestibule Doors	Proposed Use: Office Space/Replace vestibule doors with revolving door & single swing door	Permit Fee: \$723.00	Cost of Work: \$723.00	CEO District: 3
Proposed Project Description: Replace vestibule doors with revolving door & single swing door		FIRE DEPT: <input checked="" type="checkbox"/> Approved <input type="checkbox"/> Denied	INSPECTION: Use Group: 15 Type: 2 4/14/03	
		Signature: <i>[Signature]</i>	Signature: <i>[Signature]</i>	
PEDESTRIAN ACTIVITIES DISTRICT (P.A.D.) Action: <input type="checkbox"/> Approved <input type="checkbox"/> Approved w/Conditions <input type="checkbox"/> Denied Signature: _____ Date: _____				

Permit Taken By: tad	Date Applied For: 03/26/2003	Zoning Approval		
-------------------------	---------------------------------	------------------------	--	--

<p>1. This permit application does not preclude the Applicant(s) from meeting applicable State and Federal Rules.</p> <p>2. Building permits do not include plumbing, septic or electrical work.</p> <p>3. Building permits are void if work is not started within six (6) months of the date of issuance. False information may invalidate a building permit and stop all work..</p>	<p>Special Zone or Reviews</p> <p><input type="checkbox"/> Shoreland</p> <p><input type="checkbox"/> Wetland</p> <p><input type="checkbox"/> Flood Zone</p> <p><input type="checkbox"/> Subdivision</p> <p><input type="checkbox"/> Site Plan</p> <p>Maj <input type="checkbox"/> Mjnor <input type="checkbox"/> MM <input type="checkbox"/></p> <p>Date: <i>03/25/03</i></p>	<p>Zoning Appeal</p> <p><input type="checkbox"/> Variance</p> <p><input type="checkbox"/> Miscellaneous</p> <p><input type="checkbox"/> Conditional Use</p> <p><input type="checkbox"/> Interpretation</p> <p><input type="checkbox"/> Approved</p> <p><input type="checkbox"/> Denied</p> <p>Date: _____</p>	<p>Historic Preservation</p> <p><input checked="" type="checkbox"/> Not in District or Landmark</p> <p><input type="checkbox"/> Does Not Require Review</p> <p><input type="checkbox"/> Requires Review</p> <p><input type="checkbox"/> Approved</p> <p><input type="checkbox"/> Approved w/Conditions</p> <p><input type="checkbox"/> Denied</p> <p>Date: <i>[Signature]</i></p>
---	--	--	--

CERTIFICATION

I hereby certify that I am the owner of record of the named property, or that the proposed work is authorized by the owner of record and that I have been authorized by the owner to make this application as his authorized agent and I agree to conform to all applicable laws of this jurisdiction. In addition, if a permit for work described in the application is issued, I certify that the code official's authorized representative shall have the authority to enter all areas covered by such permit at any reasonable hour to enforce the provision of the code(s) applicable to such permit.

SIGNATURE OF APPLICANT ADDRESS DATE PHONE

RESPONSIBLE PERSON IN CHARGE OF WORK, TITLE DATE PHONE

City of Portland, Maine - Building or Use Permit

389 Congress Street, 04101 Tel: (207) 874-8703, Fax: (207) 874-8716

Permit No: 03-0244	Date Applied For: 03/26/2003	CBL: 215 B002001
------------------------------	--	----------------------------

Location of Construction: 2211 Congress St	Owner Name: Unum Corp	Owner Address: 2211 Congress St	Phone: 207-575-5886
Business Name:	Contractor Name: Door Control	Contractor Address: Portland	Phone:
Lessee/Buyer's Name	Phone:	Permit Type: Alterations - Commercial	

Proposed Use: Office Space/Replace vestibule doors with revolving door & single swing door	Proposed Project Description: Replace vestibule doors with revolving door & single swing door
--	---

Dept: Zoning	Status: Approved	Reviewer: Marge Schmuckal	Approval Date: 03/28/2003	Ok to Issue: <input checked="" type="checkbox"/>
Note:				
Dept: Building	Status: Pending	Reviewer: Mike Nugent	Approval Date:	Ok to Issue: <input type="checkbox"/>
Note:				
Dept: Fire	Status: Approved with Conditions	Reviewer: Lt. McDougall	Approval Date: 03/31/2003	Ok to Issue: <input checked="" type="checkbox"/>
Note:				
1) the fire alarm system shall be maintained to NFPA 72 standards				
2) the sprinkler system shall be maintained to NFPA 13 standards				

Comments:
04/02/2003-mjn: Faxed Section 1018. Revolving Doors to The Architect. Must address standards.

All Purpose Building Permit Application

If you or the property owner owes real estate or personal property taxes or user charges on any property within the City, payment arrangements must be made before permits of any kind are accepted.

Location/Address of Construction: <u>2211 CONGRESS ST.</u>		
Total Square Footage of Proposed Structure		Square Footage of Lot
Tax Assessor's Chart, Block & Lot Chart# Block# Lot# <u>215 B00 2001</u>	Owner: <u>UNUM PROVIDENT BLDG</u> <u>2211 CONGRESS ST. #03</u> <u>PORTLAND, MAINE</u>	Telephone: <u>JOHN FOX</u> <u>207-575-5886</u>
Lessee/Buyer's Name (If Applicable) <u>N/A</u>	Applicant name, address & telephone: <u>DOOR CONTROL INC.</u> <u>800-258-9742</u> <u>7 LEHOUX DRIVE</u> <u>PO BOX 16385</u> <u>HOOKSETT, N.H. 03106</u>	Cost Of Work: <u>\$100,000</u> Fee: <u>\$723⁰⁰</u>
Current use: <u>OFFICE BLDG.</u>		
If the location is currently vacant, what was prior use: <u>N/A</u>		
Approximately how long has it been vacant: <u>N/A</u>		
Proposed use: <u>SAME</u>		
Project description: <u>REMOVE SWING DOORS & INSTALL SECURITY REVOLVING DOOR & NEW SWING</u> <u>2 LOCATIONS</u>		
Contractor's name, address & telephone: Who should we contact when the permit is ready: <u>MARK BICKMORE</u> Mailing address: <u>DOOR CONTROL, INC. 7 LEHOUX DRIVE</u> <u>PO Box 16385 HOOKSETT, N.H. 03106</u>		
We will contact you by phone when the permit is ready. You must come in and pick up the permit and review the requirements before starting any work, with a Plan Reviewer. A stop work order will be issued and a \$100.00 fee if any work starts before the permit is picked up. PHONE: <u>800-258-9742</u>		

IF THE REQUIRED INFORMATION IS NOT INCLUDED IN THE SUBMISSIONS THE PERMIT WILL BE AUTOMATICALLY DENIED AT THE DISCRETION OF THE BUILDING/PLANNING DEPARTMENT, WE MAY REQUIRE ADDITIONAL INFORMATION IN ORDER TO APPROVE THIS PERMIT.

I hereby certify that I am the Owner of record of the named property, or that the owner of record authorizes the proposed work and that I have been authorized by the owner to make this application as his/her authorized agent. I agree to conform to all applicable laws of this jurisdiction. In addition, if a permit for work described in this application is issued, I certify that the Code Official's authorized representative shall have the authority to enter all areas covered by this permit at any reasonable hour to enforce the provisions of the codes applicable to this permit.

Signature of applicant: <u>Mark Bickmore</u>	Date: <u>3/26/03</u>
--	----------------------

This is NOT a permit, you may not commence ANY work until the permit is issued.
If you are in a Historic District you may be subject to additional permitting and fees with the Planning Department on the 4th floor of City Hall



**CITY OF PORTLAND
ACCESSIBILITY CERTIFICATE**

Designer: SMRT

Address of Project Unum Provident, 2211 Congress St. - #03

Nature of Project Replace interior pair of

vestibule doors at 2 locations with revolving door & single
swing door

Date 3/25/03

The technical submissions covering the proposed construction work as described above have been designed in compliance with applicable referenced standards found in the Maine Human Rights Law and Federal Americans with Disability Act.

(SEAL)

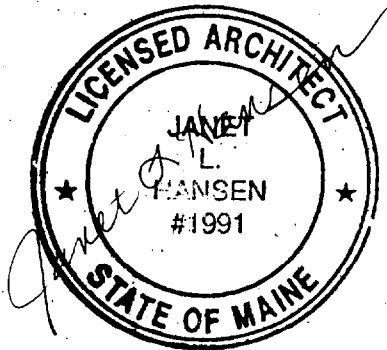

Signature Janet L. Hansen

Title Principal / Architect

Firm SMRT

Address 144 Fore Street

Portland, Maine 04101

Telephone 207-772-3846

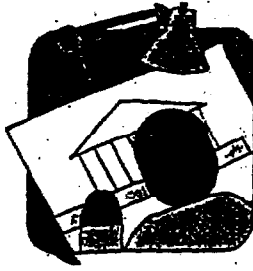

CITY OF PORTLAND MAINE

389 Congress St., Rm 315

Portland, ME 04101

Tel. - 207-874-8704

Fax - 207-874-8716

TO: Inspector of Buildings City of Portland, Maine
Planning & Urban Development
Division of Housing & Community Services

FROM DESIGNER: Janet Hansen

SMRT

DATE: 3/25/03

Job Name: Unum Provident Security Doors

Address of Construction: 2211 Congress St., H03

THE BOCA NATIONAL BUILDING CODE/1999 Fourteenth EDITION

Construction project was designed according to the building code criteria listed below:

Building Code and Year BOCA 1999 Use Group Classification(s) B

Type of Construction _____ Bldg. Height _____ Bldg. Sq. Footage _____

Seismic Zone _____ Group Class _____

Roof Snow Load Per Sq. Ft. _____ Dead Load Per Sq. Ft. _____

Basic Wind Speed (mph) _____ Effective Velocity Pressure Per Sq. Ft. _____

Floor Live Load Per Sq. Ft. _____

Structure has full sprinkler system? Yes No _____ Alarm System? Yes No _____
Sprinkler & Alarm systems must be installed according to BOCA and NFPA Standards with approval from the Portland Fire Department.

Is structure being considered unlimited area building: Yes _____ No _____

If mixed use, what subsection of 313 is being considered _____

List Occupant loading for each room or space, designed into this Project.

(Designers Stamp & Signature)

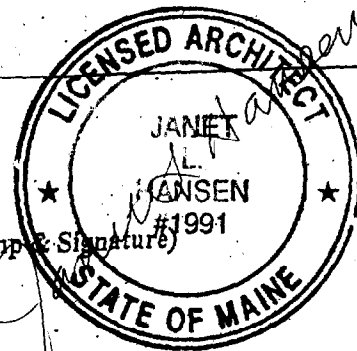

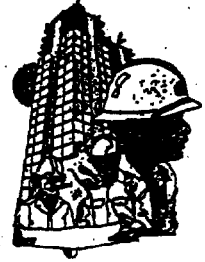
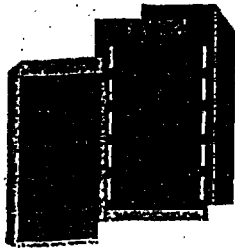

**CITY OF PORTLAND
BUILDING CODE CERTIFICATE**
389 Congress St., Rm 315
Portland, ME 04101

TO: Inspector of Buildings City of Portland, Maine
Department of Planning & Urban Development
Division of Housing & Community Service

FROM: Janet Hansen / SMRT

RE: Certificate of Design

DATE: 3/25/03

These plans and/or specifications covering construction work on:

Installing new doors at 2 vestibule locations
at Unum Provident H03 Bldg, 2211 Congress Street.

Have been designed and drawn up by the undersigned, a Maine registered architect/engineer according to the BOCA National Building Code/1999 Fourteenth Edition, and local amendments.

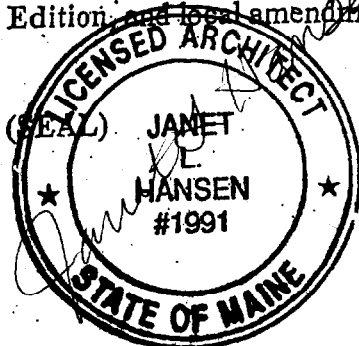

Signature Janet Hansen

Title Principal / Architect

Firm SMRT

Address 144 Fore Street Portland, Maine

As per Maine State Law:

\$50,000.00 or more in new construction; repair, expansion, addition, or modification for Building or Structures, shall be prepared by a registered design Professional.

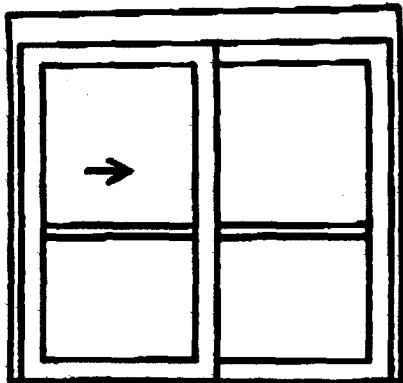

DOOR CONTROL, INC.

7 LEHOUX DRIVE PO BOX 16385

HOOKSETT, N.H. 03106-0385

603-627-4114

FAX 603-627-4451

ROCHESTER OFFICE 603-822-1001

FAX TRANSMITTAL

DATE	04/02/03
FROM	Mark Bicknore
TO	City of Portland Planning & Development
ATTN:	Michael Nugent
RE:	Building permit application Unum Provident

Michael, I have a permit application in to your office for a project we are proposing at Unum Provident building H03, concerning security revolving doors, Reference your CBL #215B002001.

Janet Hanson with SMRT has advised that you are looking for information regarding emergency egress through the revolving doors. Attached please find a copy of their specifications, I have indicated reference to emergency break-away in these specifications as well as attached a hand sketch of the door position when these doors are collapsed or "book fold" position. As indicated in the attached specifications the force to break the doors into the book fold position is adjustable but not to exceed 180 LBS.

Please contact me should you have any questions I can be reached at 603-822-1001

4/11/03 RE FAX 7
Ⓞ

WE ARE FAXING YOU [06] PAGE(S) INCLUDING THIS COVER SHEET. PLEASE
CALL US @ 603-627-4114 SHOULD THERE BE AN ERROR IN TRANSMISSION



BOON EDAM

The first name in entrance technology

ARCHITECTURAL SPECIFICATION

Tourlock 180 + 90 Security Revolving Door

4050 South 500 West, Salt Lake City, UT 84123 • (801) 261-8980 • FAX (801) 261-1612

DIVISION 8 – DOORS AND WINDOWS
SECTION 08470 – REVOLVING DOORS

PART I – GENERAL

1.01 SECTION INCLUDES

- A. This section covers the furnishing and installation of a complete Automatic Security Revolving Door System. Provide complete system that has been fabricated, assembled, and tested for proper operation at the factory. It includes curved side walls, canopy, ceiling, access hatch, ceiling lights, door wings, hardware, glass, motor drive system, emergency collapsing mechanism and sensor system as required for installation.

1.02 RELATED SECTIONS

- A. Section 07915 - Sealants, Caulking and Seals
- B. Section 08400 - Entrances and Storefronts
- C. Section 08710 - Door Hardware
- D. Section 08810 - Glass and Glazing
- E. Section 09600 - Flooring
- F. Section 16123 - Electrical Supply and Termination

1.03 QUALITY ASSURANCE

- A. Manufacturer shall be a company specializing in the supply of automatic security revolving doors with a minimum of 10 years experience.
- B. Manufacturer shall supply a factory trained supervisor during installation of the door.

1.04 SUBMITTALS

- A. Submit project specific shop drawings, finish samples and Operating & Maintenance Manuals in accordance with Section ().
- B. Indicate pertinent dimensions, general construction, component connections and locations, anchorage methods and locations, hardware, and installation details.

1.05 DELIVERY, STORAGE AND HANDLING

- A. Deliver materials to job site in manufacturer's packaging undamaged, complete with installation instructions.
- B. Store off ground, under cover, protected from weather and construction activities.

1.06 PROJECT/SITE CONDITIONS

- A. Revolving doors install on finished floor only. Floor must not be more than 3/16" out of level at any point within the footprint of the revolving door.

1.07 WARRANTY

Boon Edam warranties its products against defects in material and workmanship for a period of one (1) year from the date of substantial completion. This warranty excludes glass breakage, normal wear on finishes or damage that occurs due to abuse, misuse or acts of God.



PART II - PRODUCTS

2.01 MANUFACTURER

Factory assembled and tested Tourlock 180 + 90 Automatic Security Revolving Door as manufactured by Boon Edam, Inc., 4050 South 500 West, Salt Lake City, Utah 84123.
(801) 261-8980 Fax: (801) 261-1612 Homepage: www.boonedam.com

2.02 DOOR CONSTRUCTION

- A. Curved Side Walls and Canopy: Shall have a standard inside diameter of 6'-6" or 7'-0" and be manufactured from six (6) extruded aluminum posts, six (6) 12" high one-piece extruded aluminum canopies and four (4) extruded aluminum bottom rails all with a minimum thickness of 0.125".
- B. Door Wings: Four doors as designed and manufactured of 1 3/4" thick aluminum extrusions with minimum thickness of 0.125" and reinforced with internal aluminum door corners for strength. Door wings must utilize removable horsehair weather stripping on three sides. Doors must be capable of folding forward or backward allowing for emergency egress.
- C. Ceiling: shall be fabricated of formed aluminum sheet in a pie-shaped configuration. Each section must be secured in position and removed only by authorized personnel.

2.03 EQUIPMENT

- A. Drive System: Overhead drive system with one 1/4 HP AC motor attached to the internal structural framing. The motor shall be powered by a 208-230 VAC, 3-phase service. The motor shall utilize an internal angle encoder for constant monitoring of door position and a Frequency Controller to provide for the following characteristics:
 - 1. Adjustment of rotation speed through a digital setting
 - 2. Constant regulation of rotation speed
 - 3. Adjustment of startup/run torque through a digital setting to minimize force required to stop door
 - 4. Adjustment of stopping distance through a digital setting
 - 5. Password-protected Security over Frequency Control settings
- B. Braking Assembly: Positive braking and stopping shall be performed by electromagnetic brake assembly incorporated within the drive unit. The brake unit to provide the following characteristics:
 - 1. Remain locked at all times until unlocked by authorized signal from the access control device or emergency system
 - 2. Lock immediately after signal from IRS sensor system or other incorporated system.
- C. Controls: Microprocessor-based electronics utilizing a 2000-step Programmable Logic Controller (PLC) with the following characteristics:
 - 1. RAM & ROM memory
 - 2. Lithium battery backup
 - 3. Self-diagnostics for quick detection of problem source
 - 4. Visual display of problem source
- D. Emergency Collapsing Mechanism: Precision-engineered door hangers and disks that allow the door wings to be collapsed under pressure and stored in a bookfold position. Hangers and disks are finished in black and provide tension to hold the door wings in position when the electric locking is released. The wings shall be capable of being collapsed outward under pressure on the outer stile not to exceed 180 pounds.
- E. Pivot: Floor mounted pivot under the center shaft to provide smooth rotation.
- F. Center Shaft: Extruded aluminum shaft with multi-point connections to the drive system and pivot.





2.04 SECURITY SYSTEM

- A. IRS Infrared Sensor System: Ceiling mounted infrared sensors capable of performing the following functions:
 1. Detecting the presence of a person after card read and initiating door rotation
 2. Detecting the presence of a person within the door and preventing unauthorized entry in the form of tailgating by immediately stopping the door and sounding the alarm
 3. Detecting the presence of a person in a compartment to ensure that the person actually went through the door
- B. Direction Sensors: Sensors that will lock the 4-wing doorset immediately if the doorset is pushed in the opposite direction of travel, and then sound the alarm.
- C. Weight Sensor System (Optional): Electronic Load Cells installed in a steel frame under the floor mat of the door and capable of performing the following functions:
 1. Measure the weight on the floor mat in the door compartment
 2. Determine if the measured weight exceeds the weight of the pre-set parameters. If the weight is outside of the preset parameters, the door will immediately stop and the alarm will activate. (This feature will reduce the chance for "piggybacking" or the coupling of more than one person in a compartment. This feature with software for Precision Weight Matching will eliminate the chance for piggybacking.)
- D. Activation: Activation of the Tourlock by external card reader or other access control device that can provide a dry contact to the control box of the door. Card reader or other activation device not by Boon Edam.

2.05 SAFETY SYSTEM

- A. Safety Switches: A system of pressure sensitive switches in front of rotating door wings (optional) and in front of fixed side walls that will stop the door's rotation immediately upon compression. All switches must be tied into the programmable logic controller, give a visual signal when malfunctioning and cause the door to stop rotating until corrected. System components shall be incorporated as follows:
 1. S.R.B. (Safety Rail Bentwall Switch): A multi-directional, closed-contact pressure sensitive switch contained within a black rubber profile mounted to the edge of each inbound side wall that will immediately stop the door's rotation if compressed.
 2. S.R.D. (Safety Rail Doorwing) (Optional): A multi-directional, closed-contact pressure sensitive switch contained within a black rubber profile mounted to the bottom rail of each door wing that will immediately stop the door's rotation if compressed.
- B. Torque Limiting: A setting within the programming of the Frequency Controller in the drive system that allows the rotation force to be minimized, allowing the doorset to be stopped manually by applying pressure against its rotation.
- C. Emergency Egress Doors: The four doors shall be capable of folding in the direction of egress and allow for unobstructed egress in cases of emergency.

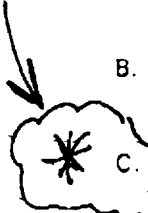

2.06 HARDWARE/MATERIALS

- A. Tempered Glass: All flat glass in door wings shall be 1/4" clear tempered safety glass, all curved glass shall be 1/4" clear bent tempered safety glass.
- B. Laminated Glass (Optional): 7/16" clear curved laminated safety glass is available as an option.
- C. Aluminum Extrusions: Heavy duty profile aluminum extrusions with minimum thickness of 0.125.
- E. Weather Stripping: Genuine horsehair weather stripping on all required edges of door wings.
- F. Bumpers: rigid, rubber-tipped bumper on each door wing to prevent push bar from contacting the glass.



BOON EDAM

The first name in entrance technology

ARCHITECTURAL SPECIFICATION

Tourlock 180 + 90 Security Revolving Door

4050 South 500 West, Salt Lake City, UT 84123 • (801) 261-8980 • FAX (801) 261-1612

- G. Rubber Seal: Rubber profiles to seal glazing, ceiling ring, and/or any other joints or gaps requiring weather-resistant seal.
- H. Pivot: Floor mounted pivot under the center shaft to provide smooth rotation.
- I. Center Shaft: Extruded aluminum shaft with connections to the drive system and pivot.

2.07 FINISH

- A. Enclosure Walls: Anodized aluminum, kynar painted or powder-coated aluminum, stainless steel or architectural bronze (muntz metal) clad.
- B. Rotating Doors and Shaft: Anodized aluminum, kynar painted or powder-coated aluminum, stainless steel or architectural bronze (muntz metal) clad.
- C. Ceiling: Anodized aluminum, kynar painted or powder-coated aluminum, stainless steel or architectural bronze (muntz metal) clad.

PART III - EXECUTION

3.01 INSTALLATION

- A. Inspection: Installer must examine the location and advise the Contractor of any site conditions unacceptable for proper installation of product. These conditions include but are not limited to the following:
 - 1. Floor out of level more than 3/16" at any point within the footprint of the door
 - 2. Finished floor not yet installedInstallation shall not begin until these unacceptable conditions are rectified.
- B. Erection: Install revolving doors in accordance with manufacturer's printed instructions. Set units level, plumb, and with uniform hairline joints. Anchor securely into place. Use only factory trained installers.
- C. Adjustment: Installer shall adjust door, hardware and sensors for smooth operation and proper performance.
- D. Instruction: A factory trained installer shall demonstrate to the owner's maintenance crew the proper operation of the door and the necessary service requirements such as lubrication, cleaning, and inspection of components.
- E. Cleaning: Clean metal and glass surfaces carefully after installation to remove excess caulk, dirt and labels.

Boon Edam, Inc. reserves the right to change this specification at any time without notice.

Tourlock 180 + 90

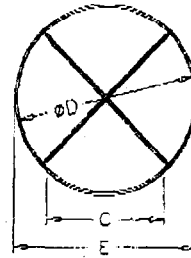
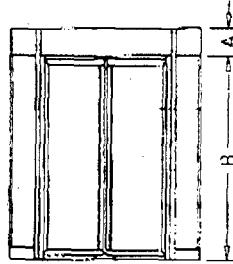

	Standard	Standard
	6'8"	7'0"
A	11 1/4"	11 1/4"
B	7'0"	7'0"
C	5'3 1/4"	5'4 1/2"
D	6'6"	7'0"
E	6'8"	7'3"

Basic Operation

The Tourlock 180 + 90 remains locked in the x-position waiting for the person to approach. Upon receiving an authorized signal from an external card reader or other access control device, the Tourlock is put into "standby" mode. As the person enters the opening of the Tourlock, overhead sensors detect this presence and rotate the doorset 180° to allow the person through. The Tourlock then stops and locks.

If a second person, with authorization, enters the Tourlock in the next compartment while the doorset is revolving, the Tourlock will make an additional 90° turn and allow the second person through as well.

Simultaneous inbound and outbound traffic can be accommodated, providing a maximum recommended traffic capacity of approximately 25-30 persons per minute in both directions.

If a person enters the Tourlock without authorization, from either direction, the doorset will immediately stop and an alarm will sound. Upon the unauthorized person stepping out, the Tourlock will finish its cycle.

The optional weight sensor system helps prevent an authorized person from escorting a second person through on a single authorization.

Construction

The Tourlock 180 + 90 is fabricated from anodized aluminum extrusions and 1/4" tempered safety glass. Optional finishes include: painted or powdercoated aluminum, stainless steel and brass cladding. Laminated safety glass or bullet resistant is also available as an option.

The drive system consists of an AC motor with Frequency Controller. A 208V, 3 phase service is required. The frequency control allows for independent, digital settings for rotation speeds and motor torque. This allows for the proper settings for each environment.

A Programmable Logic Controller (PLC) serves as the main processor for the operation of the Tourlock and can be customized to meet specific installation requirements.

Overhead infrared sensors are used to start the door's rotation and to detect the presence of persons in the compartments. The PLC then determines whether authorization has been granted.

Safety

The standard Tourlock 180 + 90 is programmed to be fail-safe and allow for emergency egress when necessary. The electric locking device is released upon signal from the building alarm system and the door wings may then be folded outward.

Compressible contact switches are installed on the end of the curved side walls and will stop the door's rotation upon compression.

BOOK FOLD POSITION

Distributor

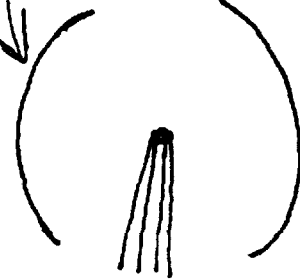

Boon Edam Inc.
4050 South 500 West Salt Lake City, UT 84123
800-658-8776 801-261-8980 Fax: 801-261-1812
www.boonedam.com

UNUMPROVIDENT CORPORATION







HO III SECURITY DOORS

2211 Congress Street
Portland, Maine

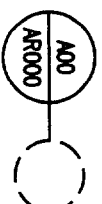
DRAWING LIST

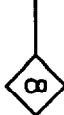
- GENERAL**
G1001 COVER SHEET
- ARCHITECTURAL**
AD101 DEMOLITION PLAN
AE101 FLOOR PLANS
AE201 ELEVATIONS
AE401 ENLARGED PLAN
AE501 DETAILS

SYMBOL LEGEND

-  DETAIL
-  CIRCLE NOTE
-  PARTITION TAG
-  DOOR TAG
-  ROOM NAME
ROOM NUMBER
-  SEALANT AND
BACKER ROD

EGRESS ANALYSIS

BOCA 1999, BUSINESS OCCUPANCY, SPRINKLERS

ATM LOBBY: (1) 3' DOOR AND (1) 6'-6" REVOLVING DOOR = 270 PEOPLE (REDUCTION OF 184 PEOPLE FROM ORIGINAL)

PARKING LOT LOBBY: (2) 3' DOORS AND (1) 6'-6" REVOLVING DOOR = 490 PEOPLE. REDUCTION OF 168 FROM ORIGINAL.

MAIN ENTRANCE: (2) PAIR OF 3' DOORS = 908 PEOPLE

CAFETERIA EXIT: (2) PAIR OF 3' DOORS = 908 PEOPLE.

EAST STAIR TOWER: (1) 3' DOOR AND (2) PAIR OF 3' DOORS = 1,128 PEOPLE.

ADDITIONAL EXITS FROM LOADING DOCK AND MECHANICAL ROOM.

TOTAL CAPACITY WITH REVOLVING DOORS = 3,704 PEOPLE
ORIGINAL CAPACITY = 4,072 PEOPLE.
ACTUAL OCCUPANCY = 1,500 +/- PEOPLE.

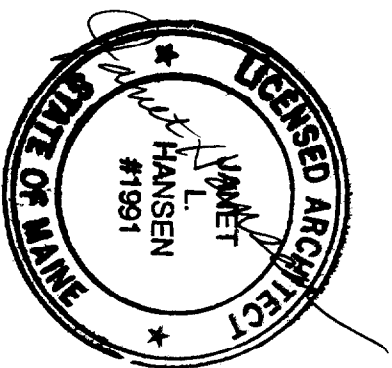

KEY PLAN
NOT TO SCALE

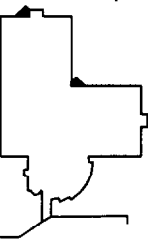

FOR CONSTRUCTION
03-14-03

ARCHITECTURE ENGINEERING PLANNING

SMRT

144 Fore Street/P.O.Box 618 PORTLAND, MAINE 04104
tel. (207) 772-3846 / fax. (207) 772-1070

PROJECT: UNUMPROVIDENT HO3 SECURITY DOORS

SUBJECT: COVER SHEET

SCALE: 1 1/2"=1'-0"

PROJECT MANAGER: JLH

JOB CAP/DRAWN: RJL

A/E OF RECORD: JLH

SMRT CAD FILE: G1001-03008

PROJECT No. 03008

DATE:

SHEET No.

G1001

© COPYRIGHT 2002 SMRT INC.

**SM
RT**

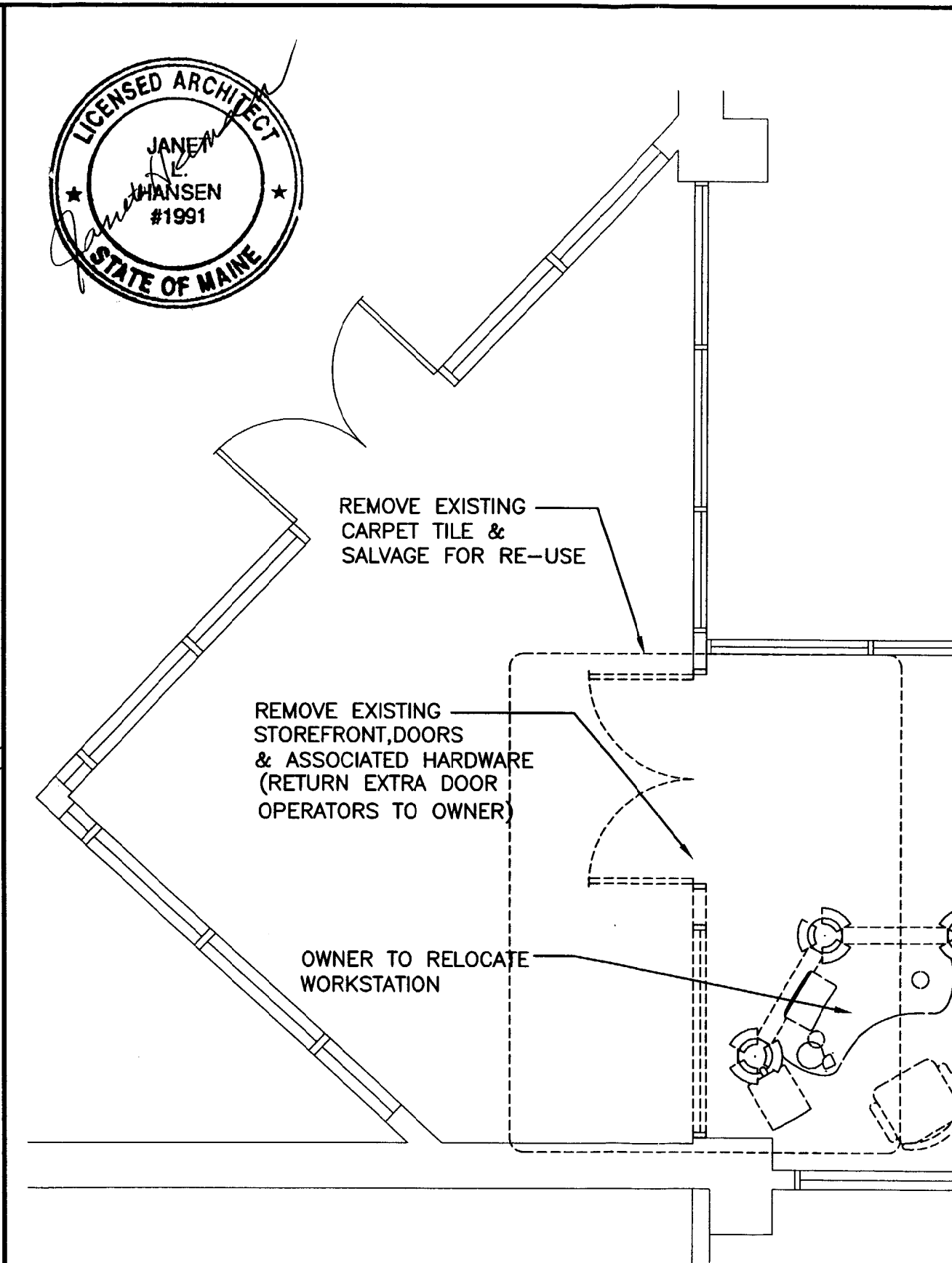
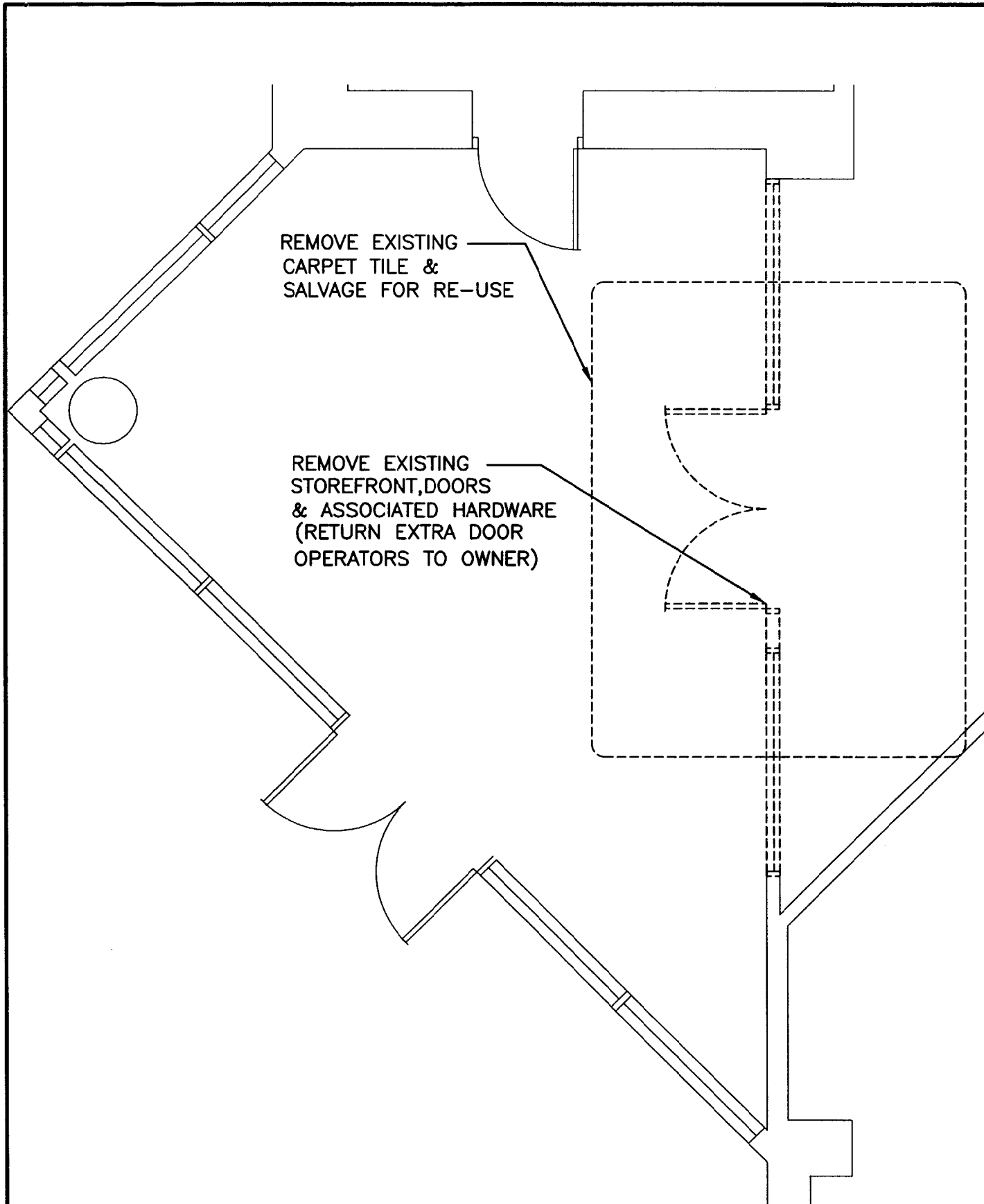
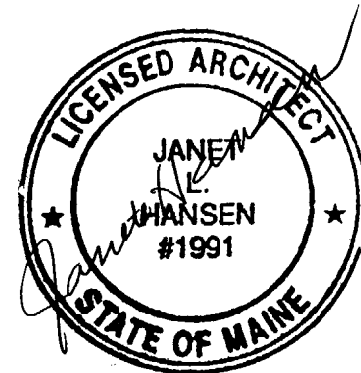

ARCHITECTURE ENGINEERING PLANNING
 SMRT
 144 Fore Street / P. O. Box 618 PORTLAND, MAINE 04104
 tel. (207) 772-3846 / fax. (207) 772-1070

PROJECT: UNIMPROVED H03 SECURITY DOORS
 SUBJECT: DEMO FLOOR PLANS

A1
 1/4"=1'-0"

DEMO FLOOR PLAN

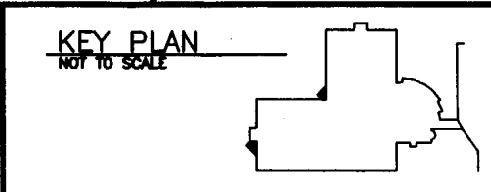

FOR CONSTRUCTION
 03-14-03

SCALE:	1/4"=1'-0"
PROJECT MANAGER:	JLH
JOB CAP/DRAWN:	RJL
A/E OF RECORD:	JLH
SMRT CAD FILE:	AD101-03008
PROJECT No.	03008
DATE:	

SHEET No. AD101

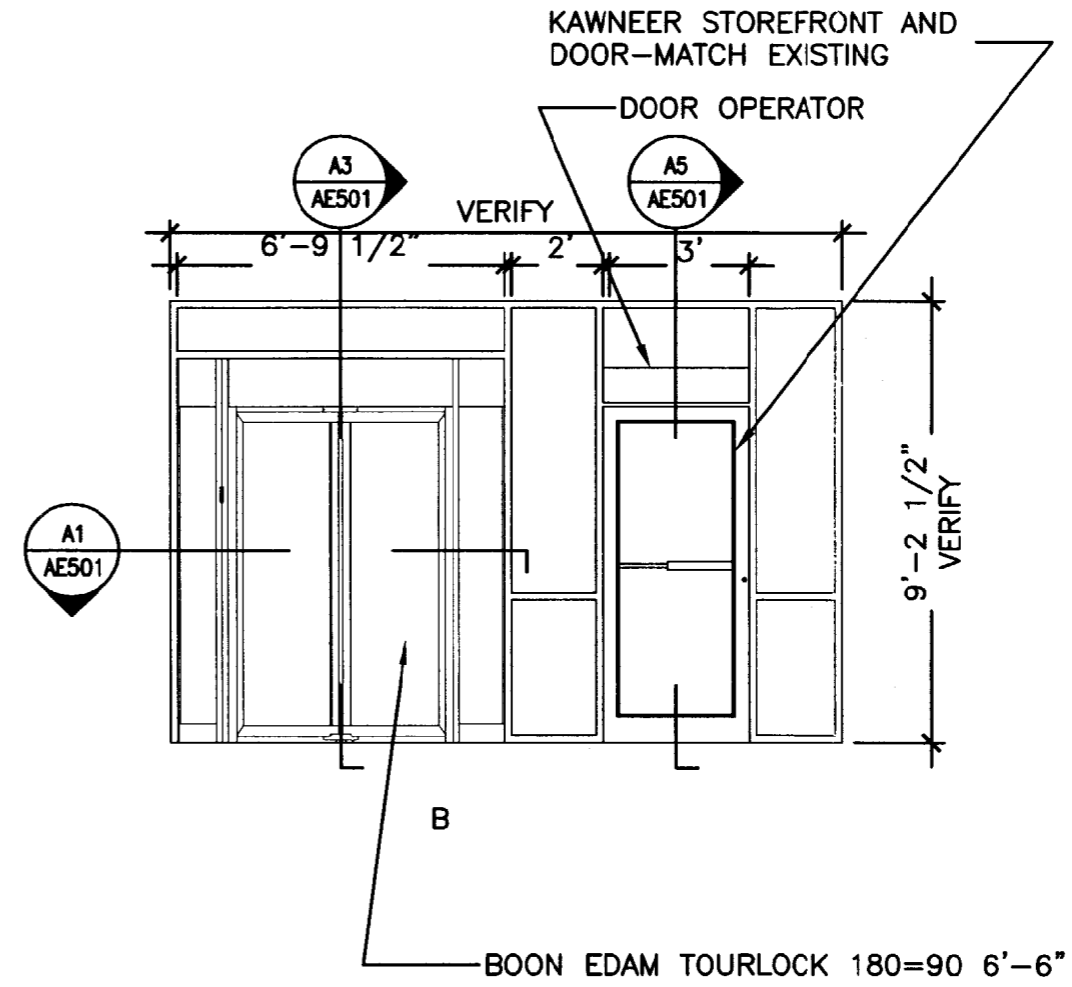
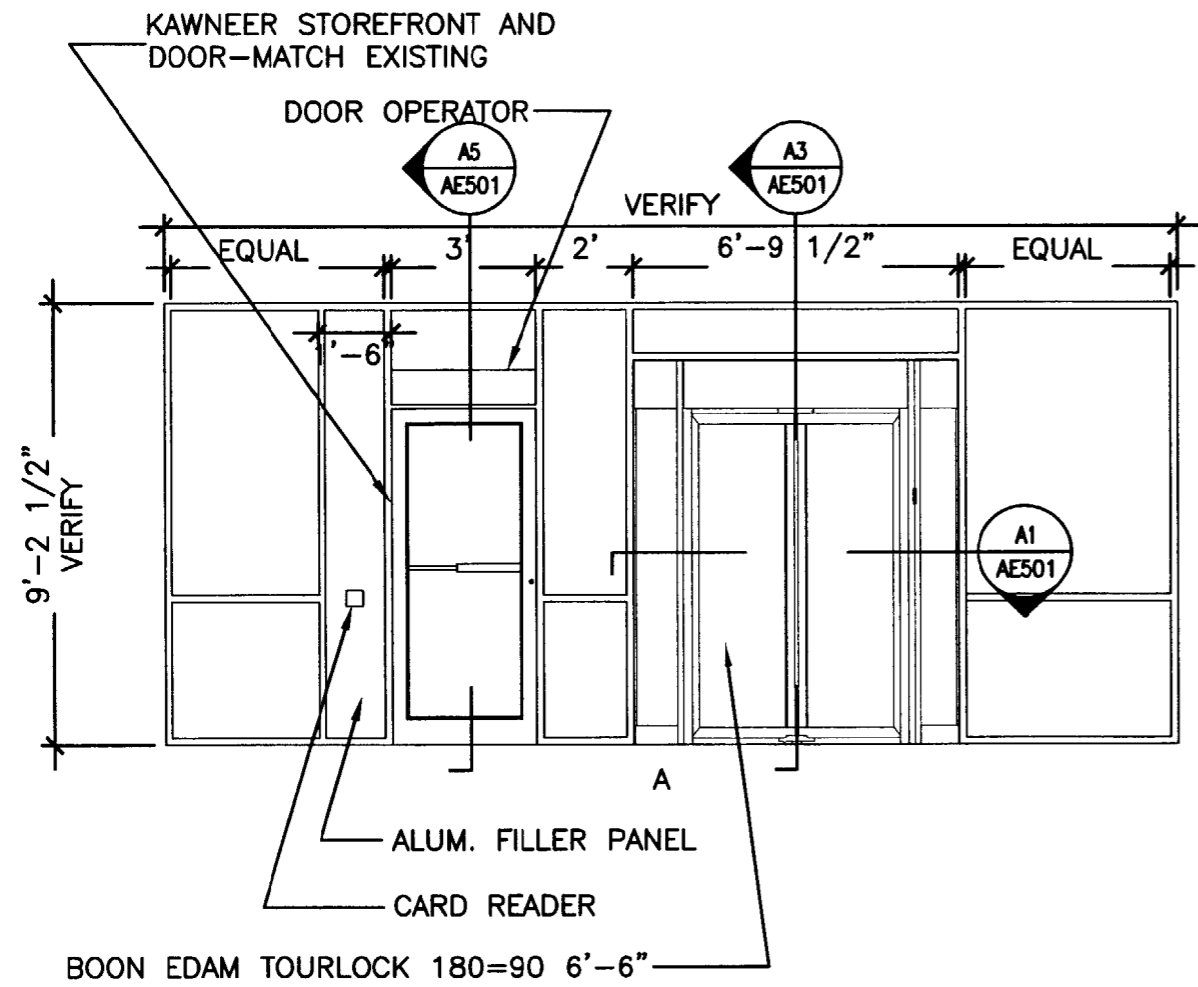
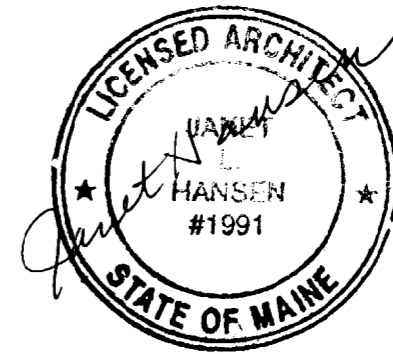

**SMT
RIT**

ARCHITECTURE ENGINEERING PLANNING
SMRT
144 Fore Street/P.O. Box 618 PORTLAND, MAINE 04104
tel. (207) 772-3846 / fax. (207) 772-1070

PROJECT: UNIMPROVIDENT HO3 SECURITY DOORS

SUBJECT: ELEVATIONS

SCALE: 1/4"=1'-0"
PROJECT MANAGER: JLH
JOB CAP/DRAWN: RJL
A/E OF RECORD: JLH
SMRT CAD FILE: AE201-03008
PROJECT No. 03008
DATE:

A1

ELEVATIONS

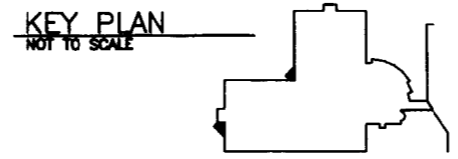

FOR CONSTRUCTION
03-14-03

1/4"=1'-0"

SHEET No.
AE201

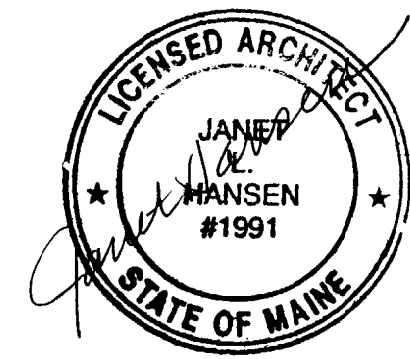
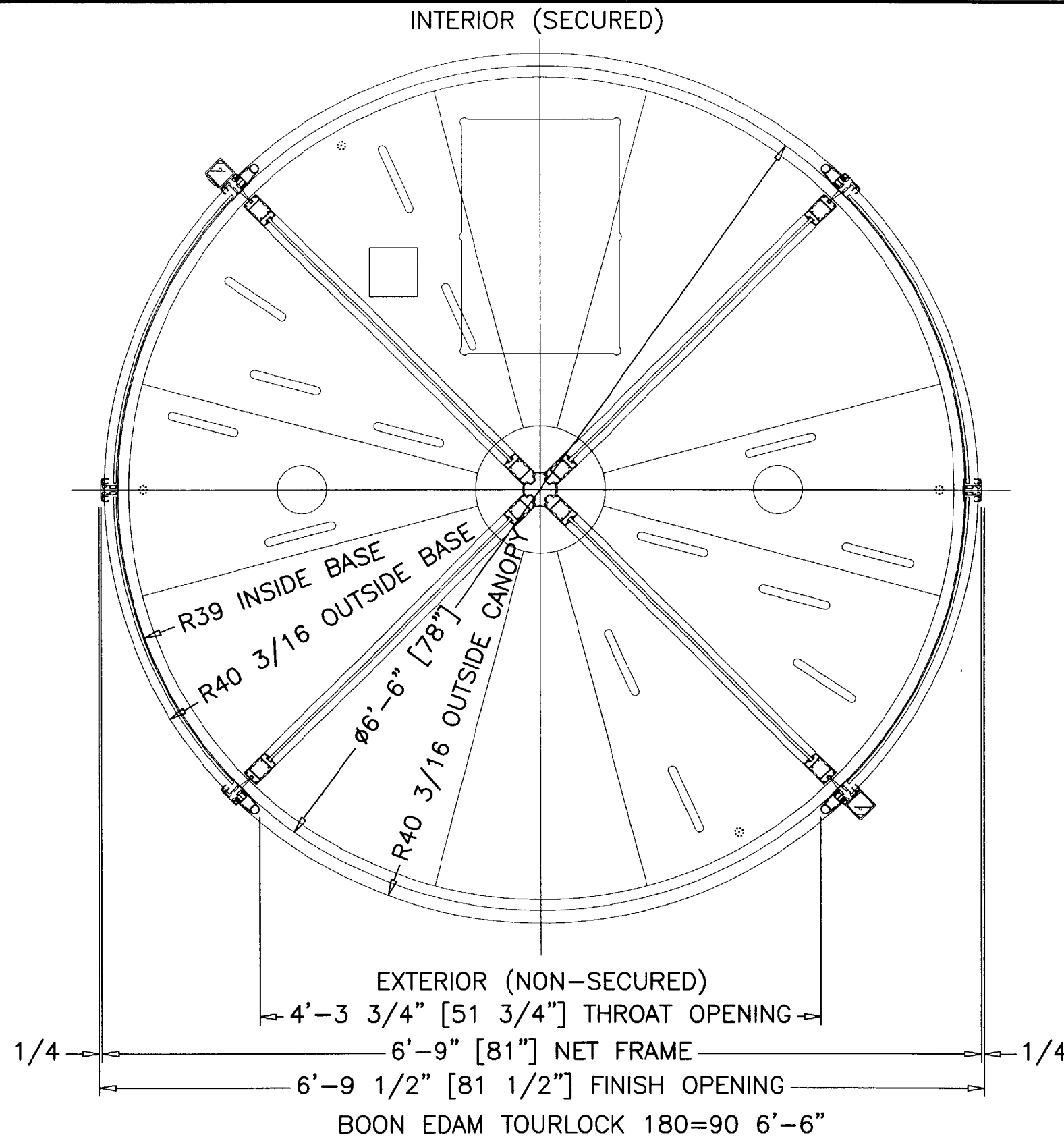

S M R T

ARCHITECTURE ENGINEERING PLANNING
SMRT
144 Fore Street/P.O.Box 618 PORTLAND, MAINE 04104
tel. (207) 772-3846 / fax. (207) 772-1070

PROJECT: UNIMPROVIDENT H03 SECURITY DOORS
SUBJECT: ENLARGED PLAN

SCALE: 1 1/2" = 1'-0"
PROJECT MANAGER: JLH
JOB CAP/DRAWN: RJL
A/E OF RECORD: JLH
SMRT CAD FILE: AE401-03008
PROJECT No. 03008
DATE:

A1

ENLARGED PLAN

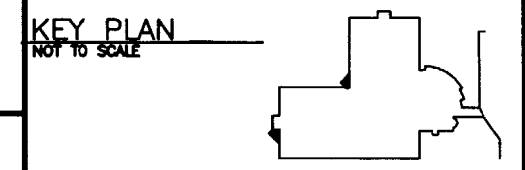

FOR CONSTRUCTION
03-14-03

1" = 1'-0"

SHEET No.
AE401

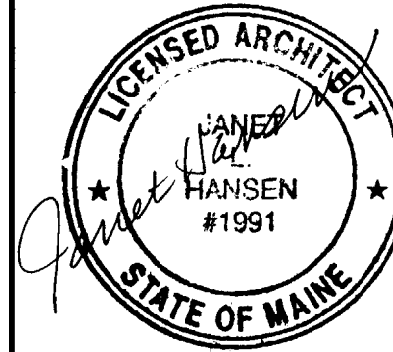

SMT
RIT

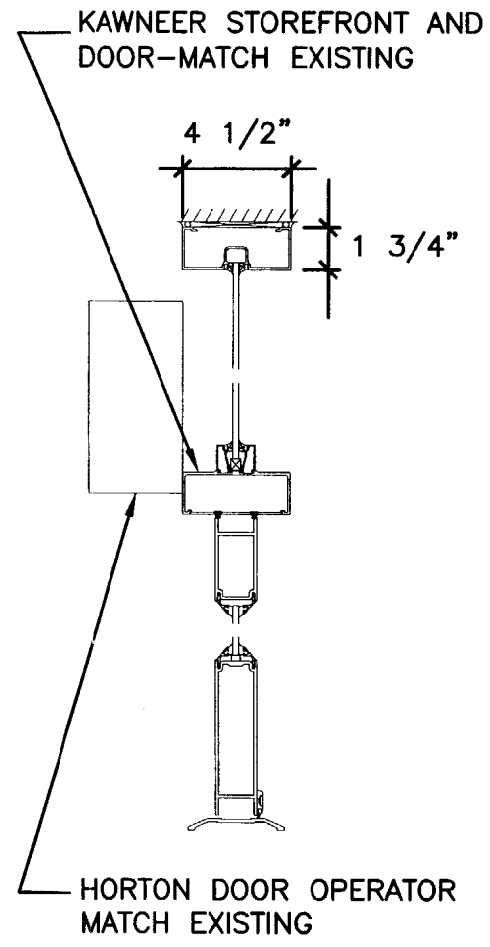
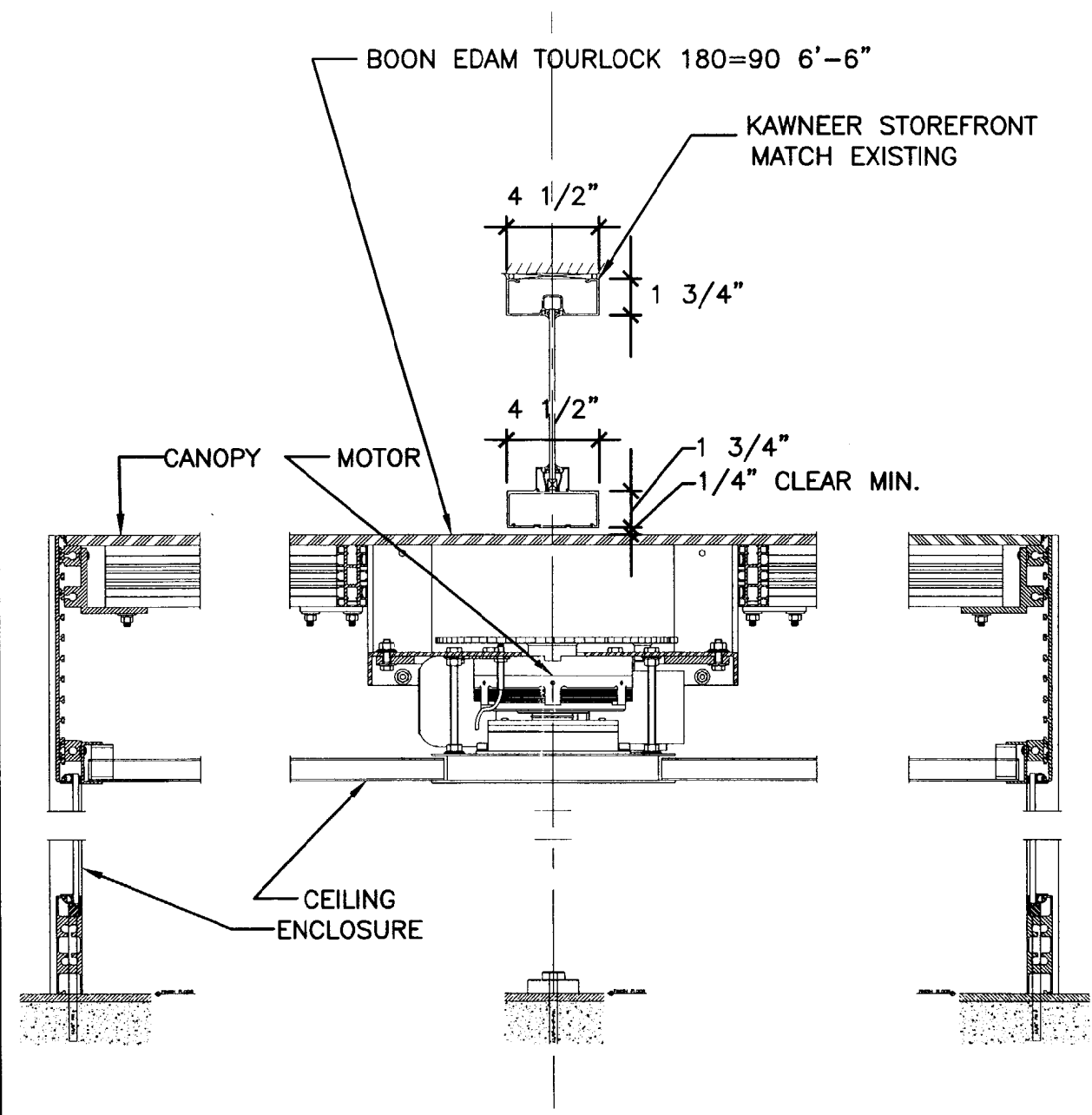
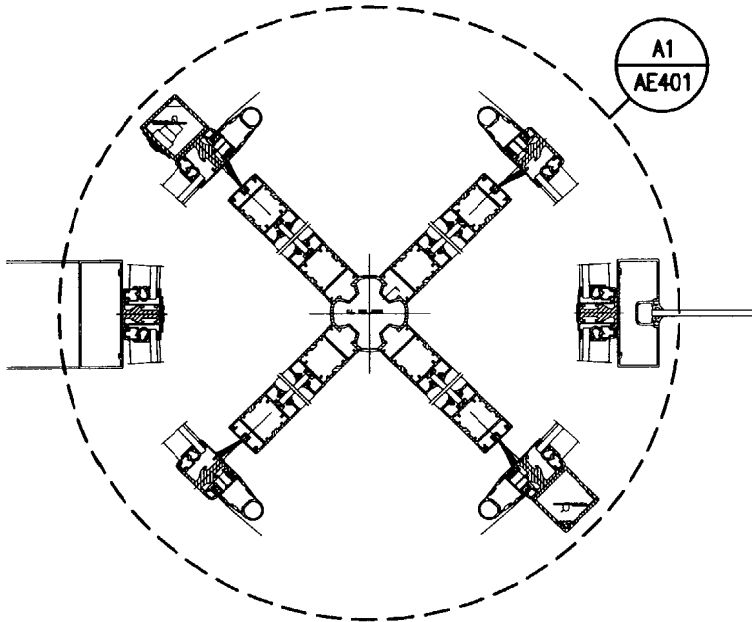

A1
1 1/2"=1'-0"

DETAIL

A3
1 1/2"=1'-0"

SECTION

A5
1 1/2"=1'-0"

SECTION

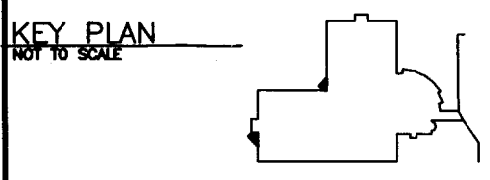

FOR CONSTRUCTION
03-14-03

ARCHITECTURE ENGINEERING PLANNING
SMRT
144 Fore Street/P.O. Box 618 PORTLAND, MAINE 04104
tel. (207) 772-3846 / fax. (207) 772-1070

PROJECT: UNIMPROVIDENT HO3 SECURITY DOORS

SUBJECT:

DETAILS

SCALE: 1 1/2"=1'-0"
PROJECT MANAGER: JLH
JOB CAP/DRAWN: RJL
A/E OF RECORD: JLH
SMRT CAD FILE: AE501-03008
PROJECT No. 03008
DATE:

SHEET No.
AE501

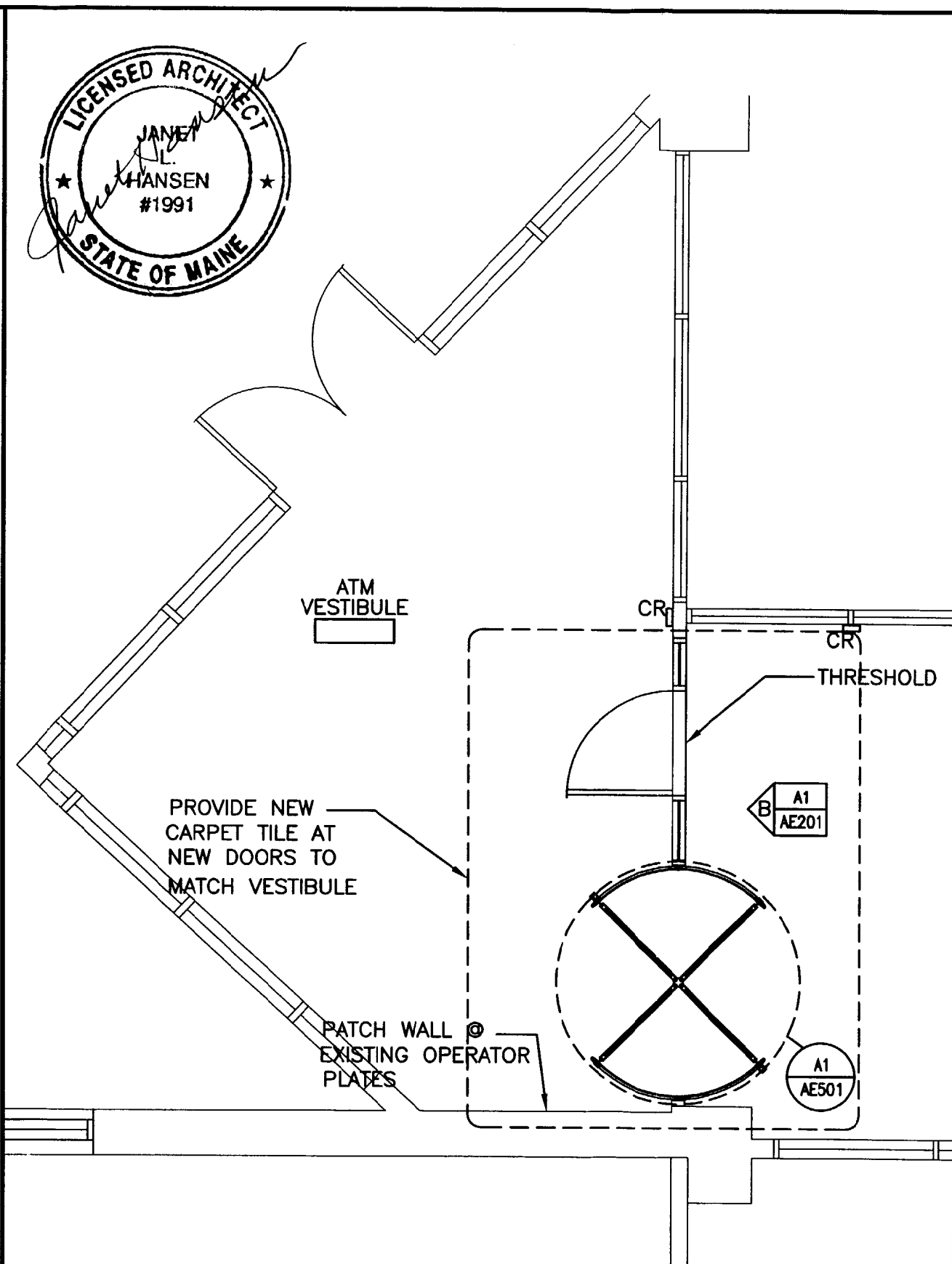
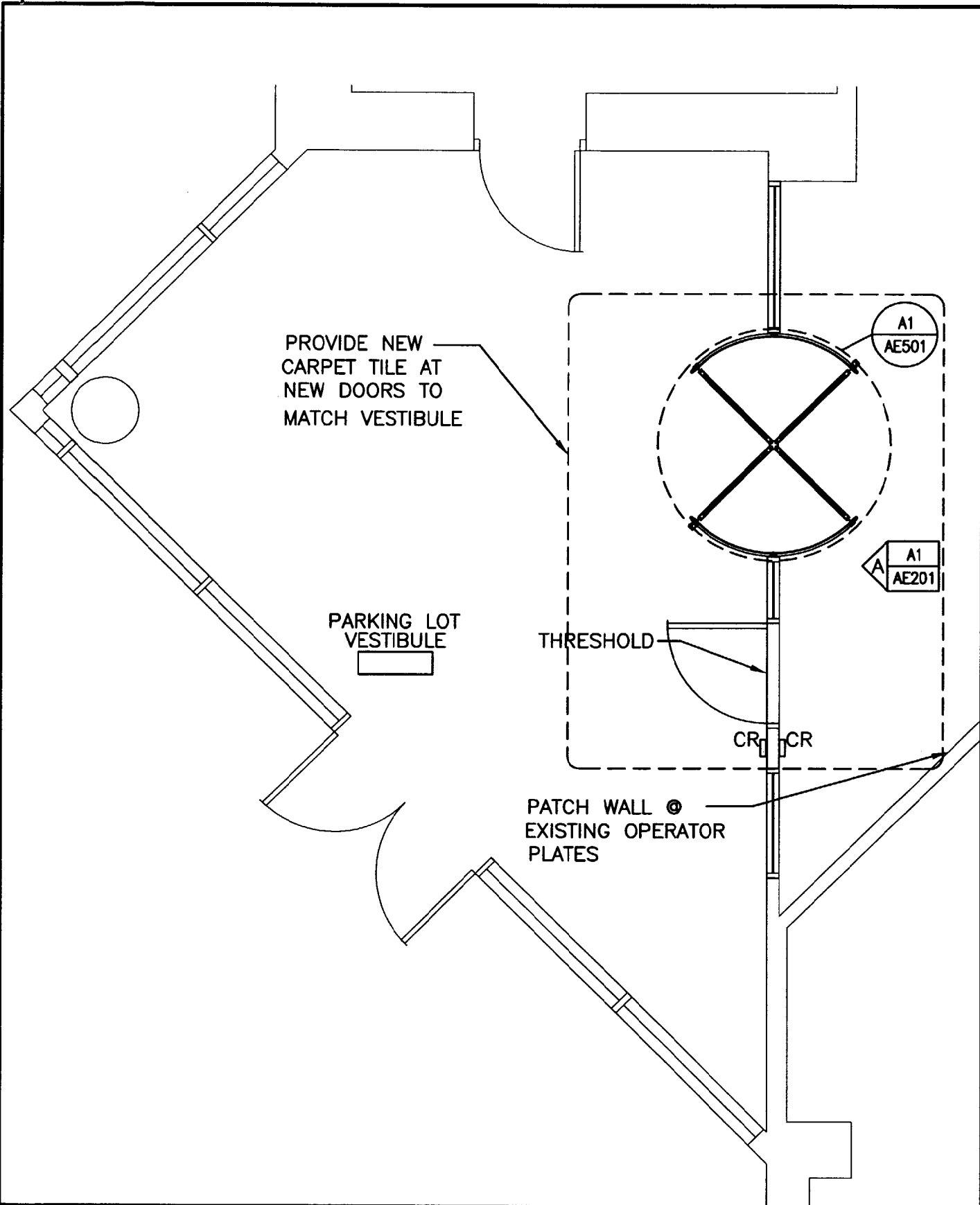
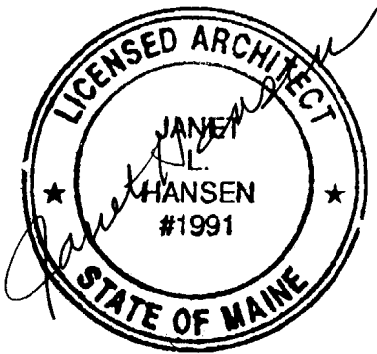

**SMT
SRT**

ARCHITECTURE ENGINEERING PLANNING
SMRT
144 Fore Street/P.O. Box 618 PORTLAND, MAINE 04104
tel. (207) 772-3846 / fax. (207) 772-1070

PROJECT: UNIMPROVIDENT H03 SECURITY DOORS

SUBJECT: FLOOR PLANS

SCALE:	1/4" = 1'-0"
PROJECT MANAGER:	JLH
JOB CAP/DRAWN:	RJL
A/E OF RECORD:	JLH
SMRT CAD FILE:	AE101-03008
PROJECT No.	03008
DATE:	

A1
1/4" = 1'-0"

FLOOR PLAN

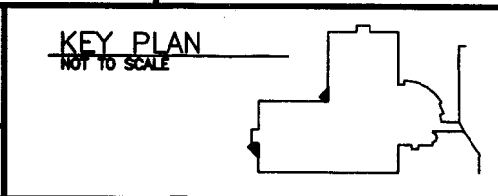

FOR CONSTRUCTION
03-14-03

SHEET No.
AE101