

REMOVE LIGHTS/TROFFERS
EXISTING MAIN 4x4 GRID TO REMAIN

REMOVE PORTIONS OF
EXISTING GRID TO SUIT
LIGHTING CONFIGURATION,
TYPICAL NEW PRIVATE
OFFICES

EXISTING CEILING,
LIGHTS, DIFFUSERS,
ETC., TO REMAIN

REMOVE
RECESSED
LIGHTING

EXISTING CEILING,
LIGHTS, DIFFUSERS,
ETC., TO REMAIN

PHASE IV
PHASE II

PHASE IV
PHASE III

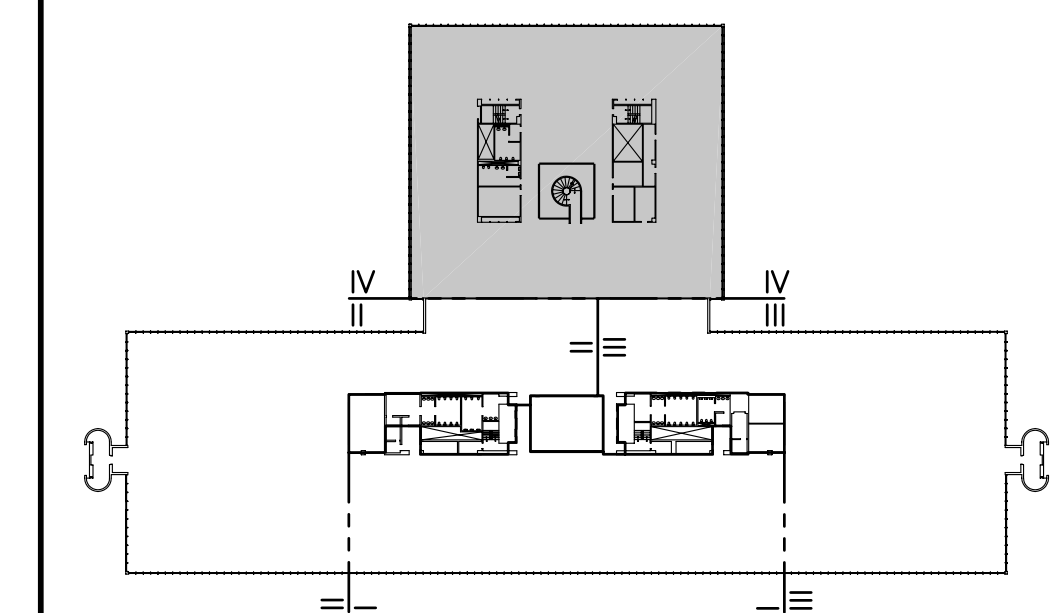

F18 KEY PLAN

NOT TO SCALE

0	ISSUED FOR CONSTRUCTION	1-28-04
REV.	DESCRIPTION	DATE

ISSUED FOR CONSTRUCTION
1-28-04

CURRENT ISSUE STATUS:

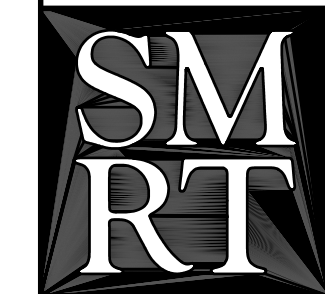
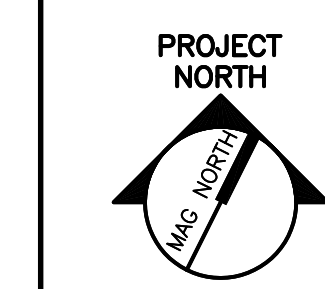

ARCHITECTURE ENGINEERING PLANNING

SMRT
144 Fore Street/P.O. Box 618
Portland, Maine 04104
tel. (207) 772-3846
fax. (207) 772-1070

UNIMPROVIDENT HO-1
2nd FLOOR OFFICE RENOVATIONS
PORTLAND, ME.

PHASE IV
REFL. CEIL. DEMOLITION PLAN

SHEET TITLE:	1/8"=1'-0"	DATE:	
PROJECT MANAGER:	JLH	GRAPHIC SCALE:	0" 1"
JOB CAP/DRAWN:	CEB		
A/E OF RECORD:	JLH	SHEET No.	
SMRT CAD FILE:	AD104-03100-01		
PROJECT No.	03100-01		

A1 REFLECTED CEILING DEMOLITION PLAN - PHASE IV

1/8"=1'-0"

AD104