

UNUMPROVIDENT

HO 1

SECOND FLOOR OFFICE RENOVATIONS

2211 Congress Street
Portland, Maine

0	ISSUED FOR CONSTRUCTION-PHASE 1	10-30-03
REV	DESCRIPTION	DATE
		
ARCHITECTURE ENGINEERING PLANNING SMRT 144 Fore Street/P.O. Box 618 PORTLAND, MAINE 04104 tel. (207) 772-3846 / fax. (207) 772-1070		















PROJECT:	UNUMPROVIDENT HO1 2ND FLOOR OFFICE RENOVATION PORTLAND, MAINE
SHEET TITLE:	COVER SHEET

CURRENT ISSUED STATUS:	ISSUED FOR CONSTRUCTION-PHASE 1 10-30-03
SCALE:	NA
PROJECT MANAGER:	JLH
SHEET No.	G1001
JC/DRAWN BY:	MDR
A/E OF RECORD:	JLH
SMRT CAD FILE:	G1001-03100
PROJECT No:	03100
DATE:	10-30-03

ABBREVIATIONS

AB ANCHOR BOLT	EA EACH	L ANGLE; LENGTH	SACT SUSPENDED ACOUSTIC
AC A/C AIR CONDITIONING	EF EXHAUST FAN; EACH FACE	LF LEFT SHEET LINOLEUM	SC TILE CEILING
ACCU AIR CONDITIONING CONDENSER UNIT	EJ EXPANSION JOINT	LL LIVE LOAD	SCF SOLID CORE SQUARE FOOT; SUPPLY FAN
ACPLAS ACOUSTICAL PLASTER	EL ELEVATION	LLH LONG LEG HORIZONTAL	SFT SHEET
ACT ACOUSTIC CEILING TILE	ELEC ELECTRICAL	LLV LONG LEG VERTICAL	SK SIMILAR
AFF ABOVE FINISHED FLOOR	EOP EDGE OF PAVEMENT	LP LIGHTING PANEL; LIQUIFIED PROPANE	SKX SHEAR KEY
AGG AGGREGATE	EPPM ETHYLENE PROPYLENE DIENE MONOMER		SN SANITARY NAPKIN (DISPENSER)
ALT ALTERNATE	EQ EQUAL		SP SPECIAL
AP ACCESS PANEL	EW EACH WAY	MAX MAXIMUM	SS STAINLESS STEEL
APROX APPROXIMATE	EWC ELECTRIC WATER COOLER	MB MARKER BOARD	STA STATION
ARCH ARCHITECTURAL	EXST EXISTING	MDO MEDIUM DENSITY OVERLAY	STL STEEL
	EXP EXPANSION	MECH MECHANICAL	STRUC STRUCTURAL
	EXT EXTERIOR	MFR MANUFACTURER	
BCX BOTTOM CHORD EXTENSION		MIN MINIMUM	T TREAD
BD BOARD	F.R.P. FABRICATED FIBERGLASS REINFORCED PLASTIC	MISC MISCELLANEOUS	TB TACKBOARD
BIT BITUMINOUS	FB FLAT BAR	MASONRY MASONRY OPENING	T&B TOP AND BOTTOM
BLDG BUILDING	FBO FURNISHED BY OTHERS	MO MOISTURE-RESISTANT	TBM TEMPORARY BENCHMARK
BLP BORROWED LIGHT PANEL	FCO FLOOR CLEAN-OUT	MUA MAKE-UP AIR	TCE TOP CHORD EXTENSION
BO BOTTOM OF	FD FLOOR DRAIN		TJ TIE JOIST
BOF BOTTOM OF FOOTING	FE FIRE EXTINGUISHER	N NOSING	TO TOP OF
BOS BOTTOM OF STEEL	FF FINISHED FLOOR- FAR FACE	NCB NEW CATCH BASIN	TOC TOP OF CONCRETE
BOT BOTTOM	FFE FINISHED FLOOR ELEVATION	NDMH NEW DRAIN MANHOLE	TOF TOP OF FOOTING
BRDG BRIDGING	FO FRAMED OPENING	NFM NEW FORCE MAINE	TOM TOP OF MASONRY
BRG BEARING	FRP FIBERGLASS REINFORCED PLASTIC	NIC NOT IN CONTRACT	TOP TOP OF
BS BOTH SIDES	FS FAR SIDE	NS NEAR SIDE	TOS TOP OF STEEL; TOP OF SLAB
BSE BRICK SHELF ELEVATION	FTG FOOTING	NSD NEW STORM DRAIN LINE	TOW TOP OF WALL
		NSS NEW SANITARY SEWER LINE	
		NTS NOT TO SCALE	TP TOILET PAPER (DISPENSER); TEST PIT
C CHANNEL	GA GAUGE	NW NEW WATER LINE	TS TUBE STEEL
CB CATCH BASIN; CHALKBOARD	GALV GALVANIZED		TYP TYPICAL
CEM BO CEMENTITIOUS BACKER BOARD	GB GRAB BAR	OC ON CENTER	UH UNIT HEATER
CFM CUBIC FEET PER MINUTE	GC GENERAL CONTRACTOR	OH OUTSIDE FACE OVERHEAD	UNO UNLESS NOTED OTHERWISE
CIP CAST IN PLACE	GDT GYPSUM DROP-IN TILE	PA PUBLIC ADDRESS	V VENT PIPE; VERTICAL
CJ CONTROL JOINT; CONSTRUCTION JOINT	GV GRAVITY VENT	PAF POWDER-ACTUATED FASTENER	VB VAPOR BARRIER
CL CENTER LINE	GWB GYPSUM WALL BOARD	PDU POOL DEHUMIDIFICATION UNIT	VCT VINYL COMPOSITION TILE
CLL CONTRACT LIMIT LINE		PL PLATE; PROPERTY LINE	VERT VERTICAL
CLR CLEAR		PLM PLASTIC LAMINATE	VP VISION PANEL
CMU CONCRETE MASONRY UNIT		PLF POUNDS PER LINEAR FOOT	VTR VENT THROUGH THE ROOF
COL COLUMN		PP POWER PANEL	
CONC CONCRETE		PSF POUNDS PER SQUARE FOOT	W/ WITH
CONT CONTINUOUS		PSI POUNDS PER SQUARE INCH	WC WATER CLOSER
CT CERAMIC TILE		PT PRESSURE-TREATED	WF WIDE FLANGE
CUH CABINET UNIT HEATER		PVC POLYVINYL CHLORIDE	WH WATER HEATER
		PVMT PAVEMENT	W/O WITHOUT
D DIAMETER			WP WORKING POINT
DBL DOUBLE			WS WEB STIFFENER
DF DRINKING FOUNTAIN			WWF WELDED WIRE FABRIC
DL DEAD LOAD			
DR DISPLAY RAIL			
DTL DETAIL			
DW DISHWASHER			
DWC DRAWING			
I INCLUDED ANGLE			
ID INSIDE DIAMETER			
IF INSIDE FACE			
IMP ISOLATION JOINT			
INS IMPACT RESISTANT			
INV INVERT			
JS JOIST SUBSTITUTE			
K KIPS			

SYMBOL LEGEND

	BUILDING SECTION
	WALL SECTION
	DETAIL
	EXTERIOR ELEVATION
	INTERIOR ELEVATION
	LEVEL LINE
	CIRCLE NOTE
	WINDOW TAG
	PARTITION TAG
	DOOR TAG
	ROOM NAME
	ROOM NUMBER
	COLUMN BUBBLE AND CENTER LINE
	BACKER ROD AND SEALANT

GRID NO.	TITLE
SCALE	REFERENCE SHEET

DRAWING LIST

GENERAL	
G001	COVER SHEET
ARCHITECTURAL	
AD101	DEMOLITION PLAN
AE101	REFLECTED CEILING PLAN
MECHANICAL	
M-001	LEGEND AND ABBREVIATIONS
M-002	SPECIFICATIONS & NOTES
MD101	CONFERENCE ROOM DEMOLITION PLANS
MD102	CONFERENCE ROOM DEMOLITION PLANS
M-101	CONFERENCE ROOM HVAC PLANS
M-102	CONFERENCE ROOM HVAC PLANS
M-501	DETAILS
M-601	SCHEDULES
ELECTRICAL	
ED101	ELECTRICAL DEMOLITION PLAN
E-001	LEGEND AND GENERAL NOTES
E-101	LIGHTING & SYSTEMS PLAN

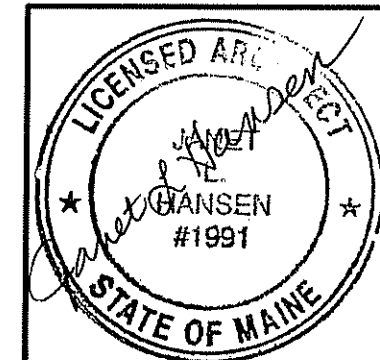

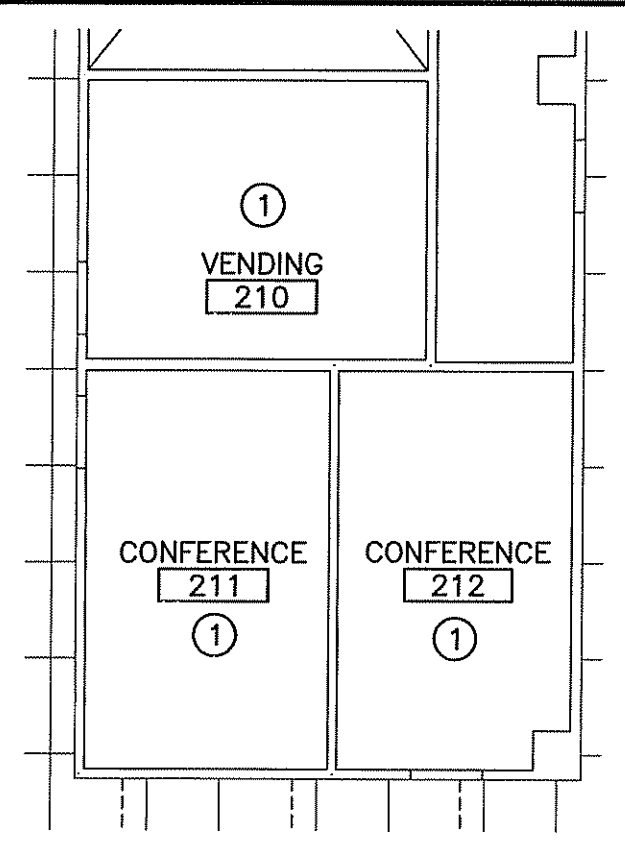
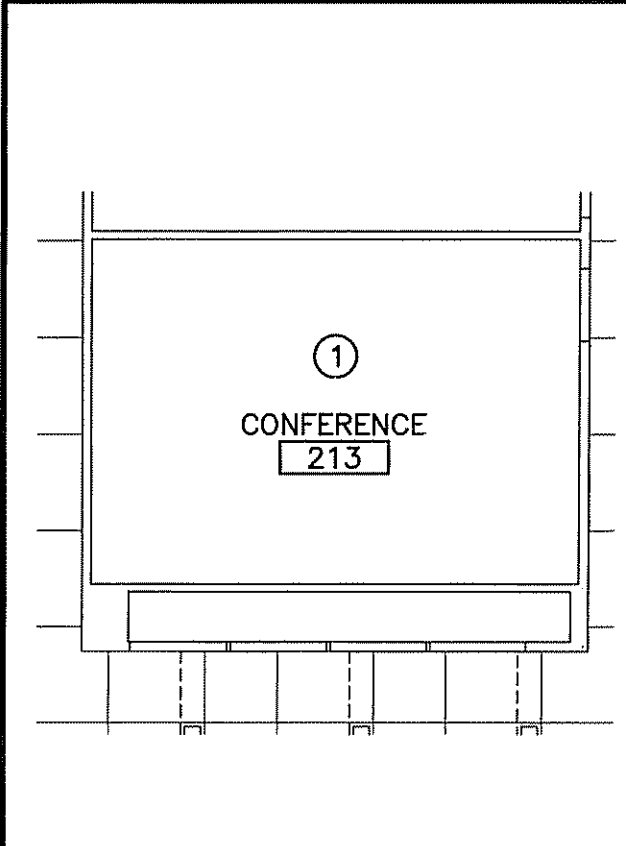

KEYED DEMO NOTES:

- ① REMOVE CEILING ASSEMBLY COMPLETE, PREPARE FOR NEW

C1 PART. REFLECTED CEILING PLAN
1/8"=1'-0"

C4 PART. REFLECTED CEILING PLAN
1/8"=1'-0"

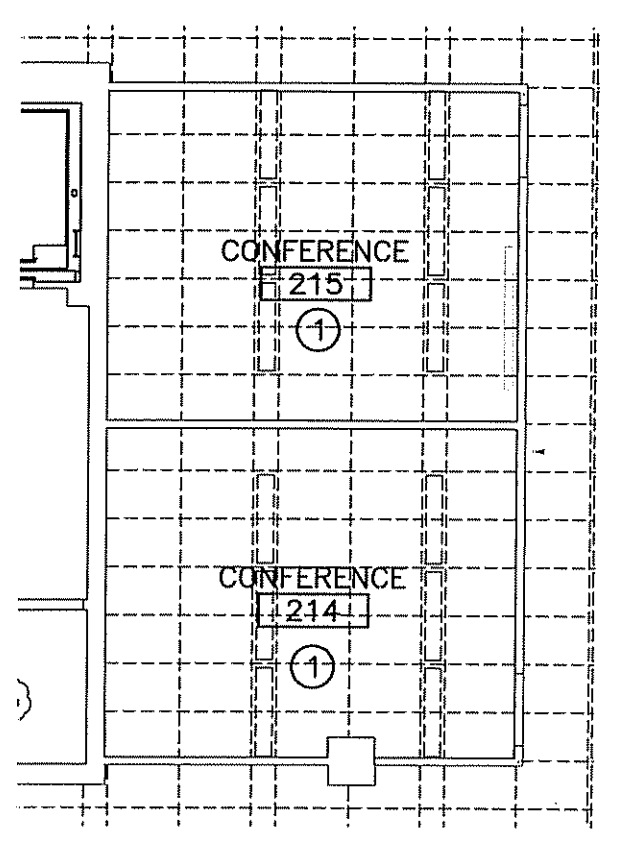
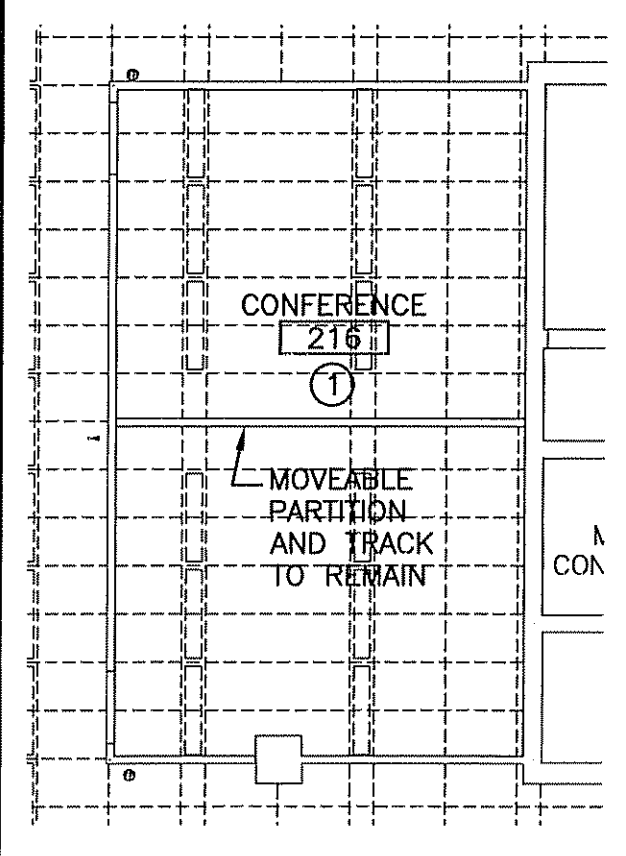

A1 PART. REFLECTED CEILING PLAN
1/8"=1'-0"

A4 PART. REFLECTED CEILING PLAN
1/8"=1'-0"

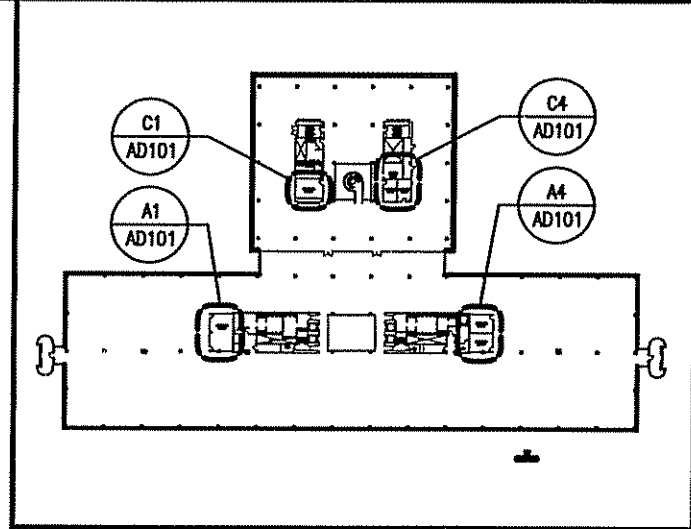

KEY PLAN - SECOND FLOOR

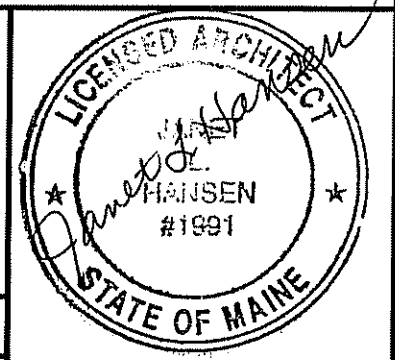

REV	DESCRIPTION	DATE
0	ISSUED FOR CONSTRUCTION-PHASE 1	10-30-03

PROJECT: UNUMPROVIDENT HO1
2ND FLOOR OFFICE RENOVATION
PORTLAND, MAINE

CURRENT ISSUED STATUS: **ISSUED FOR CONSTRUCTION-PHASE 1 10-30-03**

SCALE: 1/8"=1'-0"
PROJECT MANAGER: JLH
SHEET No. **AD101**

JC/DRAWN BY: MDR
A/E OF RECORD: JLH
SMART CAD FILE: AD101-03100
PROJECT No: 03100
DATE: 10-30-03

SM RPT

ARCHITECTURE ENGINEERING PLANNING
SMART
144 Fore Street/P.O.Box 618 PORTLAND, MAINE 04104
tel. (207) 772-3846 / fax. (207) 772-1070

SHEET TITLE: **DEMOLITION PLAN**

© copyright 2003 SMART INC.

ROOM FINISH SCHEDULE											
ROOM NUMBER	ROOM NAME	FLOOR	BASE	WALLS				CEILING		ROOM NUMBER	REMARKS
				NORTH	SOUTH	EAST	WEST	MATERIAL	HEIGHT		
210	VENDING	EXST VCT	RES	PAINT	PAINT	PAINT	PAINT	ACT	9'-4"	210	
211	CONFERENCE	CPT. TILE 1	RES	PAINT	PAINT	PAINT	PAINT	ACT	9'-4"	211	
212	CONFERENCE	CPT. TILE 1	RES	PAINT	PAINT	PAINT	PAINT	ACT	9'-4"	212	
213	CONFERENCE	CPT. TILE 1	RES	PAINT	PAINT	PAINT	PAINT	ACT	9'-4"	213	
214	CONFERENCE	CPT. TILE 1	RES	PAINT	PAINT	PAINT	PAINT	ACT	9'-4"	214	
215	CONFERENCE	CPT. TILE 2	RES	PAINT	PAINT	PAINT	PAINT	ACT	9'-4"	215	
216	CONFERENCE	CPT. TILE 2	RES	PAINT	PAINT	PAINT	PAINT	ACT	9'-4"	216	

FINISH MATERIAL NOTES:

- CARPET TILE 1 TO BE MILLIKEN WINDOWPANES.
- RESILIENT BASE TO BE 4" BLACK, STRAIGHT.
- HOLLOW METAL DOORS AND FRAMES AND CHAIR RAILS TO BE PAINTED, BENJAMIN MOORE COLOR , ARMY GREEN 2141-30.
- ALL WALLS TO BE PAINTED, CALIFORNIA PAINT COLOR BOTANY BEIGE, 8221W.
- ACT - 15/16" GRID WITH ARMSTRONG FINE FISSURED #1729.

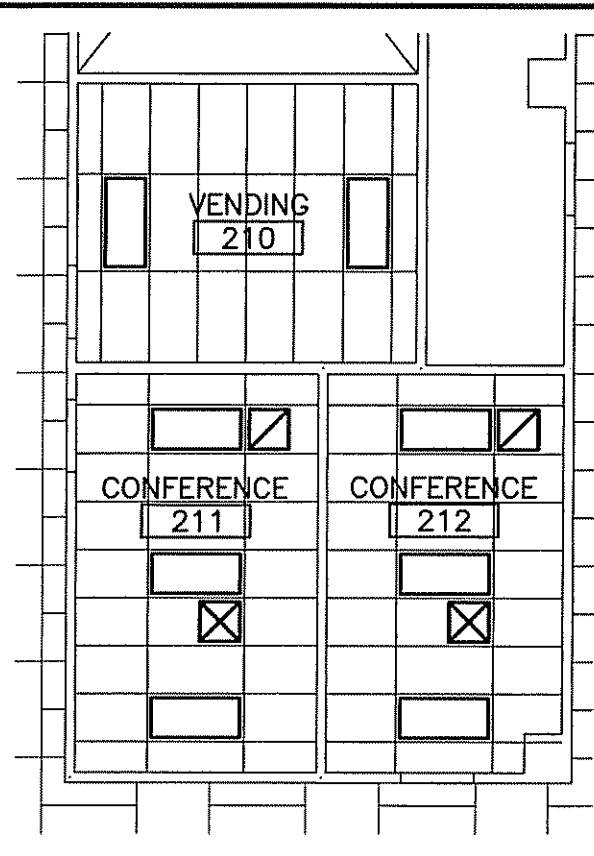
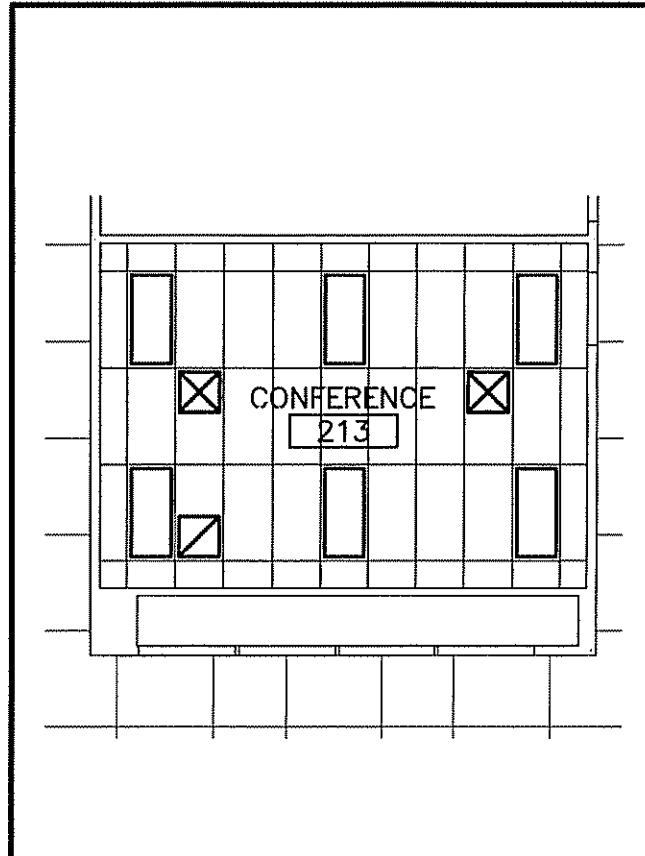

C1 PART. REFLECTED CEILING PLAN
1/8"=1'-0"

C4 PART. REFLECTED CEILING PLAN
1/8"=1'-0"

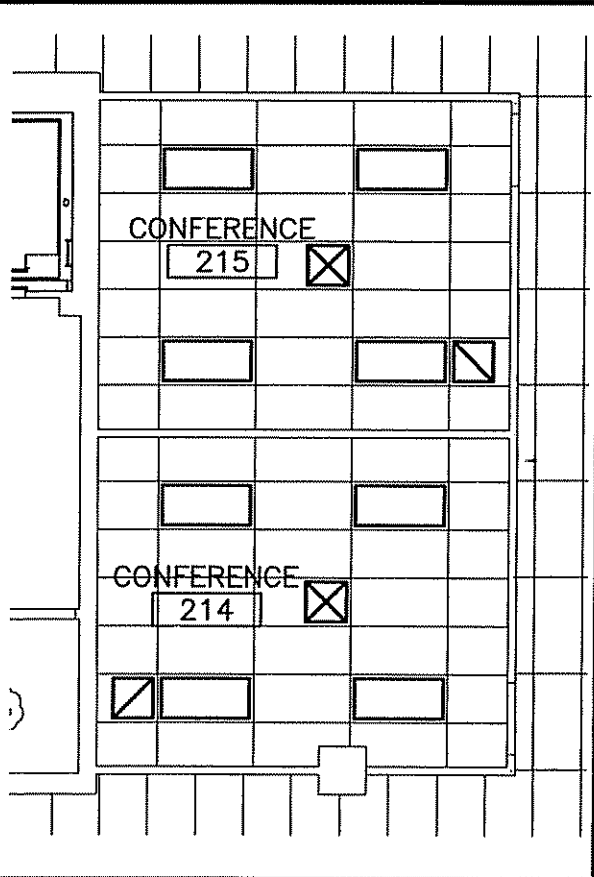
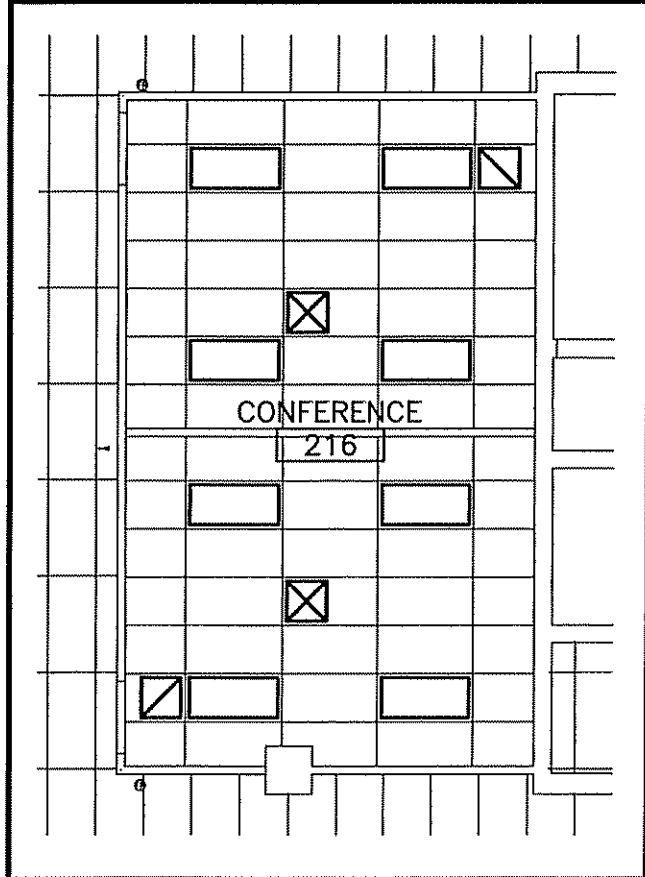

A1 PART. REFLECTED CEILING PLAN
1/8"=1'-0"

A4 PART. REFLECTED CEILING PLAN
1/8"=1'-0"

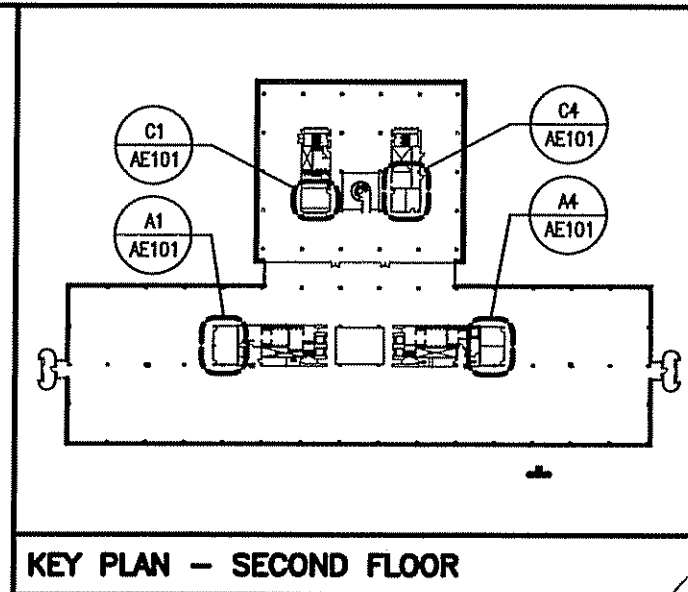

KEY PLAN - SECOND FLOOR

ISSUED FOR CONSTRUCTION-PHASE 1
10-30-03

SCALE: 1/8"=1'-0"
PROJECT MANAGER: JLH
SHEET No. **AE101**

JC/DRAWN BY: MDR
A/E OF RECORD: JLH
SMART CAD FILE: AE101-03100
PROJECT No: 03100
DATE: 10-30-03

© COPYRIGHT 2003 SMART, INC.

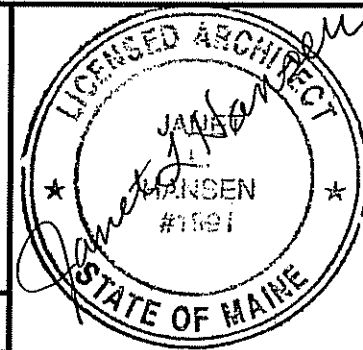

ISSUED FOR CONSTRUCTION-PHASE 1 10-30-03

PROJECT: UNUMPROVIDENT HO1
2ND FLOOR OFFICE RENOVATION
PORTLAND, MAINE

SHEET TITLE: REFLECTED CEILING PLAN

ARCHITECTURE ENGINEERING PLANNING
SMART
144 Fore Street/P.O. Box 618 PORTLAND, MAINE 04104
tel. (207) 772-3846 / fax. (207) 772-1070

SM
RT

AIR DISTRIBUTION SYMBOLS

	RECTANGULAR DUCT (FIRST NUMBER IS SIDE SHOWN) DIMENSIONS IN INCHES
	12 INCH ROUND DUCT
	MOTORIZED DAMPER
	FLEXIBLE DUCT
	DUCT FLEXIBLE CONNECTOR (FC)
	DUCT DROPS AND RISES IN DIRECTION OF AIR FLOW
	RETURN DUCT TURNED UP OR DOWN (DASHED)
	SUPPLY DUCT TURNED UP OR DOWN (DASHED)
	EXHAUST DUCT TURNED UP OR DOWN (DASHED)
	ACOUSTICAL LINING (DUCT DIM. FOR NET FREE AREA)
	ROUND DUCT ELBOW DOWN
	ROUND DUCT ELBOW UP
	SQUARE TO ROUND TRANSITION
	CAP (DUCT AND/OR PIPE)
	INDICATES DUCT, PIPING, EQUIPMENT TO BE REMOVED.
	EXHAUST AIR
	RETURN AIR
	SUPPLY AIR
	VOLUME DAMPER
	FIRE DAMPER
	SMOKE DAMPER
	COMBINATION SMOKE/FIRE DAMPER
	RECTANGULAR ELBOW W/TURNING VANES
	DIRECTION OF AIR FLOW (IN) DIRECTION OF AIR FLOW (OUT)
	HUMIDISTAT OR HUMIDITY SENSOR
	THERMOSTAT (T) OR TEMP. SENSOR
	SMOKE DETECTOR
	ACCESS DOOR
	DIFFUSER, REGISTER OR GRILLE TAG
	CFM AIR FLOW QUANTITY
	FINNED TUBE TAG
	DETAIL NO. SHEET NO. WHERE DETAIL IS LOCATED
	EQUIPMENT TAG EQUIPMENT NO.

PIPING SYMBOLS

	UNION		DRIFT FLOWMETER
	FLANGE		FLEXIBLE PIPE CONNECTOR
	PIPE ANCHOR		EXPANSION JOINT
	PIPE GUIDE OR SLEEVES		STEAM TRAP (FLOAT AND THERMOSTATIC INDICATED T.T. THERMOSTAT, B.T. BUCKET TRAP)
	PIPE ELBOW TURNED DOWN		CONCENTRIC REDUCER/INCREASER
	PIPE ELBOW TURNED UP		ECCENTRIC REDUCER/INCREASER
	PIPING TEE-DOWN		HOSE BIBB
	PIPING TEE-UP		WALL HYDRANT
	PIPE RISER		DIRECTION OF FLOW
	FLOOR CLEAN OUT		FIRE DEPARTMENT CONNECTION
	CLEAN OUT		PUMP
	WALL CLEAN OUT		WATER HAMMER SUPPRESSER
	PIPE PITCHES DOWN		FINNED TUBE BASEBOARD
	GENERIC VALVE. SEE SPECIFICATIONS FOR TYPE		HUMIDIFIER
	GATE VALVE		DIFFERENTIAL PRESSURE TRANSMITTER
	BALL VALVE		SPRINKLER HEAD
	BUTTERFLY VALVE (MANUAL)		GAS TURRET
	2-WAY CONTROL VALVE		MEDICAL OXYGEN OUTLET
	3-WAY CONTROL VALVE		MEDICAL VACUUM INLET
	BALANCING VALVE (CIRCUIT SETTER)		MEDICAL AIR OUTLET
	CHECK VALVE		NITROUS OXIDE OUTLET
	PLUG VALVE		
	GLOBE VALVE		
	NEEDLE VALVE		
	BACK FLOW PREVENTER		
	SOLENOID VALVE		
	PRESSURE REDUCING OR REGULATING VALVE		
	PRESSURE RELIEF VALVE		
	STRAINER W/BLOWDOWN		
	MANUAL AIR VENT		
	AUTOMATIC AIR VENT		
	PRESSURE SWITCH		
	FLOW SWITCH		
	PRESSURE GAUGE AND COCK		
	THERMOMETER AND WELL		
	TEMPERATURE & PRESSURE TAP (PETE'S PLUG)		
	HOSE END DRAIN VALVE WITH CAP		

ABBREVIATIONS

AAV	AUTOMATIC AIR VENT	EA	EXHAUST AIR	PAE	PROCESS ACID EXHAUST
ACC	AIR COOLED CONDENSER	EF	EXHAUST FAN	PHE	PROCESS HEAT EXHAUST
ACU	AIR CONDITIONING UNIT	ENC	ENCLOSURE	PSE	PROCESS SOLVENT EXHAUST
AD	ACCESS DOOR	ER	EXHAUST REGISTER	PP	POLY-PROPYLENE
AE	ACID EXHAUST	(E)	EXISTING	PPE	PRE PURCHASED EQUIPMENT
AFF	ABOVE FINISHED FLOOR	EXIST.	EXISTING	PRS	PRESSURE REDUCING STATION
AHU	AIR HANDLING UNIT	FBO	FURNISHED BY OWNER	PRV	PRESSURE REDUCING VALVE
AP	ACCESS PANEL	FBP	FACE AND BYPASS	PVD	PNEUMATIC VOLUME DAMPER
ATC	AUTOMATIC TEMPERATURE CONTROL	FC	FLEXIBLE CONNECTION	(R)	REMOVE
AV	AIR VENT	FCD	FLOOR CLEANOUT	RA	RETURN AIR
BA	BREATHING COMPRESSED AIR	FD-#	FLOOR DRAIN TAG	(REL.)	RELOCATED
BB	BASEBOARD	FD	FIRE DAMPER	RF	RETURN FAN
BOD	BACKDRAFT DAMPER	FG	FIBERGLASS	RG	RETURN GRILLE
BO	BLAST GATE	F & T	FLOAT AND THERMOSTATIC	RHC	REHEAT COIL
BFP	BACKFLOW PREVENTER	FR#B	FREEZE RESISTANT HOSE BIBB	RM	ROOM
BLDG	BUILDING	FTR	FINNED TUBE RADIATION	RPZ	REDUCED PRESSURE ZONE BFP
BOO	BOTTOM OF DUCT	FS	FLOW SWITCH	RR	RETURN REGISTER
BOP	BOTTOM OF PIPE	GC	GENERAL CONTRACTOR	RV	RELIEF VALVE
BTU	BRITISH THERMAL UNIT	GPM	GALLONS PER MINUTE	SA	SUPPLY AIR
CBQ	COUNTER BALANCED DAMPER	H	HUMIDIFIER	SCV	SELF CONTAINED VALVE
CD	CEILING DIFFUSER	HB	HOSE BIBB	SD	SMOKE DETECTOR
CFP	CAPPED FOR FUTURE	HBU	HEAT RECOVERY UNIT	SF	SUPPLY FAN
CFM	CUBIC FEET PER MINUTE	HTR	HEATER	SG	SUPPLY GRILLE
CLD	CEILING	H & V	HEATING AND VENTILATION	SR	SUPPLY REGISTER
CO	CLEANOUT	HAC	HEATING, VENTILATING AND AIR CONDITIONING	TE	TEMPERATURIZED ELEMENT (SENSOR)
CONT	CONTINUATION	HW	HOT WATER	TO	TRANSFER GRILLE
COORD	COORDINATE	HX	HEAT EXCHANGER	TOO	TOP OF DUCT
CT	COOLING TOWER	IN WG	INCHES WATER GAUGE	TOP	TOP OF PIPE
CTE	CONNECT TO EXISTING	LD	LINED DUCT	TT	TIGHT TO STEEL
CU	COPPER	MAU	MAKE UP AIR UNIT	TV	TURBINE WAVE(S)
CUH	CABINET UNIT HEATER	MAX	MAXIMUM	TYP	TYPICAL
CV	CONTROL VALVE	MBH	1000 BTU/HR	UH	UNIT HEATER
CW	COLD WATER	ME	MECHANICAL ENGINEER	UP	UP IN CHASE
CW-P	CITY WATER-PROCESS	MFR	MANUFACTURER	UPW	UP IN WALL
DC	DOUBLE CONTAINED	MN	MINIMUM	UV	UNIT VENTILATOR
DDC	DIRECT DIGITAL CONTROL	MOD	MOTOR OPERATED DAMPER	VB	VACUUM BREAKER
DA	DIAMETER	MV	MULTI-PURPOSE VALVE	VTR	VENT THRU ROOF
DIC	DOWN IN CHASE	MUA	MAKE UP AIR	VO	MANUAL VOLUME DAMPER
DIW	DOWN IN WALL	MWP	NON-PRESSURE WATER	VCFF	VALVED AND CAPPED FOR FUTURE
DN	DOWN	MR	MERIT/DORANGE	VOC	VOLATILE ORGANIC COMPOUNDS
DS	DOWNSPOUT	OA	OUTSIDE AIR	W/	WITH
DT	DROP AND TRANSITION	ODD	OPPOSED BLADE DAMPER	WCO	WALL CLEANOUT
DWG	DRAWING	OED	OPEN ENDED DUCT	WH	WALL HYDRANT
DWH	DOMESTIC WATER HEATER	P-#	PLUMBING FIXTURE TAG		

PIPING SYSTEMS

—10-1 HF—	10-1 HF	—HCR—	HOT/ CHILLED WATER RETURN	—PCWR—	PROCESS COOLING WATER RETURN
—AV—	ACID VENT	—HCS—	HOT/ CHILLED WATER SUPPLY	—PC—	PUMPED STEAM CONDENSATE
—AD—	ACID DRAIN	—HCV—	HOUSE CLEAN VACUUM	—PD—	PUMPED DISCHARGE
—AD—	ACID DRAIN (BELOW SLAB)	—HG—	HOT GAS	—POS. SOLV.—	POSITIVE SOLVENT DRAIN
—BA—	BREATHING AIR	—HPS—	HIGH PRESSURE STEAM	—PW—	POTABLE WATER
—CD—	CONDENSATE DRAIN	—HPR—	HIGH PRESSURE CONDENSATE RETURN	—R—	RELIEF LINE
—CDA—	COMPRESSED DRY AIR	—HWS—	HOT WATER SUPPLY	—RL—	REFRIGERANT LIQUID
—CHWS—	CHILLED WATER SUPPLY	—HWR—	HOT WATER RETURN	—RS—	REFRIGERANT SUCTION
—CHWR—	CHILLED WATER RETURN	—ID—	ISOPROPYL ALCOHOL DRAIN	—S—	SANITARY
—CWS—	CONDENSER WATER SUPPLY	—LP—	LIQUID PROPANE GAS	—S—	SANITARY (UNDER SLAB)
—CWR—	CONDENSER WATER RETURN	—HLP—	HIGH PRESSURE LIQUID PROPANE GAS	—SD—	STORM DRAIN
—DB—	DISTRIBUTION VALVE BOX	—LPS—	LOW PRESSURE STEAM	—SD—	STORM DRAIN (UNDER SLAB)
—DIS—	DEIONIZED WATER SUPPLY	—LPR—	LOW PRESSURE RETURN	—ELD—	MIXED SOLVENT DRAIN
—DIR—	DEIONIZED WATER RETURN	—MA—	MEDICAL AIR	—SV—	SOLVENT
—EKD—	EKG DRAIN	—MPS—	MEDIUM PRESSURE STEAM	—SP—	SPRINKLER
—ESW—	EYEWASH	—MPR—	MEDIUM PRESSURE RETURN	—TWS—	TEMPERED CHILLED WATER SUPPLY
—FCS—	FREE COOLING SUPPLY	—MV—	MEDICAL VACUUM	—TWR—	TEMPERED CHILLED WATER RETURN
—FCR—	FREE COOLING RETURN	—N2MP—	NON-PROCESS NITROGEN	—V—	VENT
—FDS—	FUEL OIL SUPPLY	—N2—	PROCESS NITROGEN	—VAC—	PLANT VACUUM
—FOR—	FUEL OIL RETURN	—NG—	NATURAL GAS	—ZB—	ZONE VALVE BOX
—FOV—	FUEL OIL VENT	—HNG—	HIGH PRESSURE NATURAL GAS		
—GCR—	GRAVITY STEAM CONDENSATE RETURN	—NO—	NITROUS OXIDE		
—GLY—	GLYCOL	—MED. SOLV.—	NEGATIVE SOLVENT DRAIN	—TEMP—	DOMESTIC HOT WATER (TEMP °F)
—GV—	GAS VENT	—NPW—	NON POTABLE COLD WATER	—TEMP—	RECIRC. DOMESTIC HOT WATER (TEMP °F)
—H—	HYDROGEN	—CW—	DOMESTIC COLD WATER	—HW—	DOMESTIC HOT WATER
—H2O2—	HYDROGEN PEROXIDE	—DFA—	OIL FREE COMPRESSED AIR	—RCW—	RECIRCULATED DOMESTIC HOT WATER

GENERAL NOTE

1. ALL GENERAL NOTES, SYMBOL LISTS, AND DETAILS ARE TO BE CONSIDERED AS APPLICABLE TO ALL HVAC DRAWINGS FOR THIS PROJECT. SYMBOLS AND ABBREVIATIONS SHOWN ON THIS SHEET ARE FOR REFERENCE ONLY AND DO NOT INDICATE THEIR INCORPORATION INTO THE DESIGN.

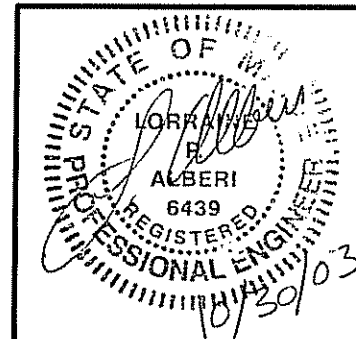

PROJECT:	UNIMPROVIDENT HO1 2ND FLOOR OFFICE RENOVATION PORTLAND, MAINE		ISSUED FOR CONST.-PHASE1	10-30-03	DATE
	SHEET TITLE:		REV	DESCRIPTION	
CURRENT ISSUED STATUS:	ISSUED FOR CONSTRUCTION-PHASE 1 10-30-03		ARCHITECTURE ENGINEERING PLANNING SMART 144 Fore Street/P.O. Box 618 PORTLAND, MAINE 04104 tel. (207) 772-3846 / fax. (207) 772-1070		
SCALE:	NOT TO SCALE	JC/DRAWN BY:	BGG		
PROJECT MANAGER:	JLH	A/E OF RECORD:	LPA		
SHEET No.	M-001	SMART CAD FILE:	M-001-03100	PROJECT No.:	03100
				DATE:	10-30-03

SPECIFICATIONS & NOTES:

CONTRACTOR SHALL VISIT THE SITE TO DETERMINE PRE-EXISTING CONDITIONS AND ALL WORK NECESSARY, PRIOR TO BIDDING. VERIFY ALL MEASUREMENTS AND EXISTING CONDITIONS IN THE FIELD. GENERAL SCHEMATIC LAYOUT IS INDICATED; ALL OFFSETS, OBSTRUCTIONS, AND EXISTING CONFIGURATIONS AND CONSTRAINTS MUST BE FIELD VERIFIED.

OBTAIN NECESSARY PERMITS AND PAY ASSOCIATED FEES.

COORDINATE ANY SERVICE DISRUPTIONS WITH THE OWNER.

INSTALL ALL COMPONENTS IN ACCORDANCE WITH MANUFACTURER RECOMMENDATIONS, ALL LOCAL CODES AND STANDARDS, AND UNUM PROVIDENT REQUIREMENTS.

DRAWINGS ARE DIAGRAMMATIC ONLY; FIELD-VERIFY ALL EXISTING CONDITIONS. COORDINATE INSTALLATIONS WITH OTHER TRADES.

THE INTENTION OF THESE CONTRACT DOCUMENTS IS TO CALL FOR FINISHED WORK, FULLY TESTED AND READY FOR OPERATION. ANY COMPONENTS OR LABOR NOT MENTIONED IN THE CONTRACT DOCUMENTS BUT REQUIRED FOR FUNCTIONING SYSTEMS SHALL BE PROVIDED. SHOULD THERE APPEAR TO BE ANY DISCREPANCIES OR QUESTIONS OF INTENT, THE CONTRACTOR SHALL REFER THE MATTER TO THE ARCHITECT FOR DECISION BEFORE START OF ANY RELATED WORK.

PERFORM WORK IN ACCORDANCE WITH LOCAL CODES.

SEAL ALL DUCT AND PIPE PENETRATIONS WITH FIRE SEALANT.

OBSERVE THE OWNER'S CLEANLINESS PROTOCOLS.

METAL DUCTWORK

GALVANIZED STEEL DUCTWORK: ASTM A653 GALVANIZED STEEL SHEET, LOCK-FORMING QUALITY, AND G90 ZINC COATING. ALL DUCTWORK SHALL BE FURNISHED AND INSTALLED IN ACCORDANCE WITH SMACNA STANDARDS. CONSTRUCT DUCT SYSTEMS SO THAT LEAKAGE DOES NOT EXCEED ONE PERCENT OF THE TOTAL AIR QUANTITIES. SEAL ALL DUCT JOINTS WITH GASKETED CONNECTIONS, DUCTMATE, OR EQUAL.

DUCTWORK PRESSURE/SEAL CLASS.

SUPPLY DUCTWORK UPSTREAM OF DUAL DUCT VAV TERMINAL UNITS:

6 INCH/CLASS A.

SUPPLY DUCTWORK DOWNSTREAM OF DUAL DUCT VAV TERMINAL UNITS:

2 INCH/CLASS C.

INSULATE DUCTWORK WITH 1-1/2" F.G. BLANKET WITH VAPOR BARRIER JACKET EQUAL TO SCHULLER MICOLITE TYPE 75, ASTM C533, WITH FSK FACING.

PROVIDE VOLUME DAMPERS AT ALL BRANCH DUCTS.

SPECIFICATIONS & NOTES: (CONT)

INSULATED FLEXIBLE DUCTS

ALUMINUM LAMINATE AND POLYESTER FILM WITH LATEX ADHESIVE SUPPORTED BY HELICALLY WOUND SPRING STEEL WIRE, FIBERGLASS INSULATION, POLYETHYLENE VAPOR BARRIER FILM. R-VALUE = 4.2, UL 181, CLASS 1. MAXIMUM LENGTH: 5 FEET.

DUAL DUCT VAV TERMINAL UNITS

DESIGN IS BASED ON TITUS, PRESSURE INDEPENDENT, COMPLETE WITH SEPARATE INLET MULTI-POINT AIRFLOW SENSORS AND DAMPER ASSEMBLIES. THE TERMINAL CASING SHALL BE MINIMUM 20 GAUGE GALVANIZED STEEL, INTERNALLY LINED WITH NON-POROUS, FIBER-FREE SEALED LINER WHICH COMPLIES WITH UL 181 AND NFPA 255. DAMPERS OF HEAVY GAUGE STEEL.

UNIT SHALL INCLUDE A MIXER-ATTENUATOR SECTION AS AN INTEGRAL PART OF THE TERMINAL MINIMIZE DOWNSTREAM STRATIFICATION.

PROVIDE 24 VOLT CONTROL TRANSFORMER.

AUTOMATIC TEMPERATURE CONTROLS

EXTEND THE EXISTING ANDOVER CONTROL SYSTEM TO SERVE THE RENOVATED AREA. ALL NEW CONTROLS SHALL BE ELECTRONIC/DDC.

PROVIDE COMPLETE CONTROLS FOR VAV TERMINAL UNITS.

TESTING, ADJUSTING, AND BALANCING (T-A-B)

TEST, ADJUST, AND BALANCE EQUIPMENT AND DISTRIBUTION SYSTEMS IN ACCORDANCE WITH NEBB OR AABC PROCEDURAL STANDARDS. TESTS SHALL BE PERFORMED BY AN INDEPENDENT T-A-B AGENCY.

T-A-B ALL NEW AIR INLETS AND OUTLETS, INCLUDING DESIGN AND ACTUAL CFM.

T-A-B NEW DUAL DUCT VAV TERMINAL UNITS.

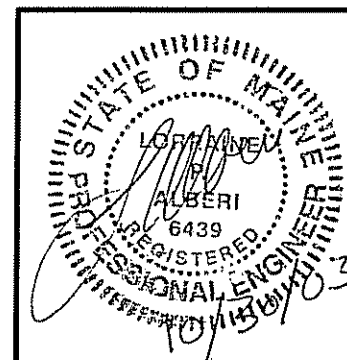

CURRENT ISSUED STATUS: ISSUED FOR CONSTRUCTION-PHASE 1 10-30-03	SCALE: NOT TO SCALE	JC/DRAWN BY: CAH	DATE: 10-30-03
	PROJECT MANAGER: JLH	A/E OF RECORD: LPA	
SHEET No. M-002	SMRT CAD FILE: M-002-03100	PROJECT No: 03100	DATE: 10-30-03
PROJECT: UNUMPROVIDENT HO1 2ND FLOOR OFFICE RENOVATION PORTLAND, MAINE		SHEET TITLE: SPECIFICATIONS & NOTES	
REV: 0		ISSUED FOR CONST.-PHASE 1	DATE: 10-30-03
ARCHITECTURE ENGINEERING PLANNING SMRT 144 Fore Street/P.O. Box 618 PORTLAND, MAINE 04104 tel. (207) 772-3846 / fax. (207) 772-1070			

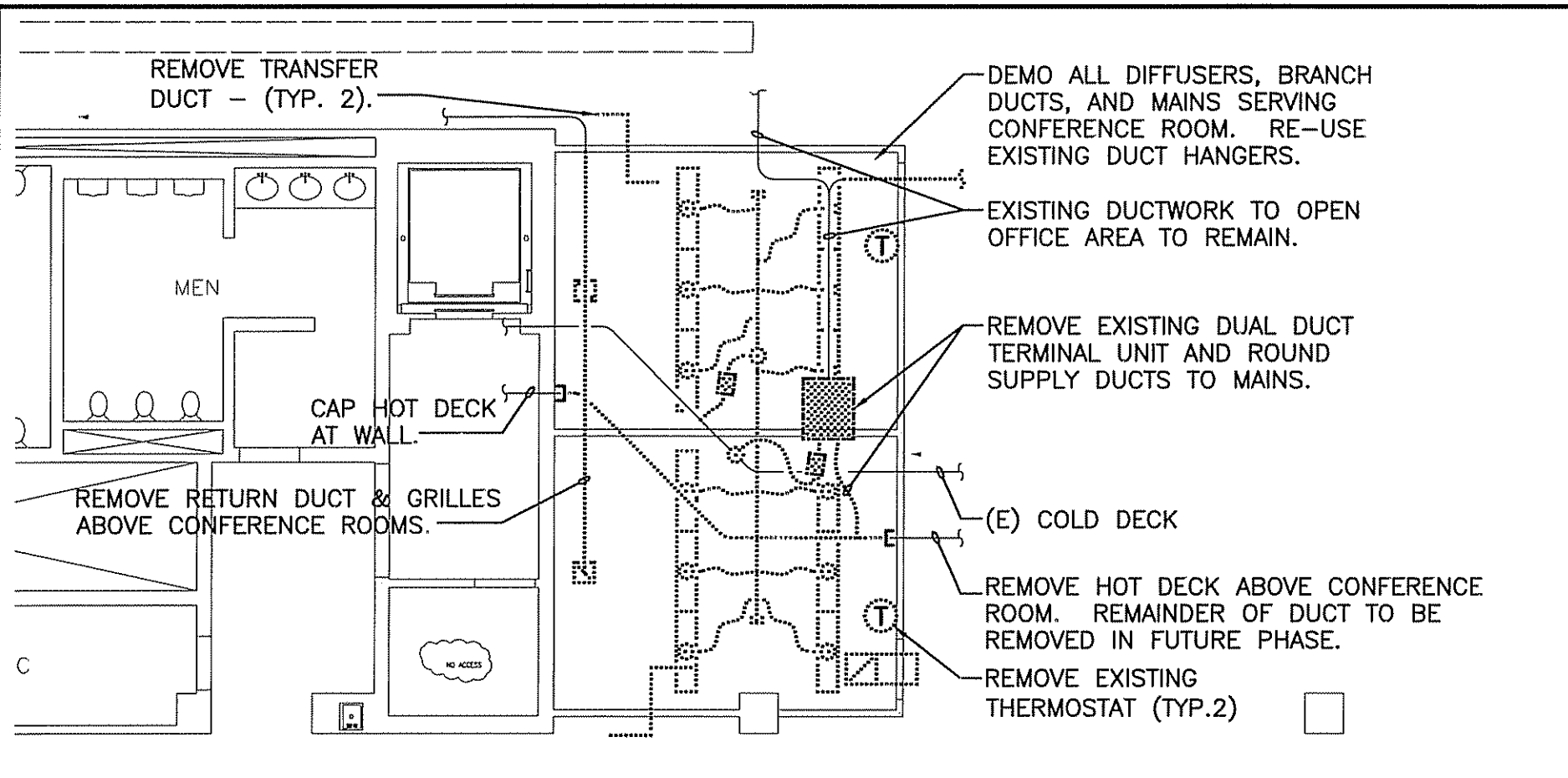

NOTE:

1. SEE SHEET M-001 FOR LEGEND AND ABBREVIATIONS.

2 DEMOLITION PLAN
1/8"=1'-0"

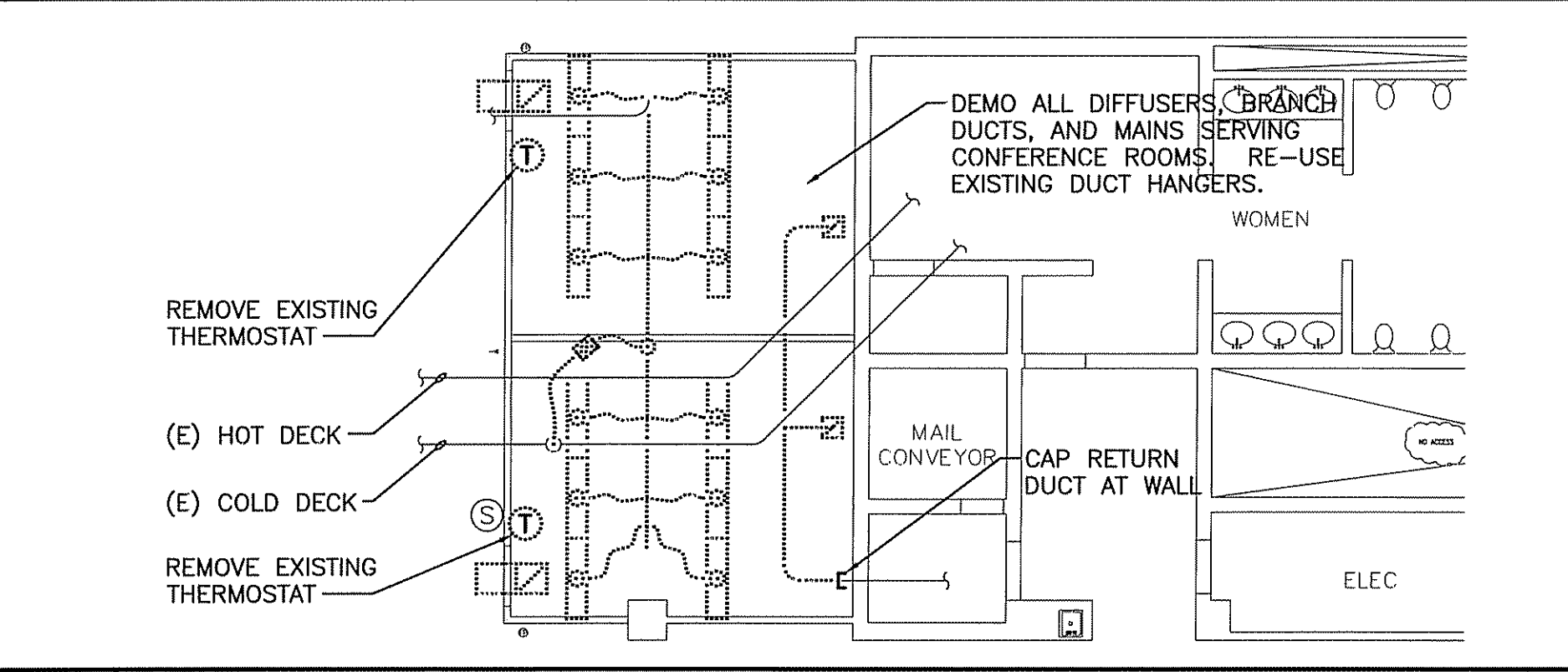

1 DEMOLITION PLAN
1/8"=1'-0"

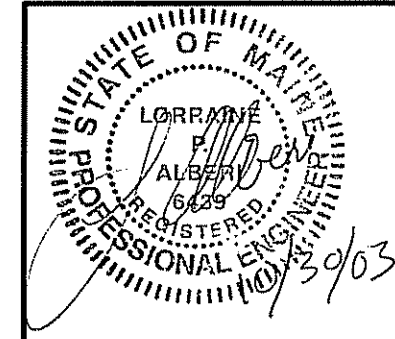

CURRENT ISSUED STATUS: ISSUED FOR CONSTRUCTION-PHASE 1 10-30-03		SCALE: AS NOTED	JC/DRAWN BY: BGG	BGG	DATE: 10-30-03
PROJECT MANAGER: JLH	A/E OF RECORD: LPA	SMRT CAD FILE: MD101-03100	PROJECT No: 03100	DATE: 10-30-03	
PROJECT: UNIMPROVIDENT HO1 2ND FLOOR OFFICE RENOVATION PORTLAND, MAINE		SHEET TITLE: CONFERENCE ROOM DEMOLITION PLANS			
REV	DESCRIPTION	DATE			
0	ISSUED FOR CONST.-PHASE1	10-30-03			

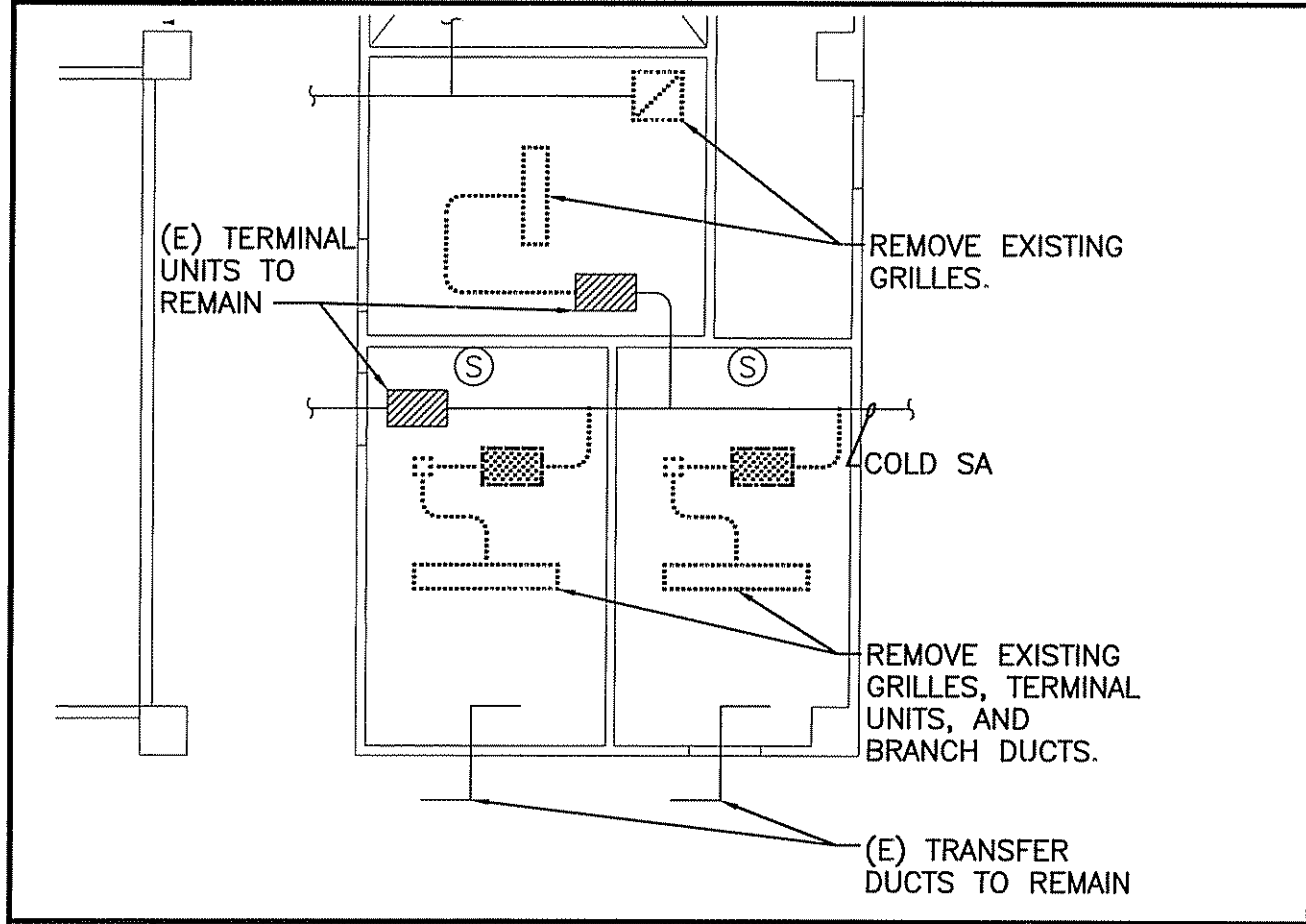

2 DEMOLITION PLAN

1/8"=1'-0"

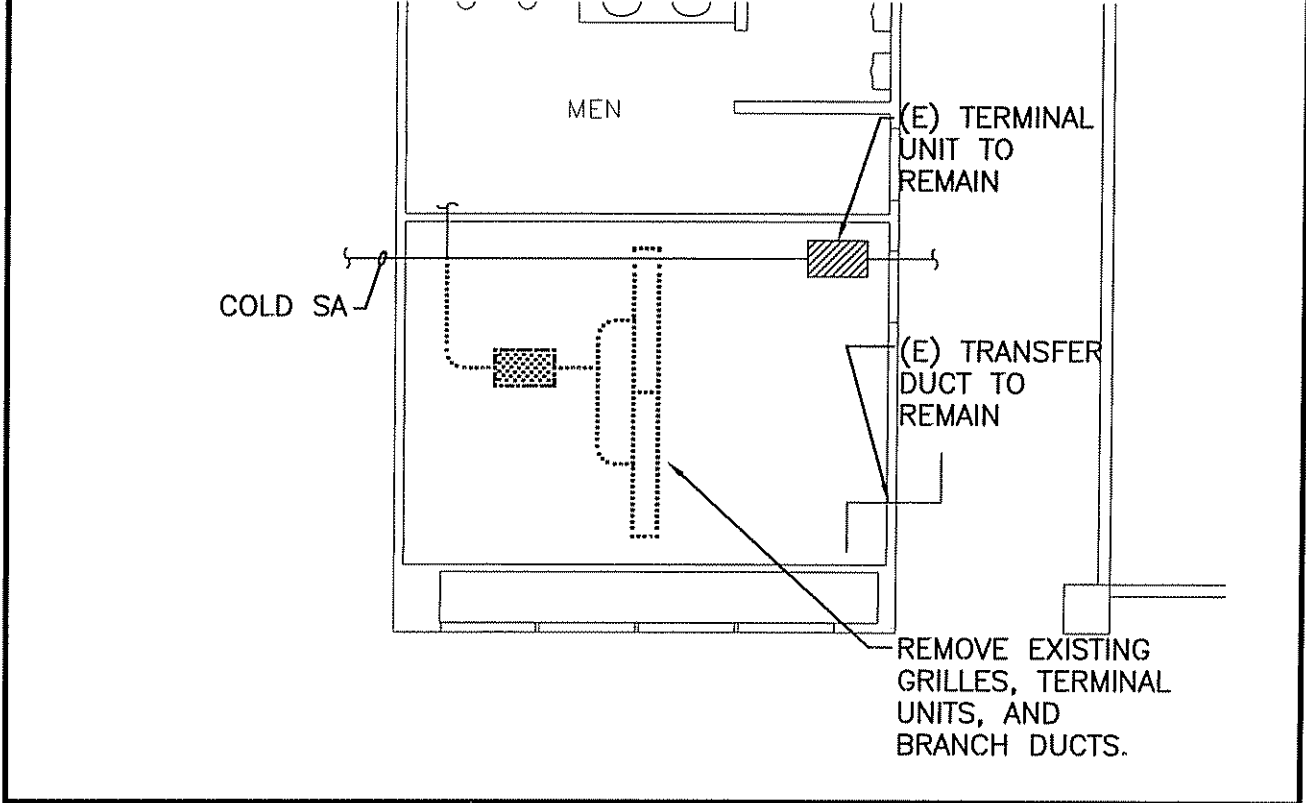

1 DEMOLITION PLAN

1/8"=1'-0"

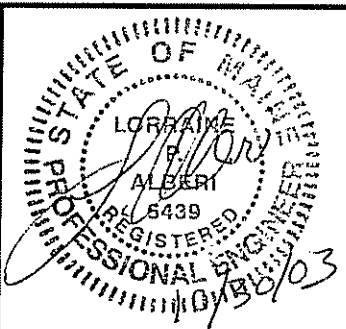

CURRENT ISSUED STATUS:		ISSUED FOR CONSTRUCTION-PHASE 1		10-30-03	
SCALE:	AS NOTED	JC/DRAWN BY:	CAH	DATE: 10-30-03	
PROJECT MANAGER:	JLH	A/E OF RECORD:	LPA	SMRT CAD FILE: MD102-03100	
SHEET No.	MD102	PROJECT No.:	03100	DATE: 10-30-03	
PROJECT:		UNUMPROVIDENT HO1 2ND FLOOR OFFICE RENOVATION PORTLAND, MAINE		SHEET TITLE: CONFERENCE ROOM DEMOLITION PLANS	
REV	0	DESCRIPTION	ISSUED FOR CONST.-PHASE1	DATE	10-30-03

2 FLOOR PLAN

1/8"=1'-0"

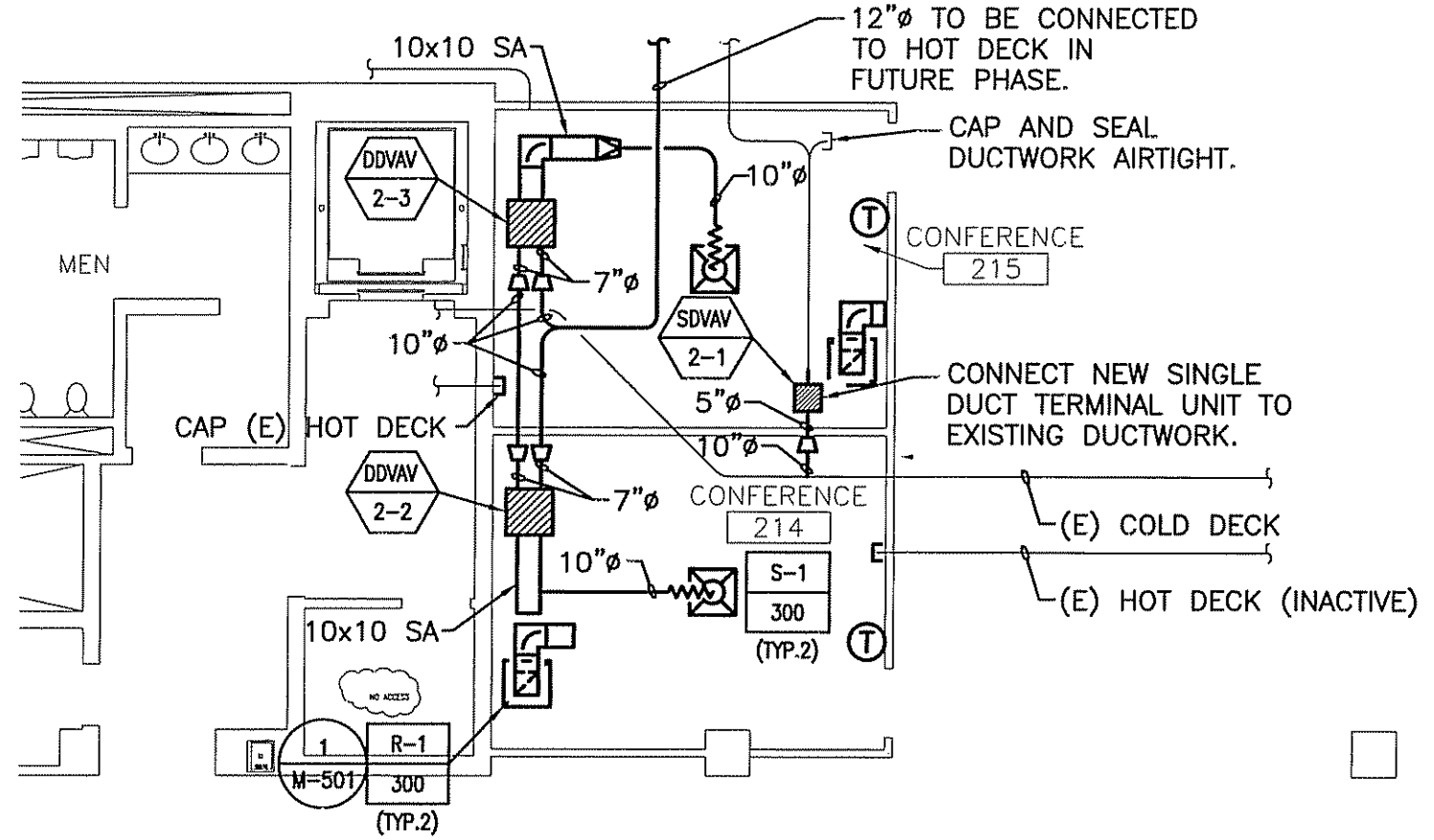

1 FLOOR PLAN

1/8"=1'-0"

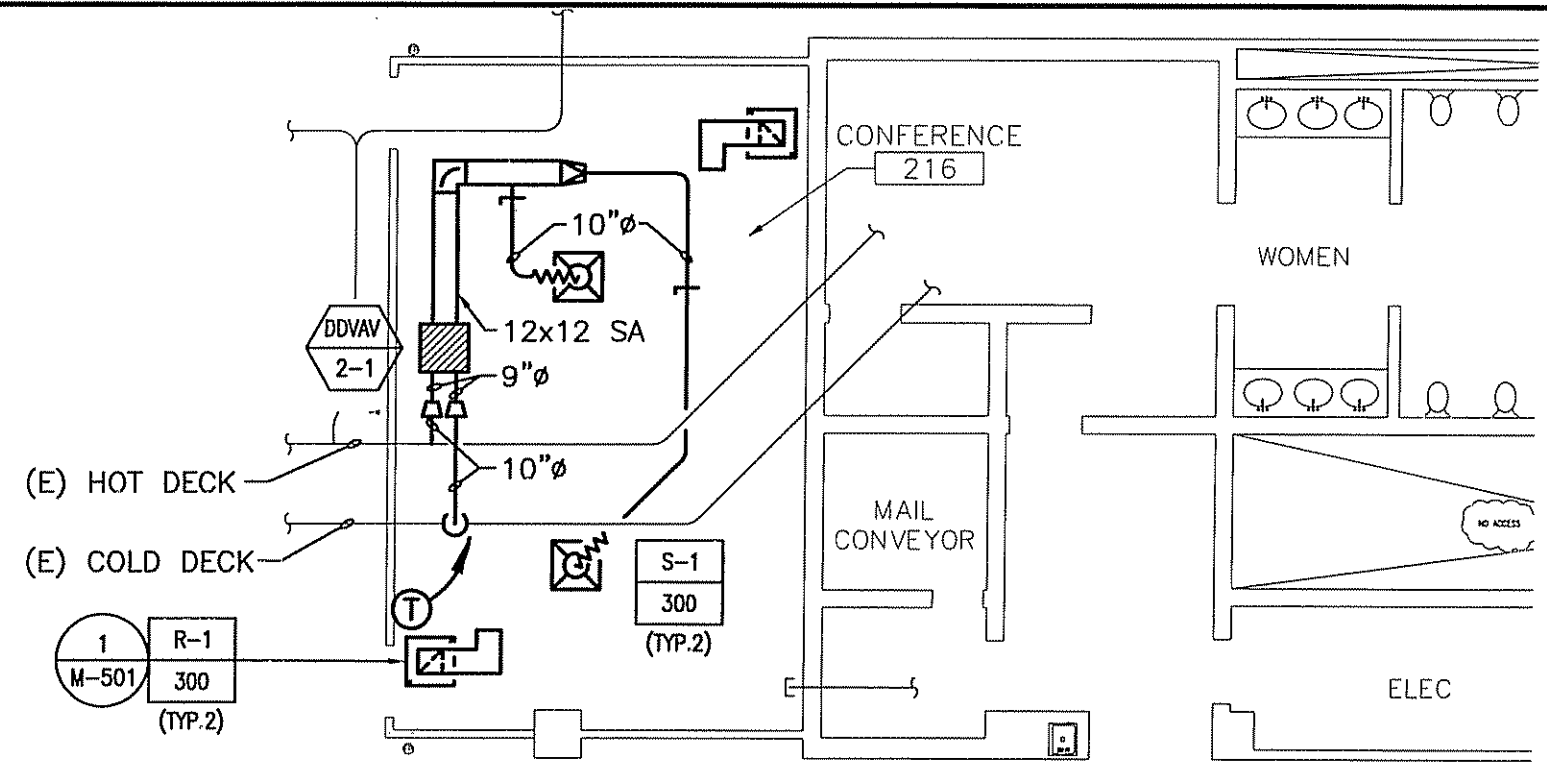

NOTE:

1. SEE SHEET M-001 FOR LEGEND AND ABBREVIATIONS.

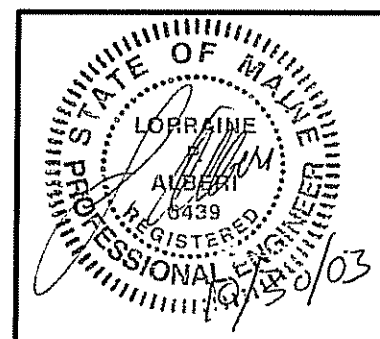

CURRENT ISSUED STATUS:		ISSUED FOR CONSTRUCTION - PHASE 1		PROJECT:	
10-30-03		10-30-03		UNIMPROVIDENT HO1 2ND FLOOR OFFICE RENOVATION PORTLAND, MAINE	
SCALE:	AS NOTED	JC/DRAWN BY:	BGG	SHEET TITLE:	
PROJECT MANAGER:	JLH	A/E OF RECORD:	LPA	CONFERENCE ROOM HVAC PLANS	
SHEET No.	M-101	SMRT CAD FILE:	M-101-03100		
		PROJECT No.:	03100		
		DATE:	10-30-03		
		REV	DESCRIPTION	DATE	
		0	ISSUED FOR CONSTRUCTION - PHASE 1	10-30-03	



ARCHITECTURE ENGINEERING PLANNING
SMRT
144 Fore Street/P.O. Box 618 PORTLAND, MAINE 04104
tel. (207) 772-3846 / fax. (207) 772-1070

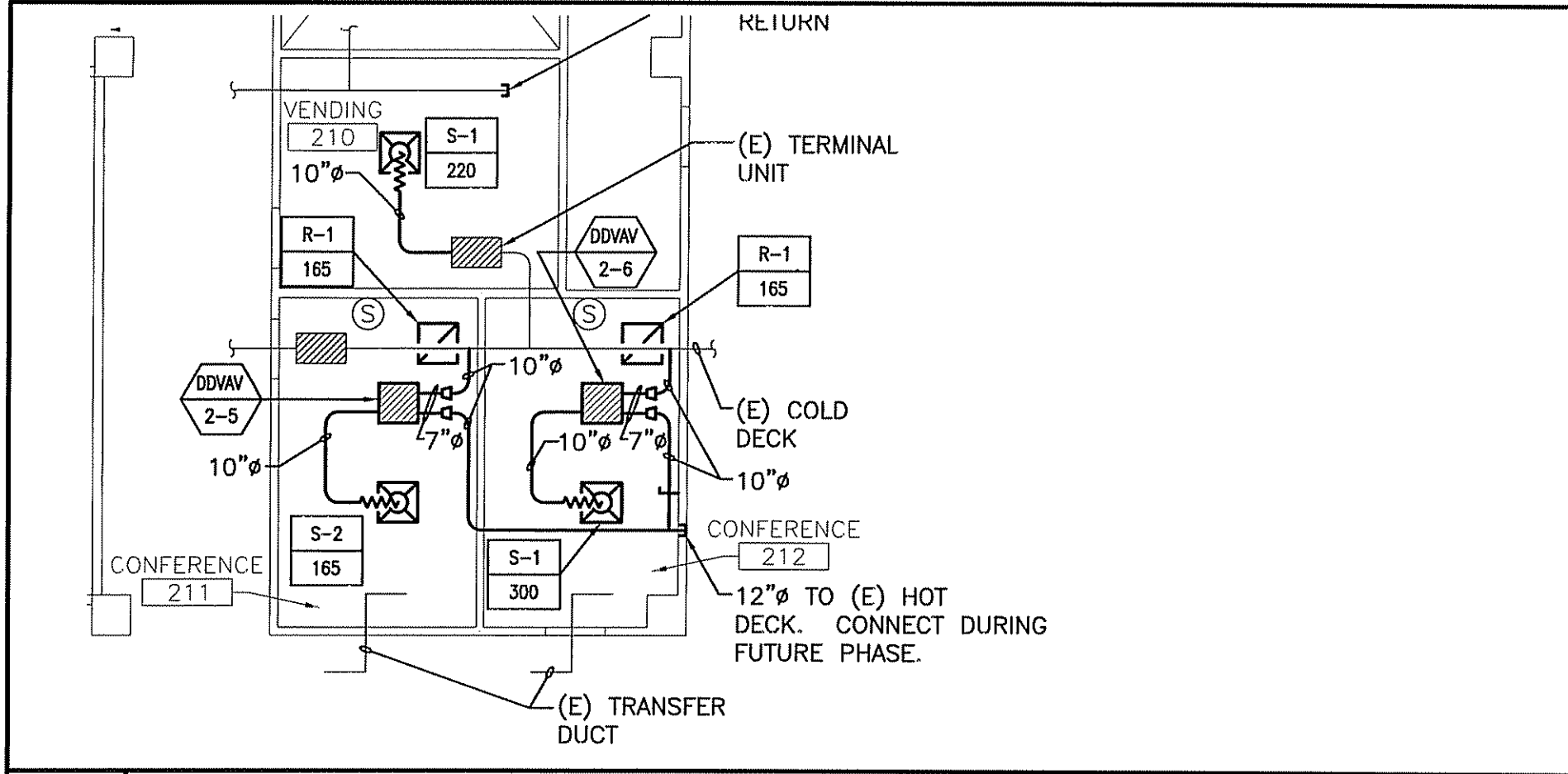

2 FLOOR PLAN
1/8"=1'-0"

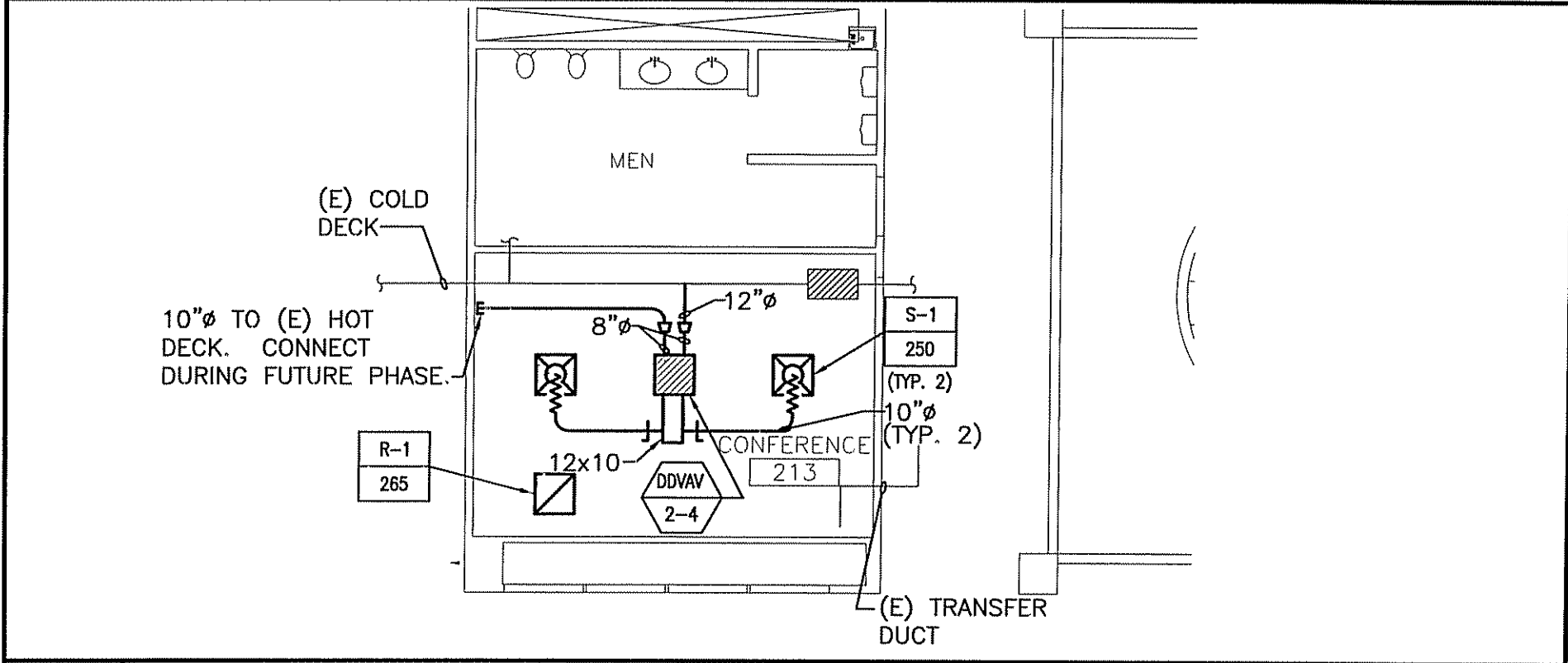

1 FLOOR PLAN
1/8"=1'-0"

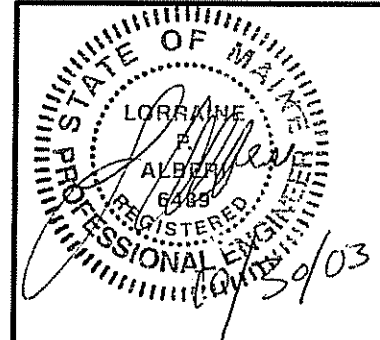

CURRENT ISSUED STATUS: ISSUED FOR CONSTRUCTION-PHASE 1 10-30-03	SCALE: AS NOTED	JC/DRAWN BY: BGG	PROJECT:	ISSUED FOR CONST.-PHASE1	DATE
	PROJECT MANAGER: JLH	A/E OF RECORD: LPA	UNIMPROVIDENT HO1 2ND FLOOR OFFICE RENOVATION PORTLAND, MAINE	0	10-30-03
SHEET No. M-102	SMRT CAD FILE: M-102-03100	PROJECT No: 03100	SHEET TITLE:	REV	DESCRIPTION
© COPYRIGHT 2003 SMRT INC.	DATE: 10-30-03		CONFERENCE ROOM HVAC PLANS		
			ARCHITECTURE ENGINEERING PLANNING SMRT 144 Fore Street/P.O.Box 618 PORTLAND, MAINE 04104 tel. (207) 772-3846 / fax. (207) 772-1070		



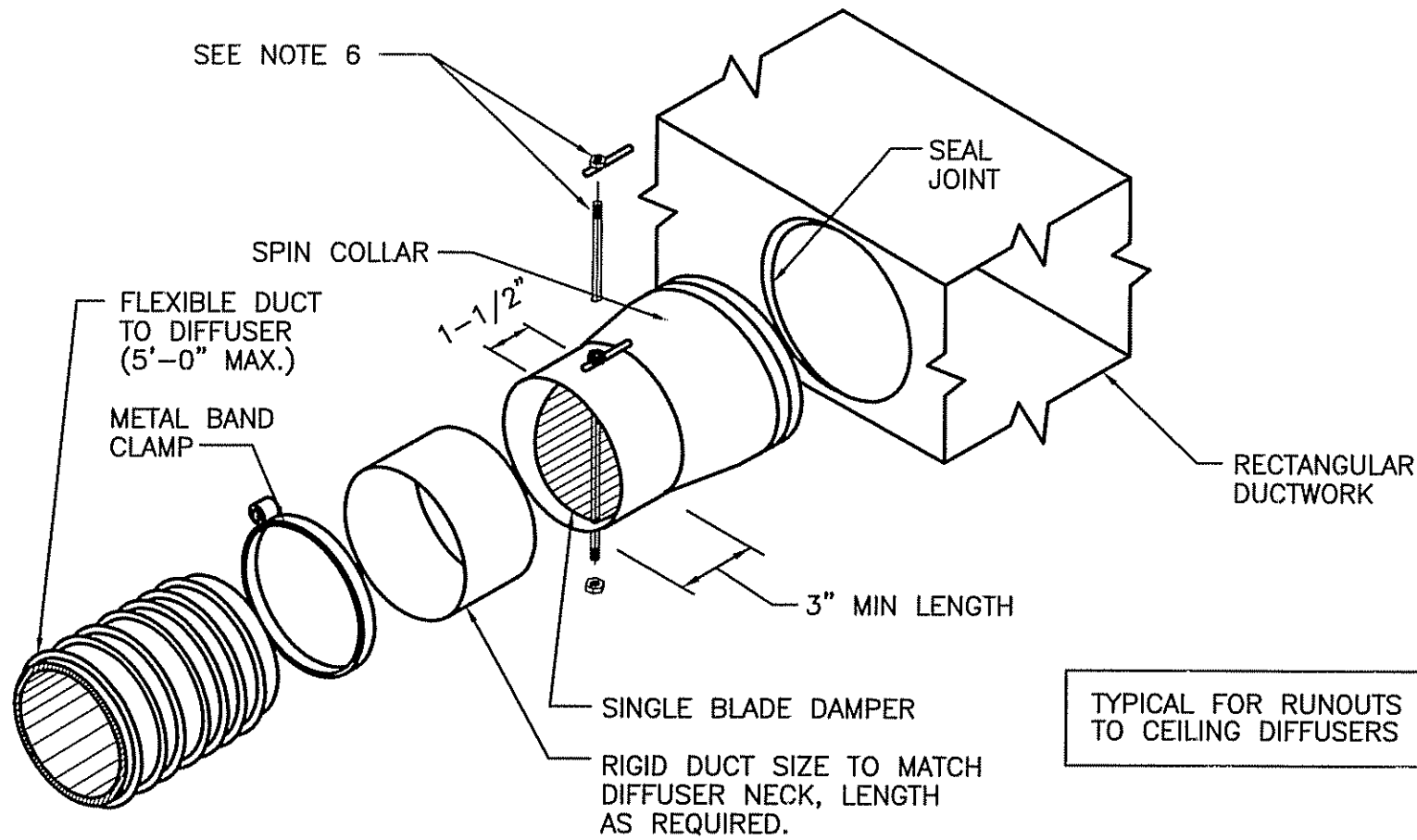

TYPICAL FOR RUNOUTS TO CEILING DIFFUSERS

NOTES:

1. SUPPORT IN ACCORDANCE WITH SMACNA GUIDELINES.
2. BAND FLEX TO COLLAR 1/2" MINIMUM FROM OUTBOARD END OF COLLAR.
3. INSTALL SPIN COLLAR DAMPER IN OPEN POSITION; FINAL ADJUSTMENT BY TAB CONTRACTOR.
4. POP RIVET OR SHEET METAL SCREWS, MINIMUM 3 EA AT 120° INTERVALS, CONNECTING STOVEPIPE TO COLLAR. ENSURE RIVETS OR SCREWS DO NOT INTERFERE W/DAMPER.
5. SEAL JOINTS WITH SPECIFIED SEALANTS TO PREVENT LEAKAGE.
6. INSTALL LOCKING QUADRANT AND HANDLE ON BOTTOM OF DUCT FOR EASY SERVICE (SHOWN ON TOP FOR EASE OF ILLUSTRATION ONLY).
7. SUPPORT FLEXIBLE DUCT TO PREVENT KINKING AND SHARP TURNS.

2

SPIN COLLAR FLEXIBLE DUCT CONNECTOR W/ DAMPER

NOT TO SCALE

RA GRILLE - SEE PLANS & SCHEDULES FOR SIZES & TAGS.

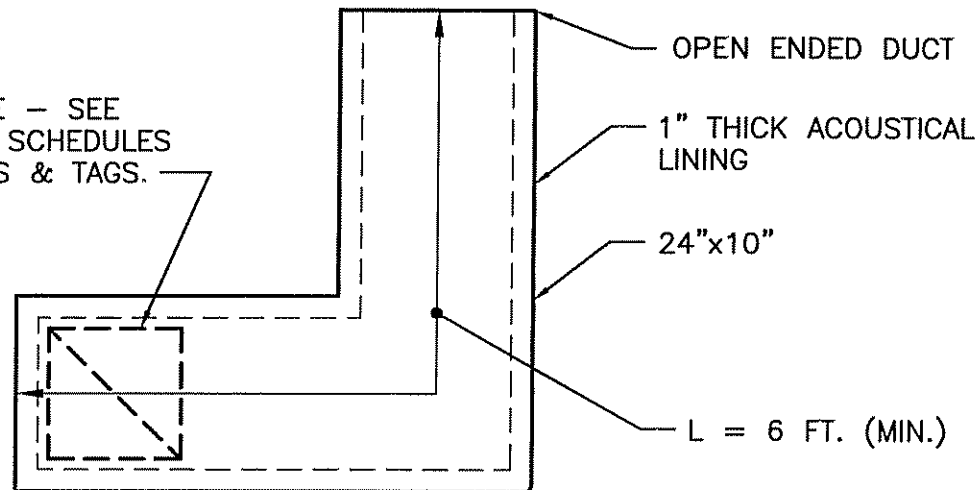

1

ACOUSTICAL RETURN DUCT DETAIL

NOT TO SCALE

PROJECT:	UNUMPROVIDENT HO1 2ND FLOOR OFFICE RENOVATION PORTLAND, MAINE	REV	0	ISSUED FOR CONST.-PHASE1	10-30-03	DATE
SHEET TITLE:	DETAILS	DESCRIPTION				
CURRENT ISSUED STATUS:	ISSUED FOR CONSTRUCTION-PHASE 1 10-30-03	SCALE:	NOT TO SCALE	JC/DRAWN BY:	CAH	
		PROJECT MANAGER:	JLH	A/E OF RECORD:	LPA	
		SHEET No.	M-501	SMRT CAD FILE:	M-501-03100	
				PROJECT No.:	03100	
				DATE:	10-30-03	

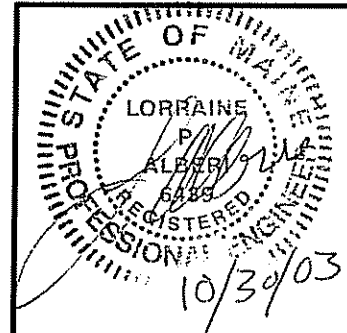

ARCHITECTURE ENGINEERING PLANNING
SMRT
144 Fore Street/P.O. Box 618 PORTLAND, MAINE 04104
tel. (207) 772-3846 / fax. (207) 772-1070

SINGLE & DUAL DUCT VAV TERMINAL SCHEDULE

TAG	INLET SIZE		COOLING CFM (MAX)	MINIMUM MIXED CFM	HEATING CFM	MAX. PRESSURE DROP THRU TERMINAL	TITUS MODEL NO.	NOTES:
	COLD	HOT						
DDVAV 2-1	9"	9"	600	600	600	0.18	DEDV-A	①
DDVAV 2-2	7"	7"	300	300	300	0.16	DEDV-A	①
DDVAV 2-3	7"	7"	300	300	300	0.16	DEDV-A	①
DDVAV 2-4	8"	8"	500	500	500	0.36	DEDV-A	①
DDVAV 2-5	7"	7"	300	300	300	0.16	DEDV-A	①
DDVAV 2-6	7"	7"	300	300	300	0.16	DEDV-A	①
SDVAV 2-1	5"	-	350	175	0	0.15	DESV	①

NOTES: ① PROVIDE ATTENUATOR

REGISTER, DIFFUSER & GRILLE SCHEDULE

TAG	MAX CFM	NECK SIZE	TYPE	ΔP	MAX NC	TITUS MODEL NO.	NOTES
S-1	300	10"φ	24x24 LAY-IN	0.08"	15	TDC 12x12 A4	①
S-2	210	8"φ	24x24 LAY-IN	0.06"	15	TDC 12x12 A4	①
R-1	400	12x12	24x24 LAY-IN	0.037"	12	50F	①

NOTES: ① WHITE FINISH

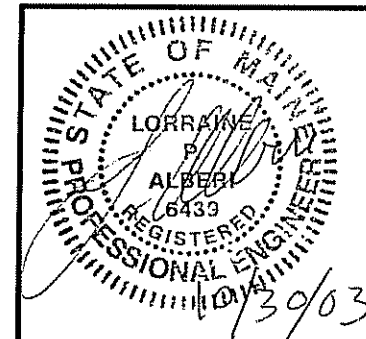













PROJECT: UNUMPROVIDENT HO1 2ND FLOOR OFFICE RENOVATION PORTLAND, MAINE	SHEET TITLE: SCHEDULES	CURRENT ISSUED STATUS: ISSUED FOR CONSTRUCTION-PHASE 1 10-30-03	SCALE: NOT TO SCALE PROJECT MANAGER: JLH SHEET No. M-601	JC/DRAWN BY: CAH A/E OF RECORD: LPA SMRT CAD FILE: M-601-03100 PROJECT No: 03100 DATE: 10-30-03	REV: 0 DESCRIPTION: ISSUED FOR CONST.-PHASE 1 DATE: 10-30-03
---	----------------------------------	---	---	---	--





ARCHITECTURE ENGINEERING PLANNING
 SMRT
 144 Fore Street/P.O. Box 618 PORTLAND, MAINE 04104
 tel. (207) 772-3846 / fax. (207) 772-1070

GENERAL NOTES:

1. ALL WORK SHALL BE PERFORMED IN ACCORDANCE WITH NFPA-70, NATIONAL ELECTRICAL CODE (NEC).
2. ALL MOTOR SAFETY SWITCHES, DISCONNECTS AND MOTOR STARTERS ARE PROVIDED BY DIVISION 16000 UNLESS NOTED AS FURNISHED WITH EQUIPMENT (FWE).
3. UNLESS OTHERWISE NOTED CONVENIENCE RECEPTACLES SHALL BE MOUNTED 18-INCHES AFF, LIGHTING TOGGLE SWITCHES 48-INCHES AFF, DATA SYSTEM OUTLETS 18-INCHES AFF, FIRE ALARM NOTIFICATION DEVICES 80-INCHES AFF OR 6-INCHES BELOW CEILING, WHICHEVER IS LOWER, AND FIRE ALARM MANUAL PULL STATIONS 48-INCHES AFF TO TOP OF DEVICE.
4. ALL PENETRATIONS THROUGH FLOORS, RATED WALLS AND PARTITIONS SHALL BE SEALED WITH A UL APPROVED FIRE SEALANT MATERIAL TO MAINTAIN THE RATING OF THE SEPARATION.
5. ALL ENCLOSURES, CONDUIT BODIES AND THEIR COVERS CONTAINING FIRE ALARM SYSTEM CONDUCTORS SHALL BE PAINTED RED.
6. AN EQUIPMENT GROUNDING CONDUCTOR SHALL BE INSTALLED WITH EVERY FEEDER AND BRANCH CIRCUIT.
7. UNLESS OTHERWISE NOTED WIRING SHALL BE 2 #12 AWG CONDUCTORS & #12 GND. HOME RUNS FED FROM 20A-1P CIRCUITS IN EXCESS OF 100 FEET SHALL BE #10 AWG.
8. LIGHTING TOGGLE SWITCHES SHALL BE COMMERCIAL SPECIFICATION GRADE 120/277 VOLT, SIDE WIRED AND PROVIDED WITH GROUNDING SCREW. 20 OR 30 AMP AS REQUIRED. LEVITON, PASS AND SEYMOUR OR APPROVED EQUAL. COORDINATE COLOR WITH ARCHITECT.
9. CONVENIENCE RECEPTACLES SHALL BE COMMERCIAL SPECIFICATION GRADE GROUNDING TYPE NEMA 5-20R, SIDE WIRED. LEVITON, PASS AND SEYMOUR OR APPROVED EQUAL. COORDINATE COLOR WITH ARCHITECTS.
10. ALL WIRING SHALL BE 600V, COPPER WITH THHN/THWN INSULATION.
11. PROVIDE UPDATED TYPED PANEL SCHEDULES FOR ALL PANELS BEING MODIFIED. BREAKERS BECOMING SPARE UPON THE REMOVAL OF EQUIPMENT OR DEVICES TO BE LABELLED AS "SPARE".

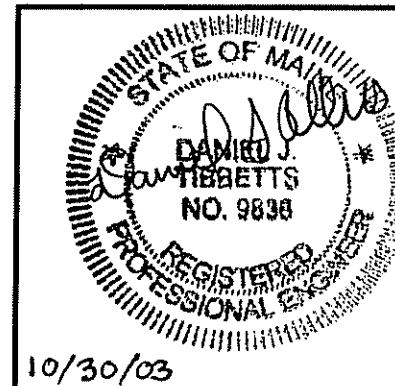
-  4' INDIRECT FIXTURE
-  2x4 LIGHT FIXTURE
-  FIXTURE WIRED TO UNSWITCHED EMERGENCY CIRCUIT
-  2x2 FIXTURE
-  DUAL HEAD EMERGENCY LIGHT BATTERY PACK
-  OCCUPANCY SENSOR
-  DUAL LEVEL SWITCH
-  DUPLEX RECEPTACLE, NEMA 5-20R.
-  PHOTOELECTRIC SMOKE DETECTOR. CEILING MOUNTED
-  FIRE ALARM VISIBLE ONLY NOTIFICATION APPLIANCE
-  FIRE ALARM AUDIBLE/VISIBLE NOTIFICATION
-  VOICE/DATA SYSTEM OUTLET



PROJECT:	UNUMPROVIDENT HO1 2ND FLOOR OFFICE RENOVATION PORTLAND, MAINE	SHEET TITLE:	LEGEND AND GENERAL NOTES	
CURRENT ISSUED STATUS:	ISSUED FOR CONSTRUCTION PHASE 1 10-30-03	SCALE:	1/8" = 1'-0"	DATE:
PROJECT MANAGER:	JLH	JC/DRAWN BY:	LAM	REV
SHEET No.	E-001	A/E OF RECORD:	DJT	0
		SMRT CAD FILE:	E-001-03100	ISSUED FOR CONST. - PHASE 1
		PROJECT No.:	03100	DESCRIPTION
		DATE:	10-30-03	10-30-03
				DATE
		 ARCHITECTURE ENGINEERING PLANNING SMRT 144 Fore Street/P.O. Box 618 PORTLAND, MAINE 04104 tel. (207) 772-3846 / fax. (207) 772-1070		

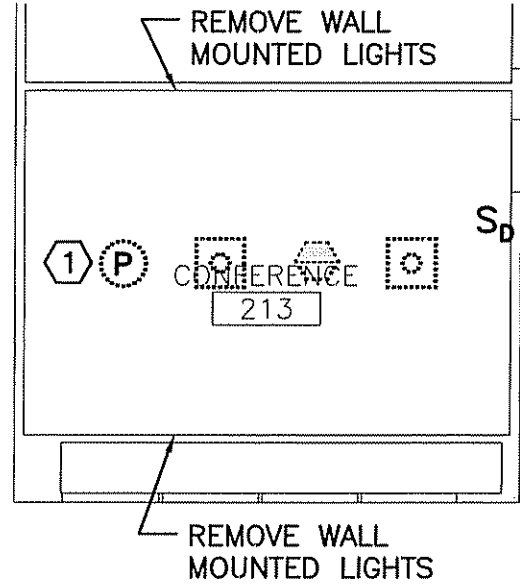

C1 PART. REFLECTED CEILING PLAN

1/8"=1'-0"

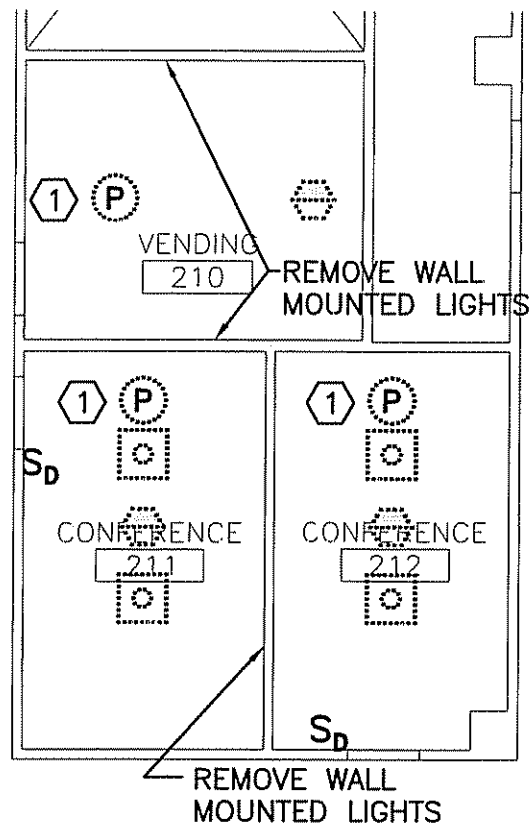

C4 PART. REFLECTED CEILING PLAN

1/8"=1'-0"

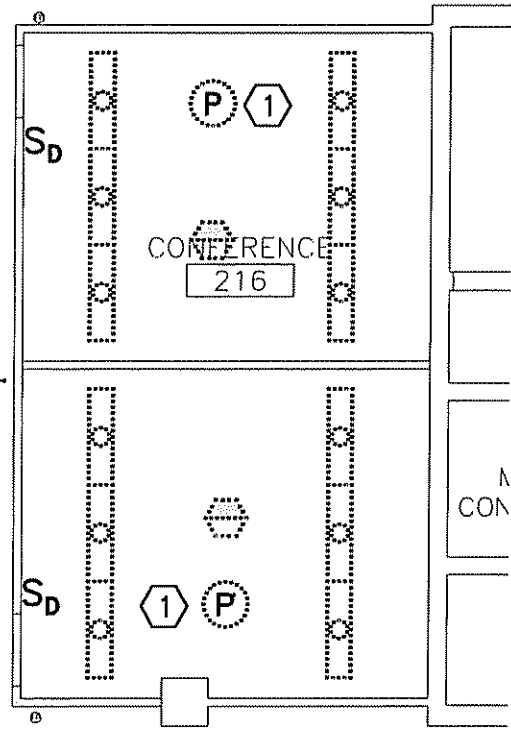

A1 PART. REFLECTED CEILING PLAN

1/8"=1'-0"

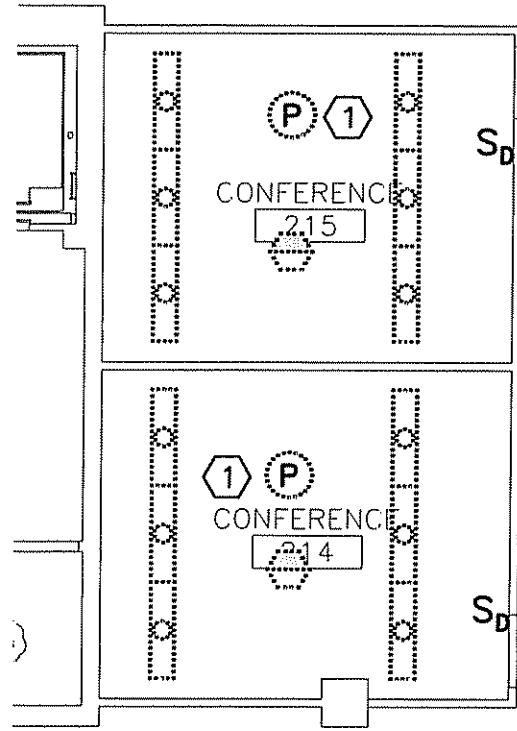

A4 PART. REFLECTED CEILING PLAN

1/8"=1'-0"

NOTE:

1. SEE SHEET E-001 FOR LEGEND AND GENERAL NOTES.

KEYED NOTE:

① RELOCATE SMOKE DETECTOR AT LOCATION SHOWN ON E-101.

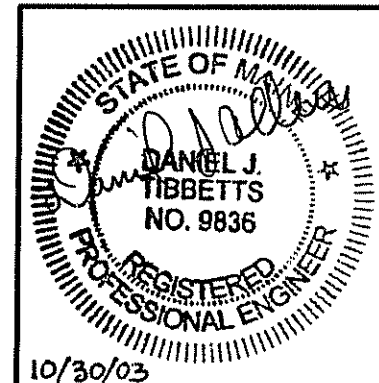

CURRENT ISSUED STATUS:

ISSUED FOR CONSTRUCTION-PHASE 1
10-30-03

SCALE: 1/8"=1'-0"
PROJECT MANAGER: JLH
SHEET No. **ED101**
JC/DRAWN BY: LAM
A/E OF RECORD: DJT
SMRT CAD FILE: ED101-03100
PROJECT No: 03100
DATE: 10-30-03

PROJECT:
UNIMPROVIDENT HO1
2ND FLOOR OFFICE RENOVATION
PORTLAND, MAINE

SHEET TITLE:
ELECTRICAL
DEMOLITION PLAN

REV	DESCRIPTION	DATE
0	ISSUED FOR CONST.-PHASE1	10-30-03

ARCHITECTURE ENGINEERING PLANNING
SMRT
144 Fore Street/P.O.Box 618 PORTLAND, MAINE 04104
tel. (207) 772-3846 / fax. (207) 772-1070



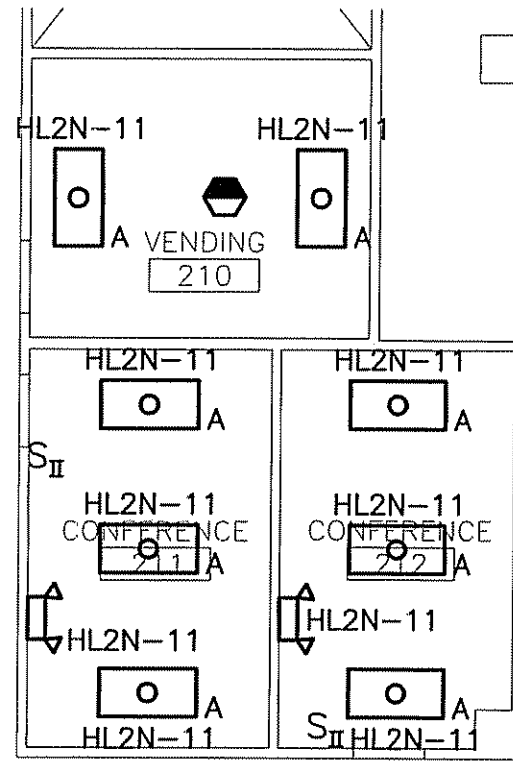
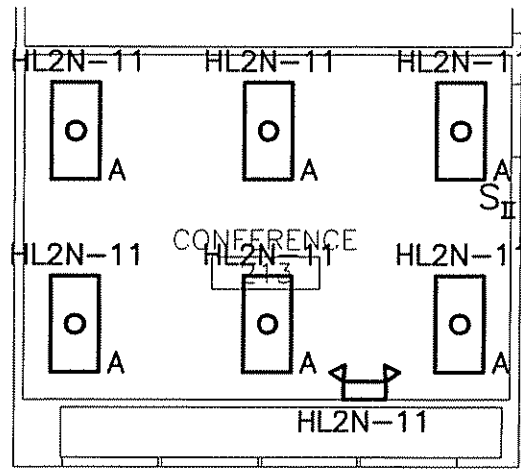

NOTE:

1. SEE SHEET E-001 FOR LEGEND AND GENERAL NOTES.
2. USE EXISTING 20, 1P SPARE CIRCUIT BREAKERS IN PANELBOARDS HL2E, HL2W AND HL2N FOR NEW LIGHTING SHOWN. COORDINATE WITH OWNER FOR LOCATIONS OF PANELBOARDS.

LIGHT FIXTURE SCHEDULE					
TYPE	DESCRIPTION	MFR.	LAMPS	MOUNTING	NOTES
A	2x4 PARABOLIC TROFFER W/ SEMI-SPECULAR REFLECTOR, 18 CELL, 3" DEEP LOUVER. 277V	COLUMBIA P424 SERIES	3-F32T8 3500K	RECESSED	PROVIDE FOR DUAL LEVEL IN CONFERENCE RM LIGHTS
	EMERGENCY LIGHTING UNIT W/ MAINT. FREE BATTERY & SELF TESTING ELECTRONICS 277V	PRESCOLITE EDS4 SERIES	INTEGRAL W/UNIT	WALL	

C1 PART. REFLECTED CEILING PLAN

C4 PART. REFLECTED CEILING PLAN

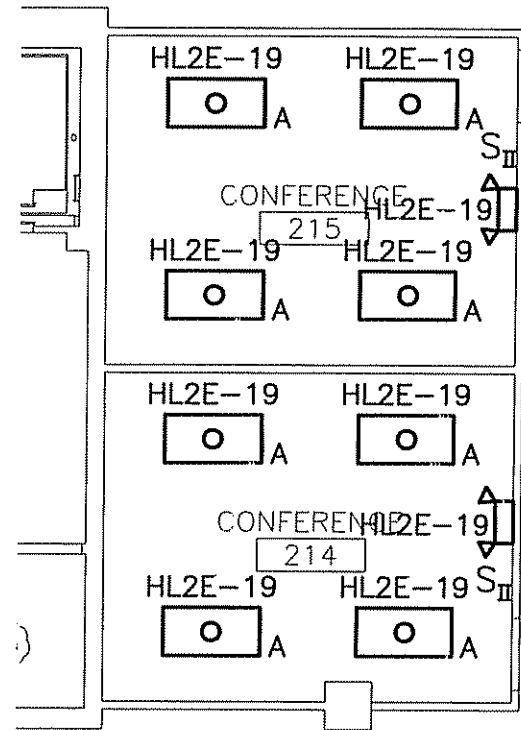
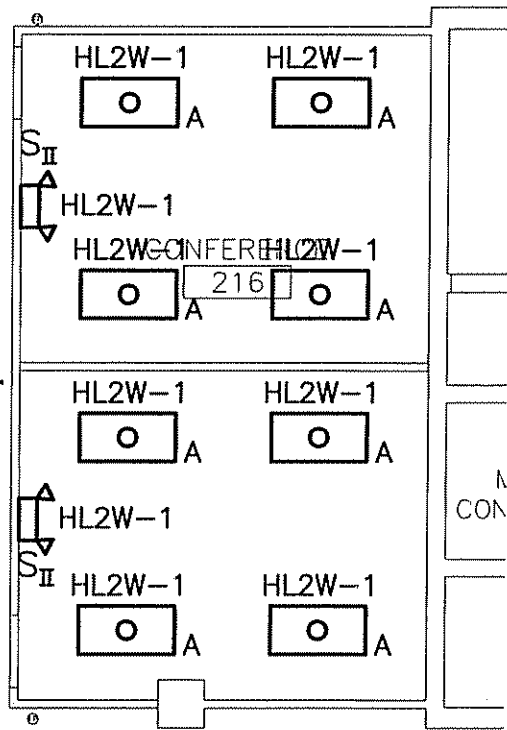

A1 PART. REFLECTED CEILING PLAN

A4 PART. REFLECTED CEILING PLAN

ISSUED FOR CONSTRUCTION - PHASE 1	10-30-03	DATE
DESCRIPTION	10-30-03	DATE
REV	0	ISSUED FOR CONSTRUCTION - PHASE 1
DESCRIPTION	10-30-03	DATE

PROJECT: UNIMPROVED HO1 2ND FLOOR OFFICE RENOVATION PORTLAND, MAINE

SHEET TITLE: LIGHTING PLANS

CURRENT ISSUED STATUS: ISSUED FOR CONSTRUCTION - PHASE 1 10-30-03

SCALE: 1/8"=1'-0"

PROJECT MANAGER: JLH

SHEET No. E-101

JC/DRAWN BY: LAM

A/E OF RECORD: DJT

SMRT CAD FILE: E-101-03100

PROJECT No: 03100

DATE: 10-30-03

© COPYRIGHT 2003 SMRT INC.



ARCHITECTURE ENGINEERING PLANNING
SMRT
144 Fore Street/P.O. Box 618 PORTLAND, MAINE 04104
tel. (207) 772-3846 / fax. (207) 772-1070

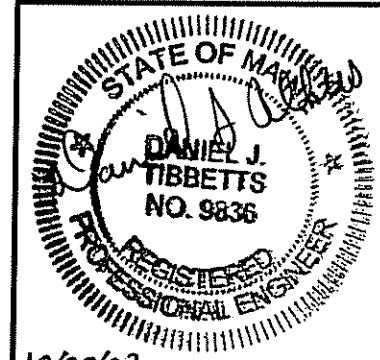

10/30/03

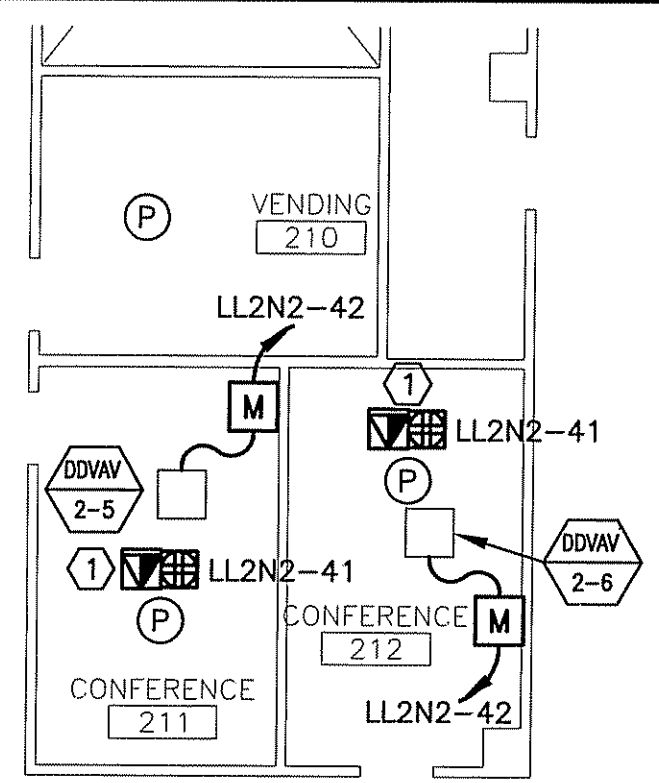
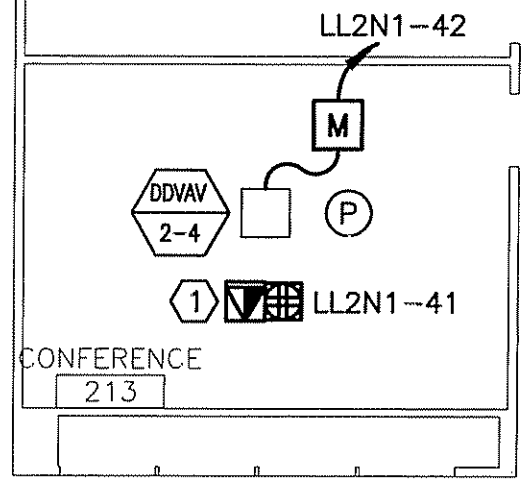

NOTE:
1. SEE SHEET M-001 FOR LEGEND AND ABBREVIATIONS.

KEYED NOTE:
① PROVIDE FLOOR MOUNTED RECEPTACLE AND VOICE/DATA BOX UNDER CONFERENCE RM. TABLES. COORDINATE WITH OWNER FOR TYPE OF FLOOR BOX REQUIRED FOR EACH LOCATION. MOUNT BOXES IN CENTER OF ROOM.

C1 POWER AND SYSTEMS PLAN

C4 POWER AND SYSTEMS PLAN

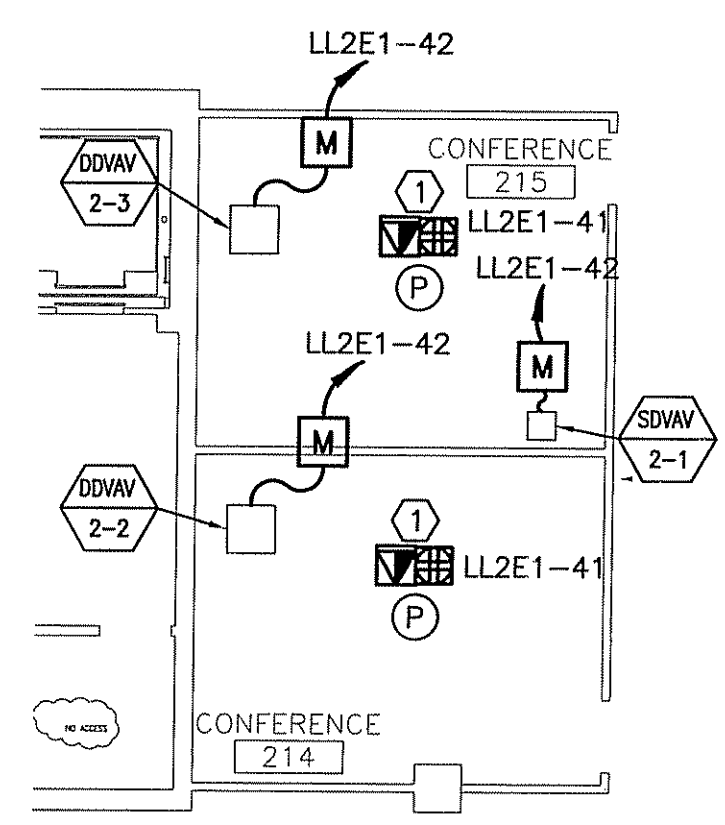
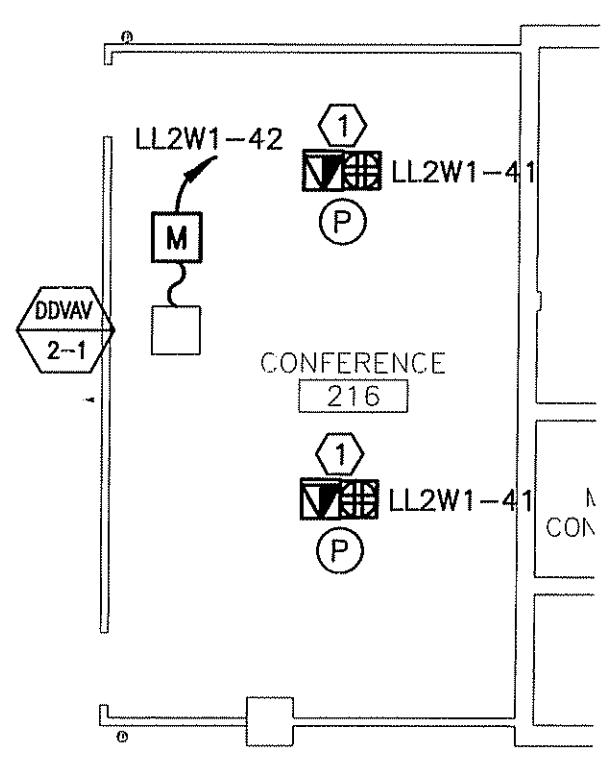

A1 POWER AND SYSTEMS PLAN

A4 POWER AND SYSTEMS PLAN

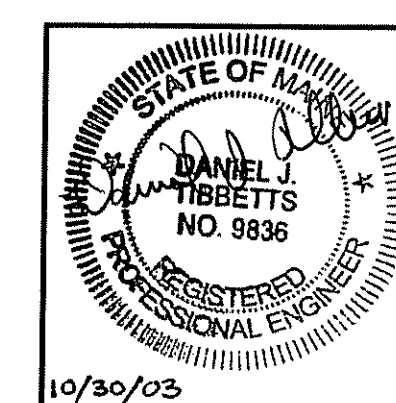

PROJECT:		UNIMPROVIDENT HO1 2ND FLOOR OFFICE RENOVATION PORTLAND, MAINE	
SHEET TITLE:		POWER & SYSTEMS PLAN	
CURRENT ISSUED STATUS:	ISSUED FOR CONST.-PHASE1	DATE:	10-30-03
SCALE:	1/8"=1'-0"	JC/DRAWN BY:	LAM
PROJECT MANAGER:	JLH	A/E OF RECORD:	DJT
SHEET No.	E-102	SMRT CAD FILE:	E-102-03100
		PROJECT No.:	03100
		DATE:	10-30-03



ARCHITECTURE ENGINEERING PLANNING
SMRT
144 Fore Street/P.O. Box 618 PORTLAND, MAINE 04104
tel. (207) 772-3846 / fax. (207) 772-1070