

**Illuminated Cabinet/Push thru Letters**  
Secondary Color Scheme

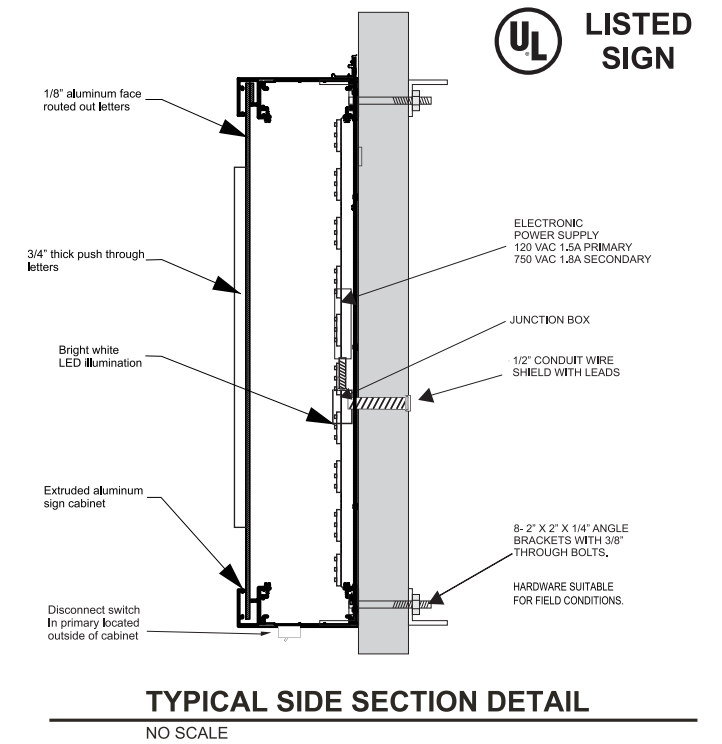

PROPOSED

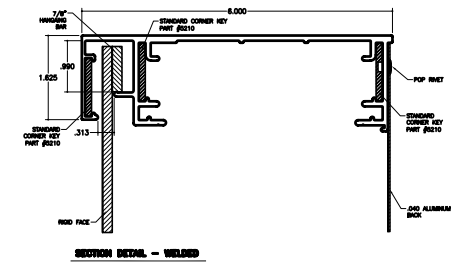

**Wall Cabinet - Push-thru Letters**

Fabricated 3" deep alum. housing with routed face painted to match PMS 540C..  
Spectrum copy and Forward Symbol are 3/4" push-thru acrylic with first surface translucent with vinyl.  
LED Illumination.



Scale: 1/4"=1'-0"  
Sq.Ft.: 37.9



38 Elm Street Meriden, CT 06450  
Call: 203-634-4331 Fax: 203-630-2780  
www.shinersigns.com

COLORS

**Primary Brand Colors**

Spectrum  
PMS 540C  
3M 3630-137

Forward Symbol  
PMS 3005C  
3M 3630-337

**Secondary Color**  
Spectrum/  
Forward Symbol

White  
#7328 White Acrylic

Spectrum  
118 Johnson Rd.  
Portland, ME 04102

Drawing Date: 8/10/2017  
Drawing Number: 347031-1  
Drawing by: TH  
Page 1 of 3

**Signage Approval**

- Approved
- Approved As Noted
- Not Approved -revise As Noted

**Client Approval Signature & Date:**

This drawing is the property of Shiner Signs, Inc. and all rights to its use for reproduction are strictly reserved by Shiner Signs, Inc.

**Illuminated Cabinet/Push thru Letters**  
Secondary Color Scheme



PROPOSED

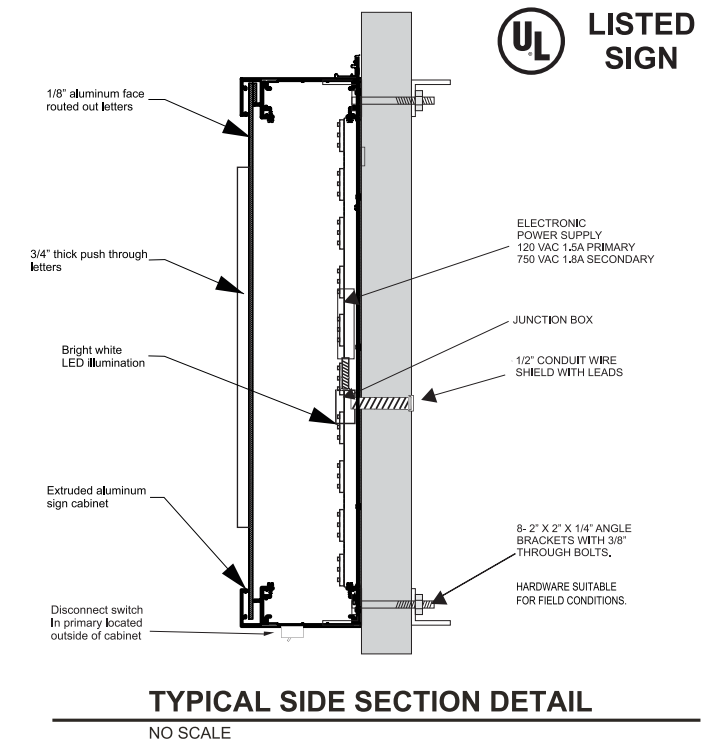
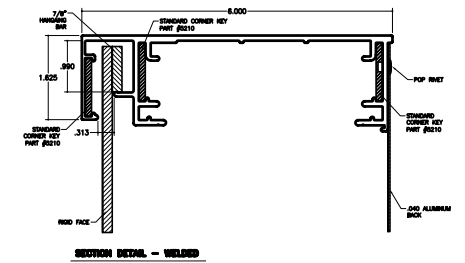

**Wall Cabinet - Push-thru Letters**

Fabricated 3" deep alum. housing with routed face painted to match PMS 540C..  
Spectrum copy and Forward Symbol are 3/4" push-thru acrylic with first surface translucent with vinyl.  
LED Illumination.



Scale: 1/4"=1'-0"  
Sq.Ft.: 37.9

COLORS

**Primary Brand Colors**

Spectrum  
PMS 540C  
3M 3630-137

Forward Symbol  
PMS 3005C  
3M 3630-337

**Secondary Color**  
Spectrum/Forward Symbol

White  
#7328 White Acrylic

Spectrum  
118 Johnson Rd.  
Portland, ME 04102

Drawing Date: 8/10/2017  
Drawing Number: 347031-1  
Drawing by: TH  
Page 2 of 3

**Signage Approval**

- Approved  
 Approved As Noted  
 Not Approved -revise As Noted

**Client Approval Signature & Date:**

This drawing is the property of Shiner Signs, Inc. and all rights to its use for reproduction are strictly reserved by Shiner Signs, Inc.



38 Elm Street Meriden, CT 06450  
Call: 203-634-4331 Fax: 203-630-2780  
www.shinersigns.com

**Illuminated Cabinet/Push thru Letters**  
Secondary Color Scheme



PROPOSED

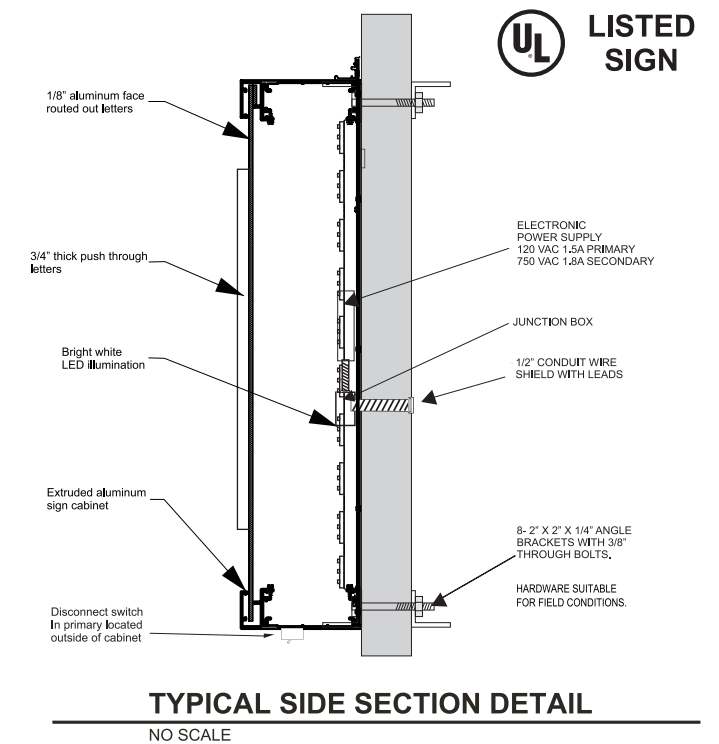
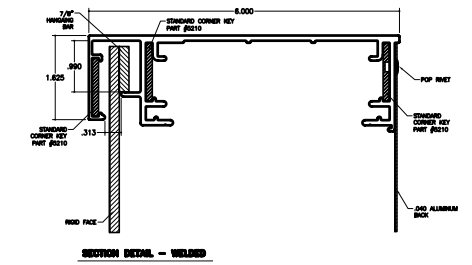

**Wall Cabinet - Push-thru Letters**

Fabricated 3" deep alum. housing with routed face painted to match PMS 540C..  
Spectrum copy and Forward Symbol are 3/4" push-thru acrylic with first surface translucent with vinyl.  
LED Illumination.



Scale: 1/4" = 1'-0"  
Sq.Ft.: 37.9

COLORS

| Primary Brand Colors    |                          | Secondary Color              |
|-------------------------|--------------------------|------------------------------|
|                         |                          |                              |
| PMS 540C<br>3M 3630-137 | PMS 3005C<br>3M 3630-337 | White<br>#7328 White Acrylic |

Spectrum  
118 Johnson Rd.  
Portland, ME 04102

Drawing Date: 8/10/2017  
Drawing Number: 347031-1  
Drawing by: TH  
Page 3 of 3

Signage Approval

- Approved
- Approved As Noted
- Not Approved -revise As Noted

Client Approval Signature & Date:

This drawing is the property of Shiner Signs, Inc. and all rights to its use for reproduction are strictly reserved by Shiner Signs, Inc.



38 Elm Street Meriden, CT 06450  
Call: 203-634-4331 Fax: 203-630-2780  
www.shinersigns.com