

# VALET PARKING LOT

JETPORT BOULEVARD  
PORTLAND, ME 04102

APPLICANT:  
TOYE REALTY  
HOLDINGS III, LLC  
P.O. BOX 6285  
CAPE ELIZABETH, ME 04107

ENGINEER/SURVEYOR:

**SEBAGO**  
TECHNICS

WWW.SEBAGOTECHNICS.COM

75 John Roberts Rd. Suite 1A South Portland, ME 04106  
250 Goddard Rd. Suite B Lewiston, ME 04240  
Tel. 207-200-2100 Tel. 207-783-5656

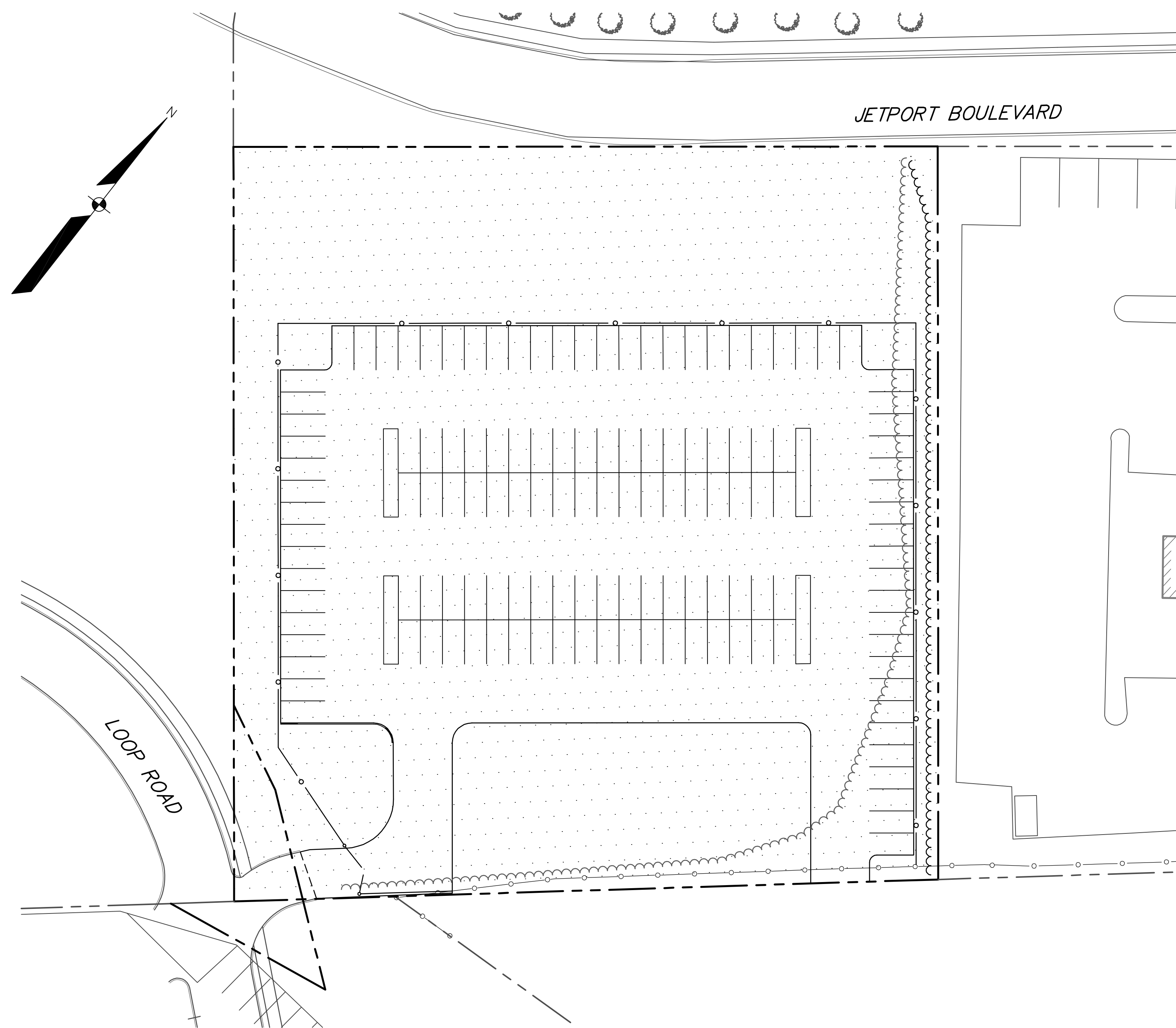

SCALE: 1" = 30'

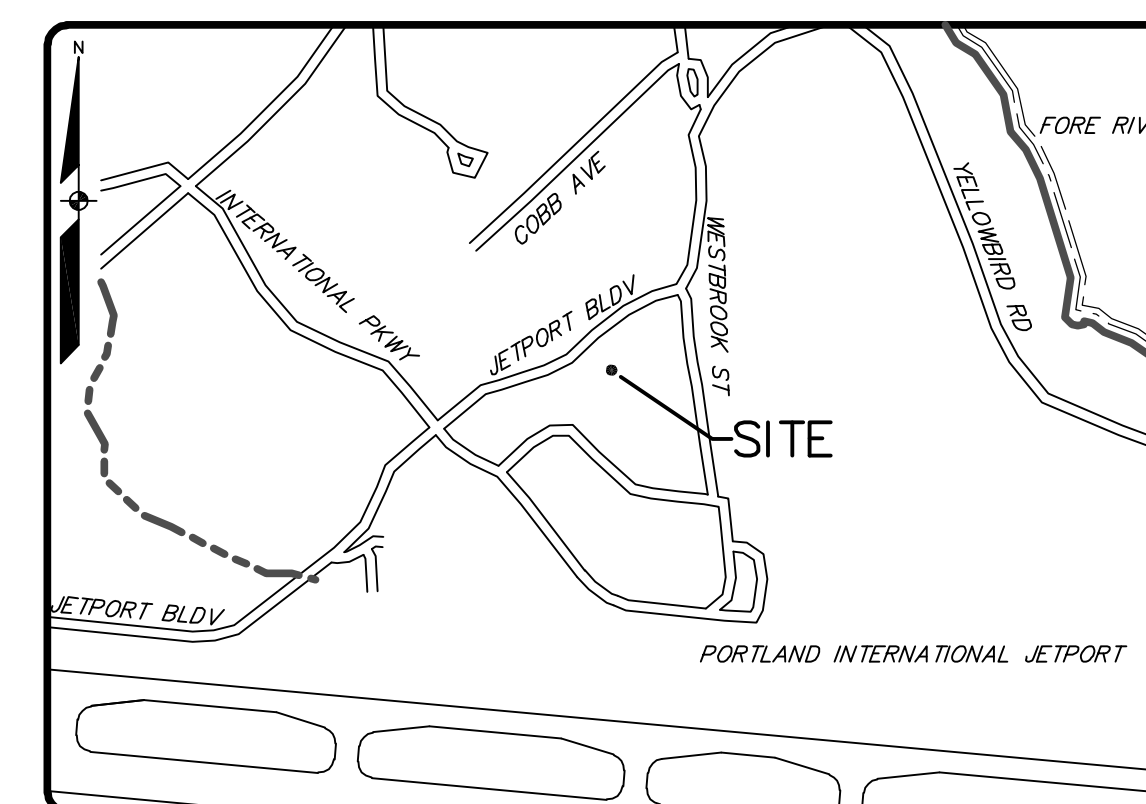

LOCATION MAP

NTS

## INDEX OF PLANS

| SHEET NO. | SHEET TITLE                                     |
|-----------|---|
| 1         | COVER SHEET                                     |
| 2         | SITE IMPROVEMENT PLAN                           |
| 3         | EROSION & SEDIMENT CONTROL PLAN NOTES & DETAILS |
| 4         | DETAILS   |
| 5         | DETAILS   |
| 6         | PRE-DEVELOPMENT WATERSHED PLAN                  |
| 7         | POST-DEVELOPMENT WATERSHED PLAN                 |