

Phillip J. Doughty Assoc., Architects  
 362 U.S. Route One, Falmouth, Maine 04105 • 207.781.5346

REVISION	DATE	DESCRIPTION	BY	APP'D	CHK'D	APPR'D
1	4/22/04	CONFORMED DRAWINGS ISSUED FOR CONSTRUCTION	PHD	[REDACTED]	[REDACTED]	[REDACTED]
2	FEB 29, 2004		PHD	[REDACTED]	[REDACTED]	[REDACTED]

**BECKER**  
 Structural Engineers, Inc.  
 73 York Street  
 Portland, ME 04101-4701  
 Tel: 207-879-1838  
 Fax: 207-879-1822  
 www.beckers.com

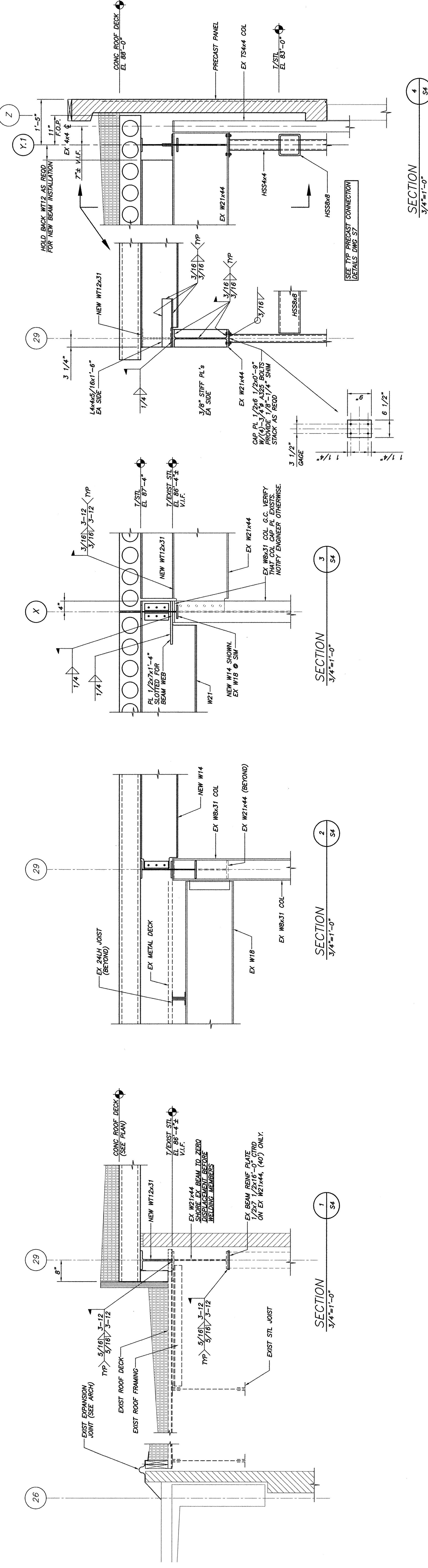

**TYP EXIST CONCRETE OVERHEAD OR VERTICAL REPAIR NOTES**

**PREPARATION:**  
 1. SAWCUT PERIMETER OF DAMAGED AREA TO A DEPTH OF 3/4".  
 2. REMOVE ALL WEAK CONCRETE TO DETERMINE DEPTH OF REPAIR. IF REPAIR IS DEEPER THAN 3/4" (MAX) CHIPPING HAMMER EXCAVATE 3/4" AROUND ALL WEAK CONCRETE. REMOVE ALL WEAK CONCRETE TO A MINIMUM SURFACE PROFILE OF 1/4" (MAX) SURFACE PROFILE OF 1/4" (MAX) SURFACE PROFILE OF 1/4" (MAX). SATURATE SURFACE DRY (SSD) WITH NO STANDING WATER DURING APPLICATION.

**INSPECTION:**  
 1. INSPECT ALL CONCRETE SURFACES PRIOR TO APPLICATION OF ADHESIVE TO INSURE PROPER PREPARATION AND CONFORM TO ALL THE MANUFACTURER'S PREPARATION INSTRUCTIONS.  
 2. IF REPAIR LOSS OF REINFORCEMENT, IF SECTION LOSS EXCEEDS 25%, NOTIFY ENGINEER PRIOR TO PROCEEDING WITH PATCH. SEE TYPICAL DETAIL THIS DWG.

**REPAIR:**  
 1. ALL REINFORCEMENT SHALL BE PRIMED OR EPOXY COATED WITH A CARBON FIBER PATCH MATERIAL AS PER MANUFACTURER'S INSTRUCTIONS.  
 2. APPLY PRIMER TO CONCRETE SUBSTRATE COMPATIBLE WITH REPAIR MATERIAL.  
 3. INSTALL REPAIR MATERIAL TO EXCEED THE MINIMUM LIFT THICKNESS SPECIFIED BY MANUFACTURER.  
 4. CURING SHALL BE AS SPECIFIED BY MANUFACTURER AND AS PER A.C.I.

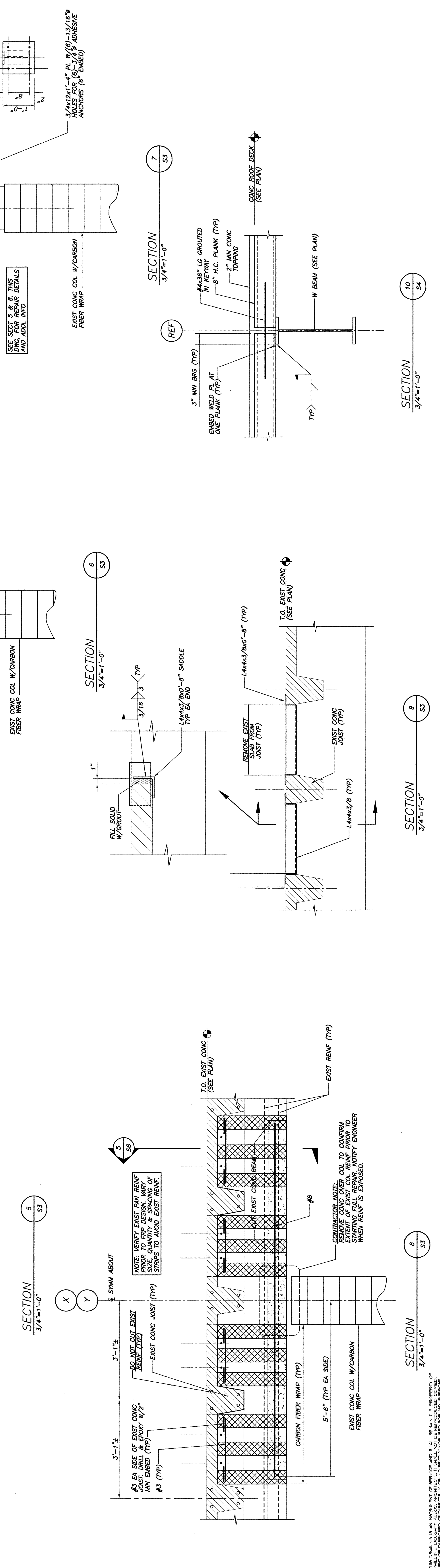
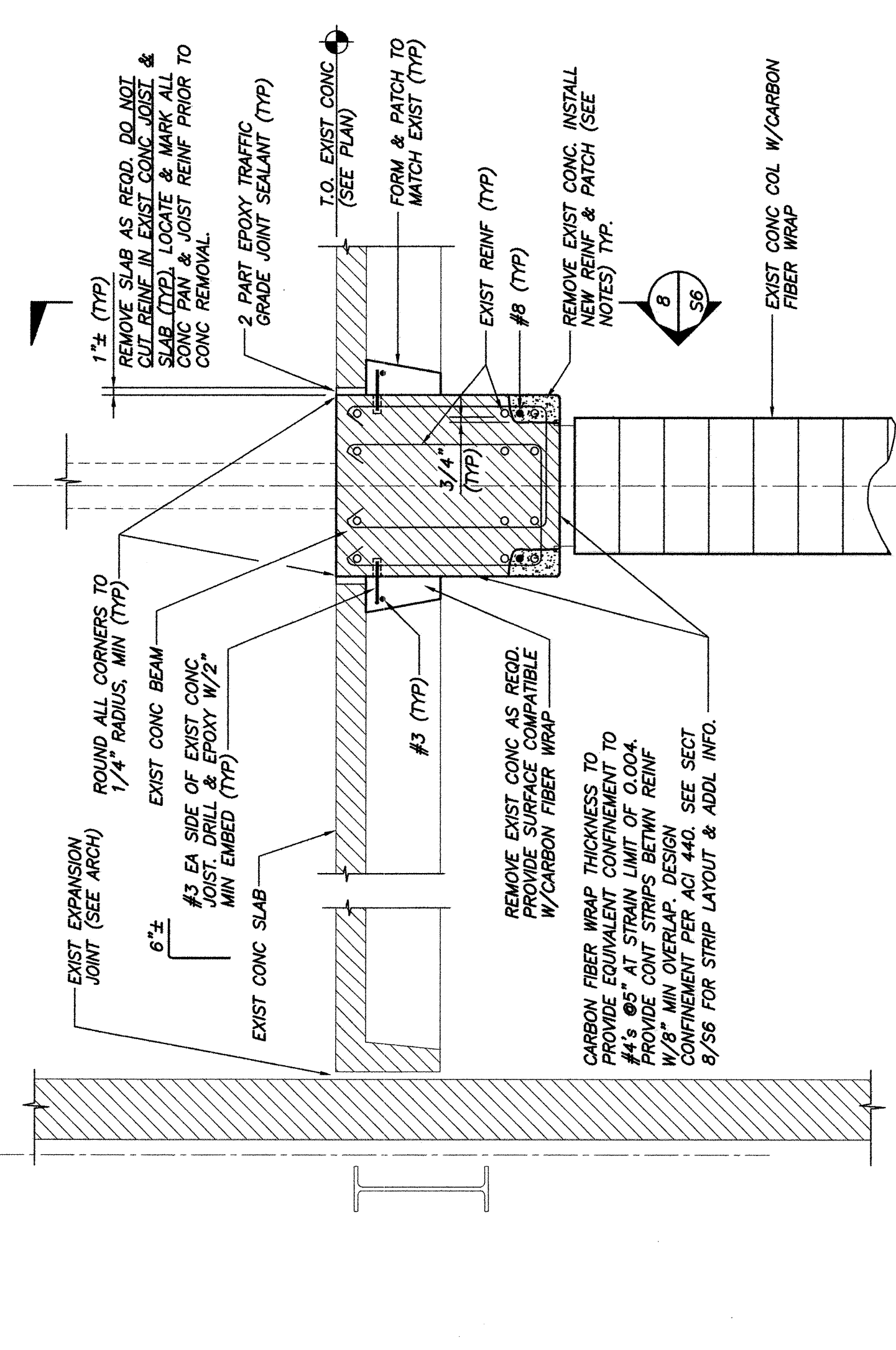

THIS DRAWING IS AN INSTRUMENT OF SERVICE AND SHALL REMAIN THE PROPERTY OF BECKER STRUCTURAL ENGINEERS, INC. NO PART OF THIS DRAWING IS TO BE REPRODUCED OR TRANSMITTED IN ANY FORM OR BY ANY MEANS, ELECTRONIC OR MECHANICAL, WITHOUT THE WRITTEN PERMISSION OF BECKER STRUCTURAL ENGINEERS, INC. CONTRACTORS SHALL BE RESPONSIBLE FOR OBTAINING ALL NECESSARY PERMITS AND APPROVALS FOR THIS PROJECT. BECKER STRUCTURAL ENGINEERS, INC. ASSUMES NO LIABILITY FOR OMISSIONS OR ERRORS ON COMPLETION OF WORK, IF REQUESTED.