

PHOTOGRAPHY AND VIDEO RECORDING OF THIS DRAWING IS PROHIBITED WITHOUT THE WRITTEN PERMISSION OF PHILLIP J. DOUGHTY ASSOCIATES, INC. ANY UNAUTHORIZED REPRODUCTION OR TRANSMISSION OF THIS DRAWING IS STRICTLY PROHIBITED AND WILL BE PROSECUTED TO THE FULL EXTENT OF THE LAW. PHILLIP J. DOUGHTY ASSOCIATES, INC. IS AN EQUAL OPPORTUNITY EMPLOYER.

NOTE:
THIS DRAWING IS FURNISHED AS A REFERENCE ONLY
FOR THE PURPOSE OF EXISTING ROOM #S AND
LOCATIONS, AND EXISTING FIRE ALARM SYSTEM DEVICES

PROJECT NO.	800006	SHEET NO.	E11
DATE	1/27/11	SCALE	1/8" = 1'-0"
DESIGNED BY	JUNE 2007	DATE	JUNE 2007
DRAWN BY	BVD	DESIGNED BY	BVD
CHECKED BY	JLM	APPROVED BY	

DATE	NOV 23	BY	A
DESCRIPTION	Door & Room Corrections		
DATE	NOV 23	BY	A
DESCRIPTION	Door & Room Corrections		

PROJECT NO.	800006	SHEET NO.	E11
DATE	1/27/11	SCALE	1/8" = 1'-0"
DESIGNED BY	JUNE 2007	DATE	JUNE 2007
DRAWN BY	BVD	DESIGNED BY	BVD
CHECKED BY	JLM	APPROVED BY	

ADDITIONS AND ALTERATIONS
EASTERN INTERNATIONAL AIRPORT BAGGAGE CLAIM FACILITY
PORTLAND INTERNATIONAL AIRPORT, PORTLAND, MAINE
REFERENCE DRAWING
EXISTING FIRE ALARM SYSTEM DEVICES
AND ROOM LOCATIONS

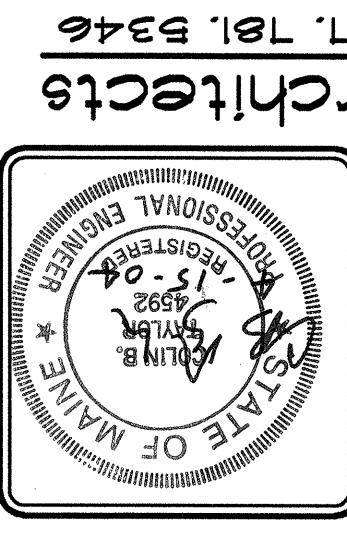

Phillip J. Doughty Assoc. Architects
362 U.S. Route One, Falmouth, Maine 04103 • 207.781.5346

REVISION	DATE	APPROVED	DESCRIPTION
1	APR 22, 2004	CEU	CONSTRUCTION SET
2	MAY 19, 2004	CEU	ADDENDUM #2
3	FEB 29, 2004	CEU	BID SUBMITTAL
4			
5			
6			
7			
8			

DH
Dufresne-Henry
Portland, Maine
Tel: (207) 775-2211 • Fax: (207) 775-6434
www.dufresne-henry.com

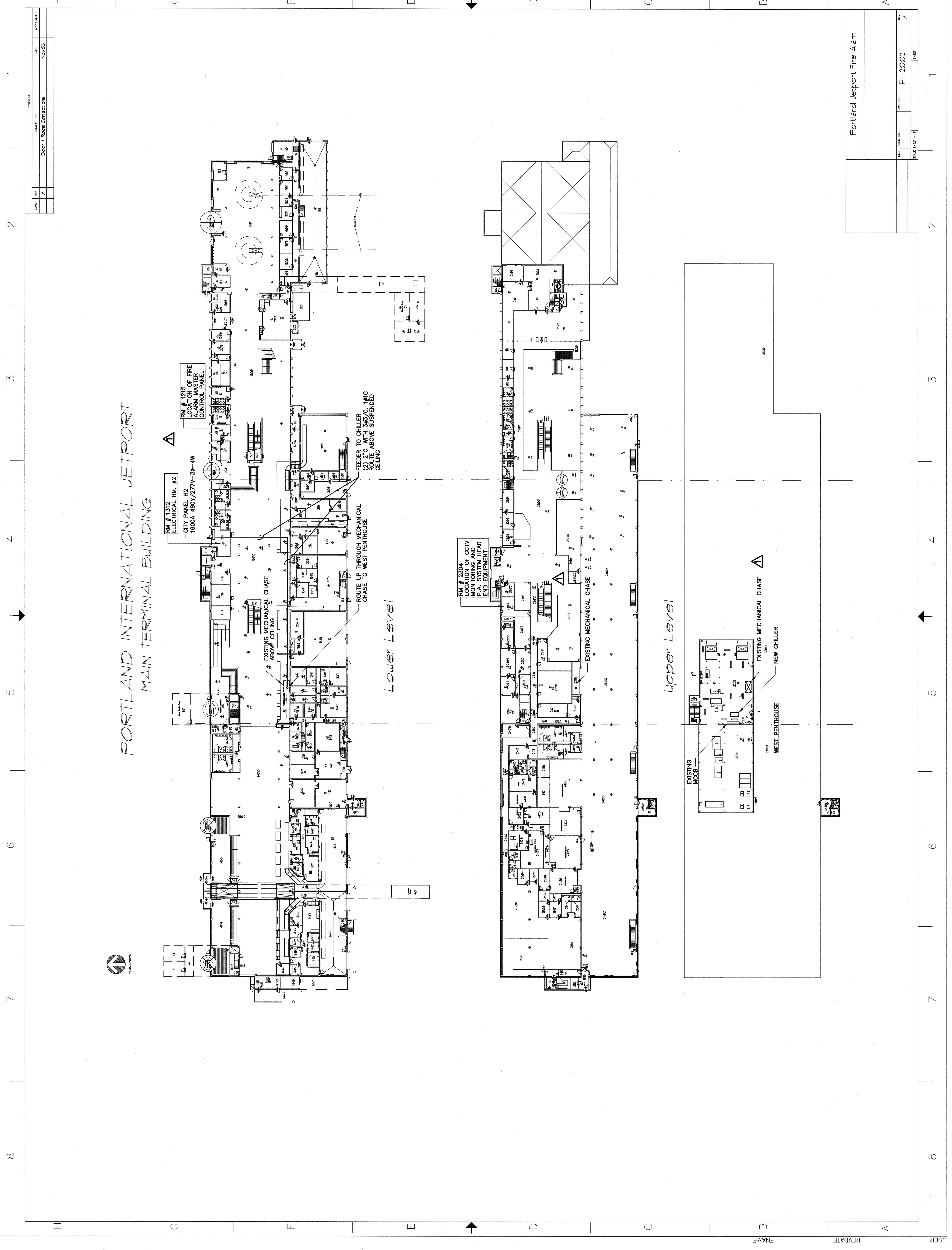

PORTLAND INTERNATIONAL JETPORT
MAIN TERMINAL BUILDING

Lower Level

Upper Level

USER REVDATE