

D2

SHEET NO. 16
 000-000
 000-000

PDA Architects
 362 U.S. Route One, Falmouth, Maine 04105 • 207.781.5346

Philip J. Doughty Assoc. • Architects

APPROVED: _____
 CHECKED: _____
 DESIGNER: JF
 DATE: FEB 2004
 SCALE: 1/8" = 1'-0"

**EASTERN EXPANSION OF BAGGAGE CLAIM FACILITY
 PORTLAND INTERNATIONAL AIRPORT, PORTLAND, MAINE**

DEMOLITION SECOND FLOOR AND ROOF

REVISION	DATE	DESCRIPTION
1	4/23/04	COVERED DRAWING ISSUED FOR CONSTRUCTION
2	4/23/04	ADDITIONAL NO. 2
3	FEB 25, 2004	REVISED

*** EXISTING ROOF DRAIN NOTE:**
 ROOF DRAINS AND ADJACENT ROOFING BETWEEN COLUMN LINES 26/29 AND LINE 38 MUST REMAIN IN SERVICE UNTIL UPPER ROOF AND WALLS ARE ABLE TO PROVIDE ADEQUATE PROTECTION FROM THE ELEMENTS.

DEMOLITION ISSUES ARE NOT RELEGATED TO "D" SHEETS ONLY - DEMOLITION ISSUES ARE SHOWN ON OTHER DIAG. LOCATIONS IN THE CONTRACT DOCUMENTS AS WELL.

LEGEND

EXISTING STRUCTURAL CONCRETE ROOF DECK SYSTEM TO BE REMOVED TO EAST SIDE OF BAY LINE. SEE STRUCT. DIAG.

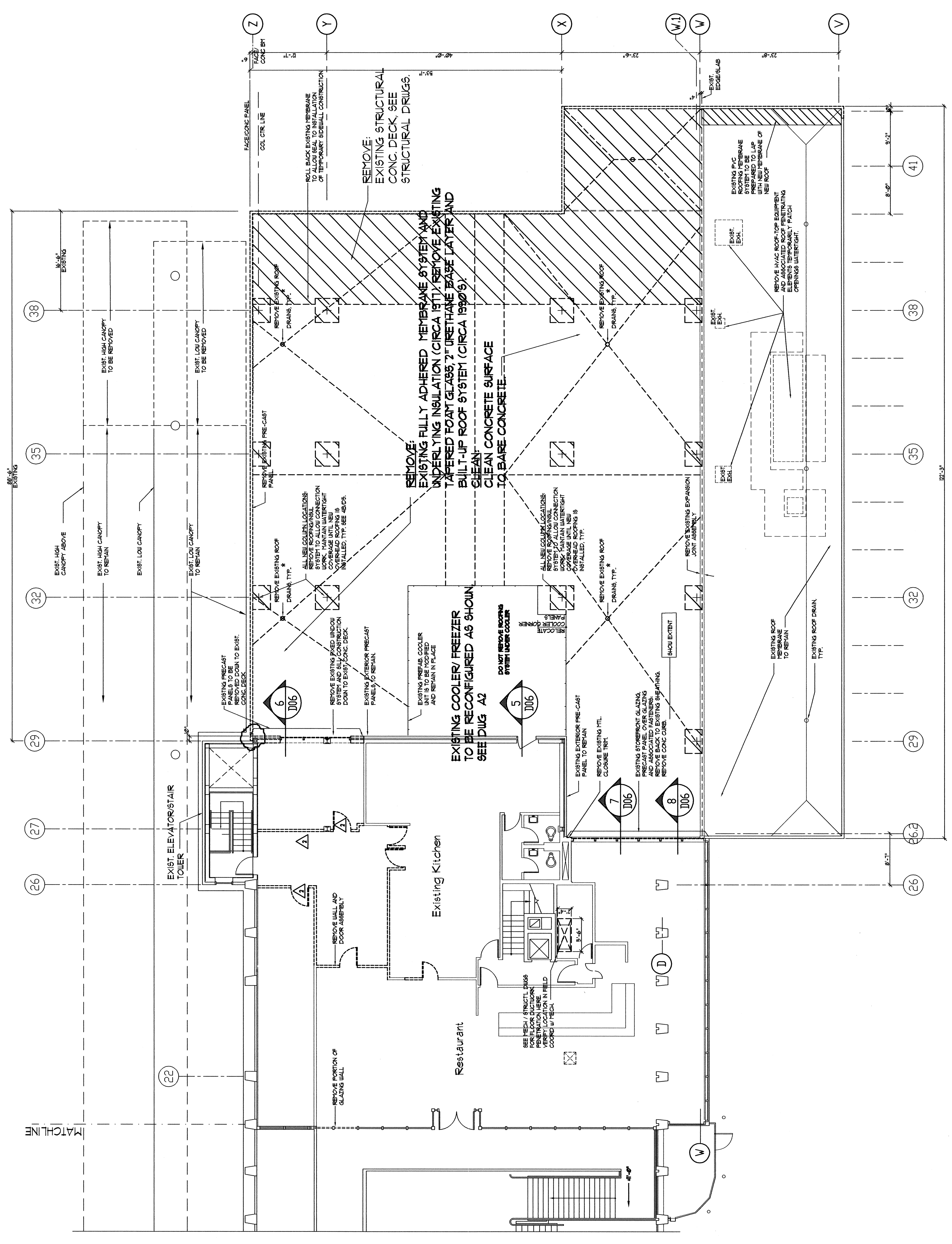

DEMOLITION SECOND FLOOR AND ROOF
 1/8" = 1'-0"

THIS DRAWING IS AN INSTRUMENT OF SERVICE AND SHALL REMAIN THE PROPERTY OF PHILIP J. DOUGHTY ASSOCIATES, INC. IT IS TO BE USED ONLY FOR THE PROJECT AND SITE SPECIFICALLY IDENTIFIED HEREON. IT IS NOT TO BE REPRODUCED, COPIED, OR TRANSMITTED IN ANY FORM OR BY ANY MEANS, WITHOUT THE WRITTEN PERMISSION OF PHILIP J. DOUGHTY ASSOCIATES, INC. REPRODUCTION OR TRANSMISSION OF THIS DRAWING WITHOUT THE WRITTEN PERMISSION OF PHILIP J. DOUGHTY ASSOCIATES, INC. IS PROHIBITED.