

**EXISTING UTILITY TUNNEL**

NORTH END looking north

1. PROTECT ALL UTILITIES DURING EXCAVATION AND WALL DEMOLITION.
2. RELOCATIONS OF EXISTING UTILITIES (FUEL FILL/VENT, 4" CONDUIT AND 4" PVC LINES) TO ALLOW A HANDWAY FROM THE EXISTING TUNNEL INTO THE NEW TUNNEL LEVEL OF STAIRWAY WILL REQUIRE COORDINATION IN FIELD.
3. PROVIDE SUPPORTS AND COORDINATE HANGING OF THE EXISTING LINES WITHIN THE NEWLY EXCAVATED AREA.

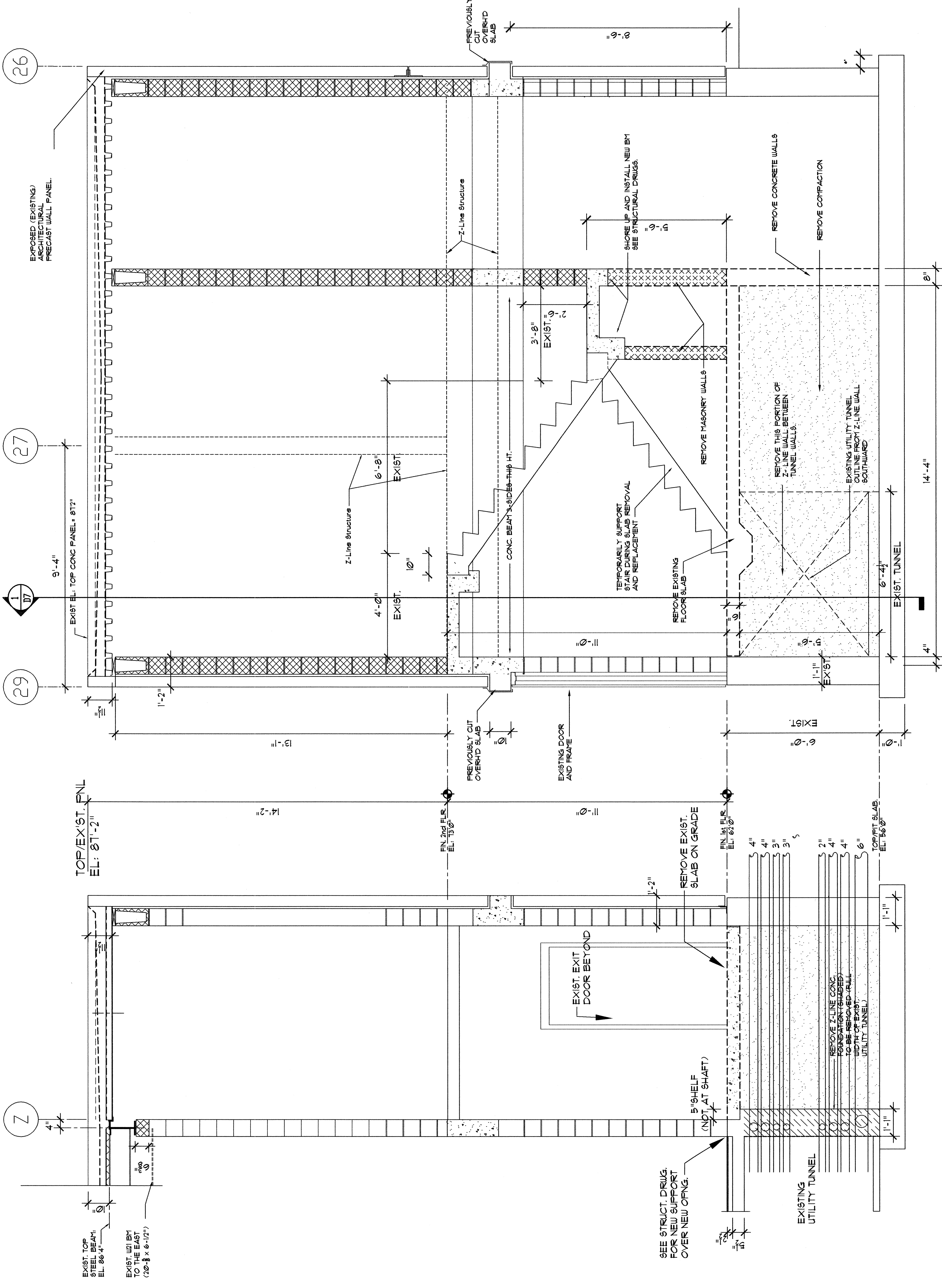

1 EXIST. STAIR SECTION N-S  
SCALE 1/2" = 1'-0"

2 EXIST. STAIR SECTION E-W  
SCALE 1/2" = 1'-0"

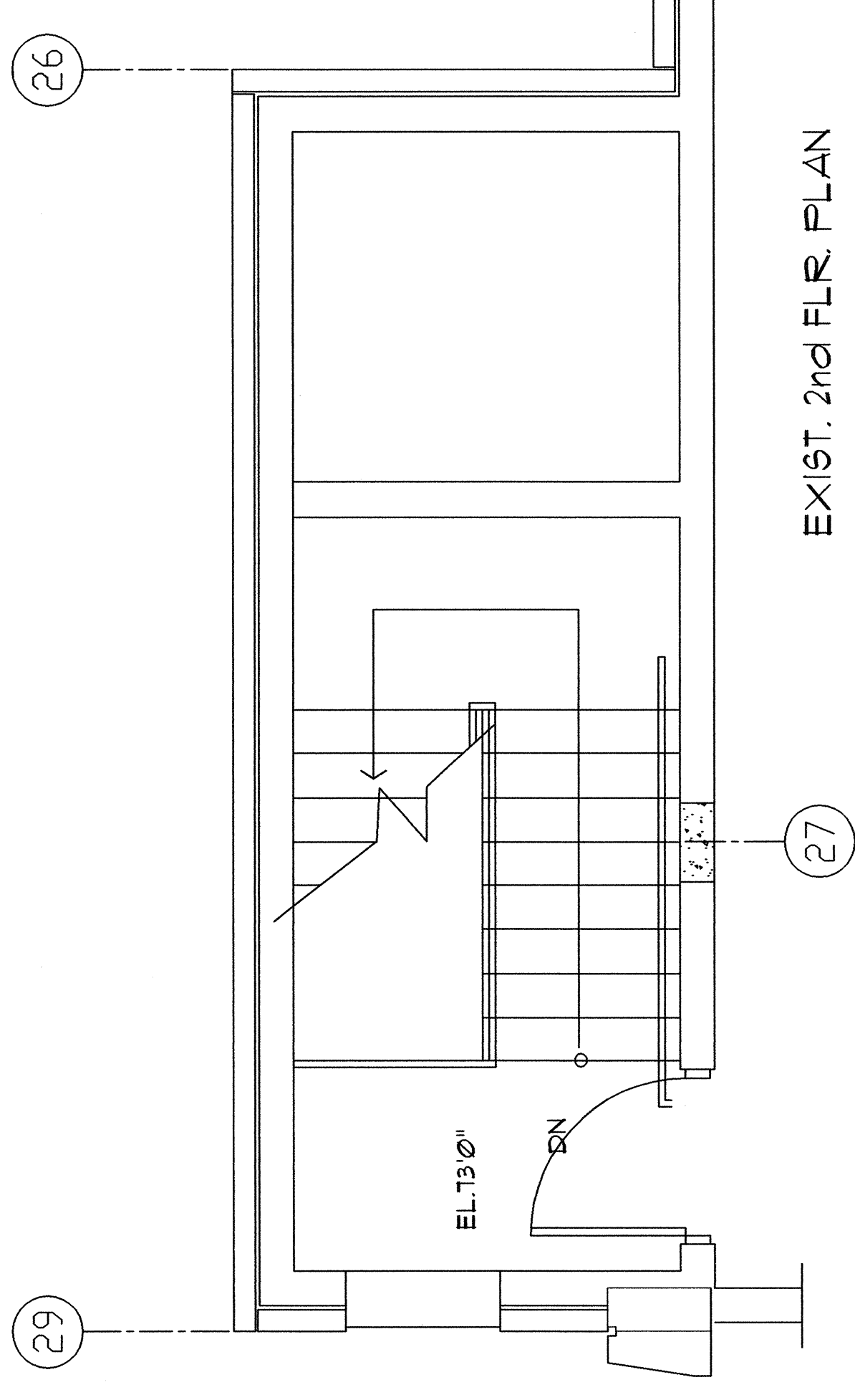

EXIST. 2nd FLR PLAN

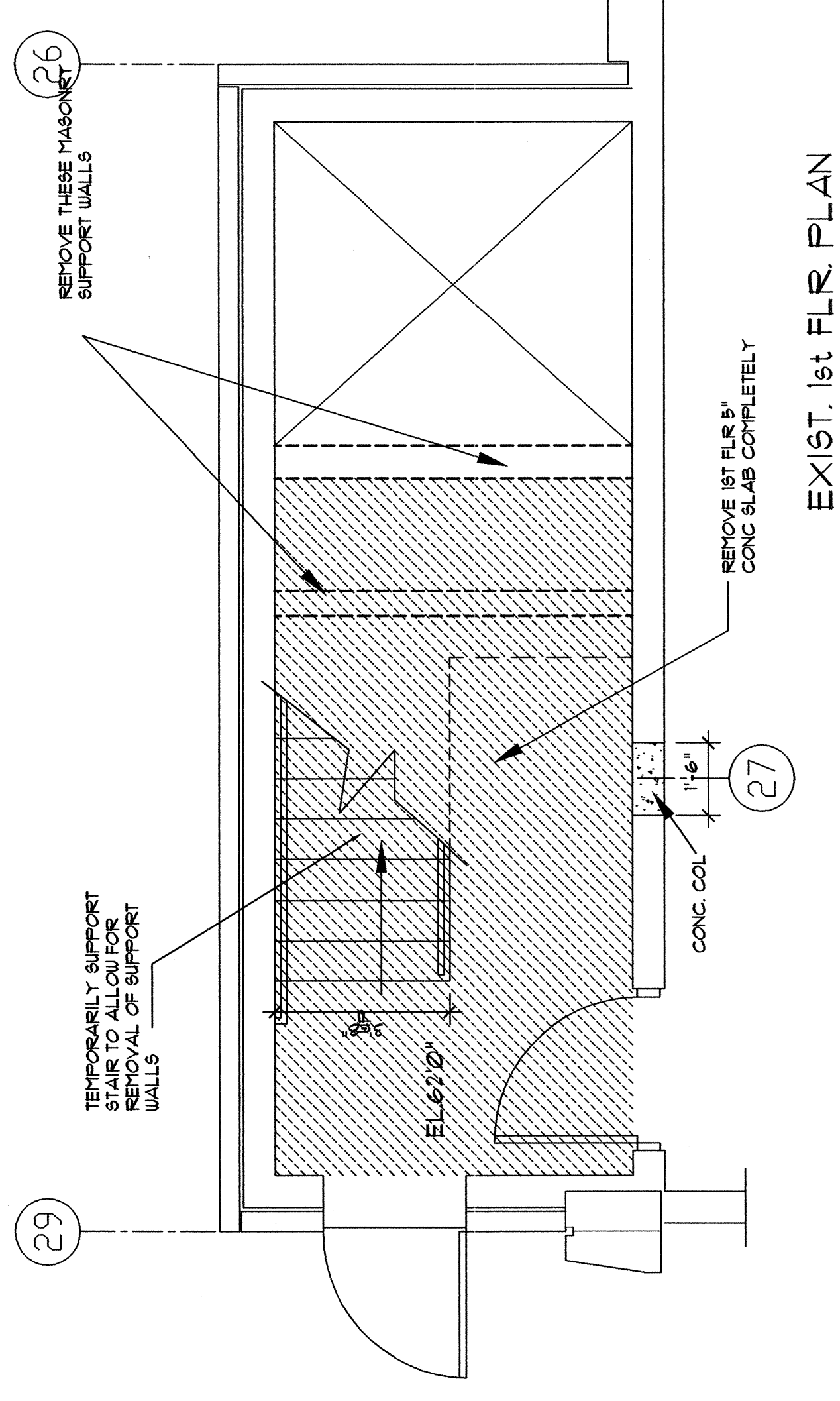

EXIST. 1st FLR PLAN

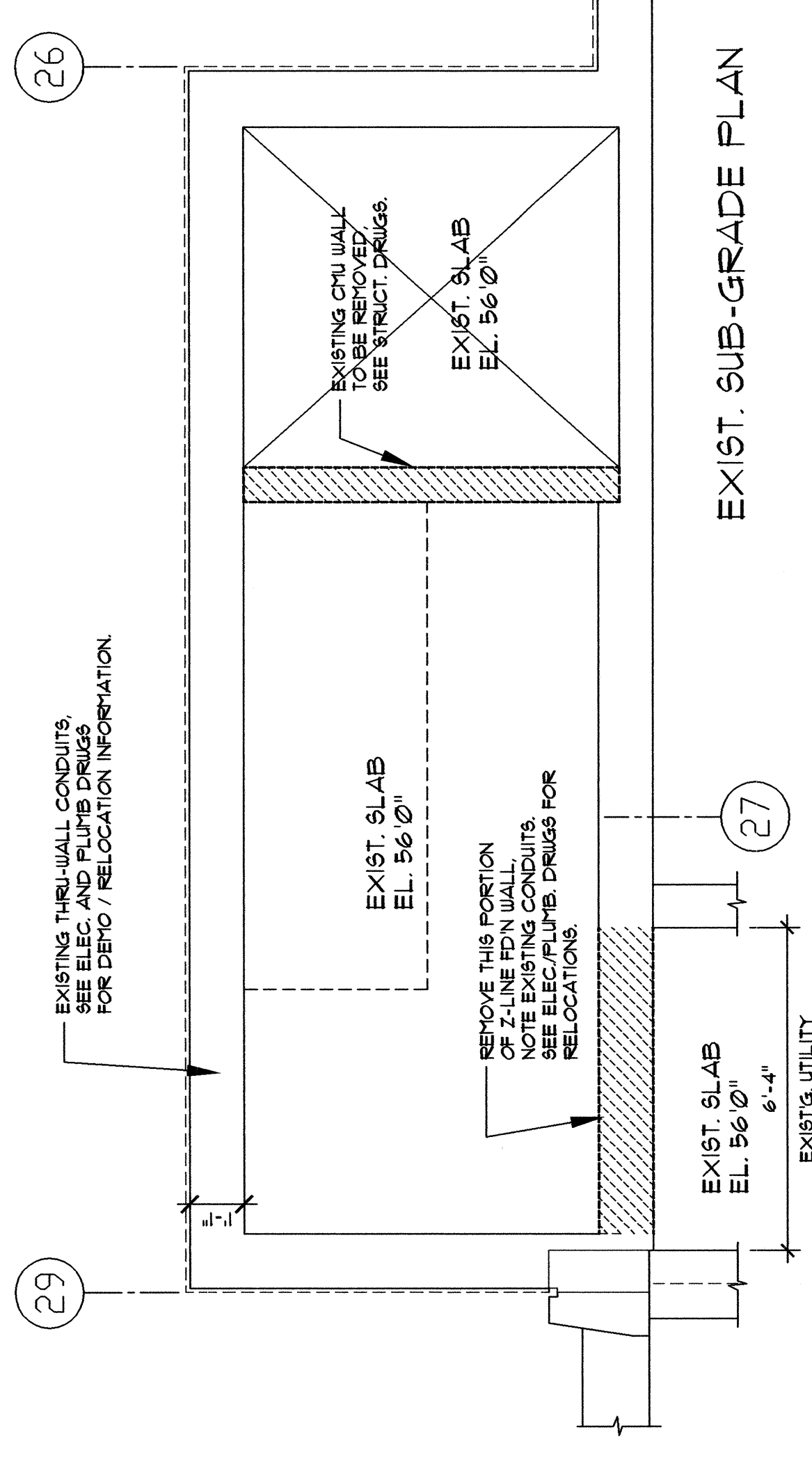

EXIST. SUB-GRADE PLAN

DEMOLITION ISSUES ARE NOT RELEGATED TO "E" SHEETS ONLY - DEMOLITION ISSUES ARE SHOWN ON OTHER LOCATIONS IN THE CONTRACT DOCUMENTS.

**LEGEND**

- [Hatched Box] EXISTING STRUCTURAL CONCRETE ROOF STRUCTURE TO BE REMOVED TO SIDE OF BAY LINE. SEE STRUCT. DRUGS.
- [Hatched Box] EXIST. ROOFING MEMBRANE TO BE MODIFIED OR REFRACING WITH NEW CONSTRUCTION.

3 EXIST. STAIR PLANS  
SCALE 3/8" = 1'-0"

<b>PHD</b> Architects	APPROVED: _____ CHECKED: _____ DESIGNED: _____ DATE: FEB 20 2024 SCALE: 1/8" = 1'-0"	<b>PHILIP J. DOUGHTY ASSOC., ARCHITECTS</b> PORTLAND INTERNATIONAL JETPORT, PORTLAND, MAINE EXPANSION OF BAGGAGE CLAIM FACILITY ADDITIONS AND ALTERATIONS EXISTING STAIR - DEMOLITION SECTION & PLAN	SHEET NO. <b>D7</b> 000-000 1 of 6
--------------------------	--	--	--

REVISION	DATE	DESCRIPTION
1	4/21/24	CONFORMED DRAWINGS ISSUED FOR CONSTRUCTION
2		
3		
4		
5		
6		
7		
8		
9		
10		

1062 US Route One, Falmouth, Maine 04105 • 207.781.5346  
 PHILIP J. DOUGHTY ASSOCIATES, ARCHITECTS  
 108 STATE STREET, PORTLAND, ME 04101  
 LICENSED ARCHITECT

THIS DRAWING IS AN INSTRUMENT OF SERVICE AND NOT BE LOANED, REPRODUCED, COPIED, OR IN ANY MANNER USED FOR ANY OTHER PROJECT WITHOUT THE WRITTEN CONSENT OF PHILIP J. DOUGHTY ASSOCIATES. ARCHITECTS. ON COMPLETION OF WORK IF REQUIRED.