

1/16"=1' 5 0 10 20 30 40ft 1/8"=1' 5 0 5 10 15 20ft 1/4"=1' 2 0 2 4 6 8 10ft 1/2"=1' 1 0 1 2 3 4 5ft 3/4"=1' 1 0 1 2 2 3ft 1"=1' 1 0 1 2 3 4 5ft 1 1/2"=1' 0 1 2 3 4 5ft 3"=1' 0 1 2 3 4 5ft 1ft

NOTES:  
 1. REFER TO ADDITIONAL GENERAL PHASING NOTES ON SHEET C3-1.  
 2. WORK SHALL BE CONDUCTED IN FOUR OR MORE PHASES. THE PHASING SHOWN ON THE PLAN IS A GENERAL GUIDE ONLY TO OUTLINE THE MAJOR PROJECT COMPONENTS. THE CONTRACTOR SHALL SUBMIT A DETAILED PHASING PLAN TO THE ARCHITECT FOR REVIEW AND APPROVAL PRIOR TO COMMENCEMENT OF WORK.  
 3. ALL CONSTRUCTION SIGNS SHALL CONFORM TO CURRENT MUTCD STANDARDS. THE CONTRACTOR SHALL MAINTAIN A SUPPLY OF APPROPRIATE CONSTRUCTION SIGNAGE ON SITE FOR USE WHEN DIRECTED BY THE ARCHITECT.  
 4. AN ELECTRONIC MESSAGE BOARD SHALL BE UTILIZED TO NOTIFY THE PUBLIC OF UPDATING CONSTRUCTION ACTIVITIES AND ROADWAY CLOSURES. THE CONTRACTOR SHALL MAINTAIN OPERATIONAL ACCESS TO ALL ROADWAYS. THE CONTRACTOR SHALL BE RESPONSIBLE FOR REINSTALLING AND REPAIRING EXISTING TRAFFIC CONTROL SIGNAGE THAT IS MODIFIED OR REMOVED AS REQUIRED DURING CONSTRUCTION TO MAINTAIN THE SAFE MOVEMENT OF VEHICLES AND PEDESTRIANS. THE CONTRACTOR SHALL COORDINATE WITH THE ARCHITECT FOR ALL MODIFICATIONS TO TRAFFIC CONTROL AND WAFFENDING SIGNAGE. REFER TO SHEET C3-1 FOR ADDITIONAL INFORMATION CONCERNING VEHICLE AND PEDESTRIAN ROUTES.  
 5. TEMPORARY LANE CLOSURE SIGNAGE SHALL BE PLACED TO FACILITATE TRAFFIC REDUCING TO ONE LANE DURING CERTAIN WORK IN FRONT OF THE TERMINAL.  
 6. THE CONTRACTOR SHALL PROVIDE 8' WIDE TEMPORARY WOODEN ADA COMPLIANT RAMPS WITH 1:12 MAX. SLOPE IN AREAS REQUIRED FOR THE SAFE MOVEMENT OF PEDESTRIANS AS DIRECTED BY THE ARCHITECT. THE RAMPS SHALL BE RELOCATED AROUND THE SIDE AS NECESSARY AND DEMOLISHED WHEN NO LONGER NEEDED.  
 PHASING NOTES:  
 PHASE A - CONTRACTOR AND PEDESTRIAN TEMPORARY ACCESS CONSTRUCTION  
 1. PROVIDE AND PLACE CONSTRUCTION SIGNAGE IN THE VICINITY OF THE PROJECT SITE TO ALERT THE PUBLIC OF PROPOSED IMPACTS TO THE FACILITY AND ADJACENT ROADWAYS.  
 2. CONSTRUCT TEMPORARY CONSTRUCTION ENTRANCES 1-4 TO FACILITATE MOVEMENT OF CONSTRUCTION MATERIALS AND VEHICLES AROUND SITE.  
 3. CONSTRUCT TEMPORARY UNPAVED ENTRANCE AT PROPOSED FILTER POND LOCATION ALONG YELLOWBIRD ROAD.  
 4. CONSTRUCT TEMPORARY PEDESTRIAN CORRIDOR AND PLACE PAVEMENT MARKINGS.  
 5. SIGNAGE AND CONSTRUCTION BARRICADES / BARRIERS TO SHEETLY DIRECT PEDESTRIANS AND CONSTRUCTION SITE CONTROL ENTRANCE AND EXIT IN PHASE I GARAGE TO ESTABLISH TEMPORARY PEDESTRIAN CORRIDOR.  
 6. ACCOMMODATE PEDESTRIAN CORRIDOR.  
 7. DELINEATE CONTRACTOR STAGING AND WORK AREAS AND PLACE CONSTRUCTION BARRIERS / BARRICADES.  
 PHASE B - GARAGE DEMOLITION AND SITE EXCAVATION  
 1. DEMOLISH COMPLETELY THE EXISTING THREE LEVEL GARAGE, ELEVATOR TOWERS, AND ACCESS RAMPS TO THE PHASE I GARAGE. (REFER TO SHEET AD-1 FOR ADDITIONAL INFORMATION).  
 2. EXCAVATE AND PREPARE SITE FOR GARAGE AND CANOPY FOUNDATIONS. PROVIDE TEMPORARY CAP EXISTING AND UTILITIES TO REMAIN AT LIMITS OF EXCAVATION. PROVIDE TEMPORARY DRAINAGE AND DEMATERING AS NECESSARY.  
 PHASE C - NEW BUILDING CONSTRUCTION AND SITE WORK  
 1. GARAGE SITE:  
 A. CONSTRUCT PHASE I GARAGE AND CANOPIES.  
 B. INSTALL NEW SITE DRAINAGE SYSTEMS.  
 C. CONSTRUCT UTILITY RELOCATION LINES AND EXTEND LIGHTING, SIGN, AND REVENUE CONTROL EQUIPMENT CIRCUITS TO PROPOSED LOCATIONS.  
 D. CONSTRUCT NEW GARAGE ENTRANCE AND RELOCATE SALVAGED REVENUE CONTROL EQUIPMENT TO NEW ISLANDS.  
 E. CONSTRUCT CONCRETE PAVED SIDEWALKS AND BITUMINOUS SIDEWALKS.  
 F. RELOCATE SALVAGED SITE SIGNAGE AND LIGHTING FIXTURES.  
 G. RELOCATE EXISTING SIDEWALK BETWEEN THE RAISED TRAFFIC TABLES.  
 H. GARAGE BECOMES OPERATIONAL.  
 2. PARKING OPERATORS BUILDING ADDITION.  
 A. INSTALL OIL / WATER SEPARATOR AND CONNECT ADDITION'S FLOOR DRAIN TO EXISTING BUILDING SANITARY SEWER LINE.  
 B. EXCAVATE EXISTING TOPSOIL TO LIMITS OF PROPOSED DISTURBANCE AND SALVAGE FOR REUSE.  
 C. CONSTRUCT ANTI-EROSION SYSTEM AND PLACE FILTER MATERIAL.  
 D. CONSTRUCT ROOF DRAIN LINE TO EXISTING STORM DRAIN LINE.  
 E. PLACE TOPSOIL SEED AND MULCH AND COMPLETELY STABILIZED.  
 F. DIRECT RUNOFF TO POND ONCE COMPLETELY STABILIZED.  
 PHASE D - RAISED TRAFFIC TABLE RECONSTRUCTION  
 ONE LANE OF THE LOOP ROAD IN FRONT OF THE TERMINAL SHALL REMAIN OPERATIONAL AT ALL TIMES DURING CONSTRUCTION OF THIS PHASE. ADDITIONALLY, ADEQUATE PICK-UP AND DROP-OFF CURB FRONTAGE MUST REMAIN AVAILABLE AT ALL TIMES AS DETERMINED BY THE OWNER. THIS WILL BE ACCOMPLISHED BY SEQUENCING THE WORK SO THAT ONLY ONE TRAFFIC TABLE IS BEING RECONSTRUCTED AT A TIME. WORK ON PHASE C AND PHASE D MAY PROCEED CONCURRENTLY AT THE DISCRETION OF THE ARCHITECT.  
 PHASE E - LANDSCAPING AND WORK SITE RESTORATION  
 1. ESTABLISH VEGETATION IN ALL DISTURBED AREAS UNLESS OTHERWISE INDICATED.  
 2. REMOVE TEMPORARY CONSTRUCTION ENTRANCES AND RESTORE SITES TO THEIR ORIGINAL CONDITIONS INCLUDING CURBING, PLANTINGS, SIGNAGE, FENCING, GUARDRAIL, UTILITIES, ETC.  
 3. MILL AND OVERLAY ALL CONTRACTOR STAGING AREAS AND OTHER AREAS USED BY THE CONTRACTOR DURING COMPLETION OF THE WORK.  
 4. APPLY PAVEMENT MARKINGS IN TWO APPLICATIONS AT LEAST 30 DAYS APART.  
 5. PERFORM FINAL PROJECT SITE CLEAN UP AND PUNCH LIST WORK.

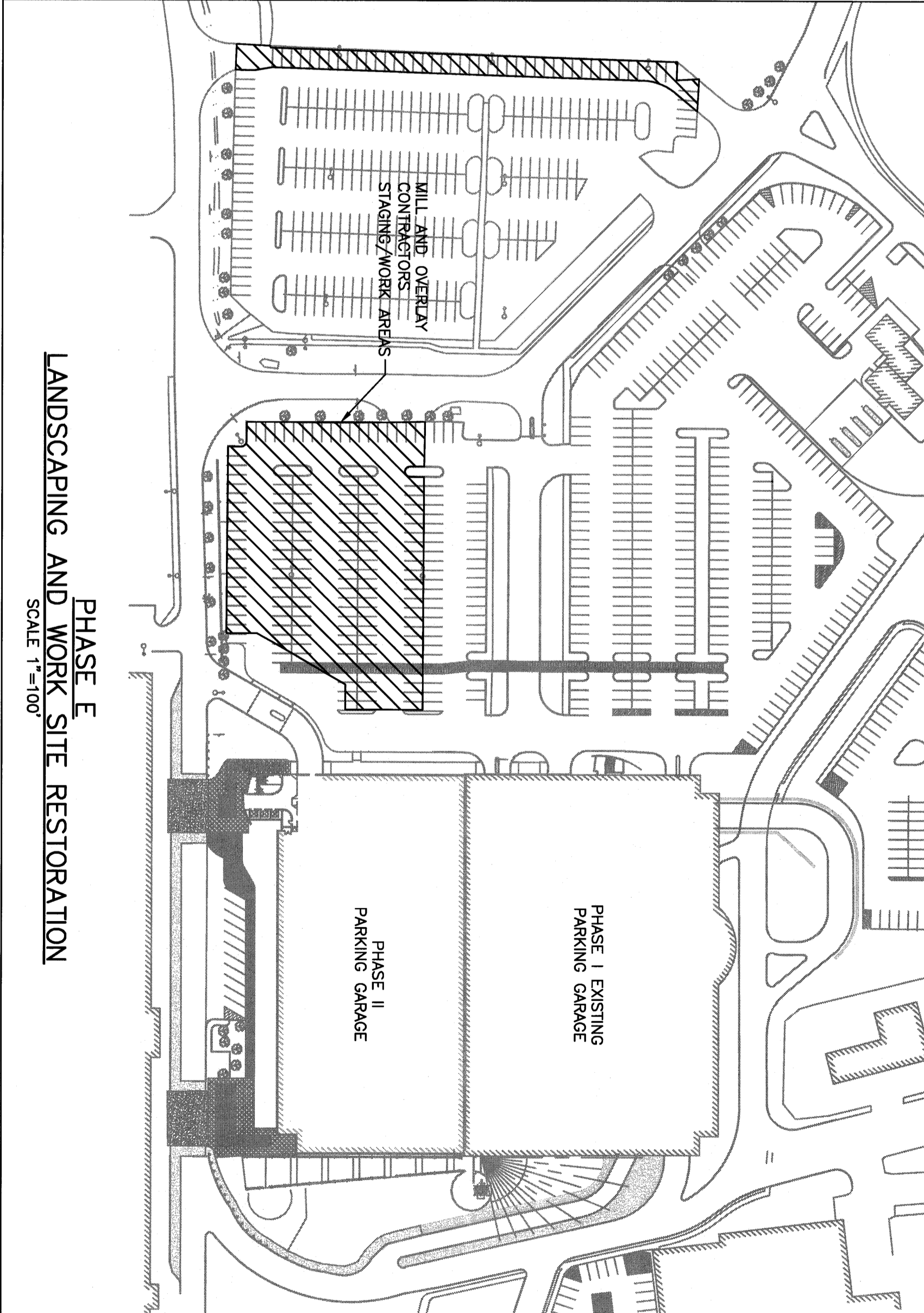
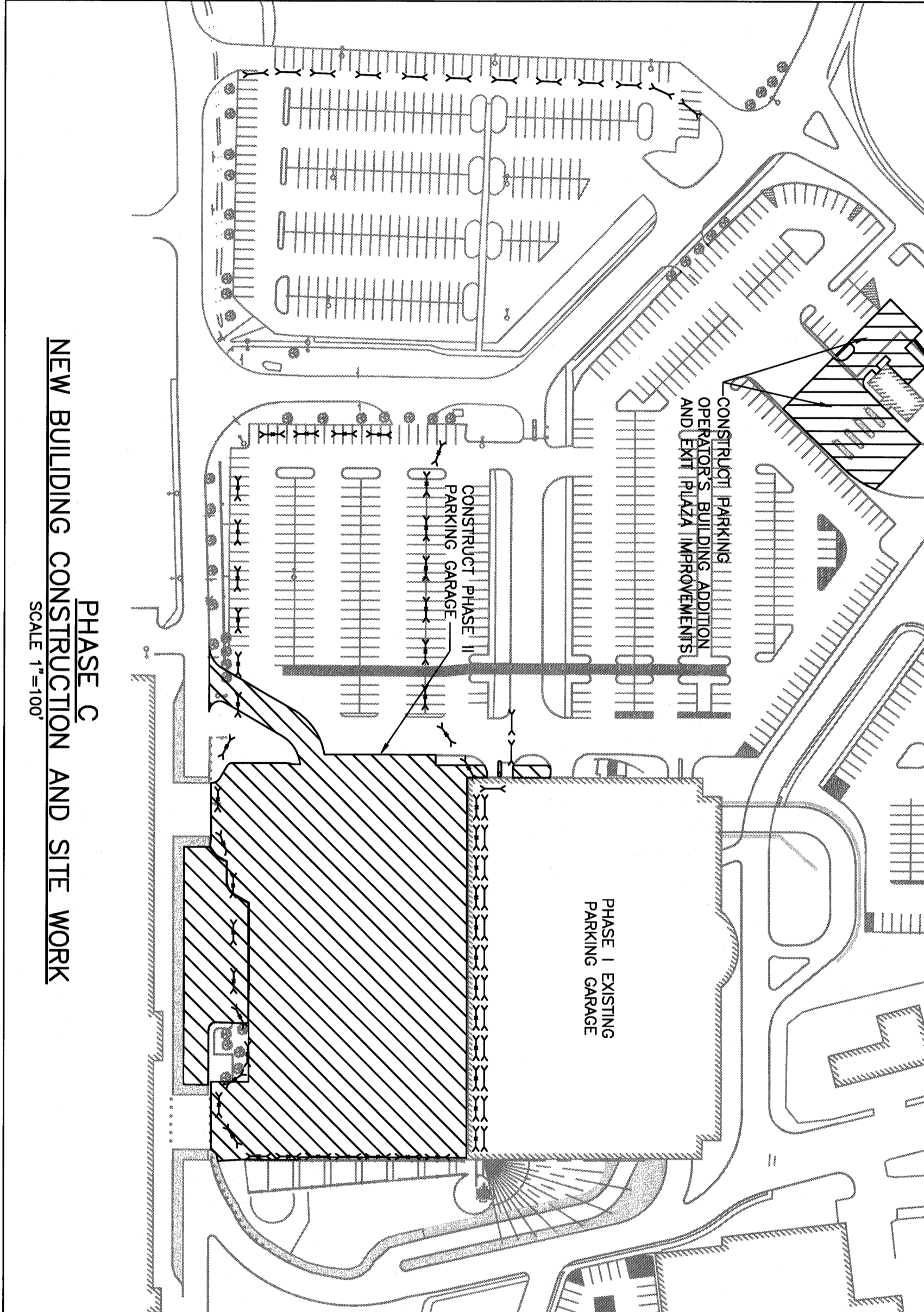
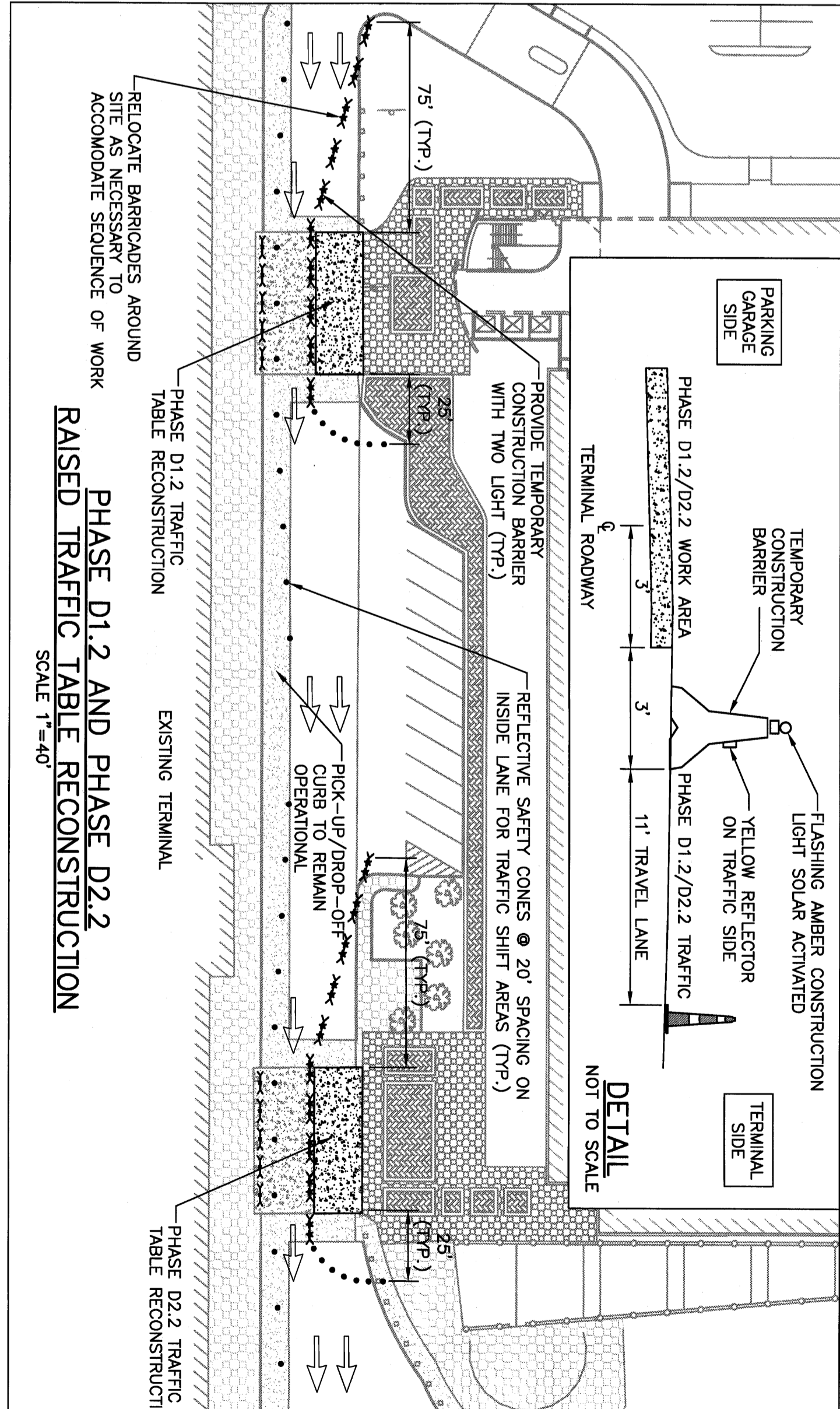
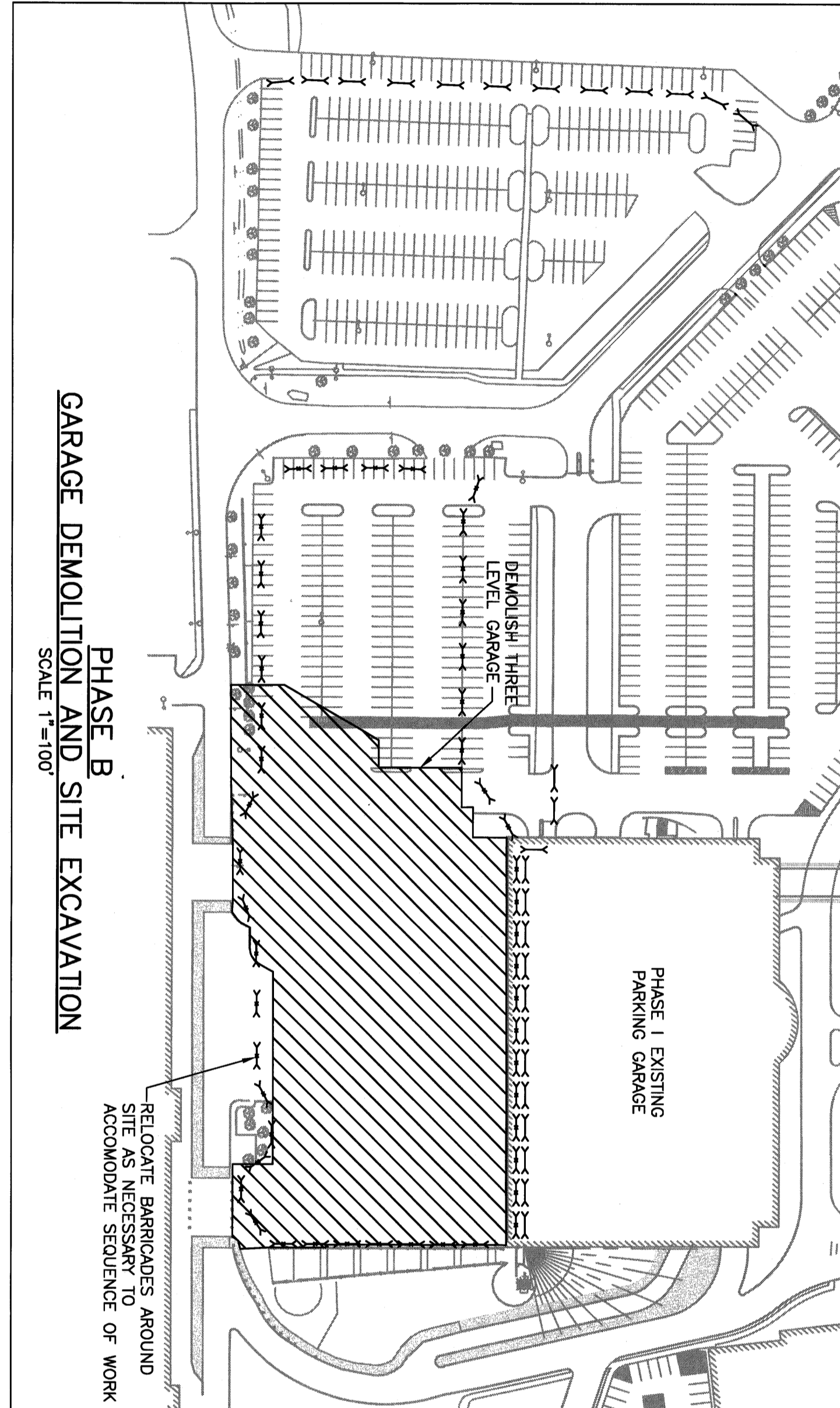
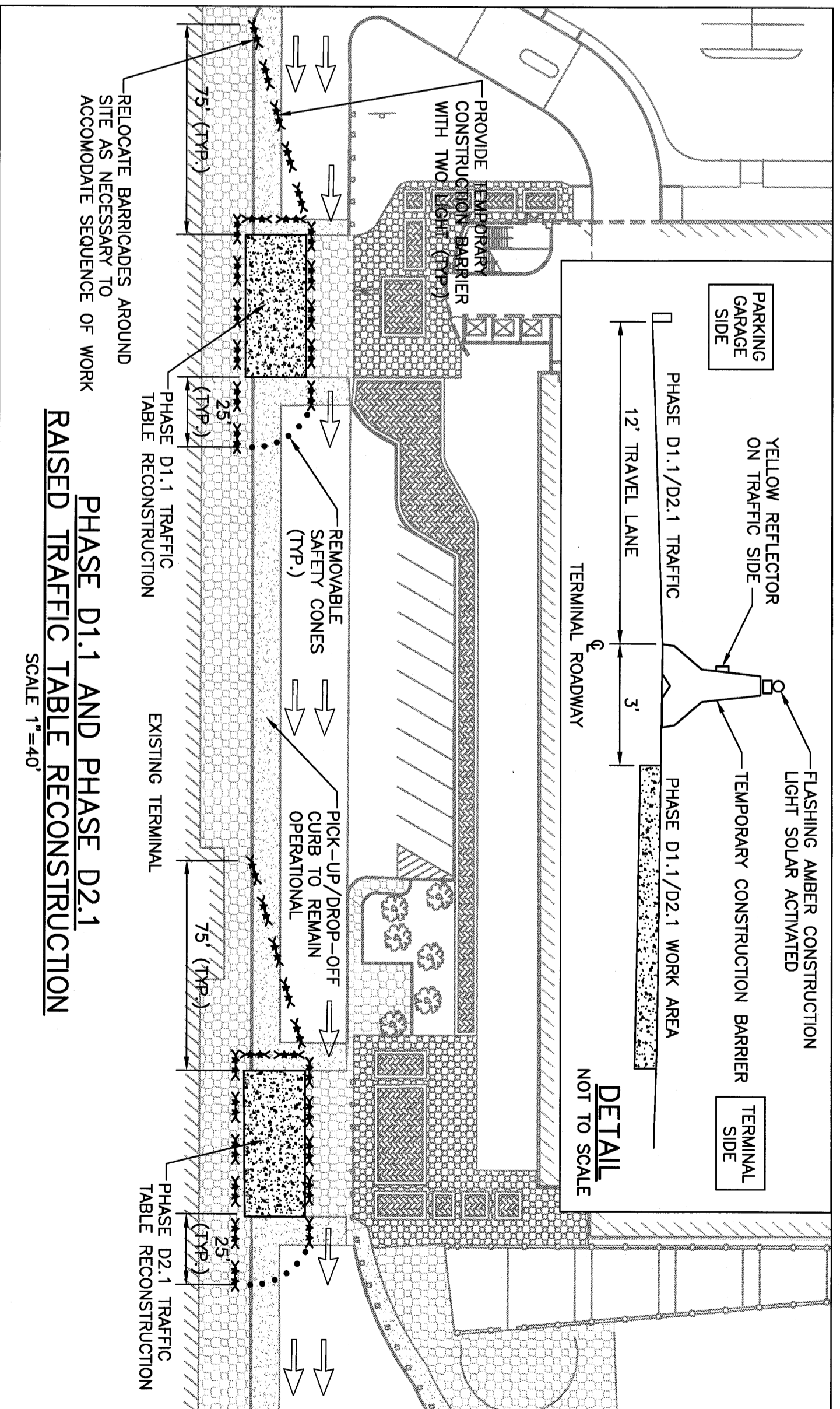
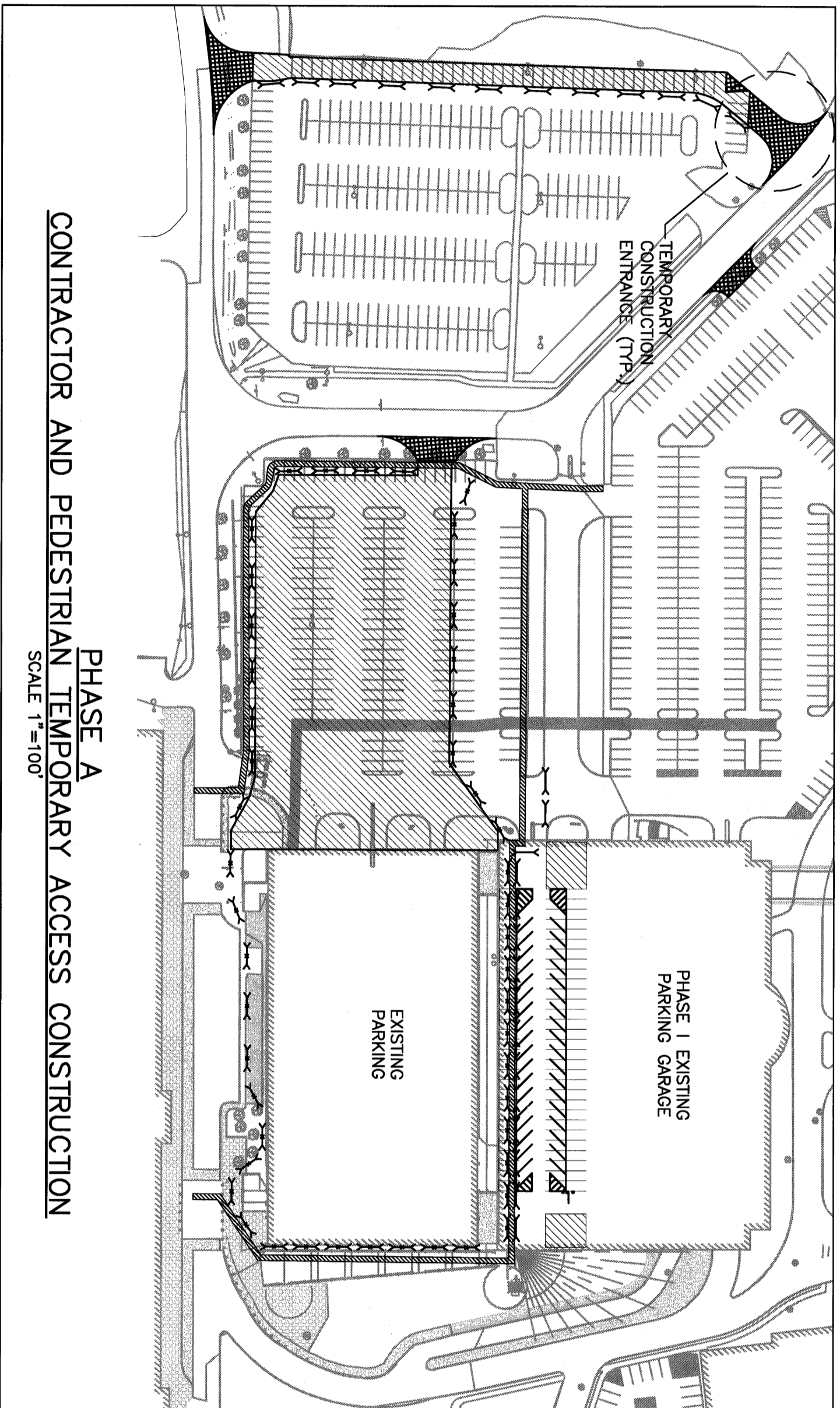

- ENTER
- RETOUR
- SIDEWALK CLOSED
- REPAIRING
- PEDESTRIAN
- RIGHT LANE CLOSED
- BEHIND BARRIER TO STOP
- WORK AREA
- ROAD WORK AHEAD
- TRUCKS ENTERING
- TRUCKS EXITING
- W20-5R
- W20-7B
- CS-3
- CS-1
- W20-5L
- W20-7A
- W20-1
- CS-2
- W4-2R
- W4-2L

PORTLAND INTERNATIONAL JETPORT  
 PHASE II PARKING GARAGE PROJECT  
 CONSTRUCTION ACTIVITY IN PROGRESS  
 16"x6" ORANGE BACKGROUND W/  
 BLACK LETTERS AND BLACK TRIM.

FLUORESCENT ORANGE  
 SAFETY CONES WITH  
 WHITE REFLECTIVE BANDS  
 4"-6" IN WIDTH  
 REFLECTIVE SAFETY CONE  
 NOT TO SCALE

STATTEC CONSULTING SERVICES INC.  
 27 Pine Street, Suite 205  
 Portland, ME 04101-3880  
 Tel: 207.775.3211  
 Fax: 207.775.6434  
 www.stattec.com

DOMENECH  
 HICKS &  
 KROCKMANN  
 ARCHITECTS  
 155 Massachusetts Ave.  
 Boston, MA 02115  
 Tel: 617-261-6400  
 Fax: 617-261-1990

CITY OF PORTLAND  
 PORTLAND, MAINE  
 DEPARTMENT OF  
 WATERFRONT AND  
 TRANSPORTATION

PORTLAND  
 INTERNATIONAL  
 JETPORT  
 PHASE II  
 PARKING GARAGE  
 1001 WESTBROOK ST.,  
 PORTLAND, MAINE

CONFORMED SET  
 FOR FIELD USE

CONSTRUCTION PHASING  
 PLANS & DETAILS

DATE: 2/25/08

SCALE: AS NOTED

SHEET NO. C3-2