

960333

Location of Construction: 1127 Westbrook St		Owner: Irving Oil Corp		Phone:	
Owner Address:		Leasee/Buyer's Name:		Phone:	
Contractor Name: Irving Oil Co. - Christopher D. Watson - 1127 Westbrook St Portland, ME 04102 775-5635		Address:		Phone:	
Past Use: Jetport		Proposed Use: Same w/signage		COST OF WORK: \$	
Proposed Project Description: Erect signage totalling 342 sq ft		FIRE DEPT. <input type="checkbox"/> Approved <input type="checkbox"/> Denied		PERMIT FEE: \$	
Permit Taken By: Mary Gresik		Date Applied For: 25 April 1996		INSPECTION: Use Group: Type: Signature: BOCA Signature: [Signature]	
		PEDESTRIAN ACTIVITIES DISTRICT (P.A.D.)		Action: <input type="checkbox"/> Approved <input type="checkbox"/> Approved with Conditions <input type="checkbox"/> Denied	
		Signature:		Date:	

PERMIT ISSUED
Permit Issued:
MAY - 2 1996
CITY OF PORTLAND

Zone: *AB* CBL: *207-B-001*
 Zoning Approval: *Bldg signs*
Special Zone or Reviews:
 Shoreland *denied*
 Wetland *5/1/96*
 Flood Zone
 Subdivision
 Site Plan maj minor mm

Zoning Appeal
 Variance
 Miscellaneous *However*
 Conditional Use *Free Stand*
 Interpretation
 Approved *Sign Approved*
 Denied *by Deb Andrews see memo*

Historic Preservation
 Not in District or Landmark
 Does Not Require Review
 Requires Review

Action:
 Approved
 Approved with Conditions
 Denied
 Date: *4/24/96*

1. This permit application doesn't preclude the Applicant(s) from meeting applicable State and Federal rules.
2. Building permits do not include plumbing, septic or electrical work.
3. Building permits are void if work is not started within six (6) months of the date of issuance. False information may invalidate a building permit and stop all work..

CERTIFICATION

I hereby certify that I am the owner of record of the named property, or that the proposed work is authorized by the owner of record and that I have been authorized by the owner to make this application as his authorized agent and I agree to conform to all applicable laws of this jurisdiction. In addition, if a permit for work described in the application issued, I certify that the code official's authorized representative shall have the authority to enter all areas covered by such permit at any reasonable hour to enforce the provisions of the code(s) applicable to such permit

[Signature] 25 April 1996
 SIGNATURE OF APPLICANT Christopher Watson ADDRESS: DATE: PHONE:
 RESPONSIBLE PERSON IN CHARGE OF WORK, TITLE PHONE:

CEO DISTRICT **4**
K Carroll

COMMENTS

done a part inspection

	Type	Inspection Record	Date
Foundation:	_____	_____	_____
Framing:	_____	_____	_____
Plumbing:	_____	_____	_____
Final:	_____	_____	_____
Other:	_____	_____	_____

City of Portland, Maine – Building or Use Permit Application 389 Congress Street, 04101, Tel: (207) 874-8703, FAX: 874-8716

Location of Construction: 1127 Westbrook St		Owner: Irving Oil Corp		Phone:	
Owner Address:		Leasee/Buyer's Name:		Phone:	
Contractor Name: Irving Oil Co. - Christopher		Address: D. Watson - 1127 Westbrook St Ptd, ME 04102		Phone: 775-5635	
Past Use: Jetport		Proposed Use: Same w/signage		COST OF WORK: \$	
Proposed Project Description: Erect signage totalling 342 sq ft		FIRE DEPT. <input type="checkbox"/> Approved <input type="checkbox"/> Denied		PERMIT FEE: \$	
Permit Taken By: Mary Gresik		Date Applied For: 25 April 1996		INSPECTION: Use Group: Type: Signature: Date:	

Permit No: **960333**

PERMIT ISSUED
Permit Issued:
MAY - 2 1996
CITY OF PORTLAND

Zone: **AB** CBL: **207-B-001**
Zoning Approval: **Blg signs ok - P&S signs denied**
Special Zone or Reviews:
 Shoreland **denied**
 Wetland **5/1/96**
 Flood Zone
 Subdivision
 Site Plan maj minor mm

Zoning Appeal
 Variance
 Miscellaneous
 Conditional Use
 Interpretation
 Approved
 Denied

Historic Preservation
 Not in District or Landmark
 Does Not Require Review
 Requires Review

Action:
 Approved
 Approved with Conditions
 Denied
Date: **4/29/96**

1. This permit application doesn't preclude the Applicant(s) from meeting applicable State and Federal rules.
2. Building permits do not include plumbing, septic or electrical work.
3. Building permits are void if work is not started within six (6) months of the date of issuance. False information may invalidate a building permit and stop all work..

CERTIFICATION

I hereby certify that I am the owner of record of the named property, or that the proposed work is authorized by the owner of record and that I have been authorized by the owner to make this application as his authorized agent and I agree to conform to all applicable laws of this jurisdiction. In addition, if a permit for work described in the application issued, I certify that the code official's authorized representative shall have the authority to enter all areas covered by such permit at any reasonable hour to enforce the provisions of the code(s) applicable to such permit

SIGNATURE OF APPLICANT *Christopher Watson* ADDRESS: DATE: **25 April 1996** PHONE:
RESPONSIBLE PERSON IN CHARGE OF WORK, TITLE PHONE:

[Handwritten Signature]
Date: **4/29/96**

CEO DISTRICT **4**
K. Carroll



CHRISTOPHER D. WATSON
National Accounts Manager

IRVING OIL CORPORATION
700 Maine Avenue
P.O. Box 401
Bangor, Maine 04402-0401

BUS: (207) 942-7000
BUS: (800) 432-1785
FAX: (207) 942-5234
RES: (207) 827-6338

Note: Bldg Sign meets
Sign regulations
The Pole Sign does
not meet the present
regulations

SIGNAGE

PLEASE ANSWER ALL QUESTIONS

ADDRESS: 1127 Westbrook St ZONE: AB

OWNER: Irving Oil Corporation

APPLICANT: Irving Aviation Services

ASSESSOR NO.: _____

SINGLE TENANT LOT? YES _____ NO X

MULTI TENANT LOT? YES X NO _____

over height
limitations
and signage
area

FREESTANDING SIGN? (ex. pole sign..) YES X NO _____ DIMENSIONS 10' x 18' 5 ft high
See Attached 16' is max 180' is max 65' is max

MORE THAN ONE SIGN? YES X NO _____ DIMENSIONS 5' x 18' 90'

BLDG. WALL SIGN? (attached to bldg) YES X NO _____ DIMENSIONS 3' x 12' 36'
2 signs - see attached (1 street side, 1 Ramp side) 36' is max

MORE THAN ONE SIGN? YES X NO _____ DIMENSIONS _____

LIST ALL EXISTING SIGNAGE AND THEIR DIMENSIONS: 342 total ft

LOT FRONTAGE (FEET) 605' It appears the bldg signs meet regs -

BLDG FRONTAGE (FEET) 320'

AWNING YES _____ NO X IS AWNING BACKLIT? YES _____ NO X

HEIGHT OF AWNING: _____

IS THERE ANY COMMUNICATION, MESSAGE, TRADEMARK OR SYMBOL ON IT? Yes - see attached sign

A SITE SKETCH AND BUILDING SKETCH SHOWING EXACTLY WHERE EXISTING AND NEW

SIGNAGE IS LOCATED MUST BE PROVIDED. SKETCHES AND/OR PICTURES OF THE

PROPOSED SIGNS ARE ALSO REQUIRED.

68.40
25.00
93.40

INFORMATION REQUIREMENTS FOR SIGN PERMIT APPLICATION

342

68.46
25.00
93.46

APPLICANTS FOR A SIGN PERMIT WILL BE ASKED TO SUBMIT THE FOLLOWING INFORMATION TO THE CODE ENFORCEMENT OFFICE:

1. PROOF OF INSURANCE
2. LETTER OF PERMISSION FROM THE OWNER
3. A SKETCH PLAN OF THE LOT, INDICATING LOCATION OF BUILDINGS, DRIVEWAYS AND ANY ABUTTING STREETS OR RIGHT OF WAYS. LENGTHS OF BUILDING FRONTAGES AND STREET FRONTAGES SHOULD BE NOTED (SEE ATTACHED)
4. INDICATE ON THE PLAN ALL EXISTING AND PROPOSED SIGNS
5. COMPUTATION OF THE FOLLOWING:
 - A) SIGN AREA OF EACH EXISTING AND PROPOSED BUILDING SIGN
 - B) SIGN AREA HEIGHT AND SETBACK OF EACH EXISTING AND PROPOSED FREESTANDING SIGN

A SKETCH OF ANY PROPOSED SIGN(S), INDICATING DIMENSIONS, MATERIALS, SOURCE OF ILLUMINATION AND CONSTRUCTION METHOD (SEE ATTACHED)

FEE FOR PERMIT - \$25.00 PLUS \$0.20 PER SQUARE FOOT

NOTE: ONCE A SKETCH PLAN HAS BEEN FILED FOR A PROPERTY, THE CODE ENFORCEMENT OFFICE WILL KEEP A RECORD OF THE PLAN SO THAT A NEW SKETCH PLAN WILL NOT BE REQUIRED FOR LATER CHANGES TO SIGNAGE ON THE PROPERTY. IN SUCH AN INSTANCE, APPLICANTS WILL ONLY BE REQUIRED TO SUBMIT INFORMATION APPLICABLE TO THE NEW SIGNS.

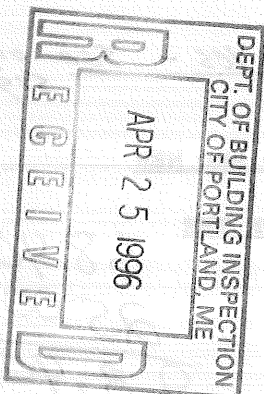

file



CITY OF PORTLAND
Planning and Urban Development Department

MEMORANDUM

TO: Marge Schmuckal, Zoning Administrator

✓ FROM: Deborah Andrews, Senior Planner *D. Andrews*

DATE: May 7, 1996

SUBJECT: Irving Aviation Sign at Portland Jetport — *RE: 1127 Westbrook S*

The existing Irving Aviation sign at the Portland Jetport has been reviewed under Sec. 14-526 of the Site Plan Ordinance and has been found to meet the standards of this section. Therefore I recommend approval, with the condition that the north facing side of the sign be altered to eliminate commercial messages of any kind and that all illumination of this face be eliminated.

RE: Free Standing sign

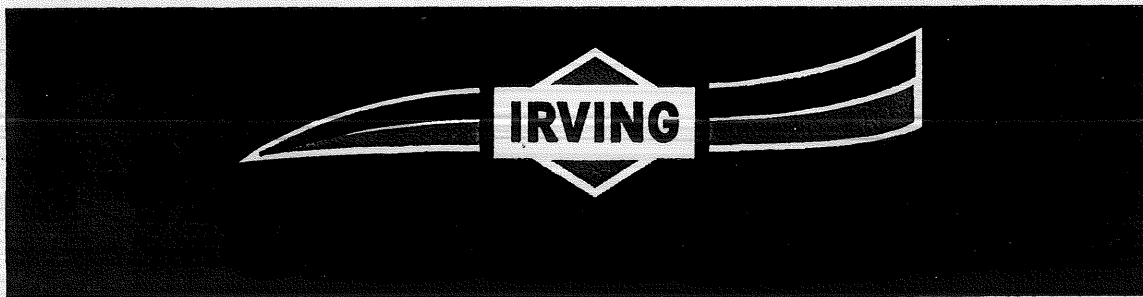

Night



Day

Scale:
1/2"=1'



End view of sign

The depth of the sign box is 8.375".
(Single face body, bleed tension frame cover)
Box painted Irving gray Pantone 403c.

Overall Size of Sign:
3'x12'
Sign Face Material-
Flexible vinyl face.
Masked off so the logo
has a black field at night.



Position of fascia sign on building



Scale:
1/4"=1'

The face of the building
that the fascia sign sits in
is- 5' height- 12' wide.

Irving Oil Limited Irving Aviation Services 3'x12' Fascia Sign

Client Signature: _____ Date: _____



Date: DEC. 6 1993

Drawn By: E. B.

These designs, details and plans represented herein are the property of Plasticraft Limited! Specifically developed for your personal use in connection with the project being planned for you by Plasticraft. It is not to be shown to anyone outside of your organization, nor are they to be used, reproduced, exhibited or copied in any fashion whatsoever. All or part of this design (excepting registered trademarks) remains the property of Plasticraft Limited.

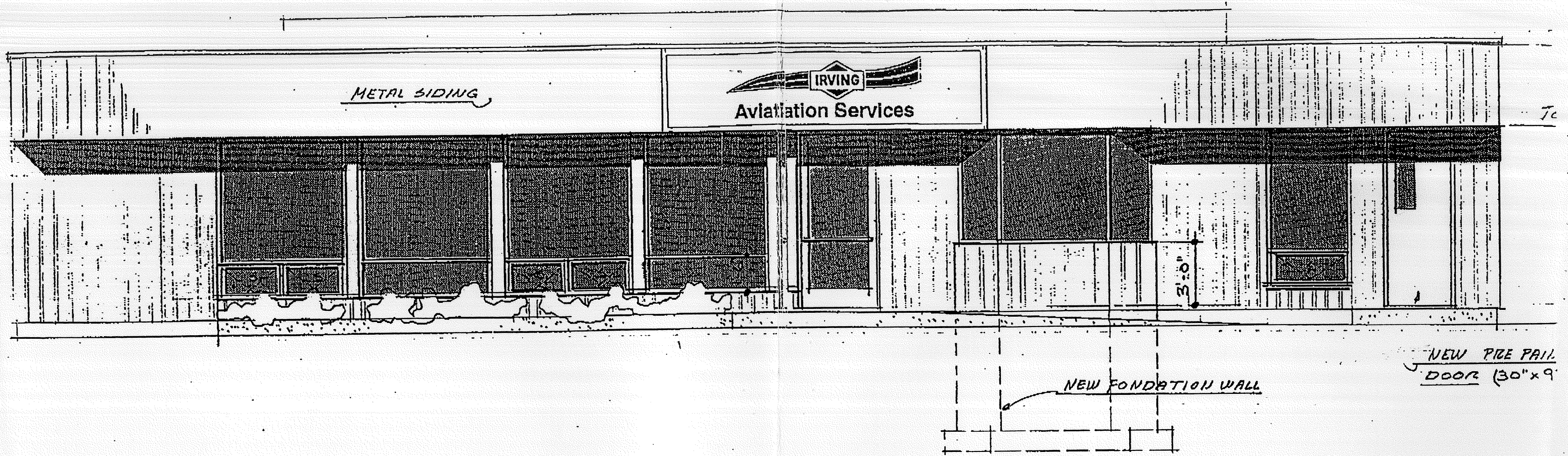

RECEIVED
 APR. 25 1996
 DEPT. OF BUILDING INSPECTION
 CITY OF PORTLAND, ME

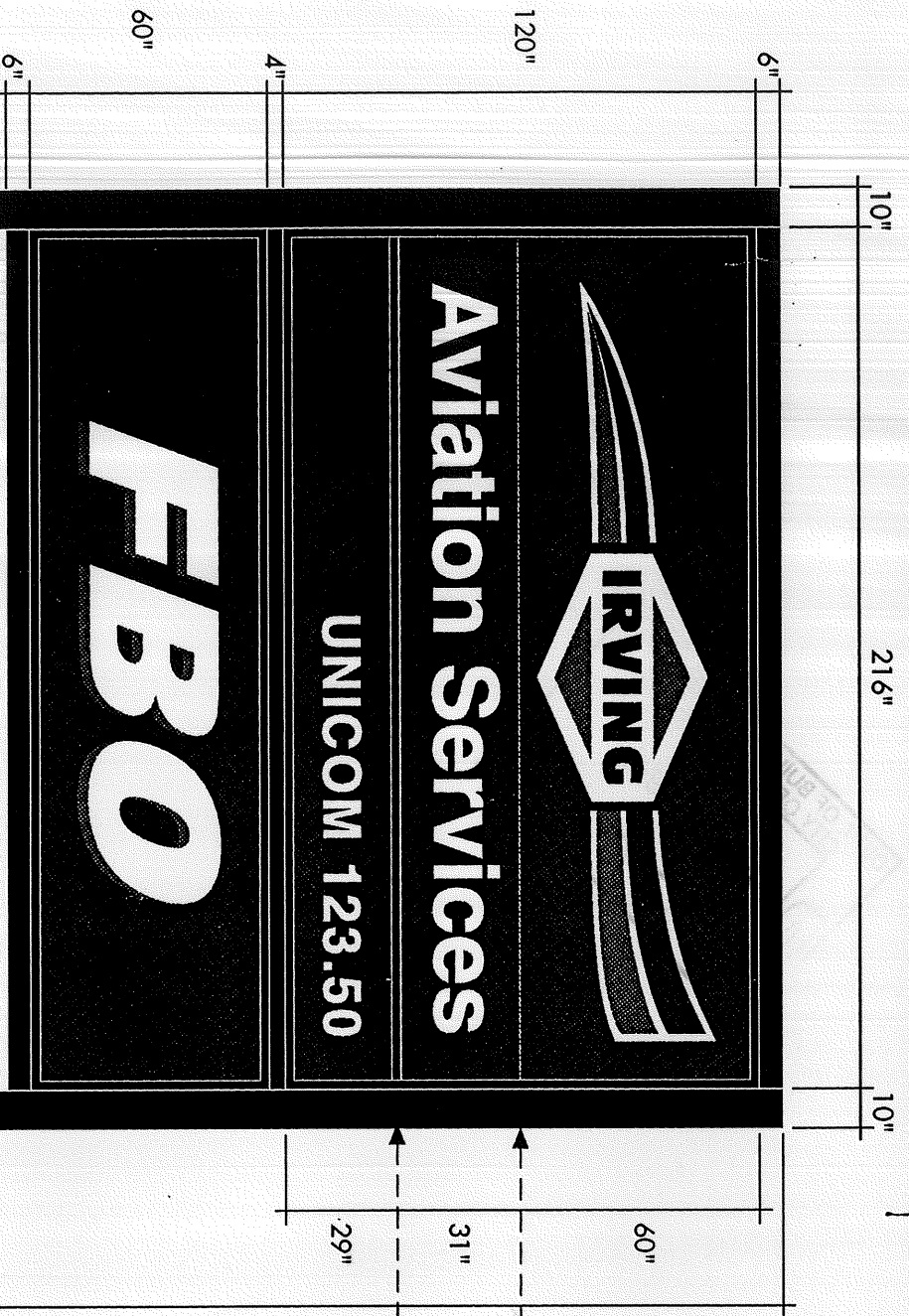

2-1/4" H-BAR
Dark Blue vinyl
applied to face of
H-Bar.

Character and graphic sizes:
Aviation Services logo-
Height- 45.75"
Width- 190"

Aviation Services-
Height- 16.5"
Width- 188"
UNICOM 123.50-
Height- 10"
Maximum readable distance- 450'
Width- 105"

FBO-
Height- 35"
Width- 122"

Scale:
1/4"=1'

**Double Sided Illuminated
Pylon Sign**

Overall Size of Top Sign Cabinet:
Height- 120"
Width- 216"
Depth- 13.75" (with frame)

Overall Size of Bottom Sign Cabinet:
Height- 60"
Width- 216"
Depth- 13.75" (with frame)

Sign Face Material-
Panaflex
The background will not illuminate at
night- the graphics will.

Material of Sign:
Sign Comp
Wide Body
Dual frame with 2-1/4" dual frame
cover
Painted black

Poles:
10"x10"x648" Steel poles
Painted black
This should be looked into by an
engineer to see what size poles and
any steel structure (if needed) should
be used. ATTACHED IS A DRAWING
FROM AMES WITH THE DETAILS

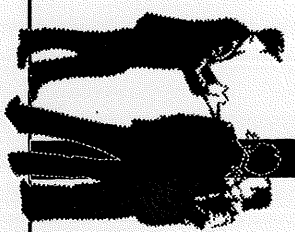

Client Signature _____ Date _____

Irving Oil Limited
Irving Oil Construction
Portland, Maine
Illuminated Pylon Sign Proposal

PLASTICRAFT
SIGNS AND GRAPHICS
These designs, details and plans represented herein are the property of Plasticraft Limited. Specialized developed for your personal use in connection with the project being planned. They are not to be used, reproduced, published or copied in any fashion whatsoever. All or part of this design (excepting registered trademarks) remains the property of Plasticraft Limited.
Date: Nov. 30/95
Drawn by: E. Beal

Name of Document: Portland, ME Aviation Pylon
Work Order No. 26530
Ready For Production: _____

648" = 54'

Certificate of Insurance

No. L-002 Dated September 11, 1995

This certificate of insurance is to certify that insurance has been effected as shown below. This certificate neither affirmatively nor negatively amends, extends or alters the coverage afforded by the insurance policies. It is furnished as a matter of information only, confers no rights upon the holder and is issued with the understanding that the rights and liabilities of the parties will be governed by the original policy / ies as they may be lawfully amended by endorsement from time to time.

Should the policy / ies stated below be cancelled, assigned or changed during the named policy period, in such manner as to affect this document, Marsh & McLennan, Limitée will endeavour to give notice to the holder of this document but failure to give such notice shall impose no obligation of any kind upon Marsh & McLennan, Limitée or upon the Insurer.

Name and address of Insured:

IRVING OIL CORPORATION
P.O. Box 401
700 Main Avenue
Bangor, Maine
04402-2003

Certificate issued to:

CITY OF PORTLAND
1001 Westbrook St.
Portland, Maine
Attn: Jeff Schultes

- COVERAGE** : Liability to third parties arising out of premises and operations; aviation products liability
- POLICY NUMBER** : AW136494
- POLICY TERM** : December 31, 1994 to December 31, 1995
- INSURERS** : Underwriters at Lloyd's, London and London Market Companies
- LIMITS OF LIABILITY** : \$ 2,000,000 Cdn each accident or occurrence
- SPECIAL CONDITION** : It is understood and agreed that City Of Portland is added as an additional insured, but only with respect to the liability arising out of the operations of the named insured.

Marsh & McLennan, Limitée
600, boul. de Maisonneuve ouest
Montréal, Québec H3A 3J3
Téléphone 514 285 5800

MARSH & MCLENNAN, LIMITÉE

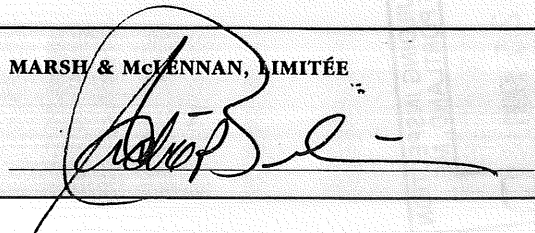



IRVING AVIATION SERVICES/PWM

PORTLAND INTERNATIONAL JETPORT

1127 WESTBROOK ST.
PORTLAND, MAINE 04102

April 25, 1996

City of Portland
389 Congress St.
Portland, ME 04101

Dear Sir,

The enclosed packet of information is the Application for a Sign Permit for Irving Aviation Services, located at the Portland International Jetport. As requested by Debbie Andrews, the free standing pole sign will have the panels on North Side, showing Irving Aviation Services and FBO, blacked out so that the internal lighting does not show through. We will also remove the top panel, Irving Aviation Services (north side), replaced with a black panel. We would request that the lower panel, FBO, remain so as to give aircraft landing on Runway 36-18, inbound from the north, a visual on our location.

If you should have any questions in regards to this application, please contact me.

Sincerely,
Irving Oil Corporation

A handwritten signature in black ink, appearing to read "CWatson", written over a horizontal line.

Chris Watson
Manager - National Sales

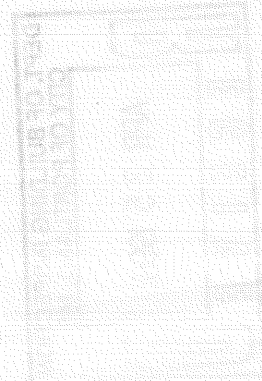

Portland International Jetport
Jeffrey Schultes, A.A.E.
Manager



Transportation and Waterfront Dept.
Thomas F. Valteau
Director

CITY OF PORTLAND

27 October 1995

Irving Aviation Services
Portland International Jetport
Portland, ME 04102

Dear Al,

The Portland International Jetport has reviewed your sign proposal and does approve the installation with the following comments and conditions:

1. A suggestion is made that the Unicom frequency be larger so as to be seen by pilots.
2. We need to see detailed sketches of footing details and location of sign to assure that it will not conflict with existing underground utilities/sewers.
3. If existing payment is removed it must be replaced and sealed.
4. Contractor must meet security requirements.
5. Size of crane (height) must be known and scheduled with the airport prior to construction.
6. Confirmation that sign height will not exceed 115 MSL elevation.

Sincerely,

Jeff Schultes, A.A.E.
Airport Manager

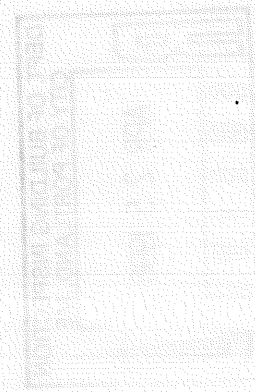



IRVING AVIATION SERVICES/PWM

PORTLAND INTERNATIONAL AIRPORT
1127 WESTBROOK ST.
PORTLAND, MAINE 04102

April 26, 1996

To: Mary
City of Portland

From: Chris Watson

Re: Sign U.C. numbers

Below you will find copies of the stickers from the two sign on the pole sign. The sticker for the two signs on the building were in a position that we were unable to remove them to copy. The number are listed.

Irving Aviation Sign (pole)

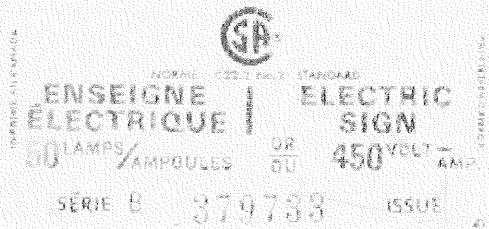

Irving Aviation Sign
(building - ramp side)

C 039848

FBO Sign (pole)



Irving Aviation Services
(building - street side)

C 039836

The stickers on the building signs have the same information showing as the pole signs

If you have any questions, please call me at 1-800-962-8250 ext. 7389

Thank you

TYPICAL AT ALL ANCHOR PLATES:
 1) THREADED W/SPOT WELDS OR
 2) UNTHREADED W/HELDS TO DEVELOP
 FULL TENSION CAPACITY OF BOLTS

1 x 6

1 x 1'-10"

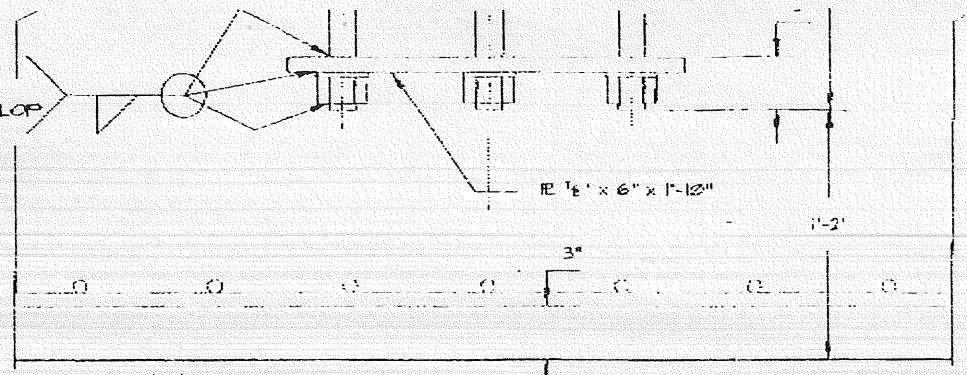

5 SECTION - FOOTING
 S1 SCALE: 1 1/2" = 1'-0"

SPECIFICATION FOR THE
 TELL FOR BUILDINGS.
 AWS REQUIREMENTS.

5 OF SIGN FRAME TO
 KG

30, GRADE B, F_y = 46 KSI

THICK
 LEVELING PLATE.

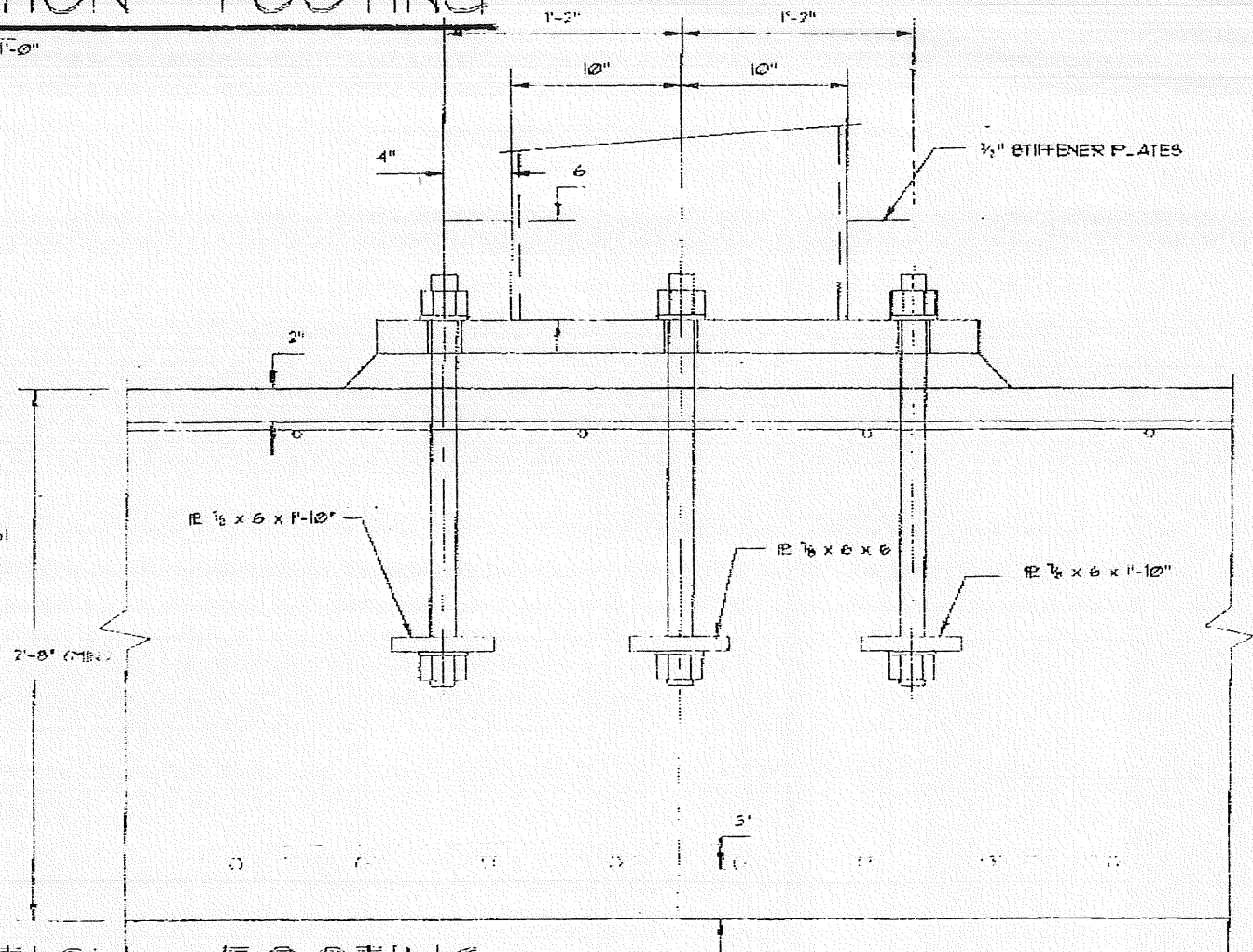

6 SECTION - FOOTING
 S1 SCALE: 1 1/2" = 1'-0"



IRVING OIL
 CORPORATION

PORTLAND JETPORT
 SOUTH PORTLAND

PROJECT NO.: 05115.02

SHEET TITLE:

PYLON SIGN
 PLAN & DETAILS

DRAWING NO.:

REVISION:

S1

A

COMPANY SUPERVISOR AND CONTRACTOR TO VERIFY ALL
 MEASUREMENTS ON WORK OR AT SITE. THIS DRAWING IS
 PROPERTY OF IRVING OIL LTD AND SHALL BE RETURNED
 ON COMPLETION OF WORK.

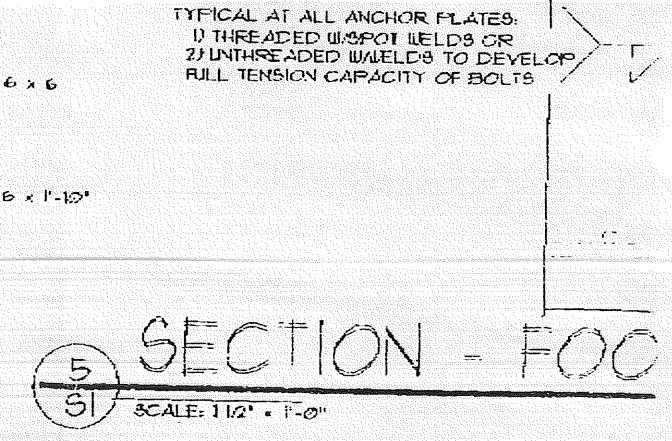
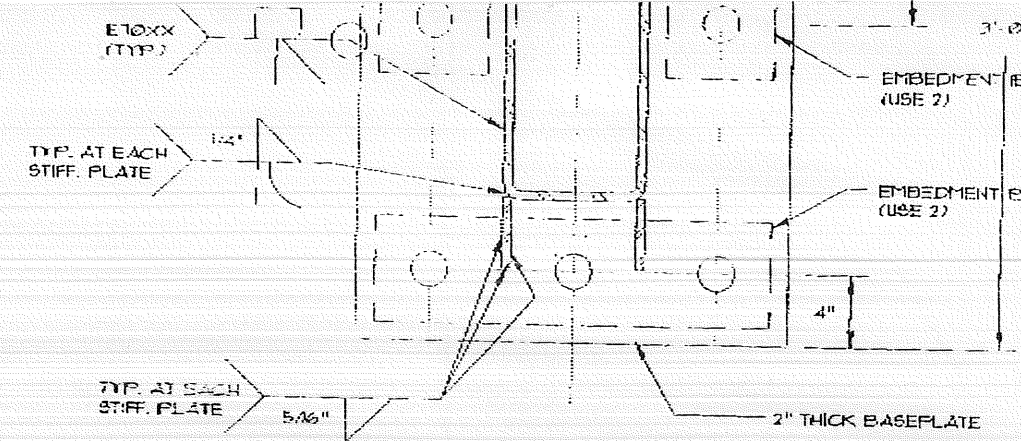
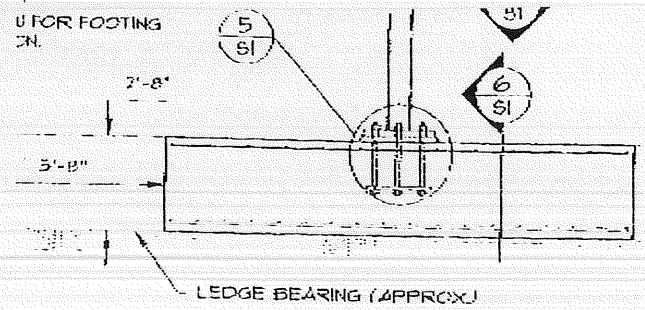

3
SI
DETAIL
SCALE: 1/12" = 1'-0"

GENERAL NOTES:

- CONTRACTOR TO VERIFY ALL DIMENSIONS AND CONDITIONS.
 - FRAME DESIGNED TO 1993 BOCA BUILDING CODE AND THE FOLLOWING LOADS
DEAD LOAD 5 PSF
WIND PRESSURE BASED ON VELOCITY OF 85 MPH
 - CONTRACTOR IS TO PROTECT EXISTING FACILITIES, STRUCTURES, AND UTILITY LINES FROM ALL DAMAGE
 - CONTRACTOR IS RESPONSIBLE FOR ADEQUATE BRACING OF STRUCTURAL MEMBERS AND NON-STRUCTURAL ITEMS DURING CONSTRUCTION.
 - FOOTING SIZE AND REINFORCING BASED ON AN ASSUMED ALLOWABLE SOIL BEARING CAPACITY OF 2000 PSF AND AVAILABLE SPACE. ALL FOOTINGS SHALL BEAR ON LEDGE.
 - CENTER FOOTINGS UNDER THEIR RESPECTIVE COLUMNS.
 - TOP OF FOOTING ASSUMED TO BE APPROXIMATELY FLUSH WITH FINISH GRADE. FOOTING HAS BEEN DESIGNED TO BE 2'-0" (MIN.) THICK.
- CONTRACTOR TO NOTIFY ENGINEER IF LEDGE ELEVATION VARIES.
- STRUCTURAL CONCRETE SHALL CONFORM TO ACI 301 AND SHALL HAVE 3000 PSI COMPRESSIVE STRENGTH IN 28 DAYS. AGGREGATES SHALL BE CLEAN WELL-GRADED, MAXIMUM SIZE 3/4". CONCRETE COMPRESSIVE TESTS SHALL CONFORM TO ASTM C39.
 - USE REGULAR WEIGHT CONCRETE FOR BOTH FOOTINGS (145 PCF, MIN.)
 - USE ASTM A615, GRADE 60 FOR ALL REINFORCING STEEL. PROVIDE COVER AS SHOWN ON THE DRAWING.
 - ANCHOR BOLTS TO BE ASTM A307.

- USE ASTM A36 STRUCTURAL STEEL FOR BASEPLATES. FABRICATION AND ERECTION SHALL CONFORM TO AISC SPECIFICATION FOR THE DESIGN, FABRICATION, AND ERECTION OF STRUCTURAL STEEL FOR BUILDINGS.
- WELDING SHALL BE DONE BY CERTIFIED WELDERS PER AWS REQUIREMENTS. USE AWS A5.1 OR A5.5 E10XX SERIES ELECTRODES.
- SIGN MANUFACTURER IS RESPONSIBLE FOR CONNECTIONS OF SIGN FRAME TO STRUCTURAL FRAME.
- SIGN MANUFACTURER IS TO PROVIDE FOR THE FOLLOWING DEFLECTION DIFFERENCES BETWEEN STRUTS:
UPPER SIGN BODY DEFL. DIFF. = 3 1/4"
LOWER SIGN BODY DEFL. DIFF. = 1 3/4"
- ALL TUBE COLUMNS AND SECTIONS SHALL BE ASTM A500, GRADE B, Fy = 46 KSI STEEL PER AISC.
- LIGHTNING PROTECTION BY OTHERS.
- LEVELING PLATE IS NOT SHOWN FOR CLARITY. USE 1/2" THICK A36 PLATE WITH MATCHING BOLT HOLE PATTERN FOR LEVELING PLATE.

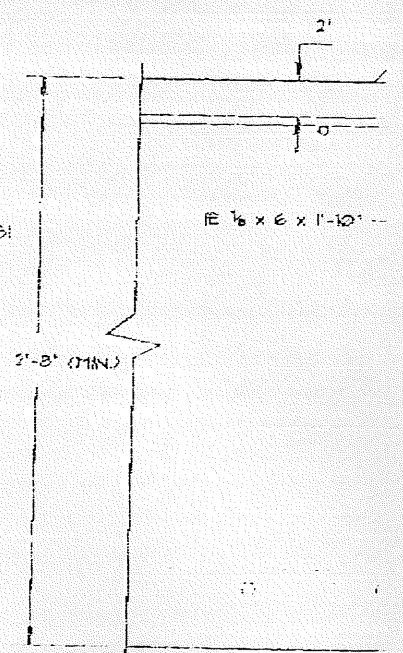

6
SI
SECTION - FOOTING
SCALE: 1/12" = 1'-0"

Bottom B

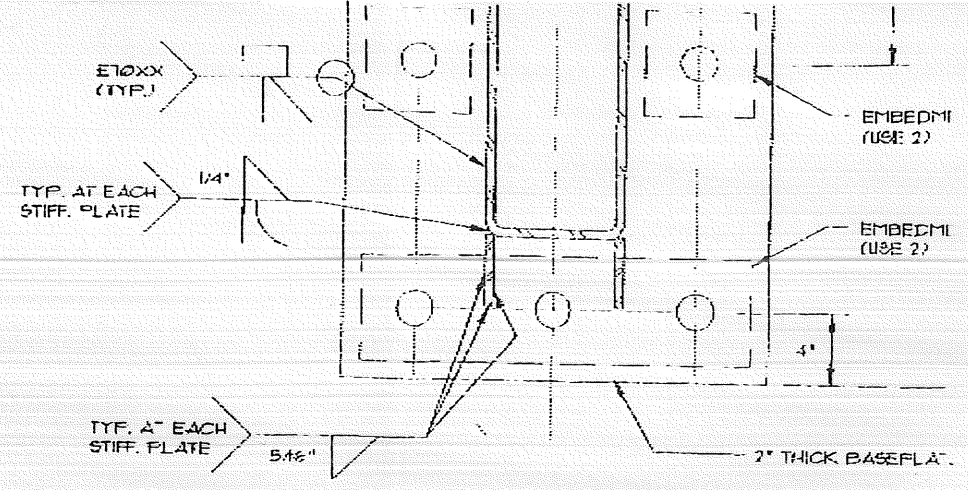
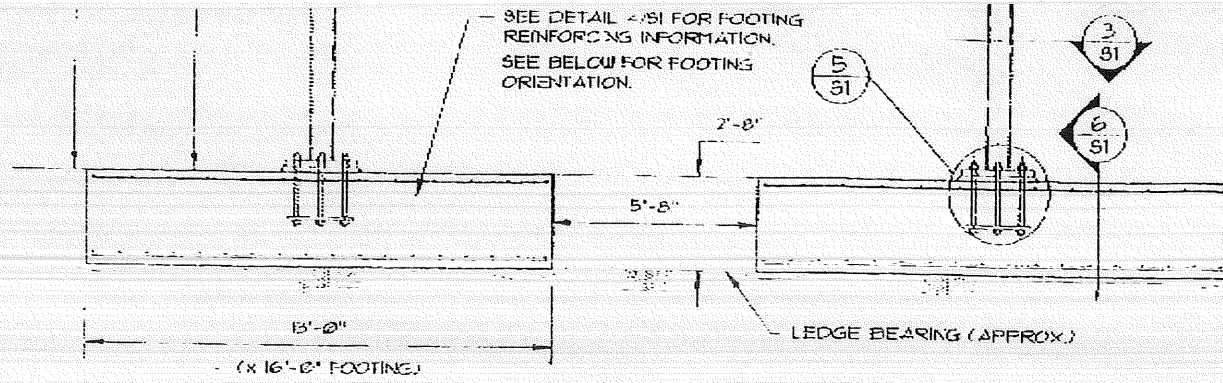

LAYOUT

SCALE: 1/4" = 1'-0"

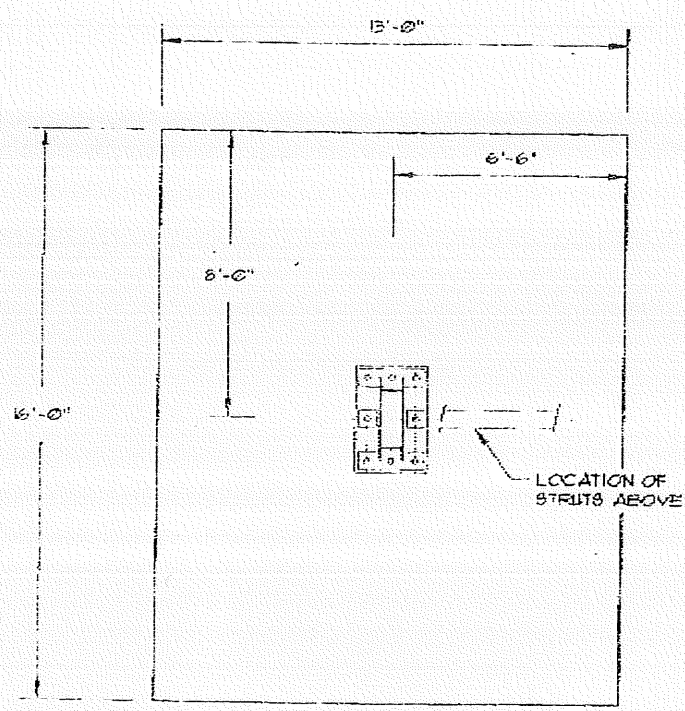

3/S1 DETAIL

SCALE: 1/2" = 1'-0"

GENERAL NOTES:

1. CONTRACTOR TO VERIFY ALL DIMENSIONS AND CONDITIONS.
2. FRAME DESIGNED TO 1993 BOCA BUILDING CODE AND THE FOLLOWING LOADS
DEAD LOAD 5 PSF
WIND PRESSURE BASED ON VELOCITY OF 85 MPH
3. CONTRACTOR IS TO PROTECT EXISTING FACILITIES, STRUCTURES, AND UTILITY LINES FROM ALL DAMAGE
4. CONTRACTOR IS RESPONSIBLE FOR ADEQUATE BRACING OF STRUCTURAL MEMBERS AND NON-STRUCTURAL ITEMS DURING CONSTRUCTION.
5. FOOTING SIZE AND REINFORCING BASED ON AN ASSUMED ALLOWABLE SOIL BEARING CAPACITY OF 2000 PSF AND AVAILABLE SPACE. ALL FOOTINGS SHALL BEAR ON LEDGE.
6. CENTER FOOTINGS UNDER THEIR RESPECTIVE COLUMNS.
7. TOP OF FOOTING ASSUMED TO BE APPROXIMATELY FLUSH WITH FINISH GRADE. FOOTING HAS BEEN DESIGNED TO BE 2'-8" (MIN.) THICK.

CONTRACTOR TO NOTIFY ENGINEER IF LEDGE ELEVATION VARIES.

8. STRUCTURAL CONCRETE SHALL CONFORM TO ACI 301 AND SHALL HAVE 3000 PSI COMPRESSIVE STRENGTH IN 28 DAYS. AGGREGATES SHALL BE CLEAN WELL-GRADED, MAXIMUM SIZE 3/4". CONCRETE COMPRESSIVE TESTS SHALL CONFORM TO ASTM C39.
9. USE REGULAR WEIGHT CONCRETE FOR BOTH FOOTINGS (145 PCF, MIN.)
10. USE ASTM A615, GRADE 60 FOR ALL REINFORCING STEEL. PROVIDE COVER AS SHOWN ON THE DRAWING.
11. ANCHOR BOLTS TO BE ASTM A307.

12. USE ASTM A36 STRUCTURAL STEEL FOR BASE. FABRICATION AND ERECTION SHALL CONFORM TO DESIGN, FABRICATION, AND ERECTION OF STRUCTURAL FRAME.
13. WELDING SHALL BE DONE BY CERTIFIED WELDER. USE AWS A5.1 OR A5.5 E70XX SERIES ELECTRODES.
14. SIGN MANUFACTURER IS RESPONSIBLE FOR CORRECT FABRICATION OF STRUCTURAL FRAME.
15. SIGN MANUFACTURER IS TO PROVIDE FOR THE DEFLECTION DIFFERENCES BETWEEN STRUTS:
UPPER SIGN BODY DEFL. DIFF. =
LOWER SIGN BODY DEFL. DIFF. =
16. ALL TUBE COLUMNS AND SECTIONS SHALL BE STEEL PER AISC.

17. LIGHTNING PROTECTION BY OTHERS.
18. LEVELING PLATE IS NOT SHOWN FOR CLARITY. USE A36 PLATE WITH MATCHING BOLT HOLE PATTERN.

Bottom A

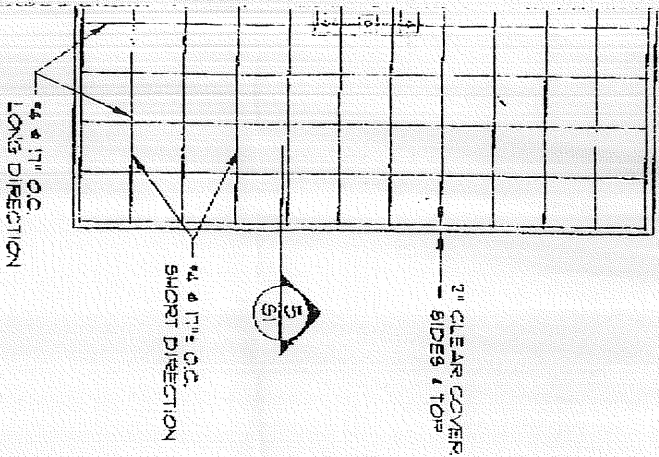

SING

TIPPER PLATES

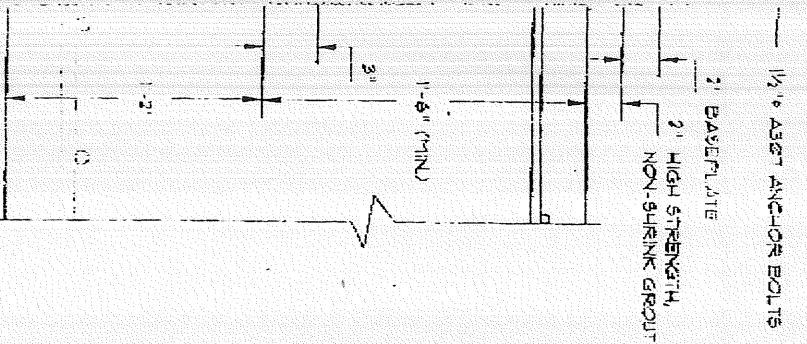

1/2" STIFFENER PLATES

- SUPERSEDES ALL PREVIOUS ISSUES
 - APPROVED FOR CONSTRUCTION
 - PRELIMINARY - NOT FOR CONSTRUCTION
- ISSUED TO: Karl Prosser, Inc
- BY: K/M DATE: 2/1/96

NOTES

REV	DATE	BY	REVISION

REVISIONS



THE AMES CORPORATION
 ARCHITECTS, ENGINEERS & PLANNERS
115 EAST SHAWNEE RD. SUITE 200 WYOMING, WY 84002-1110

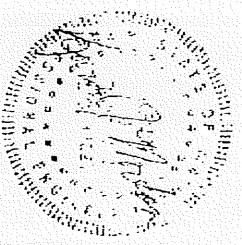

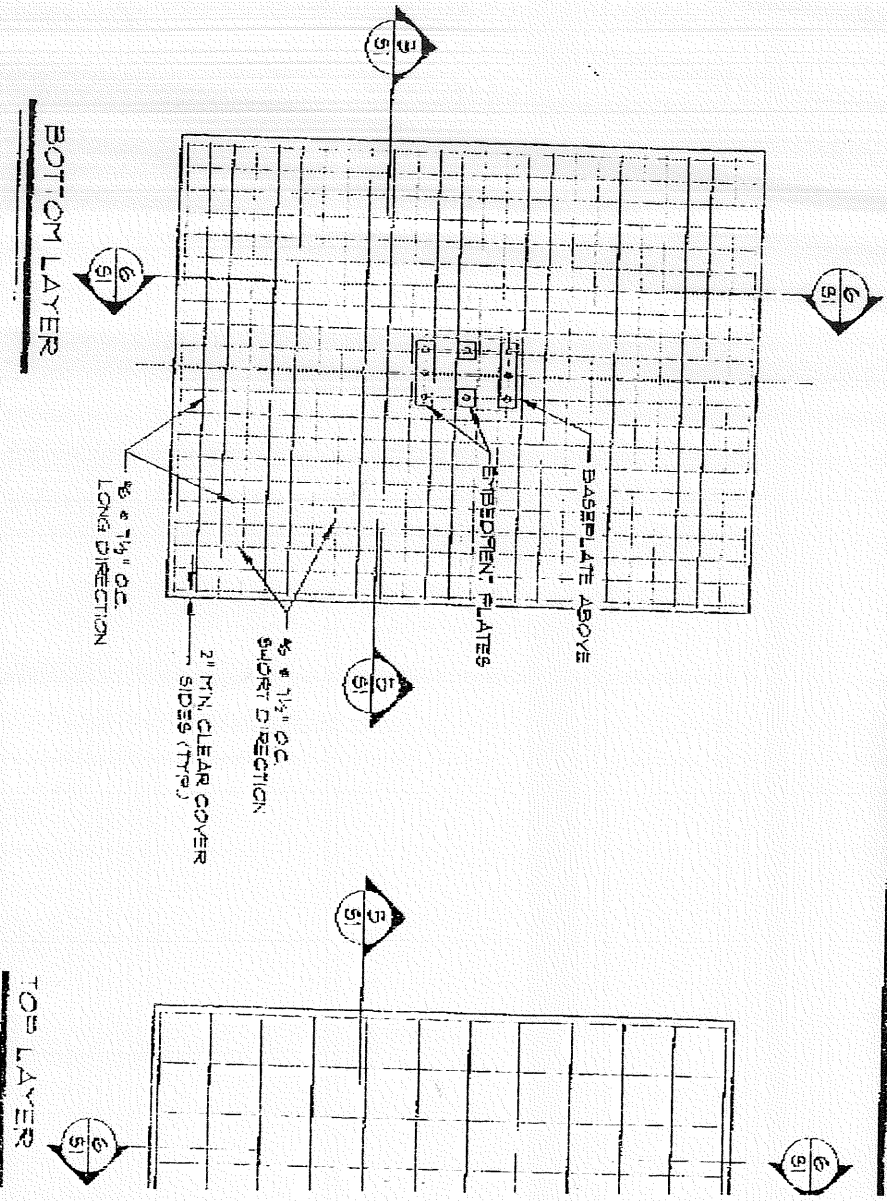

4 **DETAIL - FOOTING REINFOR**
 SCALE: 1/2" = 1'-0"

TYPICAL AT ALL ANCHOR PLATES;
 1) THREADED WIPROT WELDS OR
 2) UNTHREADED WELDS TO DEVELOP
 FULL TENSION CAPACITY OF BOLTS

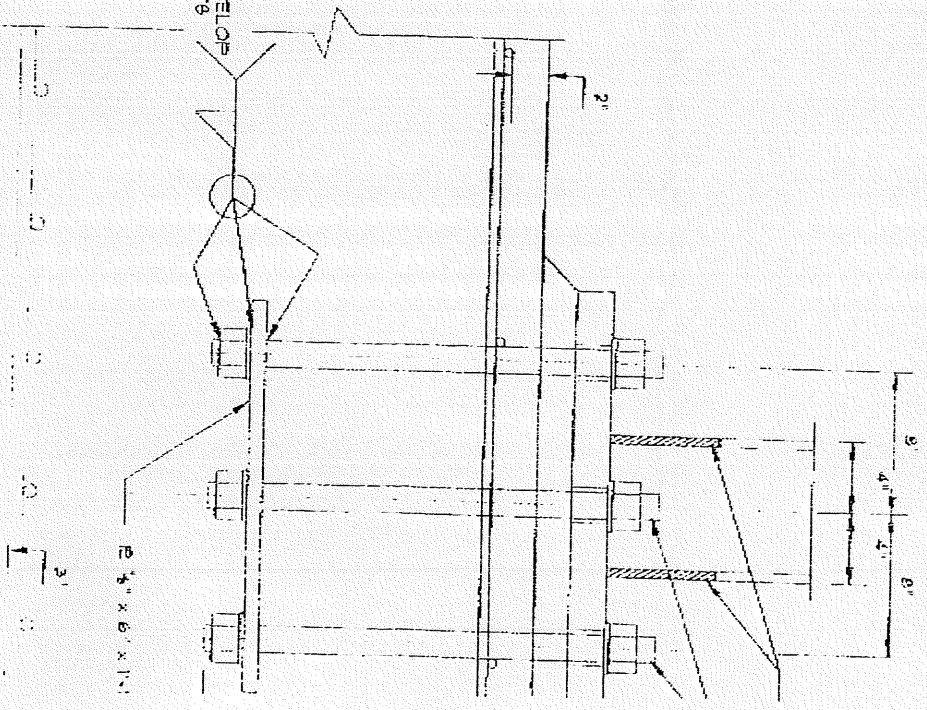

5 **SECTION - FOOTING**
 SCALE: 1/2" = 1'-0"

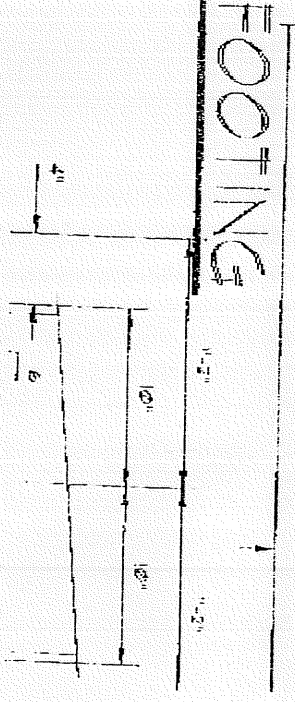

1/2" x 6" x 6"

1/2" x 6" x 6"

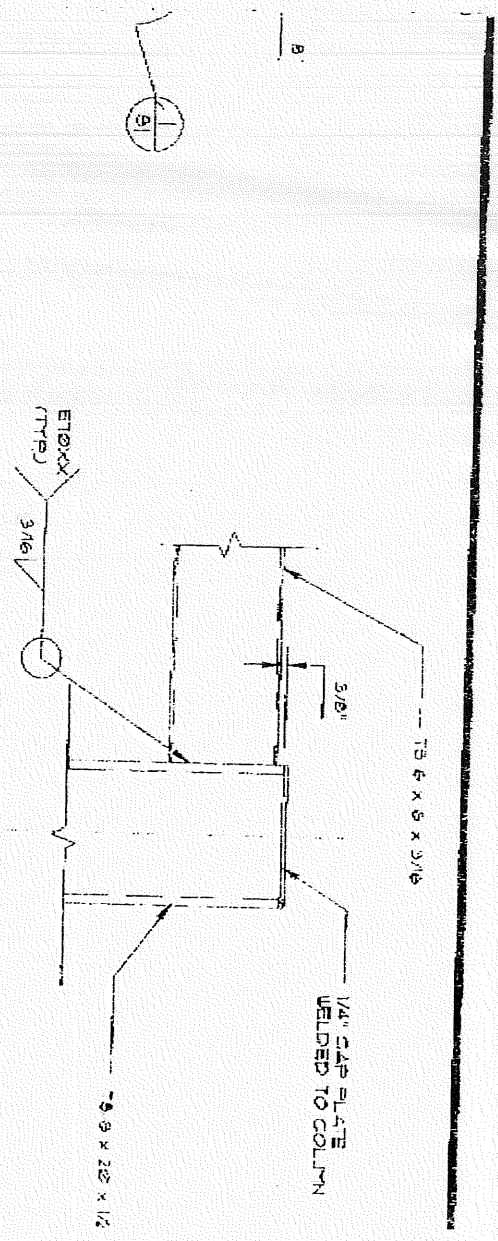

1
DETAIL
 SCALE: 1/2" = 1'-0"

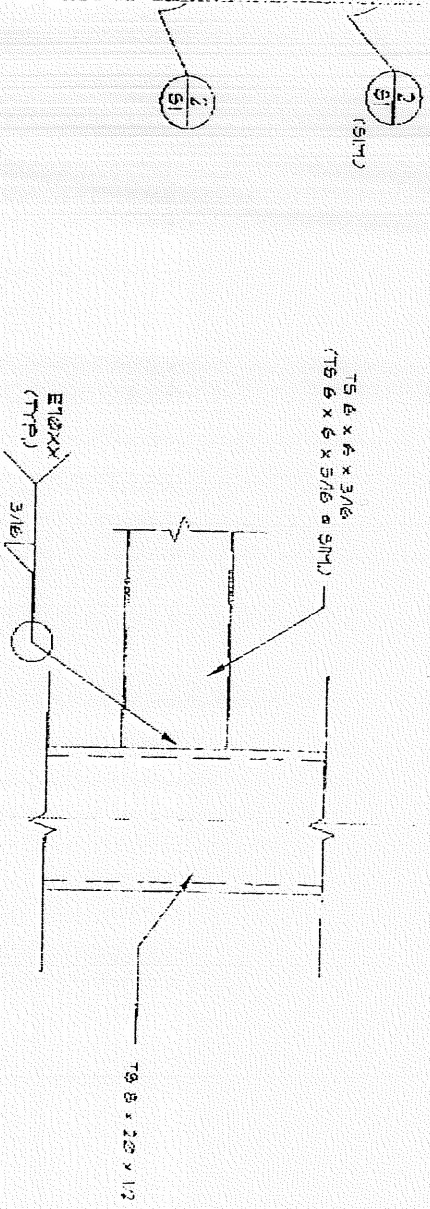

2
DETAIL
 SCALE: 1/2" = 1'-0"

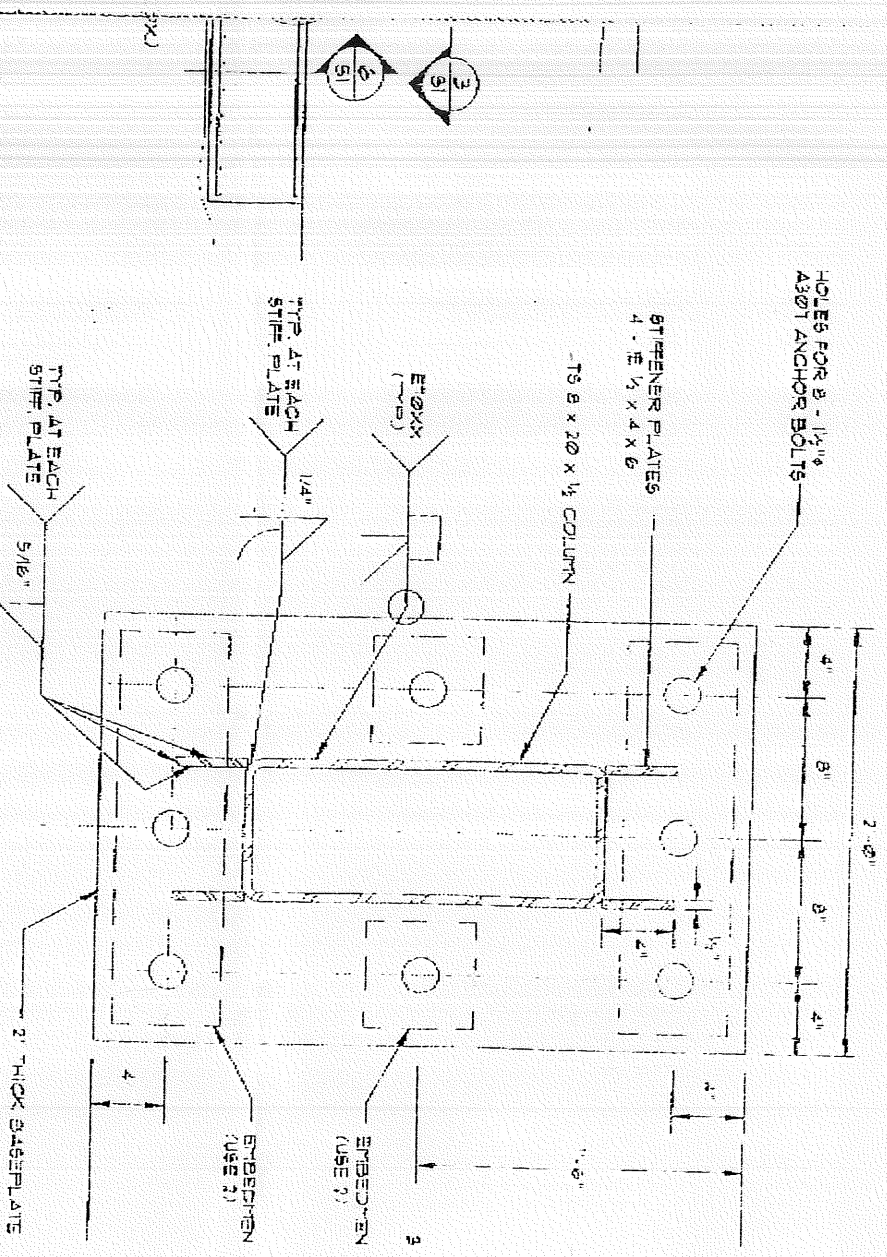

3
DETAIL

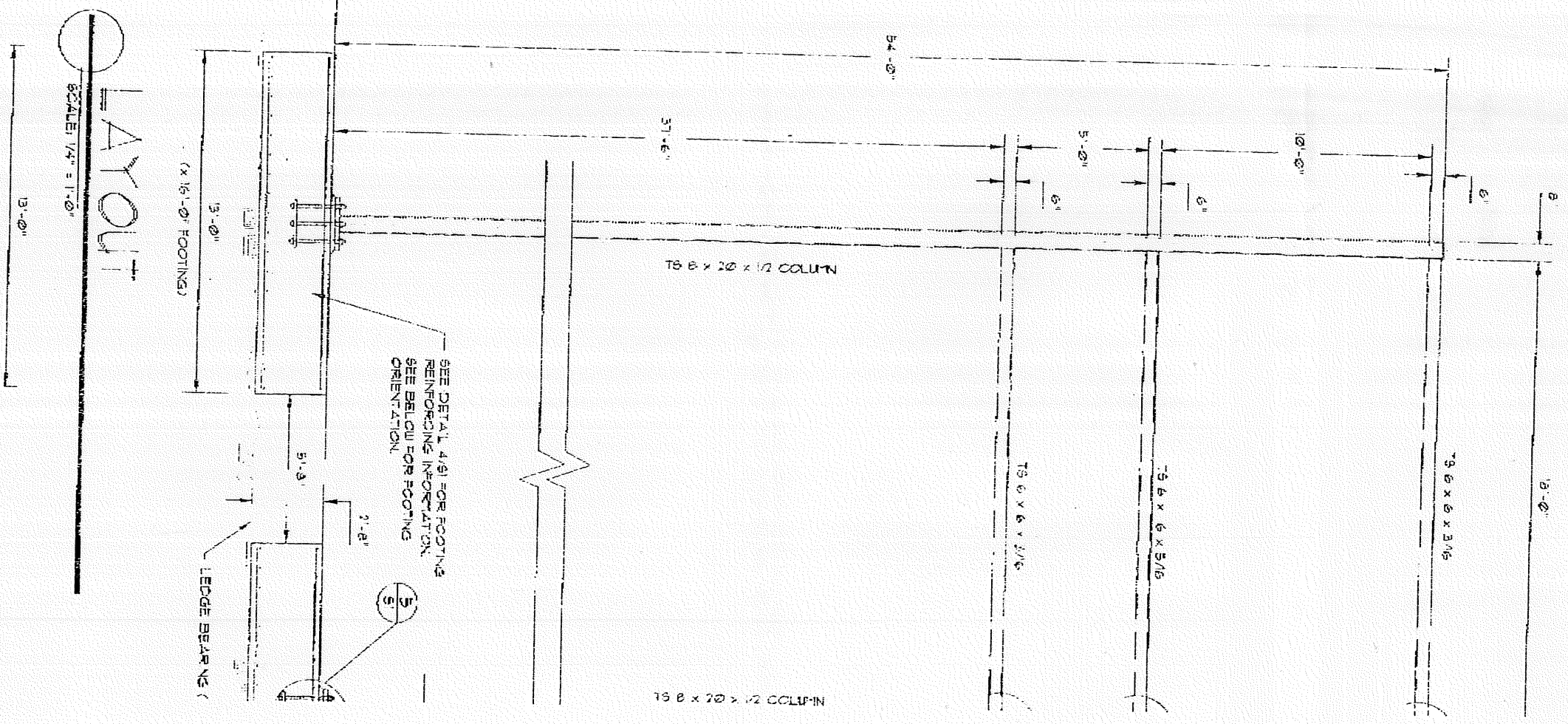

LAYOUT
 SCALE: 1/4" = 1'-0"

13'-0"

STROUDWATER IMPROVEMENT ASSOCIATION
12 Garrison Street
Portland, Maine 04102

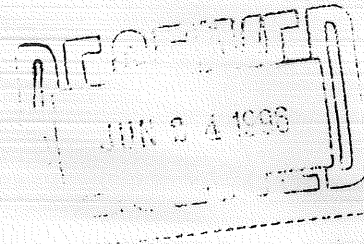

Thomas G. Ainsworth, President

June 21, 1996

Thomas Valleau
Director of Transportation
City of Portland
Portland International Jetport
Westbrook Street
Portland ME 04102

RE: Irving Aviation Sign Matter

1127 Westbrook St

Dear Tom:

Enclosed is a copy of a letter which I have caused to be sent to Attorney Cadot, representing Irving Aviation. As indicated in the letter, we believe we have reached compromise which, when implemented, will allow the withdrawal by Stroudwater of the pending objection to the Irving Aviation sign and its current configuration. Thank you for participating in what proved to be a successful effort to resolve an awkward situation.

Sincerely,

Thomas G. Ainsworth

TGA/lsw

cc: Elizabeth Boynton
Andrew Cadot, Esq.

STROUDWATER IMPROVEMENT ASSOCIATION
12 Garrison Street
Portland, Maine 04102

Thomas G. Ainsworth, President

June 21, 1996

Andrew Cadot, Esq.
Perkins Thompson Hinckley & Keddy
P.O. Box 426
Portland ME 04112-0426

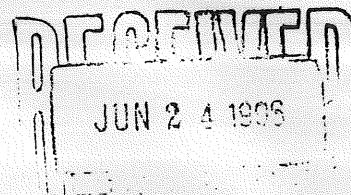

RE: Irving Aviation/Airport Sign Matter

Dear Andy:

1127 Westbrook St

This letter confirms the substance of a conversation you and I had via telephone on the morning of the 21st of June regarding a compromised resolution of the pending issues relative to Irving Aviation's new sign at the Jetport. Stroudwater accepts the spirit of the proposal made by Mr. Chris McAuliffe of Irving Oil Corporation in his letter to the SIA dated June 17, 1996, a copy of which letter is appended here. In an effort to detail somewhat more completely what SIA anticipates is involved in implementing the Irving proposal, Stroudwater understands and expects the following:

1. The existing sign for Irving Aviation at the Jetport will be lowered so that the top of the existing sign is no higher than the roof line of the tallest of the Irving Aviation buildings now in existence at the Jetport.

2. The north face of the existing sign (facing the Historic District) will not be lit and, in fact, some reengineering of the existing sign will occur to insure that light is not transmitted through the sign's north facade toward the Historic District.

3. The north facade of the sign will continue in appearance as it now is, i.e., the north face will continue to bear the Irving Aviation logo and message.

4. To the extent reasonably necessary, Irving will continue to cooperate with Jetport, City, and SIA personnel to develop and implement a long term policy regulating signage at the airport in an effort to preserve, and perhaps enhance, harmonious relations among all involved. In this regard, the SIA will continue to express concern about light pollution and visual pollution as viewed, not only on the airport itself, but also from surrounding neighborhoods including Stroudwater.

Andrew Cadot, Esq.
Page 2
June 21, 1996

5. Based upon the foregoing points of agreement, Stroudwater will withdraw its objection to the granting of a Sign Permit to Irving Aviation even though the Permit was issued after Stroudwater expressed its objections to the proposed sign.

During our conversation, we discussed the expectation that Irving will continue to honor its previous agreement not to light the sign even in its altered state after 11:00 p.m. Let me add that the SIA appreciated the offer by Irving to permit the SIA to occasionally use the conference room facility at the FBO, provided that Irving did not have other scheduled use for it at the time requested by SIA.

Looking to the future, it is our hope that the unfortunate aspects of the present situation have nonetheless allowed us to build a framework to work cooperatively in the future on issues affecting mutual interests.

Sincerely,

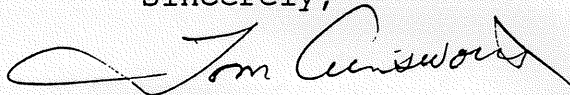
A handwritten signature in cursive script, appearing to read "Tom Ainsworth".

Thomas G. Ainsworth

TGA/lsw

cc: Portland International Jetport
Elizabeth Boynton, City Hall



IRVING OIL CORPORATION

700 MAINE AVENUE
P.O. BOX 401
BANGOR, MAINE 04402-0401

June 17, 1996

VIA TELEFAX TO 767-4824

Stroudwater Improvement Association
c/o Thomas G. Ainsworth, President
12 Garrison Street
Portland, ME 04102

RE: IRVING AVIATION SIGN AT THE JETPORT

1127 Westbrook St

Dear Mr. Ainsworth:

Following up our recent conferences regarding the new Irving Aviation FBO sign at the Jetport, Irving Aviation would like to suggest a new concept to address the concerns of the Association. Irving is willing to have the sign lowered so that the roof line of the hangar hides the sign from Westbrook Street, and in addition, to have the sign altered so that no light is emitted from the north facing side of the sign. If this resolution is satisfactory to the Association, Irving will be willing to have the City permit it obtained amended to add these conditions.

We would appreciate your letting us know the Association's position as soon as possible.

Sincerely,

Chris McAuliffe