

SITE LAYOUT NOTES

1. ALL BARRIER FREE PARKING SPACES ARE TO RECEIVE BARRIER FREE SIGNS AND PAVEMENT MARKINGS AS ILLUSTRATED ON THE DETAIL SHEETS.
2. ALL CURBING MATERIALS WILL BE SELECTED BY THE OWNER. THE DIMENSIONS PROVIDED ON THE PLAN ARE TO FACE OF CURB. ALL CURBING TYPES ARE DETAILED IN THE PROJECT DETAIL SHEETS.
3. ALL DIMENSIONING, UNLESS NOTED OTHERWISE, IS TO THE FACE OF CURB, THE EDGE OF PAVEMENT OR THE FACE OF THE BUILDING.
4. EXCEPT WHERE INDICATED OTHERWISE, THE PAVEMENT IS TO BE STANDARD DUTY PAVEMENT.

CURB LEGEND

- TYPE 1 VERTICAL GRANITE CURB - FLUSH
- TYPE 1 VERTICAL GRANITE CURB
- TIP DOWN
- TRANSITION STONE (VERTICAL GRANITE TO SLIP FORM CONCRETE)

PAVEMENT MARKING LEGEND

- 4" DYCL 4" WIDTH DOUBLE YELLOW CENTERLINE
 - 4" SYLL 4" WIDTH SOLID YELLOW LANE LINE
 - 4" SWLL 4" WIDTH SOLID WHITE LANE LINE
 - STOP 12" WIDTH SOLID WHITE STOP LINE
- ALL PARKING STALLS TO BE 4" WIDTH SINGLE SOLID WHITE LINE EXCEPT AS SHOWN ON SITE LAYOUT PLAN.
- ALL SIGNAGE AND STRIPING SHALL CONFORM TO THE STANDARDS FOR SIZE, HEIGHT, LOCATION, COLOR, INSTALLATION AND REFLECTIVITY SET FORTH IN THE CURRENT VERSION OF THE MANUAL ON UNIFORM TRAFFIC CONTROL DEVICES (MUTCD).

PAVEMENT LEGEND

- STANDARD DUTY PAVEMENT
- LIGHT DUTY PAVEMENT
- BITUMINOUS PAVEMENT SIDEWALK
- HARDSCAPE - FINAL SURFACE MATERIAL TBD

SIGN LEGEND

R1-1 24"x24" A

R7-8 12"x18" B

R7-8 12"x18" C

W11-2 24"x24" W16-9P 12"x6" D

W11-2 24"x24" W16-7P 12"x6" E

R7-1 12"x18" F

R7-1 12"x18" G

R5-1 30"x30" H

100 / 16 / 8 PARKING SPACE - STANDARD / COMPACT / ACCESSIBLE

BASELINE LINE TABLE		
ID	LENGTH	DIRECTION

BASELINE CURVE TABLE						
ID	RADIUS	ARC LENGTH	DELTA	TANGENT	PC STATION	PT STATION

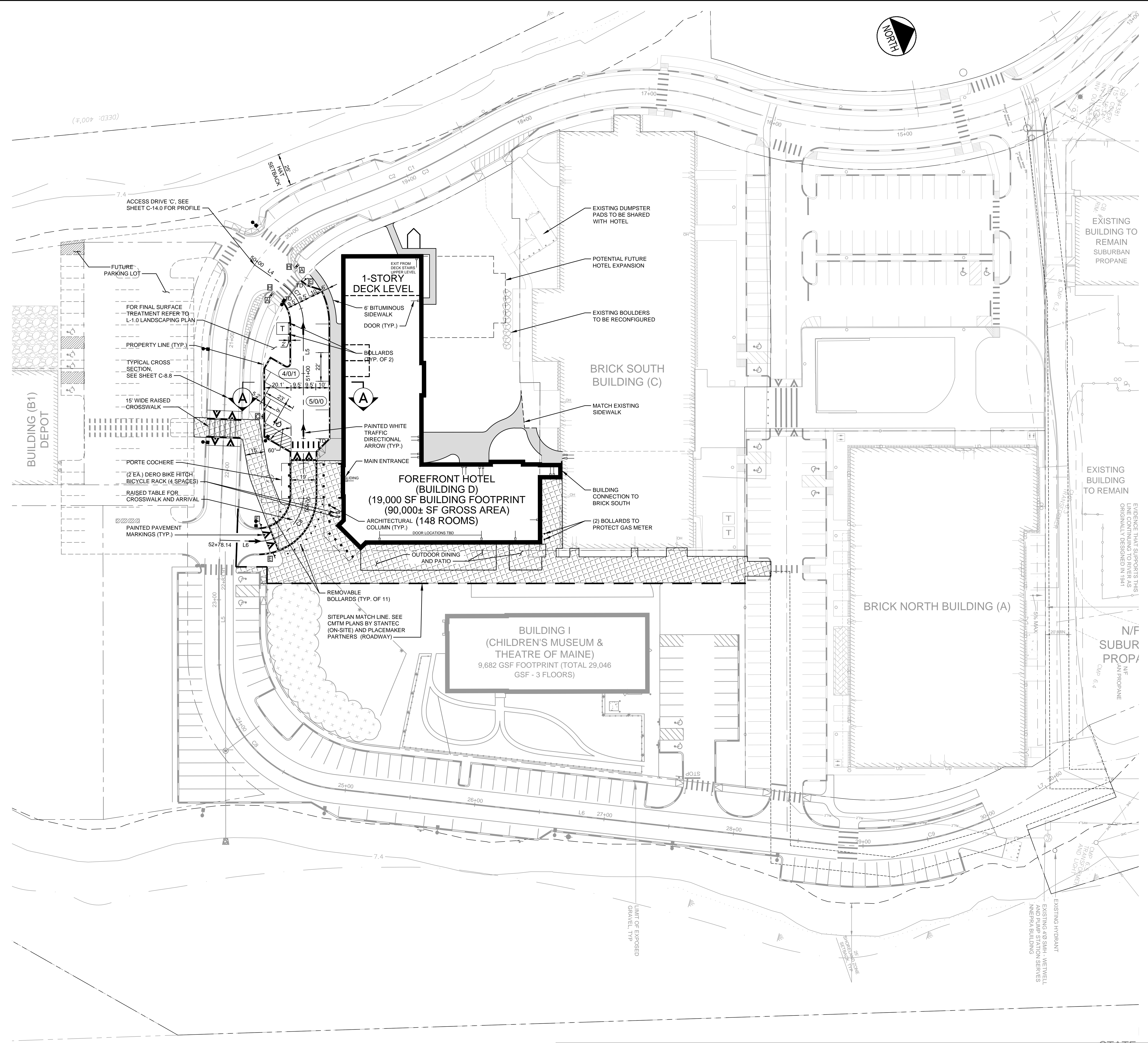

PRELIMINARY – NOT FOR CONSTRUCTION

	PROJECT THE FOREFRONT AT THOMPSON'S POINT FOREFRONT HOTEL	PLACEMAKER PARTNERS, LLC 501 DANFORTH STREET PORTLAND, ME 04102 bo@placemakerpartners.com
	SHEET TITLE SITE LAYOUT PLAN	DRAWN: DB DATE: AUG 2017 DESIGNED: BEK SCALE: 1" = 30' FILE NAME: HOTEL-SITE LAYOUT.dwg
	CLIENT FOREFRONT HOTELIERS, LLC	SHEET C-3.0

C:\Users\DCS\2017\Thompson\DCS\Projects\Placemaker\Thompson Point\02.dwg\HOTEL-SITE LAYOUT.dwg, dc:2017 10/2/2017 1:07 PM