

TIDAL AREA

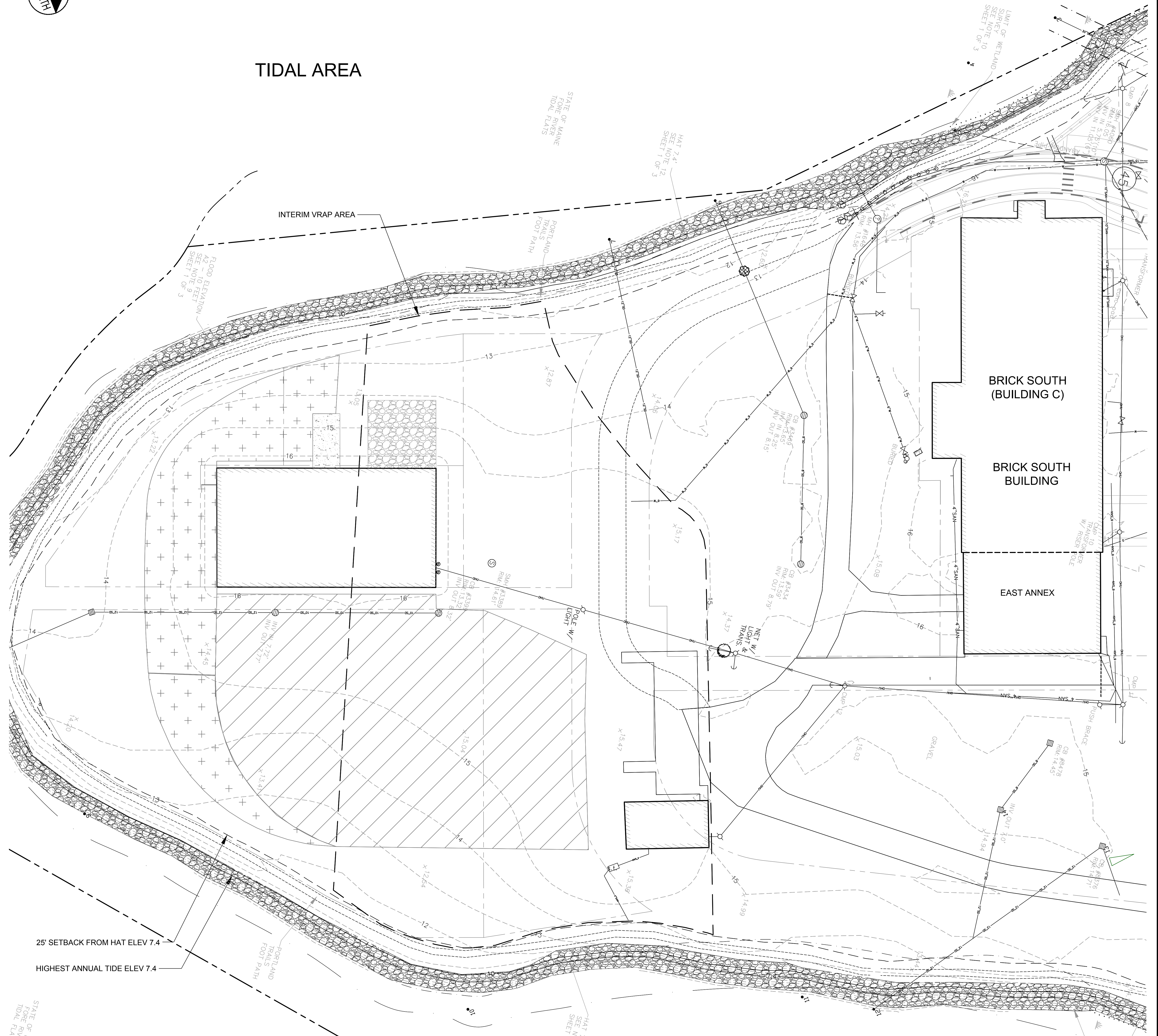

NOTE:
 THIS PLAN REPRESENTS EXISTING CONDITIONS PRIOR TO CONSTRUCTION OF SITE PLAN IMPROVEMENTS ATTENDANT WITH BRICK SOUTH. AS-BUILT PLANS ARE AVAILABLE FROM THE CONTRACTOR (SHAW BROS.) UPON REQUEST.

- PLAN REFERENCES:**
- BOUNDARY AND TOPOGRAPHIC DATA PROVIDED BY SEBAGO TECHNICS AS SHOWN ON A PLAN TITLED ALTA/ACSM LAND TITLE SURVEY OF 1 THOMPSON'S POINT, DATED MAY 27, 2011 AND LAST REVISED ON NOVEMBER 23, 2011. ADDITIONAL SURVEY ON SUBURBAN PROPANE PROVIDED ON MARCH 30, 2014, BY SEBAGO TECHNICS.
 - BORINGS AND TEST PIT LOCATIONS PROVIDED BY CREDERE ASSOCIATES, LLC AS SHOWN ON A PLAN TITLES FIGURE 2 PROPOSED SAMPLE LOCATION PLAN, THOMPSON'S POINT PROPERTY.
 - ADDITIONAL UTILITY DATA TAKEN FROM CITY AND UTILITY COMPANY RECORD DRAWINGS, AS WELL AS OBSERVATIONS BY DELUCA-HOFFMAN ASSOCIATES, INC. PERSONNEL DURING SITE VISITS.

25' SETBACK FROM HAT ELEV 7.4
 HIGHEST ANNUAL TIDE ELEV 7.4

PRELIMINARY – NOT FOR CONSTRUCTION

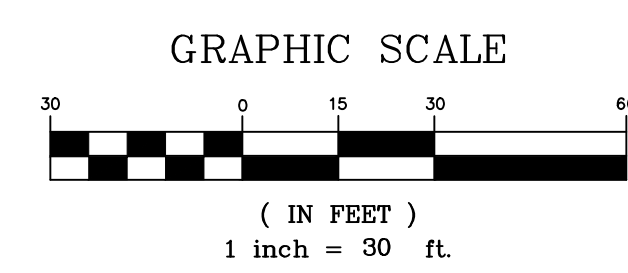

		PROJECT THE FOREFRONT AT THOMPSON'S POINT SECTIONAL 2 ROADWAY EXTENSION	PLACEMAKER PARTNERS, LLC 501 DANFORTH STREET PORTLAND, ME 04102 bo@placemakerpartners.com
SHEET TITLE EXISTING CONDITIONS PLAN		CLIENT FOREFRONT BRICK SOUTH, LLC	DRAWN: BEK DESIGNED: BEK FILE NAME: 2982.05-BS DEMO SHEET
1 REV	2017.03.20 DATE	LEVEL II SITE PLAN APPLICATION DESCRIPTION	DATE: FEB 2017 SCALE: 1" = 30' C-2.0
REVISIONS		P.E. BO KENNEDY LIC. #11994	LIC. #11994